

UNITED STATES
DEPARTMENT OF THE INTERIOR
BUREAU OF LAND MANAGEMENT

RECEIVED
BLM

FORM APPROVED
Budget Bureau No. 1004-0135
Expires: March 31, 1993

SUNDRY NOTICES AND REPORTS ON WELLS

Do not use this form for proposals to drill or to deepen or reentry to a different reservoir.
Use "APPLICATION FOR PERMIT—" for such proposals

SUBMIT IN TRIPLICATE

98 MAR 23 PM 2:25
070 FARMINGTON, NM

1. Type of Well <input type="checkbox"/> Oil Well <input checked="" type="checkbox"/> Gas Well <input type="checkbox"/> Other	5. Lease Designation and Serial No. NM 04202
2. Name of Operator CONOCO INC.	6. If Indian, Allottee or Tribe Name
3. Address and Telephone No. 10 DESTA DR. STE. 100W, MIDLAND, TX. 79705-4500 (915) 686-5424	7. If Unit or CA, Agreement Designation
4. Location of Well (Footage, Sec., T. R. M. or Survey Description) Section 9, T-28-N, R-9-W, O 400' FSL & 1790' FEL	8. Well Name and No. Jackson COM #1
	9. API Well No. 30-045-25314
	10. Field and Pool, or Exploratory Area Blanco Mesaverde
	11. County or Parish, State San Juan

CHECK APPROPRIATE BOX(S) TO INDICATE NATURE OF NOTICE, REPORT, OR OTHER DATA

TYPE OF SUBMISSION	TYPE OF ACTION	
<input checked="" type="checkbox"/> Notice of Intent	<input type="checkbox"/> Abandonment	<input type="checkbox"/> Change of Plans
<input type="checkbox"/> Subsequent Repon	<input checked="" type="checkbox"/> Recompletion	<input type="checkbox"/> New Construction
<input type="checkbox"/> Final Abandonment Notice	<input type="checkbox"/> Plugging Back	<input type="checkbox"/> Non-Routine Fracrunng
	<input type="checkbox"/> Casing Repair	<input type="checkbox"/> Water Shut-Off
	<input type="checkbox"/> Altering Casing	<input type="checkbox"/> Conversion to Injection
	<input type="checkbox"/> Other	<input type="checkbox"/> Dispose Water

(Note: Repon results of multiple completion Wdl Completion or Recompletion Report and Log form.)

13. Describe Proposed or Completed Operations (Clearly state all pertinent details, and give pertinent dates, including estimated date of starting any proposed work. If well is directionally drilled, give subsurface locations and measured and true vertical depths for all markers and zones pertinent to this work.)*

It has been proposed to recomplete this well in the Mesaverde according to the attached procedure.

RECEIVED
MAR 27 1998
OIL CON. DIV.
DIST. 3

14. I hereby certify that the foregoing is true and correct		
Signed <u>Kay Maddox</u>	Title <u>Kay Maddox</u>	Date <u>3/14/98</u>
(This space for Federal or State office use)		
Approved by <u>WAYNE TOWNSEND</u>	Title <u>Pet. Eng.</u>	Date <u>3/25/98</u>
Conditions of approval if any:		

BLM(6), NMOCD(1), SHEAR, PONCA, COST ASST, FILE ROOM

Title 18 U.S.C. Section 1001, makes it a crime for any person knowingly and willfully to make to any department or agency of the United States any false, fictitious or fraudulent statements or representations as to any matter within its jurisdiction.

*See Instruction on Reverse Side

NMOCD

**Jackson Com No. 1
Mesaverde Recompletion Procedure
API # 30-045-253140
AFE# 51-61-XXXX**

Justification:

Funds in the amount of \$156,500 (gross) is requested to cement squeeze and recomplete the Jackson Com No. 1 to the Mesaverde and downhole comingle with existing Dakota production.

During 1997 the Jackson Com No. 1 averaged 42 MCFD and has cum'd 578 MMCF since it was drilled and completed in 1982. Performing the requested work is expected to increase production 250 MCFD with an ultimate recovery of approximately 500 MMCF. The cement squeeze is necessary to obtain casing to formation integrity across the Menefee interval.

This well is Tax Credit Qualified.

**Jackson Com No.1
Mesaverde Recompletion Procedure**

**API # 30-045-25314
AFE# 51-61-XXXX**

March 18, 1998

Summary of Work Recommended

- ✓ Isolate existing Dakota Interval
- ✓ Cement squeeze behind 7" casing.
- ✓ Perforate and Stimulate Mesaverde Interval thru Tubing
- ✓ Remove Isolation Tools
- ✓ Return well to Production as a MV/DK Downhole Commingle

Well Data:

Location: 400' FSL & 1790' FEL, Sec. 9, T28N-R9W
Rio Arriba County, New Mexico

Elevations: KB: 6624'
GL: 6612'
PBTD: 7493'
TD: 7508'

Casing: 9-5/8", 36 #/ft, set @ 352'

cmt 354 cu ft. TOC @ Surface (circ)
Drift: 8.765", Capacity: 0.0773 bbl/ft, Burst: 2464 psi (70% SF)

7", 23#/ft, set @ 5815'

cmt 648 cu ft, (2 stage). TOC @ 1300' (TS) & 5210' CBL (ran in 1996)
Drift: 6.241", Capacity: 0.0393 bbl/ft, Burst: 3042 psi (70% SF)
DV tool @ 2042'

Liner: 4-1/2", 10.5 & 11.6 #/ft, set from 5629' to 7500'

cmt 294 cu ft. TOC @ Liner top 5629'
Drift: 3.927", Capacity: 0.0159 bb/ft, Burst: 3353 psi (70% SF)

Tie-Back: 4-1/2", 11.6 #/ft, set from Surface to 5629'

(3-27-97) cmt 445 sx TOC @ 1650' est
Drift: 3.927", Capacity: 0.0159 bb/ft, Burst: 3353 psi (70% SF)

Tubing: 2-3/8" @ 7427'

Drift: 1.995", Capacity: 0.00387 bbl/ft, Burst: 5416 psi (80% SF)

Perforations: 7314' - 7485' w/ 77 total holes

Additional Notes: Available records indicate no cement behind 7" csg between 5210' and DV tool at 2042'.

**Jackson Com No.1
Mesaverde Recompletion Procedure**

1. Hold safety meeting. MIRU workover unit. If necessary, kill well with a minimum of 1 % KCl. NU BOP and POOH & LD production string.
2. RU wireline unit and RIH w/ 4 1/2" Composite bridge plug. Set plug @ +/- 5610'. Test casing to 3000 psi.

Squeeze Procedure

3. Perforate 4 holes thru 4 1/2" & 7" inch at each of the following intervals using 3 1/8" select fire gun w/ 23 Gram or larger charges:

4 Holes @ 5180'
4 Holes @ 4700'
4. RIH w/ tbg & treating packer. Unload wellbore using Nitrogen. Set packer at +/-5100' and obtain circulation using Nitrogen.
5. Once circulation has been obtained inject 100 sx foamed cement to obtain squeeze. Release packer and POOH. SDON.
6. Drill out cement to 5600'. Test casing to 500 psi.

Note: If above squeeze procedure is unsuccessful, attempt to block squeeze at 5175' & 4750'

Recompletion Procedure:

7. MU 3 1/8" select fire perforating gun w/ 18gm charges w/ GR . Correlate to attached log section and perforate the following depths:

A. If necessary, spot 15% HCl from 5300' to 5260' using a dump bailer.

B. DO NOT PRESSURE UP CASING PRIOR TO PERFORATING.

Point Lookout perfs:

5214', 18', 26', 28', 37', 41', 53', 56', 62', 65', 73', 76', 98',
5304', 06', 13', 17', 49', 54', 56', 69', 76', 78',
5433', 37', 41',
5536', 39', 42', 61', & 63'

Total: 31 holes.

8. PU & RIH w/ Frac string and treating packer to +/- 5150'. RU acidizing equipment.
9. Break down perfs thru tubing using 750 gallons 15% HCl and 50% excess 1.1 sg balls.
(47) Surge balls off perforations.
DO NOT EXCEED 3000 PSI

**Jackson Com No.1
Mesaverde Recompletion Procedure**

10. Frac per attached schedule. Keep frac equipment on location.
 11. Release treating packer & POOH w/ frac string & packer.
 12. RU wireline unit and RIH w/ 7" Composite bridge plug. Set plug @ +/- 5180'. Test casing to 500 psi.
 13. MU 3 1/8" select fire perforating gun w/ 18gm charges w/ GR . Correlate to attached log section and perforate the following depths:
 - A. If necessary, spot 15% HCl from 5045' to 5005' using a dump bailer.
 - B. DO NOT PRESSURE UP CASING PRIOR TO PERFORATING.**
- Menefee Perfs:
- 4821', 23', 30', 33', 48', 55', 57', 77', 79',
4941', 44', 47', 97', 99',
5025', 27', 33', 35', 43', 45',
5116', 18', 25', 27', 35', & 37'
- Total: 26 holes.
14. PU & RIH w/ Frac string and treating packer to +/- 5150'. RU acidizing equipment.
 15. Break down perfs thru tubing using 500 gallons 15% HCl and 50% excess 1.1 sg balls. (39). Surge balls off perforations.
DO NOT EXCEED 3000 PSI
 16. Frac per attached schedule. Clean Location & Release frac equipment.
 17. Release treating packer & POOH w/ frac string & packer.
 18. RU compressors and drill out bridge plugs w/ gas. Clean out well to PBTD (7493'). Jet well w/ gas until well will flow on its own. Drywatch as necessary.
 19. RIH w/ production string. Land SN at +/- 7460'. ND BOP and NU wellhead.
 20. Record and notify necessary personnel for regulatory and gas allocation purposes.
 21. RDMO workover unit.
 22. Thank You.

District I
PO Box 1980, Hobbs, NM 88241-1980
District II
PO Drawer DD, Artesia, NM 88211-0719
District III
1000 Rio Brazos Rd. Aztec, NM 87410
District IV
PO Box 2088, Santa Fe, NM 87504-2088

State of New Mexico
Energy, Minerals & Natural Resources Department

OIL CONSERVATION DIVISION
PO Box 2088
Santa Fe, NM 87504-2088

MOLO C-104
FOR NSL

Form C-102

Revised February 21, 1994

Submit to Appropriate District Office
State Lease - 4 Copies
Fee Lease - 3 Copies

58 MAR 23 PM 2:25

☐ AMENDED REPORT

WELL LOCATION AND ACREAGE DEDICATION PLAT

API Number 30-045-25314		2 Pool Code 72319		3 Pool Name Blanco Mesaverde	
4 Property Code		5 Property Name Jackson COM			6 Well Number 1
7 OGRID No. 005073		8 Operator Name Conoco Inc., 10 Desta Drive, Ste. 100W, Midland, TX 79705-4500			9 Elevation 6612'

10 Surface Location									
UL or lot no. O	Section 9	Township 28N	Range 9W	Lot Idn	Feet from the 440	North/South line South	Feet from the 1790	East/West line East	County San Juan

11 Bottom Hole Location If Different From Surface									
UL or lot no.	Section	Township	Range	Lot Idn	Feet from the	North/South line	Feet from the	East/West line	County

12 Dedicated Acres 272.8	13 Joint or Infill	14 Consolidation Code	15 Order No.
-----------------------------	--------------------	-----------------------	--------------

NO ALLOWABLE WILL BE ASSIGNED TO THIS COMPLETION UNTIL ALL INTERESTS HAVE BEEN CONSOLIDATED OR A NON-STANDARD UNIT HAS BEEN APPROVED BY THE DIVISION

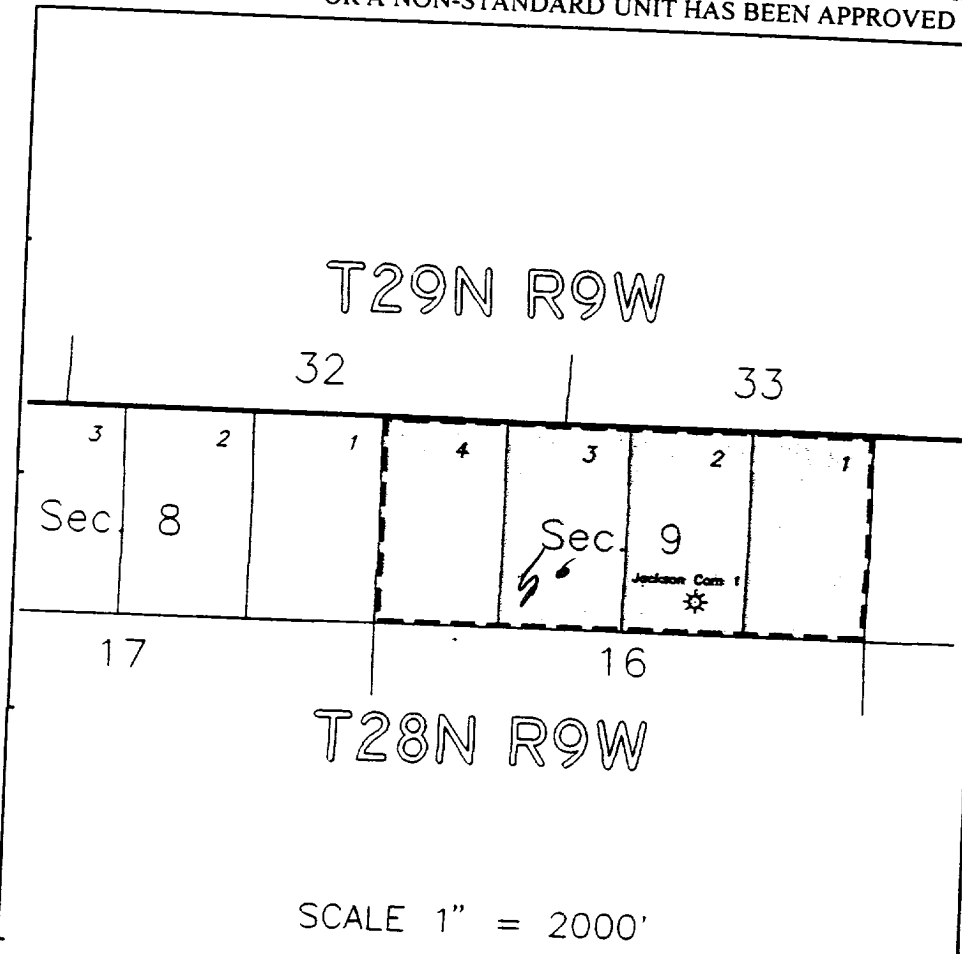

SCALE 1" = 2000'

17 OPERATOR CERTIFICATION

I hereby certify that the information contained herein is true and complete to the best of my knowledge and belief

Signature <i>Kay Maddox</i>	
Printed Name Kay Maddox	
Title Regulatory Agent	
Date March 16, 1998	

18 SURVEYOR CERTIFICATION

I hereby certify that the well location shown on this plat was plotted from field notes of actual surveys made by me or under my supervision, and that the same is true and correct to the best of my belief.

Date of Survey
Signature and Seal of Professional Surveyor:
Certificate Number