

UNITED STATES  
DEPARTMENT OF THE INTERIOR  
GEOLOGICAL SURVEY

## APPLICATION FOR PERMIT TO DRILL, DEEPEN, OR PLUG BACK

1a. TYPE OF WORK

DRILL ☒DEEPEN ☐PLUG BACK ☐

b. TYPE OF WELL

OIL  
WELL ☐GAS  
WELL ☒

OTHER

SINGLE  
ZONE ☒MULTIPLE  
ZONE ☐

2. NAME OF OPERATOR

CURTIS J. LITTLE

3. ADDRESS OF OPERATOR

P. O. Box 2487  
Farmington NM 87401

4. LOCATION OF WELL (Report location clearly and in accordance with any State requirements\*)

At surface

At proposed prod. zone

same

15. DISTANCE IN MILES AND DIRECTION FROM NEAREST TOWN OR POST OFFICE\*

15 miles SE of Bloomfield, N.M.

16. DISTANCE FROM PROPOSED\*  
LOCATION TO NEAREST  
PROPERTY OR LEASE LINE, FT.  
(Also to nearest drlg. unit line, if any)

1585'

17. DISTANCE FROM PROPOSED LOCATION\*  
TO NEAREST WELL, DRILLING COMPLETED,  
OR APPLIED FOR, ON THIS LEASE, FT.

1/2 mile

21. ELEVATIONS (Show whether DF, RT, GR, etc.)

6713 GL

23.

## PROPOSED CASING AND CEMENTING PROGRAM

SIZE OF HOLE	SIZE OF CASING	WEIGHT PER FOOT	SETTING DEPTH	QUANTITY OF CEMENT
8-3/4"	7"	23#	120'	60 sx - circulate
6-1/4"	2.875"	6.4#	2565'	200 sx - to cover Ojo Alamo

Propose to drill with mud, run mechanical logs, selectively perforate, test, and sand/water fracture the Pictured Cliffs Formation. BHP is not expected to exceed 800 psi.

A 10" 3000 psi WP and 6000 psi test double gate BOP with blind and pig rams will be used for blowout prevention.

The gas is dedicated to El Paso.

IN ABOVE SPACE DESCRIBE PROPOSED PROGRAM: If proposal is to deepen or plug back, give data on present productive zone and proposed new productive zone. If proposal is to drill or deepen directionally, give pertinent data on subsurface locations and measured and true vertical depths. Give blowout prevention program, if any.

24.

SIGNED

TITLE Operator

DATE 1-19-82

(This space for Federal or State office use)

PERMIT NO.

APPROVAL DATE

APPROVED BY

TITLE

CONDITIONS OF APPROVAL, IF ANY:

APPROVED  
AS AMENDED

MAY 10 1982

JAMES F. SLIVO  
DISTRICT ENGINEER

NMOC

All distances must be from the outer boundaries of the Section

Operator <b>CURTIS J. LITTLE</b>		Lease <b>WIEDENER</b>		Well No. <b>1</b>
Unit Letter <b>F</b>	Section <b>34</b>	Township <b>27N</b>	Range <b>10W</b>	County <b>San Juan</b>
Actual Footage Location of Well:				
<b>1585</b> feet from the <b>North</b> line and		<b>1840</b> feet from the <b>West</b> line		
Ground Level Elev. <b>6713</b>	Producing Formation <b>Pictured Cliffs</b>	Pool <b>Fulcher Kutz Ext.</b>	Dedicated Acreage: <b>160</b> Acres	

1. Outline the acreage dedicated to the subject well by colored pencil or hachure marks on the plat below.
2. If more than one lease is dedicated to the well, outline each and identify the ownership thereof (both as to working interest and royalty).
3. If more than one lease of different ownership is dedicated to the well, have the interests of all owners been consolidated by communitization, unitization, force-pooling, etc?

☐ Yes ☐ No If answer is "yes," type of consolidation \_\_\_\_\_

If answer is "no," list the owners and tract descriptions which have actually been consolidated. (Use reverse side of this form if necessary.) \_\_\_\_\_

No allowable will be assigned to the well until all interests have been consolidated (by communitization, unitization, forced-pooling, or otherwise) or until a non-standard unit, eliminating such interests, has been approved by the Commission.

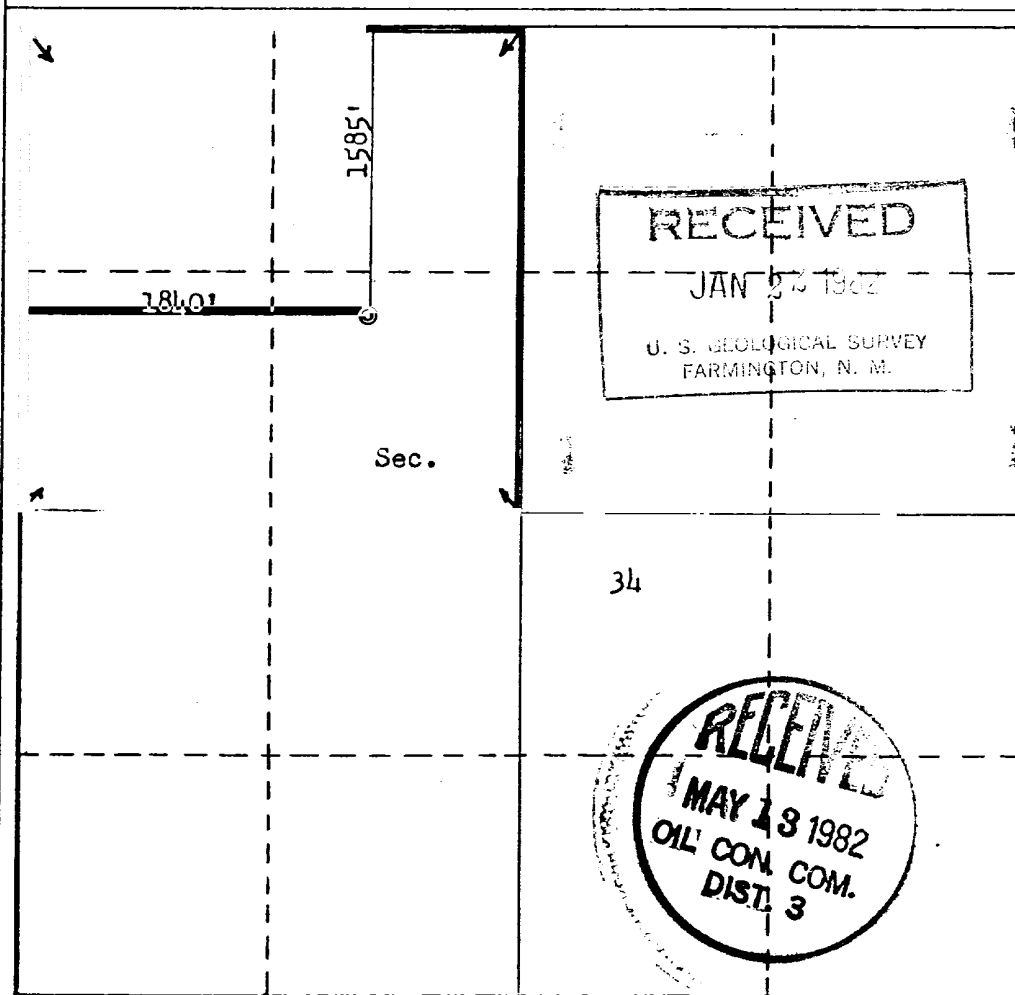

CERTIFICATION

I hereby certify that the information contained herein is true and complete to the best of my knowledge and belief.

*Curtis J. Little*

Name  
**CURTIS J. LITTLE**

Position  
**Operator**

Company  
**Curtis J. Little**

Date  
**January 19, 1982**

I hereby certify that the well location shown on this plat was plotted from field notes of actual surveys made by me or under my supervision, and that the same is true and correct to the best of my knowledge and belief.

Date Surveyed  
**December 10, 1981**

Registered Professional Engineer and/or Land Surveyor

*Fred B. Kerr Jr.*  
**Fred B. Kerr Jr.**

Certificate No.  
**3950**