

UNITED STATES
DEPARTMENT OF THE INTERIOR
GEOLOGICAL SURVEY

SUNDRY NOTICES AND REPORTS ON WELLS

(Do not use this form for proposals to drill or to deepen or plug back to a different reservoir. Use Form 9-331-C for such proposals.)

1. oil ☐ gas ☒ other

2. NAME OF OPERATOR

Union Texas Petroleum Corporation

3. ADDRESS OF OPERATOR

P. O. Box 808, Farmington, New Mexico

4. LOCATION OF WELL (REPORT LOCATION CLEARLY. See space 17 below.)

AT SURFACE: 1650 ft./S; 885 ft./W line

AT TOP PROD. INTERVAL: Same as above

AT TOTAL DEPTH: Same as above

16. CHECK APPROPRIATE BOX TO INDICATE NATURE OF NOTICE, REPORT, OR OTHER DATA

REQUEST FOR APPROVAL TO:

TEST WATER SHUT-OFF ☐
FRACTURE TREAT ☐
SHOOT OR ACIDIZE ☐
REPAIR WELL ☐
PULL OR ALTER CASING ☐
MULTIPLE COMPLETE ☐
CHANGE ZONES ☐
ABANDON* ☐

SUBSEQUENT REPORT OF

(other) Ran 5-1/2" casing

☐
☐
☐
☐
☐
☐
☐
☐
☐
☐
☒

RECEIVED
OCT 29 1982

(NOTE: Report results of multiple completion or zone change on Form 9-330.)
U. S. GEOLOGICAL SURVEY
FARMINGTON, N. M.

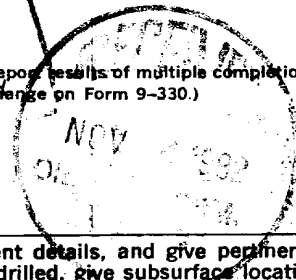

5. LEASE
T-149-IND-8181
6. IF INDIAN, ALLOTTEE OR TRIBE NAME

7. UNIT AGREEMENT NAME

8. FARM OR LEASE NAME
Navajo "D"
9. WELL NO.
I-E
10. FIELD OR WILDCAT NAME
Basin Dakota
11. SEC., T., R., M., OR BLK. AND SURVEY OR AREA
Sec. 1, T27N, R13W, N.M.P.M.
12. COUNTY OR PARISH 13. STATE
San Juan New Mexico
14. API NO.

15. ELEVATIONS (SHOW DF, KDB, AND WD)
6150 R.K.B.

17. DESCRIBE PROPOSED OR COMPLETED OPERATIONS (Clearly state all pertinent details, and give pertinent dates, including estimated date of starting any proposed work. If well is directionally drilled, give subsurface locations and measured and true vertical depths for all markers and zones pertinent to this work.)*

1. Drilled 7-7/8" hole with mud to total depth of 6150 ft. R.K.B. Total depth was reached on 9/30/82.
2. Ran D.I.L., F.I.L., and C.N.L. logs.
3. Ran 147 joints of 5-1/2", 15.50#, K-55 casing and set at 6143 ft. with float collar at 6099 ft. R.K.B. Stage collars were set at 4143 ft. and 1509 ft. R.K.B.
4. Cemented first stage with 352 cu. ft. of 50-50 Poz with 2% gel, 0.6% F.L.A., and 10% salt. Plug down at 8:45 P.M. 10/1/82. Cemented second stage with 590 cu. ft. of 50-50 Poz with 8% gel and 10 lb. of gilsonite per sack and 59 cu. ft. of Class "B" with 2% CaCl₂. Plug down at 10:00 P.M. 10/1/82. Cemented third stage with 298 cu. ft. of 65-35 Poz with 12% gel and 12-1/2 lb. of gilsonite per sack and 129 cu. ft. of 50-50 Poz with 2% gel and 10% salt. Plug down at 10:45 P.M. 10/1/82. (OVER)

Subsurface Safety Valve: Manu. and Type _____ Set @ _____ Ft.

18. I hereby certify that the foregoing is true and correct

SIGNED Kenneth E. Roddy TITLE Production Supt. DATE October 28, 1982
KENNETH E. RODDY

(This space for Federal or State office use)

APPROVED BY _____ TITLE _____ DATE _____
CONDITIONS OF APPROVAL, IF ANY:

5 Change Operator name from Supron Energy Corp.

NMOCC

*See Instructions on Reverse Side

ACCEPTED FOR RECORD

NOV 2 1982

FARMINGTON

BY Smn

Instructions

General: This form is designed for submitting proposals to perform certain well operations, and reports of such operations when completed, as indicated, on Federal and Indian lands pursuant to applicable Federal law and regulations, and, if approved or accepted by any State, on all lands in such State, pursuant to applicable State law and regulations. Any necessary special instructions concerning the use of this form and the number of copies to be submitted, particularly with regard to local, area, or regional procedures and practices, either are shown below or will be issued by, or may be obtained from, the local Federal and/or State office.

Item 4: If there are no applicable State requirements, locations on Federal or Indian land should be described in accordance with Federal requirements. Consult local State or Federal office for specific instructions.

Item 17: Proposals to abandon a well and subsequent reports of abandonment should include such special information as is required by local Federal and/or State offices. In addition, such proposals and reports should include reasons for the abandonment; data on any former or present productive zones, or other zones with present significant fluid contents not sealed off by cement or otherwise; depths (top and bottom) and method of placement of cement plugs; mud or other material placed below, between and above plugs; amount, size, method of parting of any casing, liner or tubing pulled and the depth to top of any left in the hole; method of closing top of well; and date well site conditioned for final inspection looking to approval of the abandonment.

GPO : 1976 O - 214-149

5. Six bbl. of cement slurry circulated to the surface on the third stage.

UNITED STATES
DEPARTMENT OF THE INTERIOR
GEOLOGICAL SURVEY

Amended

Form Approved.
Budget Bureau No. 62-R1424

SUNDRY NOTICES AND REPORTS ON WELLS

(Do not use this form for proposals to drill or to deepen or plug back to a different reservoir. Use Form 9-331-C for such proposals.)

1. oil ☐ gas ☒ other ☐
2. NAME OF OPERATOR
Supron Energy Corporation
3. ADDRESS OF OPERATOR
P.O. Box 808, Farmington, New Mexico 87401
4. LOCATION OF WELL (REPORT LOCATION CLEARLY. See space 17 below.)
1650
AT SURFACE: *1565 ft./S; 885 ft./W lines*
AT TOP PROD. INTERVAL: *Same as above*
AT TOTAL DEPTH: *Same as above*

16. CHECK APPROPRIATE BOX TO INDICATE NATURE OF NOTICE, REPORT, OR OTHER DATA

REQUEST FOR APPROVAL TO:		SUBSEQUENT REPORT OF:	
TEST WATER SHUT-OFF	<input type="checkbox"/>		<input type="checkbox"/>
FRACTURE TREAT	<input type="checkbox"/>		<input type="checkbox"/>
SHOOT OR ACIDIZE	<input type="checkbox"/>		<input type="checkbox"/>
REPAIR WELL	<input type="checkbox"/>		<input type="checkbox"/>
PULL OR ALTER CASING	<input checked="" type="checkbox"/>		<input type="checkbox"/>
MULTIPLE COMPLETE	<input checked="" type="checkbox"/>		<input type="checkbox"/>
CHANGE ZONES	<input type="checkbox"/>		<input type="checkbox"/>
ABANDON*	<input type="checkbox"/>		<input type="checkbox"/>

(other) *Move well location on existing well pad*

5. LEASE
I-149-I149-1149-8181
6. IF INDIAN, APPLICANT OR TRIBAL NAME
Navajo "D"
7. UNIT AGREEMENT NAME
Basin Dakota
8. FARM OR LEASE NAME
Basin Dakota
9. WELL NO.
1-E
10. FIELD OR WILDCAT NAME
Basin Dakota
11. SEC., T., R. OR BLK. AND SURVEY OR AREA
Sec. 1, T27N, R13W, N.M.P.M.
12. COUNTY OR PARISH
San Juan 13. STATE
New Mexico
14. API NO.
5851
15. ELEVATIONS (SHOW DE KDB AND WD)
5851

RECEIVED

(NOTE: Report results of multiple completion or zone change on Form 9-330.)

U.S. GEOLOGICAL SURVEY
FARMINGTON, N.M.

17. DESCRIBE PROPOSED OR COMPLETED OPERATIONS (Clearly state all pertinent details, and give pertinent dates, including estimated date of starting any proposed work. If well is directionally drilled, give subsurface locations and measured and true vertical depths for all markers and zones pertinent to this work.)*

We desire to move the well bore 85 ft. North on the existing approved well pad. The new footage location will be 1650 ft. from the South line and 885 ft. from the West line of Section 1, T27N, R13W, N.M.P.M. We also desire to change casing size from 4-1/2" to 5-1/2", 15.50#, K-55 casing with D.V. tools in the same depth as originally specified. The new cement program is as follows: 1st stage approximately 340 cu. ft. of 50-50 pozmix. 2nd stage approximately 560 cu. ft. of pozmix. 3rd stage approximately 359 cu. ft. of 65-35 pozmix followed by approximately 91 cu. ft. of Class "B" cement. Drill the D.V. tools out. Pressure test the casing. Perf and fracture the Dakota zone. Clean the well up. Run tubing and land above the Dakota zone. Nipple down the wellhead. Test the well and connect to a gathering system.

Subsurface Safety Valve: Manu. and Type _____ Set @ _____ Ft.

18. I hereby certify that the foregoing is true and correct

SIGNED *[Signature]* TITLE *Area Superintendent* DATE *July 27, 1982*

(This space for Federal or State office use)

APPROVED BY _____ TITLE _____ DATE _____
CONDITIONS OF APPROVAL, IF ANY:

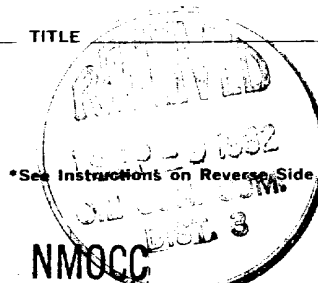

*See Instructions on Reverse Side.

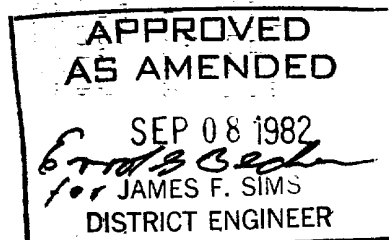

**NEW MEXICO OIL CONSERVATION COMMISSION
WELL LOCATION AND ACREAGE DEDICATION PLAT**

Form C-102
Supersedes C-128
Effective 1-1-65

All distances must be from the outer boundaries of the Section.

Operator SUPRON ENERGY CORPORATION			Lease NAVAJO "D"		Well No. 1-E
Unit Letter L	Section 1	Township 27 NORTH	Range 13 WEST	County SAN JUAN	
Actual Footage Location of Well: 1650 feet from the SOUTH line and 885 feet from the WEST line					
Ground Level Elev. 5838	Producing Formation DAKOTA		Pool BASIN		Dedicated Acreage: W/2 319.91 Acres

1. Outline the acreage dedicated to the subject well by colored pencil or hachure marks on the plat below.
2. If more than one lease is dedicated to the well, outline each and identify the ownership thereof (both as to working interest and royalty).
3. If more than one lease of different ownership is dedicated to the well, have the interests of all owners been consolidated by communitization, unitization, force-pooling, etc?

☐ Yes ☐ No If answer is "yes," type of consolidation _____

If answer is "no," list the owners and tract descriptions which have actually been consolidated. (Use reverse side of this form if necessary.) _____

No allowable will be assigned to the well until all interests have been consolidated (by communitization, unitization, forced-pooling, or otherwise) or until a non-standard unit, eliminating such interests, has been approved by the Commission.

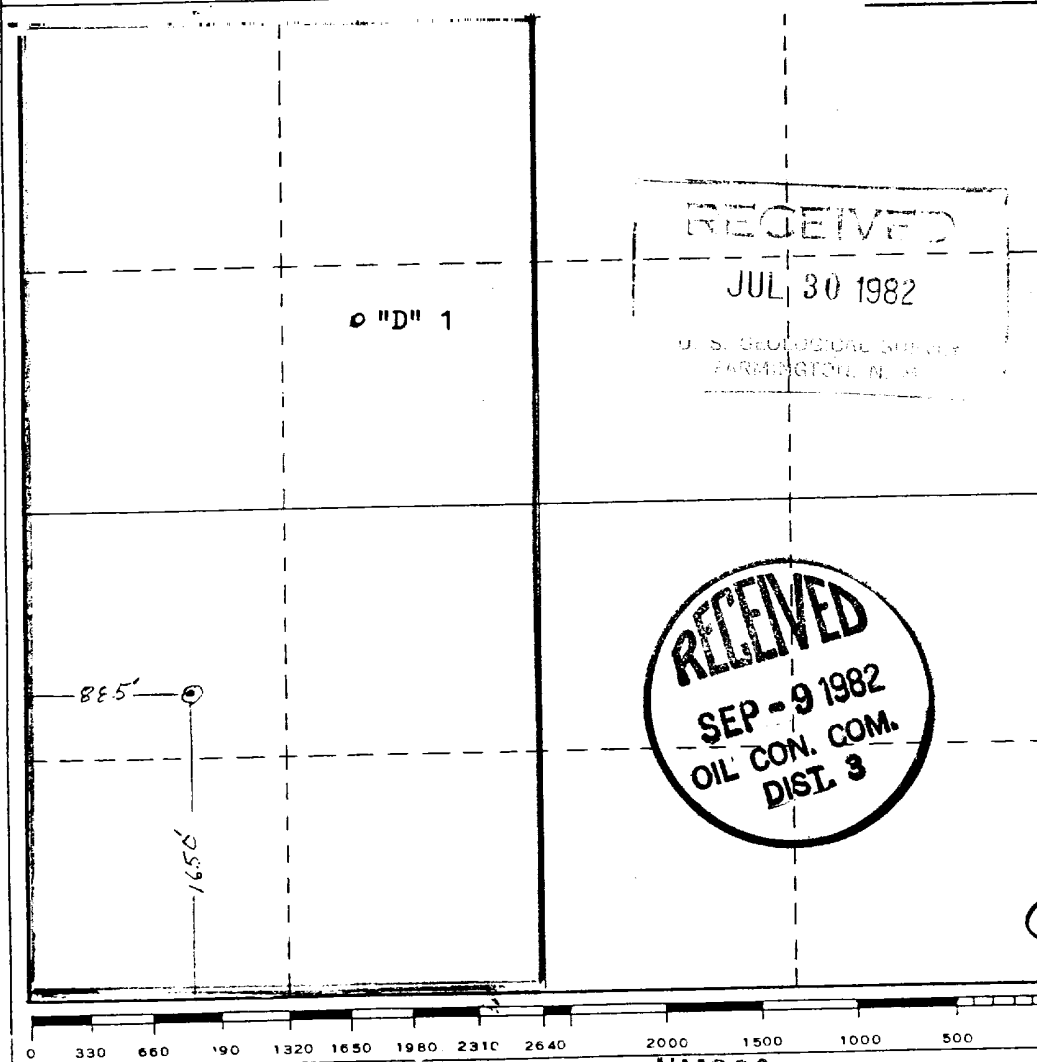

CERTIFICATION

I hereby certify that the information contained herein is true and complete to the best of my knowledge and belief.

Rudy D. Motto
Name

Rudy D. Motto
Position

Area Superintendent

Company

Supron Energy Corporation

Date

July 30, 1982

I hereby certify that the well location shown on this plat was plotted from field notes of actual surveys made by me or under my supervision, and that the same is true and correct to the best of my knowledge and belief.

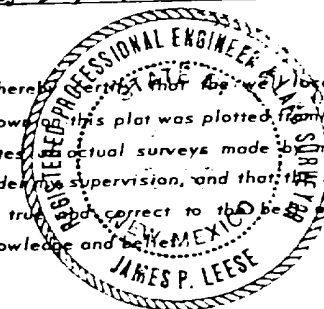

Date Surveyed

July 30, 1982

Registered Professional Engineer
and/or Land Surveyor

James P. Leese

Certificate No.

1463

NMOC