

UNITED STATES  
DEPARTMENT OF THE INTERIOR  
GEOLOGICAL SURVEY

30-045-25625

## APPLICATION FOR PERMIT TO DRILL, DEEPEN, OR PLUG BACK

1a. TYPE OF WORK DRILL <input checked="" type="checkbox"/> DEEPEN <input type="checkbox"/> PLUG BACK <input type="checkbox"/>				5. LEASE DESIGNATION AND SERIAL NO. SF-077329 079596	
b. TYPE OF WELL OIL WELL <input type="checkbox"/> GAS WELL <input checked="" type="checkbox"/> OTHER <input type="checkbox"/> SINGLE ZONE <input checked="" type="checkbox"/> MULTIPLE ZONE <input type="checkbox"/>				6. IF INDIAN, ALLOTTEE OR TRIBE NAME	
2. NAME OF OPERATOR Amoco Production Company				7. UNIT AGREEMENT NAME	
3. ADDRESS OF OPERATOR 501 Airport Dr., Farmington, NM 87401				8. FARM OR LEASE NAME Martin Gas Com "F"	
4. LOCATION OF WELL (Report location clearly and in accordance with any State requirements.) At surface 1850' FNL, 1520' FWL At proposed prod. zone Same				9. WELL NO. 1R	
14. DISTANCE IN MILES AND DIRECTION FROM NEAREST TOWN OR POST OFFICE* 10.6 miles SE of Bloomfield, NM				10. FIELD AND POOL, OR WILDCAT Basin Dakota	
15. DISTANCE FROM PROPOSED LOCATION TO NEAREST PROPERTY OR LEASE LINE, FT. (Also to nearest drlg. unit line, if any) 1520' FWL				11. SEC., T., R., M., OR BLK. AND SURVEY OR AREA SE/NW, Section 14, T27N, R10W	
16. NO. OF ACRES IN LEASE 2560 960				12. COUNTY OR PARISH San Juan	
17. NO. OF ACRES ASSIGNED TO THIS WELL 320				13. STATE NM	
18. DISTANCE FROM PROPOSED LOCATION* TO NEAREST WELL, DRILLING, COMPLETED, OR APPLIED FOR, ON THIS LEASE, FT. 250' East				19. PROPOSED DEPTH 6700'	
20. ROTARY OR CABLE TOOLS Rotary				21. APPROX. DATE WORK WILL START* As soon as permitted.	
22. ELEVATIONS (Show whether DF, RT, GR, etc.) 6140' GL				23. DRILLING OPERATIONS AUTHORIZED ARE SUBJECT TO COMPLIANCE WITH ATTACHED "GENERAL REQUIREMENTS"	
24. PROPOSED CASING AND CEMENTING PROGRAM				This action is subject to administrative appeal pursuant to 30 CFR 290.	
SIZE OF HOLE	SIZE OF CASING	WEIGHT PER FOOT	SETTING DEPTH	QUANTITY OF CEMENT	
12-1/4"	8-5/8"	24# K-55	300'	350 cu ft Class B w/2% CaCl <sub>2</sub>	
7-7/8"	4-1/2"	10.5# K-55	6700'	1st stg. - 1200 cu ft class B 50:50 POZ, w/6% gel & 0.8% FLA. Tail in w/120 cu ft class B neat. 2nd stg. - 1040 cu ft class B 65:35 POZ, w/6% gel, 2# med tuf plug/sx & 0.8% FLA. Tail in w/300 cu ft class B w/2% gel.	

This well was originally staked as the Martin Gas Com "F" No. 1A, but the name has been changed to the Martin Gas Com "F" No. 1R.

The subject well will be drilled to further develop the Basin Dakota reservoir. The well will be drilled from 0-300' using native spud mud. The well will be drilled from 300' to TD using low solids non-dispersed mud system. Completion design will be based on open hole logs. Copies of all logs will be filed upon completion. Amoco's standard blowout prevention will be employed.

The production from this well is dedicated to El Paso Natural Gas under Contract No. 56,742.

IN ABOVE SPACE DESCRIBE PROPOSED PROGRAM: If proposal is to deepen or plug back, give data on present productive zone and proposed new productive zone. If proposal is to drill or deepen directionally, give pertinent data on subsurface locations and measured and true vertical depths. Give blowout prevention program, if any.

21

SIGNED

D. M. SMITH - RCR

TITLE

District Engineer

DATE

2-21-83

(This space for Federal or State office use)

PERMIT NO.

APPROVAL DATE

APPROVED BY

TITLE

CONDITIONS OF APPROVAL, IF ANY:

APPROVED  
AS AMENDEDJAMES F. SIMS  
DISTRICT ENGINEER

All distances must be from the outer boundaries of the Section.

Operator <b>AMOCO PRODUCTION COMPANY</b>			Lease <b>MARTIN "F"</b>		Well No. <b>1R</b>
Unit Letter <b>F</b>	Section <b>14</b>	Township <b>27N</b>	Range <b>10W</b>	County <b>San Juan</b>	
Actual Footage Location of Well: <b>1850</b> feet from the <b>North</b> line and <b>1520</b> feet from the <b>West</b> line					
Ground Level Elev. <b>6140</b>	Producing Formation <b>Dakota</b>		Pool <b>Basin Dakota</b>		Dedicated Acreage: <b>320</b> Acres

1. Outline the acreage dedicated to the subject well by colored pencil or hachure marks on the plat below.
2. If more than one lease is dedicated to the well, outline each and identify the ownership thereof (both as to working interest and royalty).
3. If more than one lease of different ownership is dedicated to the well, have the interests of all owners been consolidated by communitization, unitization, force-pooling, etc?

☐ Yes ☐ No If answer is "yes," type of consolidation \_\_\_\_\_

If answer is "no," list the owners and tract descriptions which have actually been consolidated. (Use reverse side of this form if necessary.) \_\_\_\_\_

No allowable will be assigned to the well until all interests have been consolidated (by communitization, unitization, forced-pooling, or otherwise) or until a non-standard unit, eliminating such interests, has been approved by the Commission.

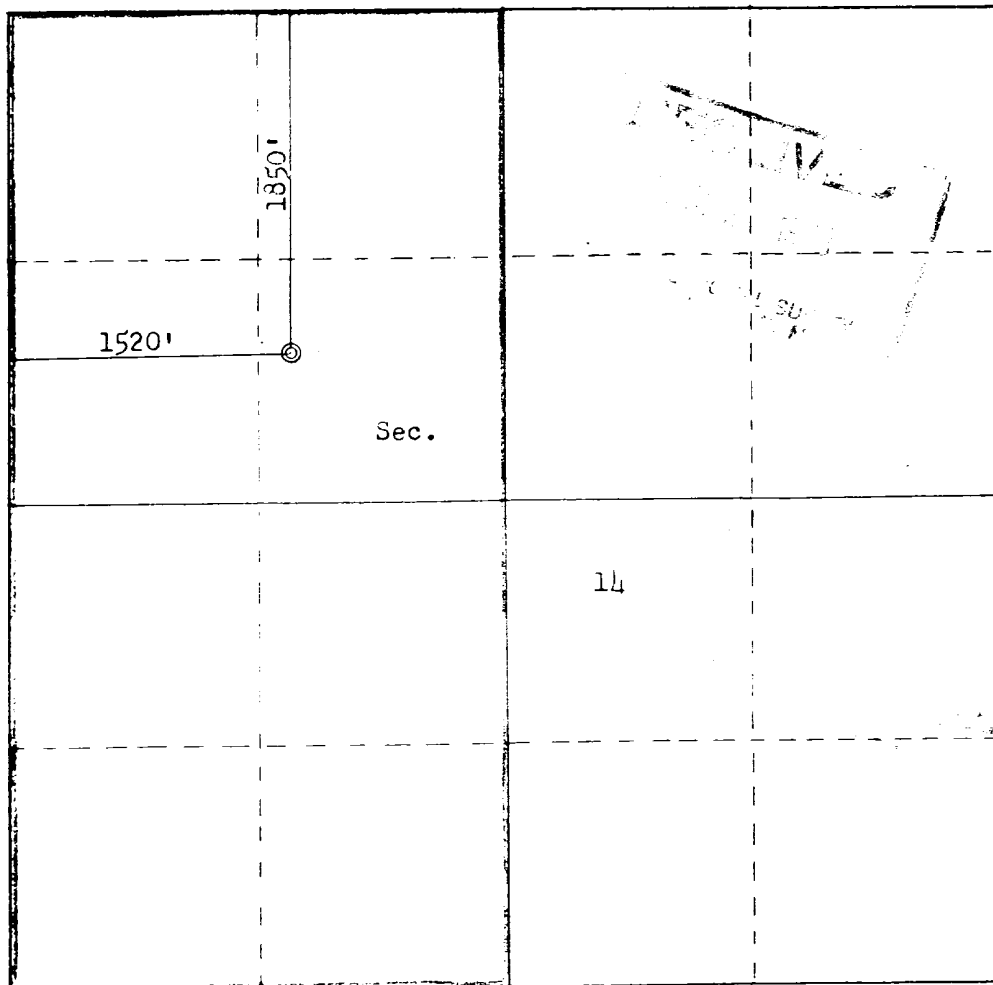

Scale: 1"=1000'

CERTIFICATION

I hereby certify that the information contained herein is true and complete to the best of my knowledge and belief.

*Dale H. Shoemaker*

Name

**D. H. SHOEMAKER**

Position

**DISTRICT ENGINEER**

Company

**AMOCO PRODUCTION COMPANY**

Date

**FEBRUARY 22, 1983**

I hereby certify that the well location shown on this plat was plotted from field notes of actual surveys made by me or under my supervision, and that the same is true and correct to the best of my knowledge and belief.

Date Surveyed

**December 17, 1982**

Registered Professional Engineer and Land Surveyor

*Fred B. Kerr Jr.*  
**Fred B. Kerr Jr.**

Certificate No.

**3950**

