

UNITED STATES  
DEPARTMENT OF THE INTERIOR  
GEOLOGICAL SURVEY

## APPLICATION FOR PERMIT TO DRILL, DEEPEN, OR PLUG BACK

## 1a. TYPE OF WORK

DRILL ☒DEEPEN ☐PLUG BACK ☐

## b. TYPE OF WELL

OIL  
WELL ☐GAS  
WELL ☒

OTHER

SINGLE  
ZONE ☒MULTIPLE  
ZONE ☐

## 2. NAME OF OPERATOR

Southland Royalty Company

## 3. ADDRESS OF OPERATOR

P. O. Drawer 570, Farmington, New Mexico 87499

## 4. LOCATION OF WELL (Report location clearly and in accordance with any State requirements.)

At surface

915' FSL &amp; 1210' FWL

At proposed prod. zone

## 14. DISTANCE IN MILES AND DIRECTION FROM NEAREST TOWN OR POST OFFICE\*

5 miles south of Blanco, New Mexico

U. S. GEOLOGICAL SURVEY

## 15. DISTANCE FROM PROPOSED\*

LOCATION TO NEAREST

PROPERTY OR LEASE LINE, FT.

(Also to nearest dirg. unit line, if any)

915'

## 18. DISTANCE FROM PROPOSED LOCATION\*

TO NEAREST WELL, DRILLING, COMPLETED,  
OR APPLIED FOR, ON THIS LEASE, FT.

500'

## 16. NO. OF ACRES IN LEASE

2337.48

## 19. PROPOSED DEPTH

3250'

## 17. NO. OF ACRES ASSIGNED

TO THIS WELL

122.31

## 20. ROTARY OR CABLE TOOLS

Rotary

## 21. ELEVATIONS (Show whether DP, RT, GR) DRILLING OPERATIONS AUTHORIZED ARE

5740' GL

SUBJECT TO COMPLIANCE WITH ATTACHED

## 22. APPROX. DATE WORK WILL START\*

April 15, 1983

## 23. "GENERAL REQUIREMENTS" PROPOSED CASING AND CEMENTING PROGRAM

This action is subject to administrative  
approval. Bureau No. 87-674-590.

SIZE OF HOLE	SIZE OF CASING	WEIGHT PER FOOT	SETTING DEPTH	QUANTITY OF CEMENT
12-1/4"	8-5/8"	24#, K-55	200'	165 cu.ft. (Circ to surface)
7-7/8"			2900'	
6-3/4"	2-7/8"	6.5#, J-55	3250'	954 cu.ft. (Cover Ojo Alamo)

Surface formation is Nacimiento.

Top of Ojo Alamo sand is at 892'.

Top of Pictured Cliffs sand is at 2007'.

Fresh water mud will be used to drill from surface to total depth.

It is anticipated that an IEL will be run to surface casing and GR-CDL will be  
run from total depth to 1250'

No abnormal pressures or poisonous gases are anticipated in this well.

It is expected that this well will be drilled before May 15, 1983.

This depends on time required for approvals, rig availability and the weather.

Gas is dedicated.

IN ABOVE SPACE DESCRIBE PROPOSED PROGRAM: If proposal is to deepen or plug back, give data on present productive zone and proposed new productive zone. If proposal is to drill or deepen directionally, give pertinent data on subsurface locations and measured and true vertical depths. Give blowout preventer program, if any.

24.

SIGNED

*D. E. Field*

TITLE

District Engineer

DATE

March 14, 1983

(This space for Federal or State office use)

PERMIT NO.

APPROVAL DATE

APPROVED BY

TITLE

CONDITIONS OF APPROVAL, IF ANY:

*written**ah 2*APPROVED  
AS AMENDED

APR 28 1983

*James F. Sims*  
JAMES F. SIMS

DISTRICT ENGINEER

*Acting Area Manager*

## OIL CONSERVATION DIVISION

STATE OF NEW MEXICO  
ENERGY AND MINERALS DEPARTMENTP. O. BOX 2088  
SANTA FE, NEW MEXICO 87501Form C-107  
Revised 10-1-72

All distances must be from the outer boundaries of the Section.

Operator <b>SOUTHLAND ROYALTY COMPANY</b>			Lease <b>REID</b>		Well No. <b>26</b>
Unit Letter <b>N</b>	Section <b>7</b>	Township <b>28N</b>	Range <b>9W</b>	County <b>San Juan</b>	
Actual Footage Location of Well: <b>915</b> feet from the <b>South</b> line and <b>1210</b> feet from the <b>West</b> line					
Ground Level Elev. <b>5740' GL</b>	Producing Formation <b>Chacra</b>		Pool <b>Otero Ext.</b>	Dedicated Acreage: <b>122.31</b> Acres	

1. Outline the acreage dedicated to the subject well by colored pencil or hatchure marks on the plat below.
2. If more than one lease is dedicated to the well, outline each and identify the ownership thereof (both as to working interest and royalty).
3. If more than one lease of different ownership is dedicated to the well, have the interests of all owners been consolidated by communitization, unitization, force-pooling, etc?

☐ Yes ☐ No If answer is "yes," type of consolidation \_\_\_\_\_

If answer is "no," list the owners and tract descriptions which have actually been consolidated. (Use reverse side of this form if necessary.) \_\_\_\_\_

No allowable will be assigned to the well until all interests have been consolidated (by communitization, unitization, forced-pooling, or otherwise) or until a non-standard unit, eliminating such interests, has been approved by the Commission.

RECEIVED

MAR 16 1983

U. S. GEOLOGICAL SURVEY  
FARMINGTON, N. M.

RECEIVED

MAY 2 1983

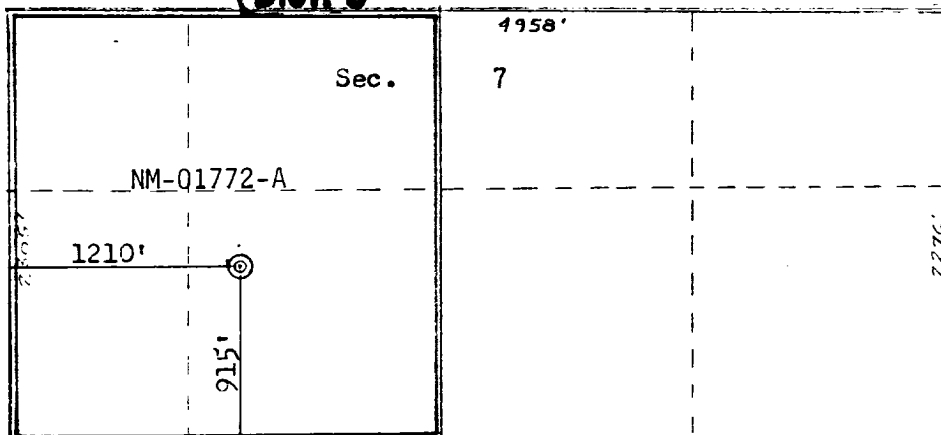
OIL CON. DIV.  
DIST. 3

Scale: 1"=1000'

## CERTIFICATION

I hereby certify that the information contained herein is true and complete to the best of my knowledge and belief.

*R. E. Fielder*  
Name

R. E. Fielder  
Position

District Engineer  
Company

Southland Royalty Company  
Date

March 14, 1983

I hereby certify that the well location shown on this plat was plotted from field notes of actual surveys made by me or under my supervision, and that the same is true and correct to the best of my knowledge and belief.

Date Surveyed  
February 25, 1983

Registered Professional Engineer  
and Land Surveyor

*Fred B. Kerr Jr.*  
Fred B. Kerr Jr.

Certificate No.  
3950

