

UNITED STATES
DEPARTMENT OF THE INTERIOR
BUREAU OF LAND MANAGEMENT

APPLICATION FOR PERMIT TO DRILL, DEEPEN, OR PLUG BACK

1a. TYPE OF WORK

DRILL ☒

DEEPEN ☐

PLUG BACK ☐

b. TYPE OF WELL

OIL
WELL ☐

GAS
WELL ☒

OTHER

SINGLE
ZONE ☒

MULTIPLE
ZONE ☐

2. NAME OF OPERATOR

KOCH EXPLORATION COMPANY

3. ADDRESS OF OPERATOR

P. O. Box 2256, Wichita, KS 67201

4. LOCATION OF WELL (Report location clearly and in accordance with any State requirements.)

At surface

1610/s 685' FEL & 1610' FSL NE SE

At proposed prod. zone

RECEIVED
MAY 02 1984
BUREAU OF LAND MANAGEMENT
FARMINGTON RESOURCE AREA

14. DISTANCE IN MILES AND DIRECTION FROM NEAREST TOWN OR POST OFFICE

15 miles south and east of Bloomfield, New Mexico

15. DISTANCE FROM PROPOSED*

LOCATION TO NEAREST

PROPERTY OR LEASE LINE, FT.

(Also to nearest drlg. unit line, if any)

685'

16. NO. OF ACRES IN LEASE

320

17. NO. OF ACRES ASSIGNED

TO THIS WELL

S 100 320

18. DISTANCE FROM PROPOSED LOCATION*

TO NEAREST WELL, DRILLING, COMPLETED,
OR APPLIED FOR, ON THIS LEASE, FT.

3495'

19. PROPOSED DEPTH

6800'

20. ROTARY OR CABLE TOOLS

Rotary

21. ELEVATIONS (Show whether DF, RT, GR, etc.)

GR 5822'

DRILLING OPERATIONS AUTHORIZED ARE
SUBJECT TO COMPLIANCE WITH ATTACHED
"GENERAL DRAINAGE AND CEMENTING PROGRAM
"GENERAL REQUIREMENTS"

22. APPROX. DATE WORK WILL START*

May 28, 1984

23.

This action is subject to administrative
appeal pursuant to 30 CFR 290.
QUANTITY OF CEMENT

SIZE OF HOLE	SIZE OF CASING	WEIGHT PER FOOT	SETTING DEPTH	
13-3/4	10-3/4	40.5#	250'	250 sx
9-7/8	7-5/8	26.4#	2500'	350 sx lite & 150 sx class "B"
6-3/4	5-1/2	15.5#	6800'	200 sx lite, 135 sx poz & 135 sx class "B"

- Set 10-3/4" 40.5# K-55 ST&C casing @ 200'. Pressure test to 1,000 PSI, cmt w/250 sx, circ. cmt to surface. Wait on cement 24 hours.
- Drill w/native mud to 1800'. Mud up w/Gel-Benex type mud and drill through the Picture Cliff formation (2252-2500'). Set 7-5/8" 26.4# K-55 ST&C csg @ 2865'. Cement w/enough cement to cover the Ojo Alamo and Picture Cliff formations. Wait on cement 12 hours. Run temp. survey for cmt top and pressure test 7-5/8" csg to 3000 PSI before drilling out.
- A double pipe and blind ram B.O.P. will be used. B.O.P. will be checked each tower & blind rams every trip.
- Drill 6-3/4" hole w/gas to total depth. Set and cmt 5-1/2" K-55 15.5# casing from T.D. to surface. Enough cmt will be used to reach intermediate casing (2500').
- A Bond Log will be run before perforating well.
- Wellhead equipment will consist of 3000 PSI working pressure.
- Anticipated bottom hole pressure @ total depth max. 2500 PSI. No abnormal pressures anticipated.

Continued on Page 2.....

IN ABOVE SPACE DESCRIBE PROPOSED PROGRAM: If proposal is to deepen or plug back, give data on present productive zone and proposed new productive zone. If proposal is to drill or deepen directionally, give pertinent data on subsurface locations and measured and true vertical depths. Give blowout preventer program, if any.

24.

SIGNED

Oswald L. Schmidt
O. L. Schmidt

TITLE VP Prod. Operations

(This space for Federal or State office use)

PERMIT NO.

RECEIVED

APPROVAL DATE

APPROVED BY

CONDITIONS OF APPROVAL

JUN 14 1984

TITLE

OIL CON. DIV.
DIST. 3

NMOCC

*See Instructions On Reverse Side

APPROVED

AS AMENDED

JUN 13 1984

AREA MANAGER
FARMINGTON RESOURCE AREA

OIL CONSERVATION DIVISION

STATE OF NEW MEXICO
ENERGY AND MINERALS DEPARTMENTP. O. BOX 2088
SANTA FE, NEW MEXICO 87501Form C-102
Revised 10-1-72

All distances must be from the outer boundaries of the Section.

Operator KOCH EXPLORATION COMPANY		Lease DRYDEN		Well No. 2E
Unit Letter I	Section 22	Township 28N	Range 8W	County San Juan
Actual Footage Location of Well: 1610 feet from the South line and 685 feet from the East line				
Ground Level Elev. 5822	Producing Formation Dakota	Pool Basin Dakota	Dedicated Acreage: 5/320 Acres	

1. Outline the acreage dedicated to the subject well by colored pencil or hatchure marks on the plat below.
2. If more than one lease is dedicated to the well, outline each and identify the ownership thereof (both as to working interest and royalty).
3. If more than one lease of different ownership is dedicated to the well, have the interests of all owners been consolidated by communitization, unitization, force-pooling, etc?

☐ Yes ☐ No If answer is "yes," type of consolidation _____

If answer is "no," list the owners and tract descriptions which have actually been consolidated. (Use reverse side of this form if necessary.) _____

No allowable will be assigned to the well until all interests have been consolidated (by communitization, unitization, forced-pooling, or otherwise) or until a non-standard unit, eliminating such interests, has been approved by the Commission.

Sec.		RECEIVED MAY 02 1984	
Dryden No. 2		BUREAU OF LAND AREA	
RECEIVED JUN 14 1984 OIL CON. DIV. DIST. 3		1610'	

Scale: 1"=1000'

CERTIFICATION

I hereby certify that the information contained herein is true and complete to the best of my knowledge and belief.

Oswald L. Schmidt

Name

O. L. Schmidt

Position

Vice Pres. Prod. Operations

Company

KOCH EXPLORATION COMPANY

Date

April 9, 1984

I hereby certify that the well location shown on this plat was plotted from field notes of actual surveys made by me or under my supervision, and that the same is true and correct to the best of my knowledge and belief.

Date Surveyed

April 9, 1984

Registered Professional Engineer
and Land Surveyor*Fred B. Kery Jr.*
Fred B. Kery Jr.

Certificate No.

3950

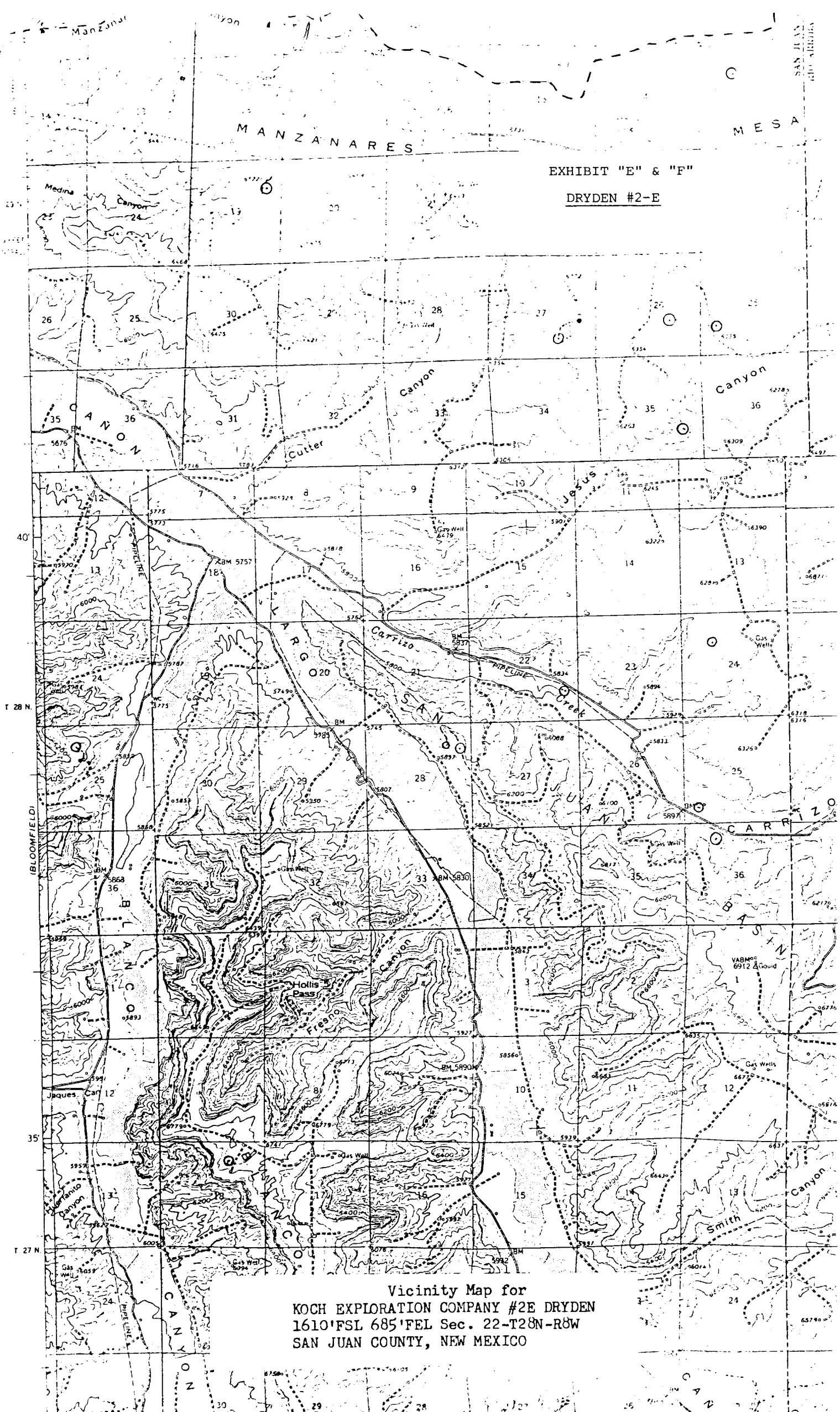

EXHIBIT "E" & "F"
DRYDEN #2-E

Vicinity Map for
KOCH EXPLORATION COMPANY #2E DRYDEN
1610'FSL 685'FEL Sec. 22-T28N-R8W
SAN JUAN COUNTY, NEW MEXICO