

UNITED STATES
DEPARTMENT OF THE INTERIOR
BUREAU OF LAND MANAGEMENT

SUBMIT IN TRIPPLICATE*
(Other instructions on re-
verse side)

Budget Bureau No. 1004-0135
Expires August 31, 1985

SUNDRY NOTICES AND REPORTS ON WELLS

(Do not use this form for proposals to drill or to deepen or plug back to a different reservoir.
Use "APPLICATION FOR PERMIT—" for such proposals.)

5. LEASE DESIGNATION AND SERIAL NO.

SF-078902A

6. IF INDIAN, ALLOTTEE OR TRIBE NAME

7. UNIT AGREEMENT NAME

Gallegos Canyon Unit

8. FARM OR LEASE NAME

9. WELL NO.

183E

10. FIELD AND POOL, OR WILDCAT

Basin Dakota

11. SEC., T., R., M., OR BLK. AND
SURVEY OR AREA

NE/NW Sec. 9, T27N, R12W

12. COUNTY OR PARISH

San Juan

13. STATE

NM

1. OIL WELL ☒ GAS WELL ☐ OTHER (change from gas to oil well)

2. NAME OF OPERATOR

Amoco Production Company

3. ADDRESS OF OPERATOR

501 Airport Drive, Farmington, NM 87401

4. LOCATION OF WELL (Report location clearly and in accordance with any State requirements.*

See also space 17 below.)

At surface

660' FNL x 1570' FWL

14. PERMIT NO.

15. ELEVATIONS (Show whether DP, RT, GR, etc.)

16.

Check Appropriate Box To Indicate Nature of Notice, Report, or Other Data

NOTICE OF INTENTION TO:

TEST WATER SHUT-OFF

FRACTURE TREAT

SHOOT OR ACIDIZE

REPAIR WELL

(Other)

PULL OR ALTER CASING

MULTIPLE COMPLETE

ABANDON*

CHANGE PLANS

X

SUBSEQUENT REPORT OF:

WATER SHUT-OFF

FRACTURE TREATMENT

SHOOTING OR ACIDIZING

(Other)

REPAIRING WELL

ALTERING CASING

ABANDONMENT*

(NOTE: Report results of multiple completion on Well
Completion or Recompletion Report and Log form.)

17. DESCRIBE PROPOSED OR COMPLETED OPERATIONS (Clearly state all pertinent details, and give pertinent dates, including estimated date of starting any proposed work. If well is directionally drilled, give subsurface locations and measured and true vertical depths for all markers and zones pertinent to this work.)*

Amoco Production Company requests approval to multiple complete in the Wildcat Gallup formation with 40 dedicated acres as well as in the Basin Dakota formation with 320 dedicated acres. An application for an unorthodox location for the Gallup is forthcoming.

18. I hereby certify that the foregoing is true and correct

SIGNED

Original Signed By

B. D. Shaw

TITLE Administrative Supervisor

(This space for Federal or State office use)

APPROVED BY

CONDITIONS OF APPROVAL, IF ANY:

TITLE

APPROVED

DATE 12/4/84

DEC 11 1984

DATE

/s/ Stan McKee
AREA MANAGER
FARMINGTON RESURFACED AREA

*See Instructions on Reverse Side

All distances must be from the outer boundaries of the Section.

Operator AMOCO PRODUCTION COMPANY			Lease GALLEGOS CANYON UNIT		Well No. 183E
Unit Letter C	Section 9	Township 27N	Range 12W	County San Juan	
Actual Footage Location of Well: 660 feet from the North line and 1570 feet from the West line					
Ground Level Elev: 5739	Producing Formation Basin Dakota + WC Gallup		Pool Basin Dakota + Wildcat Gallup		Dedicated Acreage 320/40 Acres
<p>1. Outline the acreage dedicated to the subject well by colored pencil or hatchure marks on the plat below.</p> <p>2. If more than one lease is dedicated to the well, outline each and identify the ownership thereof (both as to working interest and royalty).</p> <p>3. If more than one lease of different ownership is dedicated to the well, have the interests of all owners been consolidated by communitization, unitization, force-pooling, etc?</p> <p><input checked="" type="checkbox"/> Yes <input type="checkbox"/> No If answer is "yes," type of consolidation <u>Unitized</u></p> <p>If answer is "no," list the owners and tract descriptions which have actually been consolidated. (Use reverse side of this form if necessary.)</p> <p>No allowable will be assigned to the well until all interests have been consolidated (by communitization, unitization, forced-pooling, or otherwise) or until a non-standard unit, eliminating such interests, has been approved by the Commission.</p>					

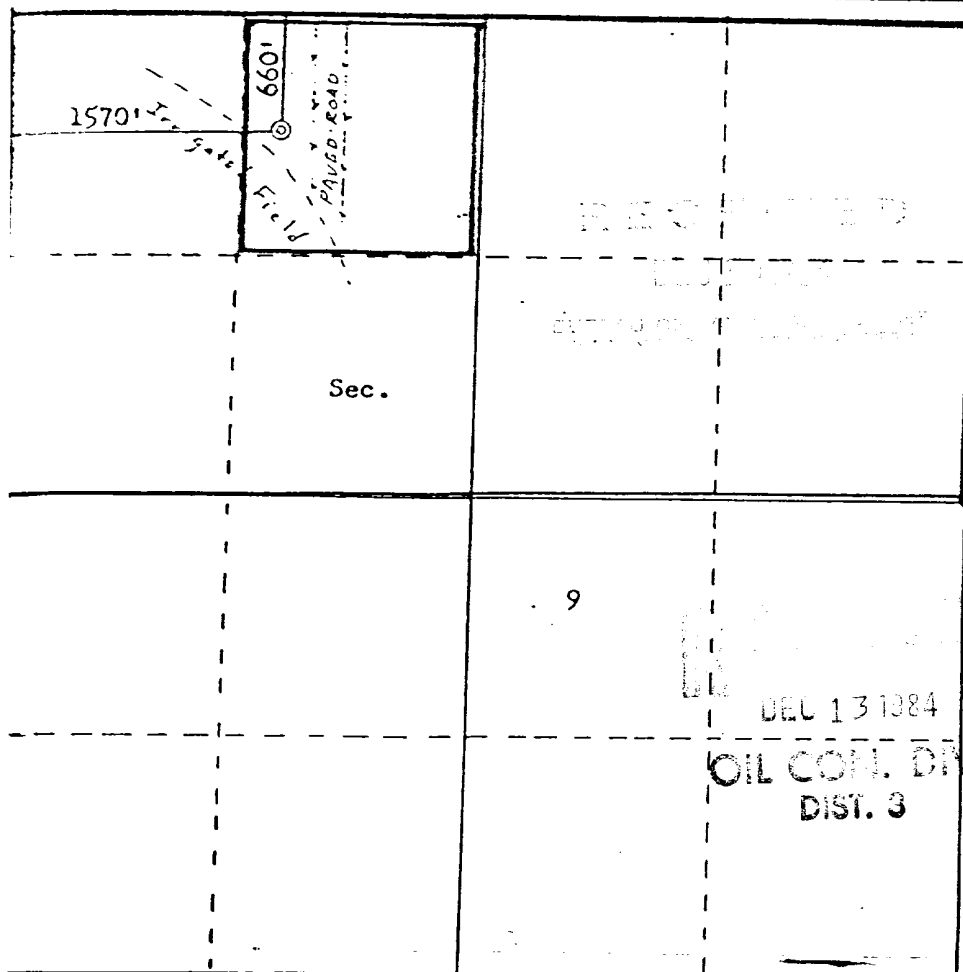

Scale: 1"=1000'

CERTIFICATION	
I hereby certify that the information contained herein is true and complete to the best of my knowledge and belief.	
Original Signed By B. D. Shaw	
Name	B. D. Shaw
Position	Administrative Supervisor
Company	Amoco Production Company
Date	May 31, 1984
I hereby certify that the well location shown on this plat was plotted from field notes of actual surveys made by me or under my supervision, and that the same is true and correct to the best of my knowledge and belief.	
Date Surveyed	January 30, 1984
Registered Professional Engineer and Land Surveyor	Fred B. Kern Jr.
Certificate No.	3950