

UNITED STATES
DEPARTMENT OF THE INTERIOR
BUREAU OF LAND MANAGEMENT

FORM APPROVED
Budget Bureau No. 1004-0135
Expires: March 31, 1993

SUNDRY NOTICES AND REPORTS ON WELLS

Do not use this form for proposals to drill or to deepen or reentry to a different reservoir.

Use "APPLICATION FOR PERMIT - " for such proposals

RECEIVED
BLM

NOV 19 2 01 PM '98
OIL CON. DIV.

5. Lease Designation and Serial No.

SF-078902A

6. Well Name, Allottee or Tribe Name

7. If Other CA, Agreement Designation

8. Well Name and No.

Gallegos Canyon Unit 183E

9. API Well No.

3004526027

10. Field and Pool, or Exploratory Area

Basin Dakota

11. County or Parish, State

SAN JUAN NEW MEXICO

1. Type of Well
☐ Oil Well ☒ Gas Well ☐ Other

2. Name of Operator

AMOCO PRODUCTION COMPANY

Attention:

Gail M. Jefferson

3. Address and Telephone No.

P.O. BOX 800 DENVER, COLORADO 80201

(303) 830-6157

4. Location of Well (Footage, Sec., T., R., M., or Survey Description)

660' FNL

1570' FWL

Sec. 9

T 27N

R 12W

UNIT C

CHECK APPROPRIATE BOX(S) TO INDICATE NATURE OF NOTICE, REPORT, OR OTHER DATA

TYPE OF SUBMISSION

TYPE OF ACTION

- ☒ Notice of Intent
☐ Subsequent Report
☐ Final Abandonment Notice

- ☐ Abandonment
☐ Recompletion
☐ Plugging Back
☐ Casing Repair
☐ Altering Casing
☒ Other Recompletion

- ☐ Change of Plans
☐ New Construction
☐ Non-Routine Fracturing
☐ Water Shut-Off
☐ Conversion to Injection
☐ Dispose Water

(Note: Report results of multiple completion on Well Completion or Recompletion Report and Log form.)

13. Describe Proposed or Completed Operations (Clearly state all pertinent details, and give pertinent dates, including estimated date of starting any proposed work. If well is directionally drilled, give subsurface locations and measured and true vertical depths for all markers and zones pertinent to this work.)*

Amoco Production Company requests permission to recomplete this well to the Fruitland Coal and continue temporarily abandonment of the Dakota per the attached procedures.

If you have any technical questions please contact Wayne Peterson at (303) 830-4332 or Gail Jefferson for any administrative concerns.

RECEIVED
NOV 19 1998
OIL CON. DIV.
DIST. 3

14. I hereby certify that the foregoing is true and correct

Signed

Gail M. Jefferson

Title

Sr. Admin. Staff Asst.

Date

10-29-1998

(This space for Federal or State office use)

Approved by

Conditions of approval, if any:

Jim Jatab

Title

11/17/98 Acting Team Lead

Date

11/17/98

Title 18 U.S.C. Section 1001, makes it a crime for any person knowingly and willfully to make to any department or agency of the United States any false, fictitious, or fraudulent statements or representations as to any matter within its jurisdiction.

* See Instructions on Reverse Side

(Signature)

NMOC

✓

GCU Well Work Procedure

GCU 183E

Date:

9/29/98

Objective:

Recomplete from Dakota to Fruitland Coal. Well is already TA in Dakota. BLM demand letter deadline 12/98.

Pertinent Information:

Location: NW9-27N-12W
County: San Juan
State: New Mexico
Lease:
Well Flac: 84274701

Horizon: Dak to FC
API #: 30-045-26027
Engr: Wayne Peterson
Phone: H--(303)795-0171
W-(303)830-4332

-
1. Check anchors. MIRUSU.
 2. Check and record tubing, casing and bradenhead pressures.
 3. Blow down wellhead, kill if necessary.
 4. Nipple down wellhead, nipple up and pressure test BOP.
 5. TOH with tubing.
 6. Log Fruitland Coal interval with CBL/GR/CCL to insure zonal isolation across FC.
NOTE: ONCE THESE LOGS ARE RUN CONTACT BILL PELZMANN IN THE DENVER OFFICE 1-303-830-6150 FOR THE CORRECT PERFORATION INTERVAL. THERE IS A 24' DEPTH SHIFT PROBLEM BETWEEN THE RESISTIVITY AND POROSITY LOGS. PERFS ARE EXPECTED TO BE EITHER 1340-1358 OR 1316-1334.
 7. Perforate the following interval with 4JSPF, 120 deg. phasing: SEE ABOVE - WILL PERF A TOTAL OF APPROXIMATELY 18'.
 8. Fracture stimulate down casing according to schedule 'A'.
 9. CO to PBTD at 2820.
 10. TIH with 2 3/8" tbg, rods, and pump. Land 1 joint below perfs if possible.
 11. RDMO. Hook up to pumping unit and well head compressor.
-

KB: 5752'
GL: 5739'

9 5/5" @ 315'

2820
Cmt plug from 2820-2920
2920

4871
Cmt plug from 4871-4971
4971

5820 - Cmt plug from 5820-70
CIBP @ 5820

Perforations:
5900' - 5912'

5942' - 5998'

PBD - 6064'
TD - 6110'

PBD - 6064'
7" @ 6110'

Amoco Production Company

SCALE

GCU 183E

ORG.
NO

District I
PO Box 1980, Hobbs, NM 88241-1980
District II
311 South First, Artesia, NM 88210
District III
1000 Rio Brazos Rd., Aztec, NM 87410
District IV
2040 South Pacheco, Santa Fe, NM 87505

State of New Mexico
Energy, Minerals & Natural Resources Department

OIL CONSERVATION DIVISION
2040 South Pacheco
Santa Fe, NM 87505

HOLD C-104
FOR USE

Form C-102
Revised October 18, 1994
Instructions on back
Submit to Appropriate District Office
State Lease - 4 Copies
Fee Lease - 3 Copies

RECEIVED
BLM
OCT-2 PM 2:04

☐ AMENDED REPORT

WELL LOCATION AND ACREAGE DEDICATION PLAT

* API Number 3004526027		* Pool Code 71629	* Pool Name Basin Fruitland Coal	
* Property Code 000570	* Property Name Gallegos Canyon Unit			* Well Number 183E
* OGRID No. 000778	* Operator Name Amoco Production Company			* Elevation 5752'

¹⁰ Surface Location

UL or lot no.	Section	Township	Range	Lot Idn	Feet from the	North/South line	Feet from the	East/West line	County
C	9	27N	12W		660	North	1570	West	San Juan

¹¹ Bottom Hole Location If Different From Surface

UL or lot no.	Section	Township	Range	Lot Idn	Feet from the	North/South line	Feet from the	East/West line	County

¹² Dedicated Acres 320.00	¹³ Joint or Infill	¹⁴ Consolidation Code	¹⁵ Order No.
-----------------------------------------	-------------------------------	----------------------------------	-------------------------

NO ALLOWABLE WILL BE ASSIGNED TO THIS COMPLETION UNTIL ALL INTERESTS HAVE BEEN CONSOLIDATED
OR A NON-STANDARD UNIT HAS BEEN APPROVED BY THE DIVISION

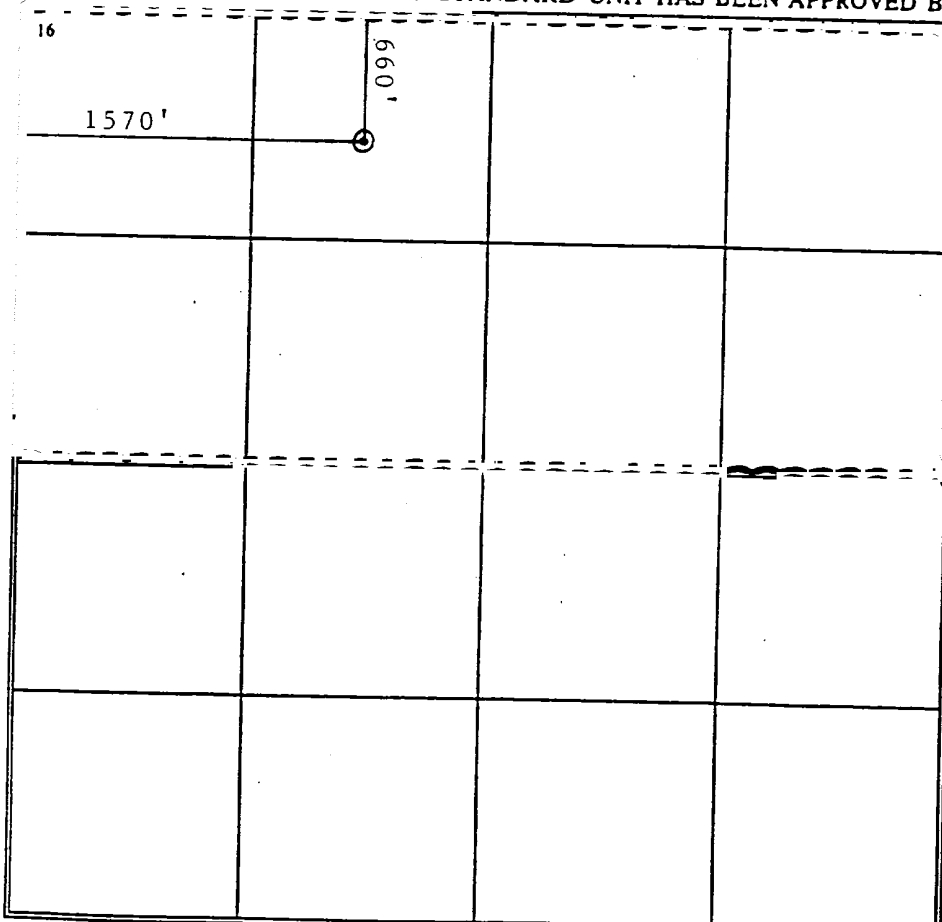

¹⁷ OPERATOR CERTIFICATION

I hereby certify that the information contained herein is
true and complete to the best of my knowledge and belief

Gail M. Jefferson
Signature

Gail M. Jefferson
Printed Name

Sr. Admin. Staff Asst.
Title

October 29, 1998
Date

¹⁸ SURVEYOR CERTIFICATION

I hereby certify that the well location shown on this plat
was plotted from field notes of actual surveys made by
me or under my supervision, and that the same is true
and correct to the best of my belief.

January 30, 1984
Date of Survey

Signature and Seal of Professional Surveyor:

Fred B. Kerr, Jr.

3950

Certificate Number