

UNITED STATES
DEPARTMENT OF THE INTERIOR
BUREAU OF LAND MANAGEMENT

APPLICATION FOR PERMIT TO DRILL, DEEPEN, OR PLUG BACK

1a. TYPE OF WORK
DRILL ☒ DEEPEN ☐ PLUG BACK ☐
b. TYPE OF WELL
OIL WELL ☐ GAS WELL ☒ OTHER ☐ SINGLE ZONE ☐ MULTIPLE ZONE ☐

2. NAME OF OPERATOR
SUPERIOR OIL COMPANY

3. ADDRESS OF OPERATOR
P.O. DRAWER 'G', CORTEZ, COLORADO 81321

4. LOCATION OF WELL (Report location clearly and in accordance with any State requirements.)*
At surface
970' FSL, 1190' FWL, SEC. 11, T27N, R9W (SWSW)
At proposed prod. zone
Same as above

14. DISTANCE IN MILES AND DIRECTION FROM NEAREST TOWN OR POST OFFICE*
12-1/2 miles Southeast of Blanco, New Mexico

15. DISTANCE FROM PROPOSED*
LOCATION TO NEAREST
PROPERTY OR LEASE LINE, FT.
(Also to nearest drilg. unit line, if any) 970'

18. DISTANCE FROM PROPOSED LOCATION*
TO NEAREST WELL, DRILLING, COMPLETED,
OR APPLIED FOR, ON THIS LEASE, FT. 3128'

21. ELEVATIONS (Show whether DF, RT, GR, etc.)
6018' ungraded ground level

23. PROPOSED CASING AND CEMENTING PROGRAM

SIZE OF HOLE	SIZE OF CASING	WEIGHT PER FOOT	SETTING DEPTH
17-1/2"	13-3/8"	54.5#	40'
12-1/4"	8-5/8"	24#	300'
7-7/8"	5-1/2"	15.5#	6800'

5. LEASE DESIGNATION AND SERIAL NO
1-149-IND.-8464
6. IF INDIAN, ALLOTTEE OR TRIBE NAME
JENNIE BUNNY, etal (Navajo)
7. UNIT AGREEMENT NAME
N/A
8. FARM OR LEASE NAME
BUNNY, etal
9. WELL NO.
#2E
10. FIELD AND POOL, OR WILDCAT
BASIN DAKOTA FIELD
11. SEC., T., R., M., OR BLK.
AND SURVEY OR AREA
M SEC. 11, T27N, R9W, NMPM
12. COUNTY OR PARISH
SAN JUAN
13. STATE
NM

17. NO. OF ACRES ASSIGNED
TO THIS WELL 160.5

20. ROTARY OR CABLE TOOLS
Rotary

22. APPROX. DATE WORK WILL START**
June 30, 1984

This action is subject to administrative
appeal pursuant to 30 CFR 290.

QUANTITY OF CEMENT
Redimix to surface
250 sx Class 'B' to surface
1st stage: 1200 sx light above
Mesa Verde.
2nd stage: 700 sx of 50/50 pozmix
above Ojo Alamo through
DV tool set at top of
Chacra.

Superior Oil proposes to drill a well to 6800' to test the Dakota formation. If
productive, we will run casing and complete. If dry, we will plug and abandon as
per BLM, BIA and State of New Mexico regulations.

RECEIVED
AUG 01 1984
OIL CON. DIV.
DIST. 3

RECEIVED
JUN 29 1984

BUREAU OF LAND MANAGEMENT
FARMINGTON RESOURCE AREA

IN ABOVE SPACE DESCRIBE PROPOSED PROGRAM: If proposal is to deepen or plug back, give data on present productive zone and proposed new productive
zone. If proposal is to drill or deepen (irrigation), give pertinent data on subsurface locations and measured and true vertical depths. Give blowout
prevention program, if any.

24. SIGNED Gregg A. Tripp TITLE Engineer
(This space for Federal or State office use)

PERMIT NO. APPROVAL DATE

APPROVED BY TITLE

CONDITIONS OF APPROVAL, IF ANY:

ok

NMCC

*See Instructions On Reverse Side

6-20-84
APPROVED
AS AMENDED
JUL 30 1984
DATE
(BGD.) MAT MILLENBACH
AREA MANAGER
FARMINGTON RESOURCE AREA

OIL CONSERVATION DIVISION

P. O. BOX 2088

Form C-102
Revised 10-1-78STATE OF NEW MEXICO
ENERGY AND MINERALS DEPARTMENT

SANTA FE, NEW MEXICO 87501

All distances must be from the outer boundaries of the Section.

Operator Superior Oil Company		Lease Bunny, et al		Well No. 2-E
Unit Letter M	Section 11	Township 27 North	Range 9 West	County San Juan
Actual Footage Location of Well: 970 feet from the South line and 1190 feet from the West line				
Ground Level Elev. 6018	Producing Formation L. S.	Pool	Dedicated Acreage: 1 Acres	

1. Outline the acreage dedicated to the subject well by colored pencil or hatchure marks on the plat below.

2. If more than one lease is dedicated to the well, outline each and identify the ownership thereof (both as to working interest and royalty).

3. If more than one lease of different ownership is dedicated to the well, have the interests of all owners been consolidated by communitization, unitization, force-pooling, etc?

☐ Yes ☐ No If answer is "yes," type of consolidation _____

If answer is "no," list the owners and tract descriptions which have actually been consolidated. (Use reverse side of this form if necessary.) _____

No allowable will be assigned to the well until all interests have been consolidated (by communitization, unitization, forced-pooling, or otherwise) or until a non-standard unit, eliminating such interests, has been approved by the Division.

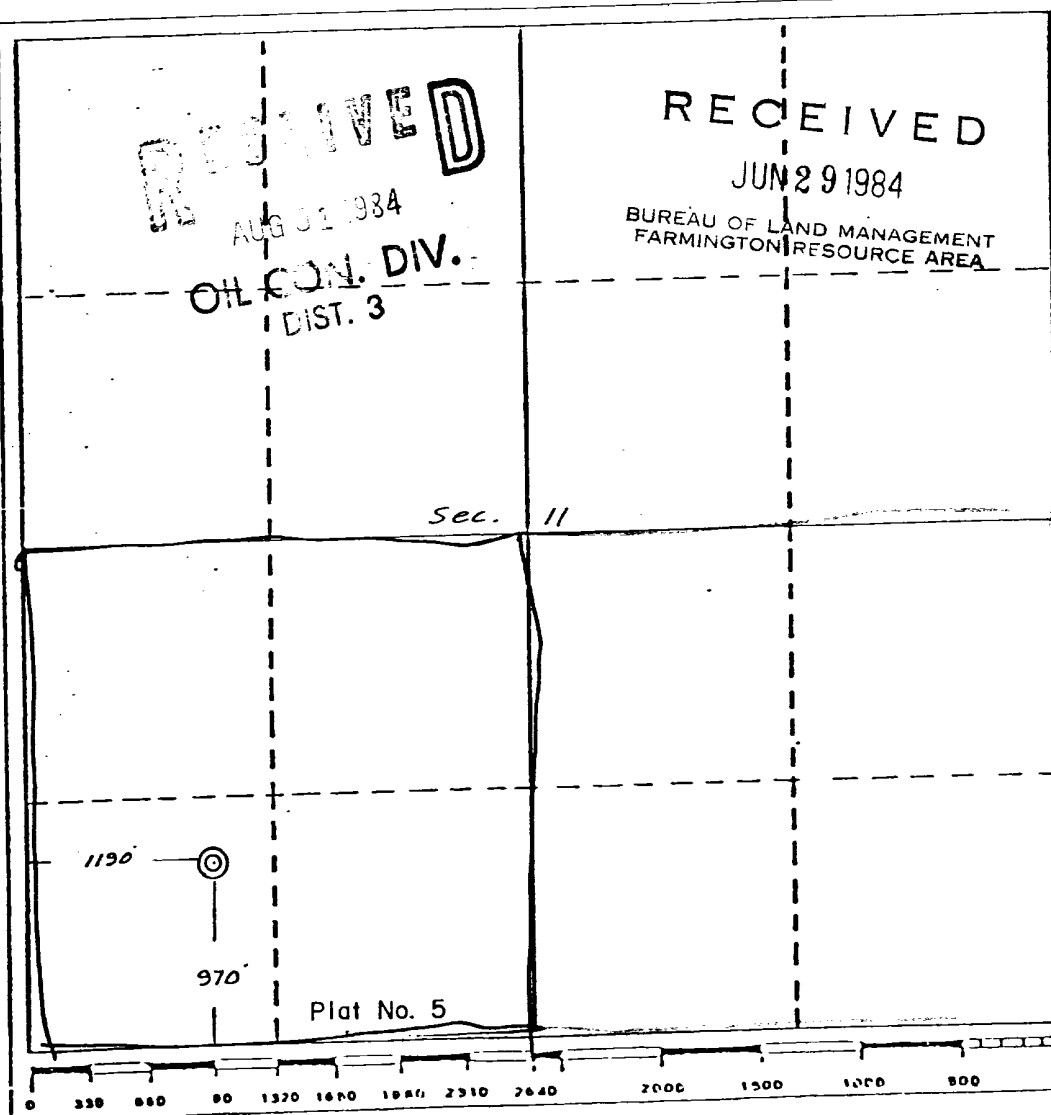

CERTIFICATION

I hereby certify that the information contained herein is true and complete to the best of my knowledge and belief.

Name _____

Position _____

Company _____

Date _____

I certify that the location shown in this plat was obtained from field notes of 1979 by me or under my supervision, and that the same is true and correct to the best of my knowledge and belief.

Date Surveyed

April 24, 1984

Registered Professional Engineer
and/or Land Surveyor
Certificate No. 5979

Edgar L. Risenhoover, L.



**PROPOSED DRILLING SITE
& FACILITIES**

Bunny, etal 2E

Sec. 11, T. 27 N. - R. 9 W.

970' ESL - 1190' FWL

San Juan County, New Mexico

DRAWN BY: JES

DATE 5-14-84

SCALE 1" = 2000'

SUPERIOR OIL

WESTERN
DIVISION

Plat No. 2