

UNITED STATES
DEPARTMENT OF THE INTERIOR
BUREAU OF LAND MANAGEMENT

SUBMIT IN DUPLICATE*

(See other In-
structions on
reverse side)

Subject Bureau No. 1004-013/
Expires August 31, 1985

WELL COMPLETION OR RECOMPLETION REPORT AND LOG *

1a. TYPE OF WELL: OIL WELL ☐ GAS WELL ☒ DRY ☐ 89 NOV 22 AM 11:27

b. TYPE OF COMPLETION: NEW WELL ☒ WORK OVER ☐ DEEP-EN ☐ PLUG BACK ☐ DIFF. ENVIR. ☐ FARMINGTON RESERVE AREA
FARMINGTON, NEW MEXICO

2. NAME OF OPERATOR
Hixon Development Company

3. ADDRESS OF OPERATOR
P.O. Box 2810, Farmington, New Mexico 87499

4. LOCATION OF WELL (Report location clearly and in accordance with any State requirements)*
At surface 1450' FSL, 1190' FWL, Section 35, T27N, R12W
At top prod. interval reported below
At total depth

14. PERMIT NO. DATE ISSUED

5. LEASE DESIGNATION AND SERIAL NO.
NM 57579

6. IF INDIAN, ALLOTTEE OR TRIBE NAME

7. UNIT AGREEMENT NAME

8. FARM OR LEASE NAME
Joe Whitney

9. WELL NO.
1

10. FIELD AND POOL, OR WILDCAT
Gallegos Fruitland P.C.

11. SEC., T., R., M., OR BLOCK AND SURVEY OR AREA
Sec. 35, T27N, R12W

12. COUNTY OR PARISH
San Juan

13. STATE
New Mexico

15. DATE SPUDDED 10-15-88 16. DATE T.D. REACHED 10-19-88 17. DATE COMPL. (Ready to prod.) 11-17-88 18. ELEVATIONS (DF, RKB, RT, GR, ETC.)* 5883' GLE 19. ELEV. CASINGHEAD

20. TOTAL DEPTH, MD & TVD 1470' KB 21. PLUG BACK T.D., MD & TVD 1304' KB 22. IF MULTIPLE COMPL., HOW MANY* N/A 23. INTERVALS DRILLED BY → X 24. PRODUCING INTERVAL(S) OF THIS COMPLETION—TOP, BOTTOM, NAME (MD AND TVD)* 984'-1004' KB, 1169'-1179' KB, 1216'-1225' KB, 1246'-1253' KB 25. WAS DIRECTIONAL SURVEY MADE Yes

26. TYPE ELECTRIC AND OTHER LOGS RUN
Induction Log with Gamma Ray and Compensated Density-Neutron Logs 27. WAS WELL CORED No

28. CASING RECORD (Report all strings set in well)

CASING SIZE	WEIGHT, LB./FT.	DEPTH SET (MD)	HOLE SIZE	CEMENTING RECORD	AMOUNT PULLED
7"	20#	128.80' KB	8-3/4"	See Attached Exhibit "A"	
4-1/2"	11.6#	884.46' KB	6-1/4"	See Attached Exhibit "A"	
4-1/2"	10.5#	1323.26' KB	6-1/4"	See Attached Exhibit "A"	

29. LINER RECORD

SIZE	TOP (MD)	BOTTOM (MD)	SACKS CEMENT*	SCREEN (MD)

30. TUBING RECORD

SIZE	DEPTH SET (MD)	PACKER SET (MD)
2-3/8"	1039.11' KB	1039.11' KB

31. PERFORATION RECORD (Interval, size and number)

Interval	Size	Number
984'-1004' KB	0.40"	41 holes
1169'-1179' KB	0.40"	21 holes
1216'-1225' KB	0.40"	19 holes
1246'-1253' KB	0.40"	15 holes

32. ACID, SHOT, FRACTURE, CEMENT SQUEEZE, ETC.

DEPTH INTERVAL (MD)	AMOUNT AND KIND OF MATERIAL USED
984'-1004' KB	See Attached Exhibit "B"
1169'-1179' KB	
1216'-1225' KB	
1246'-1253' KB	

33.* PRODUCTION

DATE FIRST PRODUCTION 11-17-88 PRODUCTION METHOD (Flowing, gas lift, pumping—size and type of pump) Flowing WELL STATUS (Producing or shut-in) Shut in

DATE OF TEST 11-17-88 HOURS TESTED 24 CHOKES SIZE 3/4 PROD'N. FOR TEST PERIOD → OIL—BSL. GAS—MCF. 203 WATER—BSL. GAS-OIL RATIO

FLOW. TUBING PRESS. 14 CASING PRESSURE 55 CALCULATED 24-HOUR RATE → OIL—BSL. GAS—MCF. 203 WATER—BSL. OIL GRAVITY-API (CORR.)

34. DISPOSITION OF GAS (Sold, used for fuel, vented, etc.)
To be sold - waiting on pipeline hookup

35. LIST OF ATTACHMENTS

36. I hereby certify that the foregoing and attached information is complete and correct as determined from all available records

SIGNED Aldrich L. Kuchera TITLE President/CEO DATE November 22, 1988

*(See Instructions and Spaces for Additional Data on Reverse Side)

Title 18 U.S.C. Section 1001, makes it a crime for any person knowingly and willfully to make to any department or agency of the United States any false, fictitious or fraudulent statements or representations as to any matter within its jurisdiction.

37. SUMMARY OF POROUS ZONES: (Show all important zones of porosity and contents thereof; cored intervals; and all drill-stem, tests, including depth interval tested, cushion used, time tool open, flowing and shut-in pressures, and recoveries):

38. GEOLOGIC MARKERS

FORMATION	TOP	BOTTOM	DESCRIPTION, CONTENTS, ETC.	NAME	TOP	
					MEAS. DEPTH	TRUE VERT. DEPTH
Ojo Alamo	141'	273'				
Kirtland	273'	976'				
Fruitland	976'	1244'				
Pictured Cliffs	1244'	Unknown				

OIL CON. DIV
DIST. 3

HIKON DEVELOPMENT COMPANY
JOE WHITNEY WELL NO. 1
1450' FSL, 1190' FWL
SECTION 35, T27N, R12W
SAN JUAN COUNTY, NEW MEXICO
COMPLETION REPORT
EXHIBIT "A"

CEMENTING RECORD

- Surface Casing - Cemented surface casing with 50 sks. (59 cu. ft.) Class "B" cement containing 2% CaCl_2 and 1/4#/sk. cellophane flakes.
- Production Casing - Mixed and pumped 105 sks. (216.3 cu. ft.) of Class "B" cement containing 2% Thrifty-Lite and 1/4#/sk. cellophane flakes. Tailed in with 75 sks. (88.5 cu. ft.) Class "B" cement containing 1/4#/sk. cellophane flakes and 2% CaCl_2 .

216.3
88.5

127.8

HIKON DEVELOPMENT COMPANY
JOE WHITNEY WELL NO. 1
1450' FSL, 1190' FWL
SECTION 35, T27N, R12W
SAN JUAN COUNTY, NEW MEXICO
COMPLETION REPORT
EXHIBIT "B"

ACID, SHOT, FRACTURE, CEMENT SQUEEZE, ETC.

<u>Depth Interval</u>	<u>Amount and Kind Material Used</u>
1246' - 1253'	Acidized under packer set at 1241' KB, with 6.0 bbls. 15% HCL acid.
1169' - 1179'	Fraced with 70 quality foam
1216' - 1225'	containing 360 bbls. 2% KCL water,
1246' - 1253'	266,000 SCF Nitrogens, and 40,000# 20/40 Brady sand.
1169' - 1179'	Spotted 3 bbls. 15% HCL acid.
1216' - 1225'	Fraced with 70 quality foam containing 181 bbls. 2% KCL water, 170,000 SCF Nitrogen, and 20,000# 20/40 Brady sand.
984' - 1004'	Spotted 6 bbls. 15% HCL acid. Fraced with 70 quality foam containing 139 bbls. 2% KCL water, 154,500 SCF Nitrogen, and 20,000# 20/40 Brady sand.

STATE OF NEW MEXICO
ENERGY AND MINERALS DEPARTMENT

NO. OF COPIES RECEIVED	
DISTRIBUTION	
SANTA FE	
FILE	
U.S.G.A.	
LAND OFFICE	
TRANSPORTER	OIL
	GAS
OPERATOR	
PROMOTION OFFICE	

OIL CONSERVATION DIVISION
P. O. BOX 2088
SANTA FE, NEW MEXICO 87501

RECEIVED
Form C-104
Revised 10-01-78
FEB 01 1989
OIL CON. DIV
DIST. 3

REQUEST FOR ALLOWABLE
AND
AUTHORIZATION TO TRANSPORT OIL AND NATURAL GAS

I. Operator
Hixon Development Company

Address
P.O. Box 2810, Farmington, N.M. 87499

Reason(s) for filing (Check proper box)

<input checked="" type="checkbox"/> New Well	Change in Transporter of:	
<input type="checkbox"/> Recompletion	<input type="checkbox"/> Oil	<input type="checkbox"/> Dry Gas
<input type="checkbox"/> Change in Ownership	<input type="checkbox"/> Casinghead Gas	<input type="checkbox"/> Condensate

Other (Please explain)

If change of ownership give name
and address of previous owner

II. DESCRIPTION OF WELL AND LEASE

Lease Name Joe Whitney	Well No. 1	Pool Name, including Formation Gallegos Fruitland P.C.	Kind of Lease State, Federal or Fee Federal	Lease No. NM 57579
Location Unit Letter <u>L</u> ; <u>1450</u> Feet From The <u>South</u> Line and <u>1190</u> Feet From The <u>West</u> Line of Section <u>35</u> Township <u>27N</u> Range <u>12W</u> , NMPM, <u>San Juan</u> County				

III. DESIGNATION OF TRANSPORTER OF OIL AND NATURAL GAS

Name of Authorized Transporter of Oil <input type="checkbox"/> or Condensate <input type="checkbox"/>	Address (Give address to which approved copy of this form is to be sent)					
Name of Authorized Transporter of Casinghead Gas <input type="checkbox"/> or Dry Gas <input checked="" type="checkbox"/>	Address (Give address to which approved copy of this form is to be sent)					
El Paso Natural Gas Co.	P.O. Box 990, Farmington, N.M. 87499					
If well produces oil or liquids, give location of tanks.	Unit	Sec.	Twp.	Rge.	Is gas actually connected?	When
					No	Waiting on pipeline connection

If this production is commingled with that from any other lease or pool, give commingling order number:

NOTE: Complete Parts IV and V on reverse side if necessary.

VI. CERTIFICATE OF COMPLIANCE

I hereby certify that the rules and regulations of the Oil Conservation Division have been complied with and that the information given is true and complete to the best of my knowledge and belief.

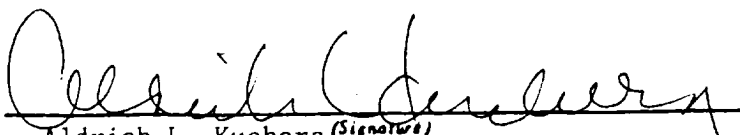
Aldrich L. Kuchera (Signature)
President/CEO (Title)
January 31, 1989 (Date)

OIL CONSERVATION DIVISION

APPROVED FEB 01 1989
BY THOMAS J. COOPER
TITLE SUPERVISOR DISTRICT #3

This form is to be filed in compliance with RULE 1104.
If this is a request for allowable for a newly drilled or deepener well, this form must be accompanied by a tabulation of the deviation tests taken on the well in accordance with RULE 111.
All sections of this form must be filled out completely for allowable on new and recompleted wells.
Fill out only Sections I, II, III, and VI for changes of owner, well name or number, or transporter, or other such change of condition.
Separate Forms C-104 must be filed for each pool in multiply completed wells.

RECEIVED

FEB 01 1989

OIL CON. DIV.
DIST. 3

Form C-104
Revised 10-01-78
Format 08-01-83
Page 2

IV. COMPLETION DATA

Designate Type of Completion - (X)		Oil Well	Gas Well	New Well	Workover	Deepen	Plug Back	Same Res'v.	Diff. Res'v.
			X	X					
Date Spudded 10-15-88	Date Compl. Ready to Prod. 11-17-88		Total Depth 1470' KB		P.B.T.D. 1304' KB				
Elevations (DF, RKB, RT, GR, etc.) 5883' GLE	Name of Producing Formation Gallegos Fruitland PC		Top Oil/Gas Pay 984'		Tubing Depth 1039.11' KB				
Perforations 984'-1004' KB,						Depth Casing Shoe 1323.26' KB			
TUBING, CASING, AND CEMENTING RECORD									
HOLE SIZE	CASING & TUBING SIZE		DEPTH SET		SACKS CEMENT				
8-3/4"	7"		128.80' KB		See below				
6-1/4"	4-1/2"		1323.26' KB		See below				
	2-3/8"		1039.11' KB						

V. TEST DATA AND REQUEST FOR ALLOWABLE (Test must be after recovery of total volume of load oil and must be equal to or exceed top allowable for this depth or be for full 24 hours)

Date First New Oil Run To Tanks	Date of Test	Producing Method (Flow, pump, gas lift, etc.)	
Length of Test	Tubing Pressure	Casing Pressure	Choke Size
Actual Prod. During Test	Oil - Bbls.	Water - Bbls.	Gas - MCF

GAS WELL

Actual Prod. Test - MCF/D 203	Length of Test 24 hours	Bble. Condensate/MCF 0	Gravity of Condensate N/A
Testing Method (pilot, back pr.) Orifice-Prover	Tubing Pressure (shut-in) 360	Casing Pressure (shut-in) 360	Choke Size 3/4

CEMENTING RECORD

Surface Casing - Cemented surface casing with 50 sks. (59 cu. ft.) Class "B" cement containing 2% CaCl₂ and 1/4#/sk. cellophane flakes.

Production Casing - Mixed and pumped 105 sks. (216.3 cu. ft.) of Class "B" cement containing 2% Thrifty-Lite and 1/4#/sk. cellophane flakes. Tailed in with 75 sks. (88.5 cu. ft.) Class "B" cement containing 1/4#/sk. cellophane flakes and 2% CaCl₂.

HixonDevelopment
COMPANY

RECEIVED
JUL 27 1989

89-2-2 8:11:23

OFFICE OF THE ATTORNEY GENERAL
FARMINGTON, NEW MEXICO

June 1, 1989

Ron Fellows
Area Manager
Bureau of Land Management
1235 LaPlata Highway
Farmington, New Mexico 87401

BRANCH OFFICE
S. L. L.
2

BLM - FRA
AM / AAM
ADMIN. / FAC/VOL
NAV AFF / RANKER
P & SC / TEST SITE
SP AGT / HZ. MAT
BRANCH L & RR
BRANCH MINERALS
ALL SUPV / ALL EMPL.
FILES

Subject: Request for Off-Lease Measurement
of Gas from
Joe Whitney Well No. 1
Lease No. NM 57579
Section 35, Township 27 North, Range 12 West
San Juan County, New Mexico

RECEIVED
AUG 03 1989
OIL CON. DIV
DIST. 3

Dear Mr. Fellows:

Hixon Development Company requests permission for the off-lease measurement of gas production from the Joe Whitney Well No. 1. This well is located approximately one-half mile from El Paso Natural Gas Company's existing system. Delivery of gas produced from this well will be accepted into the El Paso Natural Gas main line at the meter to be set in the NE/4 SE/4 of Section 35, Township 27 North, Range 12 West on Lease No. NOO-C-14-20-7471.

As you are aware, pipeline companies have ceased extending their systems to gather gas from additional wells and are requiring individual operators to deliver to the existing pipeline facility.

El Paso Natural Gas Company has agreed to accept delivery, for transportation, of the gas from this well at their meter set on the main line in the NE/4 SE/4 of Section 35, Township 27 North, Range 12 West in Lease No. NOO-C-14-20-7471.

APPROVED

JUL 31 1989
Karl Townsend

FOR

AREA MANAGER

Post Office Box 2810
Farmington, New Mexico 87499
505/326-3325

Ron Fellows

Page 2

The ability to deliver gas into El Paso Natural Gas Company's main line, therefore securing a market, will allow production of gas from the subject lease. Disapproval of this request will result in loss of revenue, not only to the operator, but also in the form of royalties and taxes.

If you have any questions regarding this request, please do not hesitate to contact me.

Very truly yours,

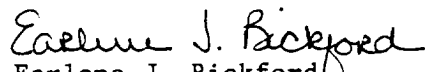
Earlene J. Bickford
Administrative Manager

Enclosure

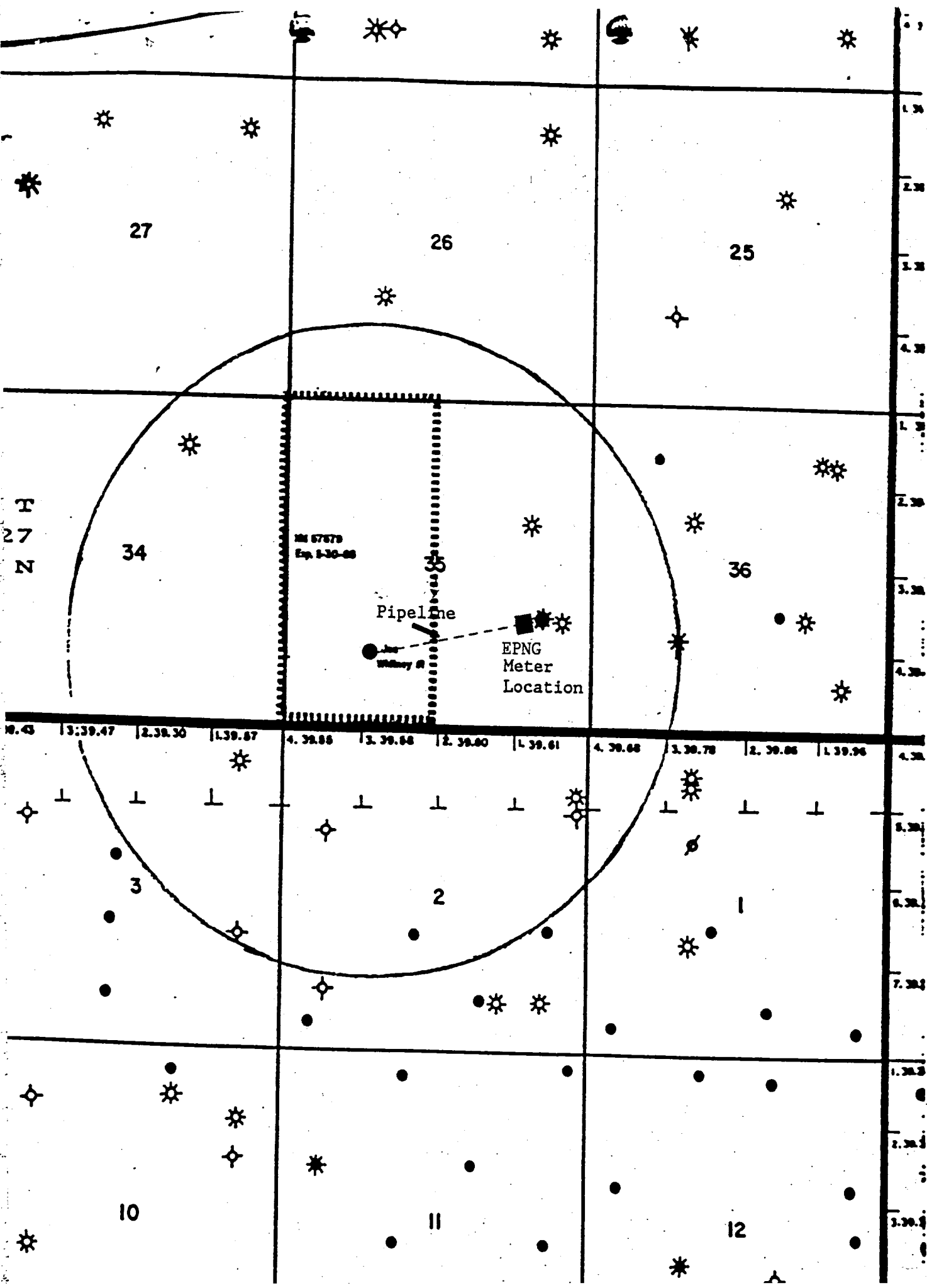

HIXON DEVELOPMENT COMPANY
JOE WHITNEY WELL NO. 1
1450' FSL, 1190' FWL
SECTION 35, T27N, R12W
SAN JUAN COUNTY, NEW MEXICO
DEVIATION SURVEY

RECEIVED
NOV 15 1988
OIL CON. DIV.
DIST. 2

<u>DATE</u>	<u>DEPTH</u>	<u>INCLINATION</u>
10-17-88	120'	1/4 degree
10-18-88	600'	1/4 degree
10-19-88	1470'	1/2 degree

By: Michael D. Haddenham
Michael D. Haddenham
Engineering Manager

Date: November 14, 1988

State of New Mexico
County of San Juan

The foregoing instrument was acknowledged before me this 14th
day of November, 1988, by Michael D. Haddenham.

Debra A. Shelton
Notary Public

My commission expires July 20, 1991.

UNITED STATES
DEPARTMENT OF THE INTERIOR
BUREAU OF LAND MANAGEMENT

SUBMIT IN TRIPLICATE*
(Other instructions on re-
verse side)

Form approved.
Budget Bureau No. 1004-0135
Expires August 31, 1985

SUNDRY NOTICES AND REPORTS ON WELLS

(Do not use this form for proposals to drill or to deepen or plug back to a different reservoir.
Use "APPLICATION FOR PERMIT—" for such proposals.)

1. OIL WELL <input type="checkbox"/> GAS WELL <input checked="" type="checkbox"/> OTHER <input type="checkbox"/>		7. UNIT AGREEMENT NAME	
2. NAME OF OPERATOR Hixon Development Company		8. FARM OR LEASE NAME Joe Whitney	
3. ADDRESS OF OPERATOR P.O. Box 2810, Farmington, N.M. 87499		9. WELL NO. 1	
4. LOCATION OF WELL (Report location clearly and in accordance with any State requirements.* See also space 17 below.) At surface 1450' FSL, 1190' FWL, Sec. 35, T27N, R12W, NMPM		10. FIELD AND POOL, OR WILDCAT Gallegos Fruitland PC	
14. PERMIT NO.		11. SEC., T., R., M., OR BLK. AND SURVEY OR AREA Sec. 35, T27N, R12W	
15. ELEVATIONS (Show whether OF, RT, GR, etc.) 5883' GLE		12. COUNTY OR PARISH San Juan	
		13. STATE N.M.	

16. Check Appropriate Box To Indicate Nature of Notice, Report, or Other Data

NOTICE OF INTENTION TO:

TEST WATER SHUT-OFF <input type="checkbox"/>	PULL OR ALTER CASING <input type="checkbox"/>
FRACTURE TREAT <input type="checkbox"/>	MULTIPLE COMPLETE <input type="checkbox"/>
SHOOT OR ACIDIZE <input type="checkbox"/>	ABANDON* <input type="checkbox"/>
REPAIR WELL <input type="checkbox"/>	CHANGE PLANS <input type="checkbox"/>
(Other) <input type="checkbox"/>	

SUBSEQUENT REPORT OF:

WATER SHUT-OFF <input type="checkbox"/>	REPAIRING WELL <input type="checkbox"/>
FRACTURE TREATMENT <input type="checkbox"/>	ALTERING CASING <input type="checkbox"/>
SHOOTING OR ACIDIZING <input type="checkbox"/>	ABANDONMENT* <input type="checkbox"/>
(Other) <input checked="" type="checkbox"/> Drilling Progress	
(Note: Report results of multiple completion on Well Completion or Recompletion Report and Log form.)	

17. DESCRIBE PROPOSED OR COMPLETED OPERATIONS (Clearly state all pertinent details, and give pertinent dates, including estimated date of starting any proposed work. If well is directionally drilled, give subsurface locations and measured and true vertical depths for all markers and zones pertinent to this work.)*

Drilled out from under casing with a 6-1/4" bit, October 17, 1988. Drilled to T.D. of 1470'. Ran Induction Log with Gamma Ray and Compensated Density-Neutron Logs. Log tops as follows: Ojo Alamo - 141', Kirtland - 273', Fruitland - 976', Pictured Cliffs - 1244'. Ran 24 jts. (905.81') 4-1/2", 11.6#, N-80, 8rd LT&C casing and 11 jts. (438.80') 10.5#, J-55, 8rd ST&C casing. Rabbited casing with a 2-7/8" tubing collar. Casing set at 1323.26' KB. Cemented casing as follows: Mixed and pumped 105 sks. (216.3 cu. ft.) of Class "B" cement containing 2% Thrifty-Lite and 1/4#/sk. cellophane flakes. Tailed in with 75 sks. (88.5 cu. ft.) Class "B" cement containing 1/4#/sk. cellophane flakes and 2% CaCl2.

18. I hereby certify that the foregoing is true and correct

SIGNED Michael D. Haddenham
Michael D. Haddenham

TITLE Engineering Manager

DATE October 27, 1988

(This space for Federal or State office use)

APPROVED BY _____
CONDITIONS OF APPROVAL, IF ANY:

TITLE _____

DATE _____

*See Instructions on Reverse Side

UNITED STATES
DEPARTMENT OF THE INTERIOR
BUREAU OF LAND MANAGEMENT

SUBMIT IN TRIPPLICATE
(Other instructions on re-
verse side)

Form approved.
Budget Bureau No. 1004-0135
Expires August 31, 1985

SUNDRY NOTICES AND REPORTS ON WELLS

Do not use this form for proposals to drill or to deepen or plug back to a different reservoir.
Use "APPLICATION FOR PERMIT" for such proposals.

1. WELL TYPE ☒ WELL ☐ OTHER

2. NAME OF OPERATOR

Hixon Development Company

3. ADDRESS OF OPERATOR

P.O. Box 2810, Farmington, N.M. 87499

4. LOCATION OF WELL (Report location clearly and in accordance with any State requirements.
See also space 17 below.)

At surface

1450' FSL, 1190' FWL, Sec. 35, T27N, R12W, NMPM

14. PERMIT NO.

15. ELEVATIONS (Show whether DF, RT, GR, etc.)

5883' GLE

5. LEASE DESIGNATION AND SERIAL NO.

NM 57579

6. IF INDIAN, ALLOTTEE OR TRIBE NAME

7. UNIT AGREEMENT NAME

8. FARM OR LEASE NAME

Joe Whitney

9. WELL NO.

1

10. FIELD AND POOL, OR WILDCAT

Gallegos Fruitland PC

11. SEC., T., R., M., OR BLK. AND
SURVEY OR AREA

Sec. 35, T27N, R12W

12. COUNTY OR PARISH 13. STATE

San Juan

New Mexico

16. Check Appropriate Box To Indicate Nature of Notice, Report, or Other Data

NOTICE OF INTENTION TO:

SUBSEQUENT REPORT OF:

TEST WATER SHUT-OFF ☐

PULL OR ALTER CASING ☐

WATER SHUT-OFF ☐

REPAIRING WELL ☐

FRACTURE TREAT ☐

MULTIPLE COMPLETE ☐

FRACTURE TREATMENT ☐

ALTERING CASING ☐

SHOOT OR ACIDIZE ☐

ABANDON* ☐

SHOOTING OR ACIDIZING ☐

ABANDONMENT* ☐

REPAIR, AGR. ☐

CHANGE LEASE ☐

(Other) ☐

Drilling Progress ☒

(NOTE: Report results of multiple completion on Well
Completion or Recompletion Report and Log form.)

17. DESCRIBE PROPOSED OR COMPLETED OPERATIONS (Clearly state all pertinent details, and give pertinent dates, including estimated date of starting any proposed work. If well is directionally drilled, give subsurface locations and measured and true vertical depths for all markers and zones pertinent to this work.)

Spudded surface at 9:00 a.m. on October 15, 1988. Drilled an 8-3/4" hole to 130' K.B. Ran three joints (128.80') of 7", 20#, 8rd, J-55, ST&C surface casing. Casing set at 128.80' K.B. Cemented surface casing with 50 sks. (59 cu. ft.) Class "B" cement containing 2% CaCl₂ and 1/4#/sk. cellophane flakes. WOC - 12 hours.

RECEIVED

OCT 23 1988

OIL CON. DIV
DIST 2

18. I hereby certify that the foregoing is true and correct

SIGNED

Michael D. Haddenham

TITLE

Engineering Manager

DATE

October 18, 1988

(This space for Federal or State office use)

APPROVED BY

TITLE

DATE

CONDITIONS OF APPROVAL, IF ANY:

*See Instructions on Reverse Side

Submit 5 Copies
Appropriate District Office
DISTRICT I
P.O. Box 1980, Hobbs, NM 88240

DISTRICT II
P.O. Drawer DD, Artesia, NM 88210

DISTRICT III
1000 Rio Brazos Rd., Aztec, NM 87410

State of New Mexico
Energy, Minerals and Natural Resources Department

OIL CONSERVATION DIVISION
P.O. Box 2088
Santa Fe, New Mexico 87504-2088

Form C-104
Revised 1-1-89
See Instructions
at Bottom of Page

**REQUEST FOR ALLOWABLE AND AUTHORIZATION
TO TRANSPORT OIL AND NATURAL GAS**

I.		Well API No.
Operator Giant Exploration & Production Company		30-045-87093
Address P.O. Box 2810, Farmington, New Mexico 87499		
Reason(s) for Filing (Check proper box) <input type="checkbox"/> Other (Please explain)		
New Well <input type="checkbox"/>	Change in Transporter of:	
Recompletion <input type="checkbox"/>	Oil <input type="checkbox"/> Dry Gas <input type="checkbox"/>	Effective July 1, 1990
Change in Operator <input checked="" type="checkbox"/>	Casinghead Gas <input type="checkbox"/> Condensate <input type="checkbox"/>	
If change of operator give name and address of previous operator Hixon Development Company, P.O. Box 2810, Farmington, N.M. 87499		

II. DESCRIPTION OF WELL AND LEASE

Lease Name Joe Whitney	Well No. 1	Pool Name, Including Formation Gallegos Fruitland P.C.	Kind of Lease State, Federal or Fee Federal	Lease No. NM 57579
Location Unit Letter <u>L</u> : <u>1450</u> Feet From The <u>South</u> Line and <u>1190</u> Feet From The <u>West</u> Line Section <u>35</u> Township <u>27N</u> Range <u>12W</u> , NMPM, <u>San Juan</u> County				

III. DESIGNATION OF TRANSPORTER OF OIL AND NATURAL GAS

Name of Authorized Transporter of Oil <input type="checkbox"/> or Condensate <input type="checkbox"/>	Address (Give address to which approved copy of this form is to be sent)	
Name of Authorized Transporter of Casinghead Gas <input type="checkbox"/> or Dry Gas <input checked="" type="checkbox"/>	Address (Give address to which approved copy of this form is to be sent)	
<u>El Paso Natural Gas Company</u>	<u>PO Box 4990, Farmington, NM 87499</u>	
If well produces oil or liquids, give location of tanks.	Unit	Sec.
	Twp.	Rge.
	Is gas actually connected?	When?
	Yes	April 14, 1989
If this production is commingled with that from any other lease or pool, give commingling order number:		

IV. COMPLETION DATA

Designate Type of Completion - (X)	Oil Well	Gas Well	New Well	Workover	Deepen	Plug Back	Same Res'v	Diff Res'v
Date Spudded	Date Compl. Ready to Prod.		Total Depth		P.B.T.D.			
Elevations (DF, RKB, RT, GR, etc.)	Name of Producing Formation		Top Oil/Gas Pay		Tubing Depth			
Perforations				Depth Casing Shoe				
TUBING, CASING AND CEMENTING RECORD								
HOLE SIZE	CASING & TUBING SIZE		DEPTH SET		SACKS CEMENT			

**V. TEST DATA AND REQUEST FOR ALLOWABLE
OIL WELL** (Test must be after recovery of total volume of load oil and must be equal to or exceed top allowable for this depth or be for full 24 hours.)

Date First New Oil Run To Tank	Date of Test	Producing Method (Flow, pump, gas lift, etc.)	
Length of Test	Tubing Pressure	Casing Pressure	RECEIVED JUL 3 1990 OIL CON
Actual Prod. During Test	Oil - Bbls.	Water - Bbls.	

GAS WELL

Actual Prod. Test - MCF/D	Length of Test	Bbls. Condensate/MMCF	Gravity of Condensate
Testing Method (pilot, back pr.)	Tubing Pressure (Shut-in)	Casing Pressure (Shut-in)	Choke Size

VI. OPERATOR CERTIFICATE OF COMPLIANCE

I hereby certify that the rules and regulations of the Oil Conservation Division have been complied with and that the information given above is true and complete to the best of my knowledge and belief.

Signature Aldrich L. Kuchera
Printed Name Aldrich L. Kuchera President
Date JUN 22 1990 Telephone No. (505) 326-3325

OIL CONSERVATION DIVISION

Date Approved JUL 3 1990

By [Signature]

Title [Signature]

- INSTRUCTIONS:** This form is to be filed in compliance with Rule 1104
- 1) Request for allowable for newly drilled or deepened well must be accompanied by tabulation of deviation tests taken in accordance with Rule 111.
 - 2) All sections of this form must be filled out for allowable on new and recompleted wells.
 - 3) Fill out only Sections I, II, III, and VI for changes of operator, well name or number, transporter, or other such changes.
 - 4) Separate Form C-104 must be filed for each pool in multiply completed wells.