

UNITED STATES
DEPARTMENT OF THE INTERIOR
BUREAU OF LAND MANAGEMENT

APPLICATION FOR PERMIT TO DRILL, DEEPEN, OR PLUG BACK

1a. TYPE OF WORK DRILL <input checked="" type="checkbox"/> DEEPEN <input type="checkbox"/> PLUG BACK <input type="checkbox"/>			5. LEASE DESIGNATION AND SERIAL NO. NM-33047
b. TYPE OF WELL OIL WELL <input type="checkbox"/> GAS WELL <input checked="" type="checkbox"/> OTHER <input type="checkbox"/> SINGLE ZONE <input checked="" type="checkbox"/> MULTIPLE ZONE <input type="checkbox"/>			6. IF INDIAN, ALLOTTEE OR TRIBE NAME
2. NAME OF OPERATOR Merrion Oil & Gas Corporation			7. UNIT AGREEMENT NAME
3. ADDRESS OF OPERATOR P. O. Box 840, Farmington, New Mexico 87499			8. FARM OR LEASE NAME Hi Roll
4. LOCATION OF WELL (Report location clearly and in accordance with any State requirements.) At surface 790' FSL & 1050' FWL (SWSW) At proposed prod. zone			9. WELL NO. 5
14. DISTANCE IN MILES AND DIRECTION FROM NEAREST TOWN OR POST OFFICE* 20 miles South of Farmington, New Mexico			10. FIELD AND POOL, OR WILDCAT Basin Fruitland Coal
15. DISTANCE FROM PROPOSED* LOCATION TO NEAREST PROPERTY OR LEASE LINE, FT. (Also to nearest drilg. unit line, if any) 790'			11. SEC., T., R., M., OR BLK. AND SURVEY OR AREA M Section 35, T27N, R13W
16. NO. OF ACRES IN LEASE 640			12. COUNTY OR PARISH 13. STATE San Juan New Mexico
17. NO. OF ACRES ASSIGNED TO THIS WELL 320			
18. PROPOSED DEPTH 1265'			20. ROTARY OR CABLE TOOLS Rotary
21. ELEVATIONS (Show whether DF, RT, GR, etc.) (This entry is subject to verification by the Bureau of Land Management) 6,033' FR			22. APPROX. DATE WORK WILL START* July, 1990

23. PROPOSED CASING AND CEMENTING PROGRAM				DRILLING OPERATIONS AUTHORIZED ARE SUBJECT TO COMPLIANCE WITH ATTACHED "GENERAL REQUIREMENTS" QUANTITY OF CEMENT
SIZE OF HOLE	SIZE OF CASING	WEIGHT PER FOOT	SETTING DEPTH	
9-3/4"	7"	20 lb/ft	100'	50 sx (59 cu.ft.)
6-1/4"	4-1/2"	10.5 lb/ft	1265'	130 sx (202 cu.ft.)

Propose to drill 9-3/4" surface hole to 100' KB. Will set approximately 100 ft. of 7", J-55, 20 lb/ft surface casing at 100 ft. KB with 50 sx (59 cu.ft.) of Class "B", with 2% CaCl₂. Top of cement at the surface. Wait on cement 10 hrs. Nipple up BOPS. Pressure test casing to 600 psi for 30 minutes. Drill 6-1/4" hole to total depth at 1,265 ft. Will run open hole logs. If well appears productive will set 4-1/2", J-55, 10.5 lb/ft production casing at total depth with 78 sx Class "B" with 2% D-79 (161 ft³) followed by 52 sx (63 cu.ft.) of Class "H", 2% gel. Estimated top of cement at the surface. Will perforate and stimulate as necessary to test well. Additional drilling program details attached.

RECEIVED

AUG 21 1990

OIL CON. DIV.
DIST. 3

IN ABOVE SPACE DESCRIBE PROPOSED PROGRAM: If proposal is to deepen or plug back, give pertinent data on present productive zone and proposed new productive zone. If proposal is to drill or deepen directionally, give pertinent data on subsurface locations and measured and true vertical depths. Give blowout preventer program, if any.

24. SIGNED Steven S. Dunn TITLE Operations Manager DATE 6-4-90
(This space for Federal or State office use)

PERMIT NO. _____ APPROVAL DATE _____

APPROVED BY _____ TITLE _____ DATE AUG 16 1990

CONDITIONS OF APPROVAL, IF ANY:

NMOOD

Ken Townsend

FOR AREA MANAGER

*See Instructions On Reverse Side

Title 18 U.S.C. Section 1001, makes it a crime for any person knowingly and willfully to make to any department or agency of the United States any false, fictitious or fraudulent statements or representations as to any matter within its jurisdiction.

Submit to Appropriate
District Office
State Leases - 4 copies
Fee Leases - 3 copies

State of New Mexico
Energy, Minerals and Natural Resources Department

Form C-182
Revised 1-1-89

OIL CONSERVATION DIVISION

P.O. Box 2088
Santa Fe, New Mexico 87504-2088

DISTRICT I
P.O. Box 1980, Hobbs, NM 88240

DISTRICT II
P.O. Drawer DD, Artesia, NM 88210

DISTRICT III
1000 Rio Brazos Rd., Aztec, NM 87410

WELL LOCATION AND ACREAGE DEDICATION PLAT

All Distances must be from the outer boundaries of the section

Operator MERRION OIL & GAS CORPORATION			Lease HI ROLL		Well No. 5
Unit Letter M	Section 35	Township 27 N	Range 13 W	County San Juan	
Actual Footage Location of Well: 790 feet from the South line and 1050 feet from the West line					
Ground level Elev. 6033	Producing Formation Fruitland		Pool Basin Fruitland		Dedicated Acreage: 320 Acres
<p>1. Outline the acreage dedicated to the subject well by colored pencil or hatchure marks on the plat below.</p> <p>2. If more than one lease is dedicated to the well, outline each and identify the ownership thereof (both as to working interest and royalty).</p> <p>3. If more than one lease of different ownership is dedicated to the well, have the interest of all owners been consolidated by communitization, unitization, force-pooling, etc.? <input type="checkbox"/> Yes <input type="checkbox"/> No If answer is "yes" type of consolidation _____ If answer is "no" list the owners and tract descriptions which have actually been consolidated. (Use reverse side of this form if necessary.) _____ No allowable will be assigned to the well until all interests have been consolidated (by communitization, unitization, forced-pooling, or otherwise) or until a non-standard unit, eliminating such interest, has been approved by the Division.</p>					

0 330 660 990 1320 1650 1980 2310 2640 2000 1500 1000 500 0

N 89°59' W

80.00 ch.

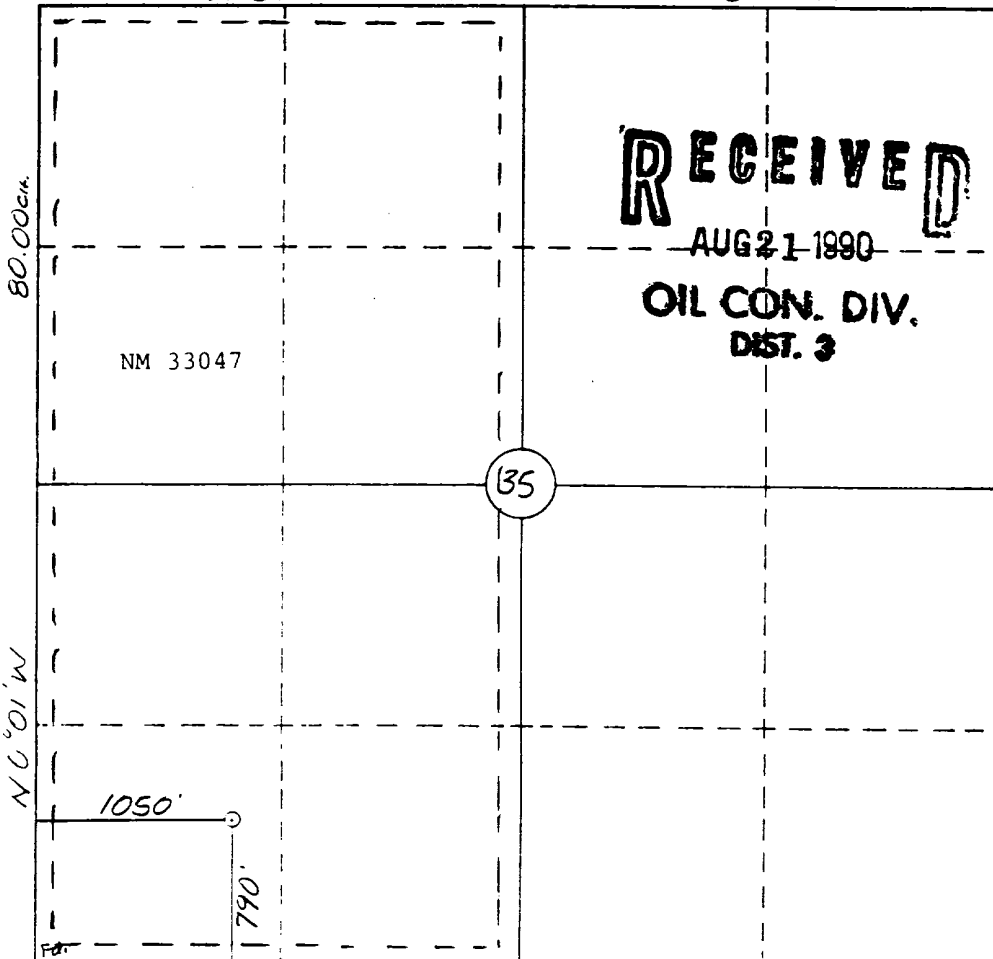

OPERATOR CERTIFICATION

I hereby certify that the information contained herein is true and complete to the best of my knowledge and belief.

Signature

Printed Name

Steven S. Dunn

Position

Operations Manager

Company

Merrion Oil & Gas Corp.

Date

6/4/90

SURVEYOR CERTIFICATION

I hereby certify that the well location shown on this plat was plotted from field notes of actual surveys made by me or under my supervision, and that the same is true and correct to the best of my knowledge and belief.

6-3-90

Date Surveyed

William E. Mahnke II

Signature of Professional Surveyor

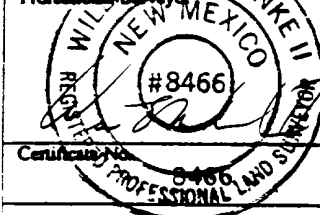

Certificate No.

8466

