

UNITED STATES
DEPARTMENT OF THE INTERIOR
BUREAU OF LAND MANAGEMENT

3-045-28255

APPLICATION FOR PERMIT TO DRILL, DEEPEN, OR PLUG BACK

1a. TYPE OF WORK

DRILL ☒

DEEPEN ☐

PLUG BACK ☐

b. TYPE OF WELL

OIL
WELL ☐

GAS
WELL ☒

OTHER ☐

SINGLE
ZONE ☒

MULTIPLE
ZONE ☐

2. NAME OF OPERATOR

Bonneville Fuels Corporation

3. ADDRESS OF OPERATOR

1600 Broadway, Suite 1110, Denver, CO 80202

4. LOCATION OF WELL (Report location clearly and in accordance with any State requirements.)*

At surface

1055' FNL, 790' FEL

At proposed prod. zone

same

14. DISTANCE IN MILES AND DIRECTION FROM NEAREST TOWN OR POST OFFICE*

10 miles southwest of Bloomfield, New Mexico

16. DISTANCE FROM PROPOSED*

LOCATION TO NEAREST
PROPERTY OR LEASE LINE, FT.
(Also to nearest drg. unit line, if any)

790

18. NO. OF ACRES IN LEASE

2560

18. DISTANCE FROM PROPOSED LOCATION*

TO NEAREST WELL, DRILLING, COMPLETED,
OR APPLIED FOR, ON THIS LEASE, FT.

± 2200'

19. PROPOSED DEPTH

2100'

21. ELEVATIONS (Show whether DF, RT, GR, etc.)

6028

23.

PROPOSED CASING AND CEMENTING PROGRAM, DRILLING OPERATIONS AUTHORIZED ARE

SIZE OF HOLE	SIZE OF CASING	WEIGHT PER FOOT	SETTING DEPTH
12 1/4	8 5/8	24#	+ 300'
7 7/8	4 1/2	11.60#	+ 2100'

SUBJECT TO COMPLIANCE WITH ATTACHED
"GENERAL REQUIREMENTS"
250 sx (Circ to surf)
500 sx (Circ to surf)

Exhibits Attached:

Exhibit 8 Production Facility Layout

Ten Point Compliance Program

Surface Use & Operation Plan

Exhibit 1 Blowout Preventer

" 2 Location & Elevation

" 3 Vicinity Map

" 4 One Mile Radius Map

" 5 Topography & Fad Layout

" 6 Cross Sections & Volumes

" 7 Rig Layout

RECEIVED

SEP 24 1990

OIL CON. DIV.
DIST. 3

IN ABOVE SPACE DESCRIBE PROPOSED PROGRAM: If proposal is to deepen or plug back, give data on present productive zone and proposed new productive zone. If proposal is to drill or deepen directionally, give pertinent data on subsurface locations and measured and true vertical depths. Give blowout preventer program, if any.

24.

SIGNED

[Signature]

TITLE

Operations Supervisor

DATE

August 20, 1990

(This space for Federal or State office use)

PERMIT NO.

APPROVAL DATE

APPROVED BY

CONDITIONS OF APPROVAL, IF ANY:

TITLE

NMOCD

*See Instructions On Reverse Side

Submit to Appropriate
District Office
State Lease - 4 copies
Fee Lease - 3 copies

State of New Mexico
Energy, Minerals and Natural Resources Department

Form C-102
Revised 1-1-89

OIL CONSERVATION DIVISION

P.O. Box 2088

Santa Fe, New Mexico 87504-2088

DISTRICT I
P.O. Box 1980, Hobbs, NM 88240

DISTRICT II
P.O. Drawer DD, Artesia, NM 88210

DISTRICT III
1000 Rio Brazos Rd., Aztec, NM 87410

WELL LOCATION AND ACREAGE DEDICATION PLAT

All Distances must be from the outer boundaries of the section

RECEIVED
BLM MAIL ROOM
AUG 22 AM 11:31

Operator BONNEVILLE FUELS CORP.			Lease Fullerton SCOTT "B" FEDERAL 13.		Well No. 13-41
Unit Letter A	Section 13	Township 27N	Range 11W	County NMPM SAN JUAN	
Actual Footage Location of Well: 1055 feet from the NORTH line and 790 feet from the EAST line					
Ground level Elev. 6028	Producing Formation			Pool Hugin 1st	Dedicated Acreage: Acres

1. Outline the acreage dedicated to the subject well by colored pencil or hatchure marks on the plat below.
2. If more than one lease is dedicated to the well, outline each and identify the ownership thereof (both as to working interest and royalty).
3. If more than one lease of different ownership is dedicated to the well, have the interest of all owners been consolidated by communitization, unitization, force-pooling, etc.?
☐ Yes ☐ No If answer is "yes" type of consolidation _____
If answer is "no" list the owners and tract descriptions which have actually been consolidated. (Use reverse side of this form if necessary.)
No allowable will be assigned to the well until all interests have been consolidated (by communitization, unitization, forced-pooling, or otherwise) or until a non-standard unit, eliminating such interest, has been approved by the Division.

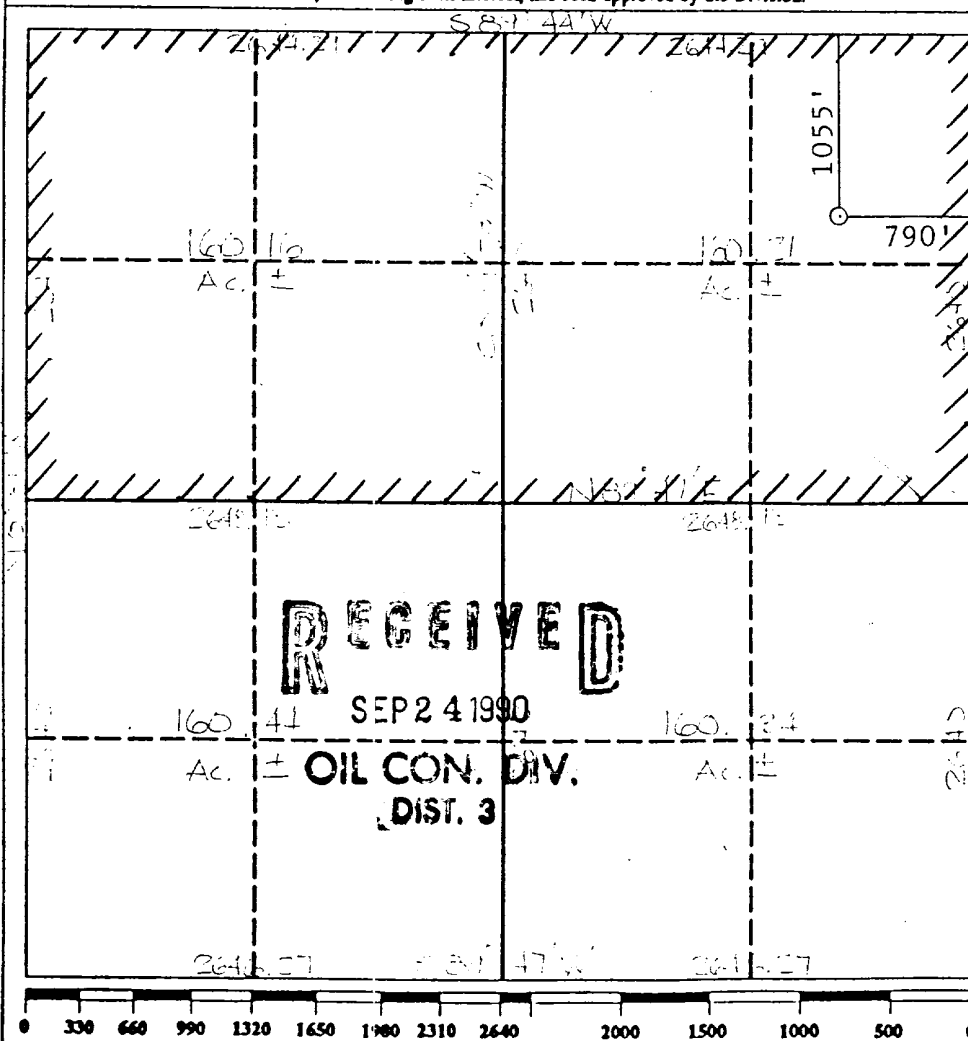

OPERATOR CERTIFICATION

I hereby certify that the information contained herein is true and complete to the best of my knowledge and belief.

Signature
Gerald D. Gentry
Printed Name
Gerald D. Gentry
Position
Operations Supervisor
Company
Bonneville Fuels Corp.
Date
August 20, 1990

SURVEYOR CERTIFICATION

I hereby certify that the well location shown on this plat was plotted from field notes of actual surveys made by me or under my supervision, and that the same is true and correct to the best of my knowledge and belief.

Date Surveyed
August 20, 1990
Signature
Cecil D. Fullerton
Professional Surveyor
9672
Cecil D. Fullerton
Certificate No.
9672