

UNITED STATES  
DEPARTMENT OF THE INTERIOR  
BUREAU OF LAND MANAGEMENT

APPLICATION FOR PERMIT TO DRILL, DEEPEN, OR PLUG BACK

1a. TYPE OF WORK  
DRILL ☒ DEEPEN ☐ PLUG BACK ☐

b. TYPE OF WELL  
OIL WELL ☐ GAS WELL ☒ OTHER ☐  
SINGLE ZONE ☒ MULTIPLE ZONE ☐

2. NAME OF OPERATOR  
Maralex Resources, Inc.

3. ADDRESS OF OPERATOR  
518 17th Street, Suite 1030, Denver, CO 80202

4. LOCATION OF WELL (Report location clearly and in accordance with any State requirements.)\*  
At surface 1760 FNL and 360 FEL (Unit Letter H)  
At proposed prod. zone Same

14. DISTANCE IN MILES AND DIRECTION FROM NEAREST TOWN OR POST OFFICE\*  
Approximately 17 miles southeast of Blanco, NM

10. DISTANCE FROM PROPOSED\*  
LOCATION TO NEAREST  
PROPERTY OR LEASE LINE, FT.  
(Also to nearest drig. unit line, if any) 360'

18. DISTANCE FROM PROPOSED LOCATION\*  
TO NEAREST WELL, DRILLING, COMPLETED,  
OR APPLIED FOR, ON THIS LEASE, FT. 280'

21. ELEVATIONS (Show whether DF, RT, GR, etc.) This section is subject to technical and procedural review pursuant to 43 CFR 3165.3 and appeal pursuant to 43 CFR 3165.4  
6086 GR, 6099 KB

23. PROPOSED CASING AND CEMENTING PROGRAM

SIZE OF HOLE	SIZE OF CASING	WEIGHT PER FOOT	SETTING DEPTH
12-1/4"	8-5/8"	23# J-55	300'
7-7/8"	5-1/2"	23# J-55	2350'

not warrant that the applica  
is a legal or equitable right  
c. title to this

Maralex Resources, Inc. proposes to drill a 12-1/4" hole to 300' using a native fresh water mud. The 8-5/8" surface string will be cemented back to surface. Casing will then be drilled out with a 7-7/8" bit using a low solids, non-dispersed fresh water mud. Upon reaching TD, a full suite of open hole logs will be run and 5-1/2" production casing will be set and cemented back to surface. In accordance with "On Shore Oil and Gas Order #1" attached is the Drilling Plan and Surface Use Plan that we will follow in drilling the subject well.

RECEIVED

NOV 27 1990

OIL CON. DIV.

DIST. 3

IN ABOVE SPACE DESCRIBE PROPOSED PROGRAM: If proposal is to deepen or plug back, give data on present productive zone and proposed new productive zone. If proposal is to drill or deepen directionally, give pertinent data on subsurface locations and measured and true vertical depths. Give blowout preventer program, if any.

24. SIGNED A. M. O'Hare TITLE President DATE 10/5/90

(This space for Federal or State office use)

PERMIT NO. \_\_\_\_\_ APPROVAL DATE \_\_\_\_\_

APPROVED BY \_\_\_\_\_ TITLE \_\_\_\_\_

CONDITIONS OF APPROVAL, IF ANY:

AK NSL-2920

NMOCD

\*See Instructions On Reverse Side

Title 18 U.S.C. Section 1001, makes it a crime for any person knowingly and willfully to make to any department or agency of the United States any false, fictitious or fraudulent statements or representations as to any matter within its jurisdiction.

5. LEASE DESIGNATION AND SERIAL NO.  
SP-078478 NM-03605 H  
6. IF INDIAN, ALLOTTEE OR TRIBE NAME  
None  
7. UNIT AGREEMENT NAME  
-----  
8. FARM OR LEASE NAME  
Marron W.N. Federal Com  
9. WELL NO.  
9  
10. FIELD AND POOL, OR WILDCAT  
Basin Fruitland Coal  
11. SEC. T. R. M. OR BLK.  
AND SURVEY OR AREA  
H Sec. 27, T27N, R8W  
12. COUNTY OR PARISH  
San Juan  
13. STATE  
New Mexico

17. NO. OF ACRES ASSIGNED  
TO THIS WELL  
N/ 320

20. ROTARY OR CABLE TOOLS  
Rotary

22. APPROX. DATE WORK WILL START\*  
November 1, 1990

DRILLING OPERATIONS AUTHORIZED ARE  
SUBJECT TO COMPLIANCE WITH ATTACHED  
"GENERAL REQUIREMENTS"

248 cuft/210 sx Class B w/2%  
CaCl<sub>2</sub>  
370 cuft/300 sx 50:50 POZ  
w/2" gel  
118 cuft/100 sx Class B neat  
tail

Submit to Appropriate  
District Office  
State Lease - 4 copies  
Fee Lease - 3 copies

State of New Mexico  
Energy, Minerals and Natural Resources Department

Form C-102  
Revised 1-1-89

OIL CONSERVATION DIVISION

P.O. Box 2088  
Santa Fe, New Mexico 87504-2088

DISTRICT I  
P.O. Box 1980, Hobbs, NM 88240

DISTRICT II  
P.O. Drawer DD, Artesia, NM 88210

DISTRICT III  
1000 Rio Brazos Rd., Aztec, NM 87410

WELL LOCATION AND ACREAGE DEDICATION PLAT

All Distances must be from the outer boundaries of the section

Operator <b>MARALEX RESOURCES, INC.</b>			Lease <b>MARRON W.N. FEDERAL COM</b>		Well No. <b>9</b>
Unit Letter <b>H</b>	Section <b>27</b>	Township <b>27 N</b>	Range <b>8 W</b>	County <b>San Juan</b>	
Actual Footage Location of Well: <b>1760</b> feet from the <b>North</b> line and <b>360</b> feet from the <b>East</b> line					
Ground level Elev. <b>6086</b>	Producing Formation <b>Fruitland</b>		Pool <b>Basin Fruitland Coal Gas</b>		Dedicated Acreage: <b>320</b> Acres
<p>1. Outline the acreage dedicated to the subject well by colored pencil or hachure marks on the plat below.</p> <p>2. If more than one lease is dedicated to the well, outline each and identify the ownership thereof (both as to working interest and royalty).</p> <p>3. If more than one lease of different ownership is dedicated to the well, have the interest of all owners been consolidated by communitization, unitization, force-pooling, etc.? <input checked="" type="checkbox"/> Yes <input type="checkbox"/> No If answer is "yes" type of consolidation <u>Communitization</u> If answer is "no" list the owners and tract descriptions which have actually been consolidated. (Use reverse side of this form if necessary.) No allowable will be assigned to the well until all interests have been consolidated (by communitization, unitization, forced-pooling, or otherwise) or until a non-standard unit, eliminating such interest, has been approved by the Division.</p>					

0 330 660 990 1320 1650 1980 2310 2640 2000 1500 1000 500 0

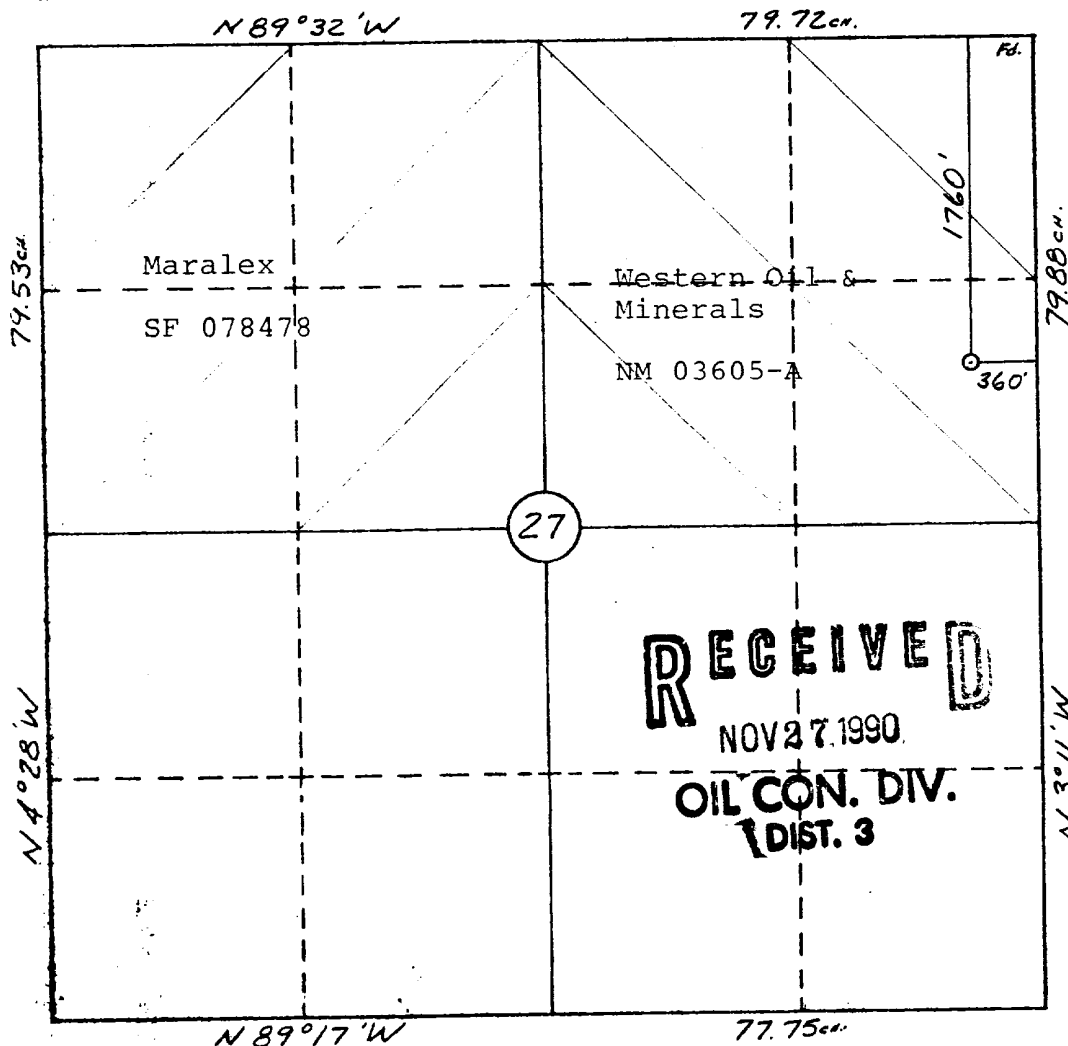

OPERATOR CERTIFICATION

I hereby certify that the information contained herein is true and complete to the best of my knowledge and belief.

Signature A. M. O'Hare  
Printed Name **A. M. O'Hare**  
Position **President**  
Company **Maralex Resources, Inc.**  
Date **10/5/90**

SURVEYOR CERTIFICATION

I hereby certify that the well location shown on this plat was plotted from field notes of actual surveys made by me or under my supervision, and that the same is true and correct to the best of my knowledge and belief.

Date Surveyed **9-28-90**  
**William F. Mahnke II**

Signature & Seal of Professional Surveyor

**WILLIAM F. MAHNKE II**  
**NEW MEXICO**  
**#8466**  
**REGISTERED PROFESSIONAL LAND SURVEYOR**  
Certificate No. **8466**

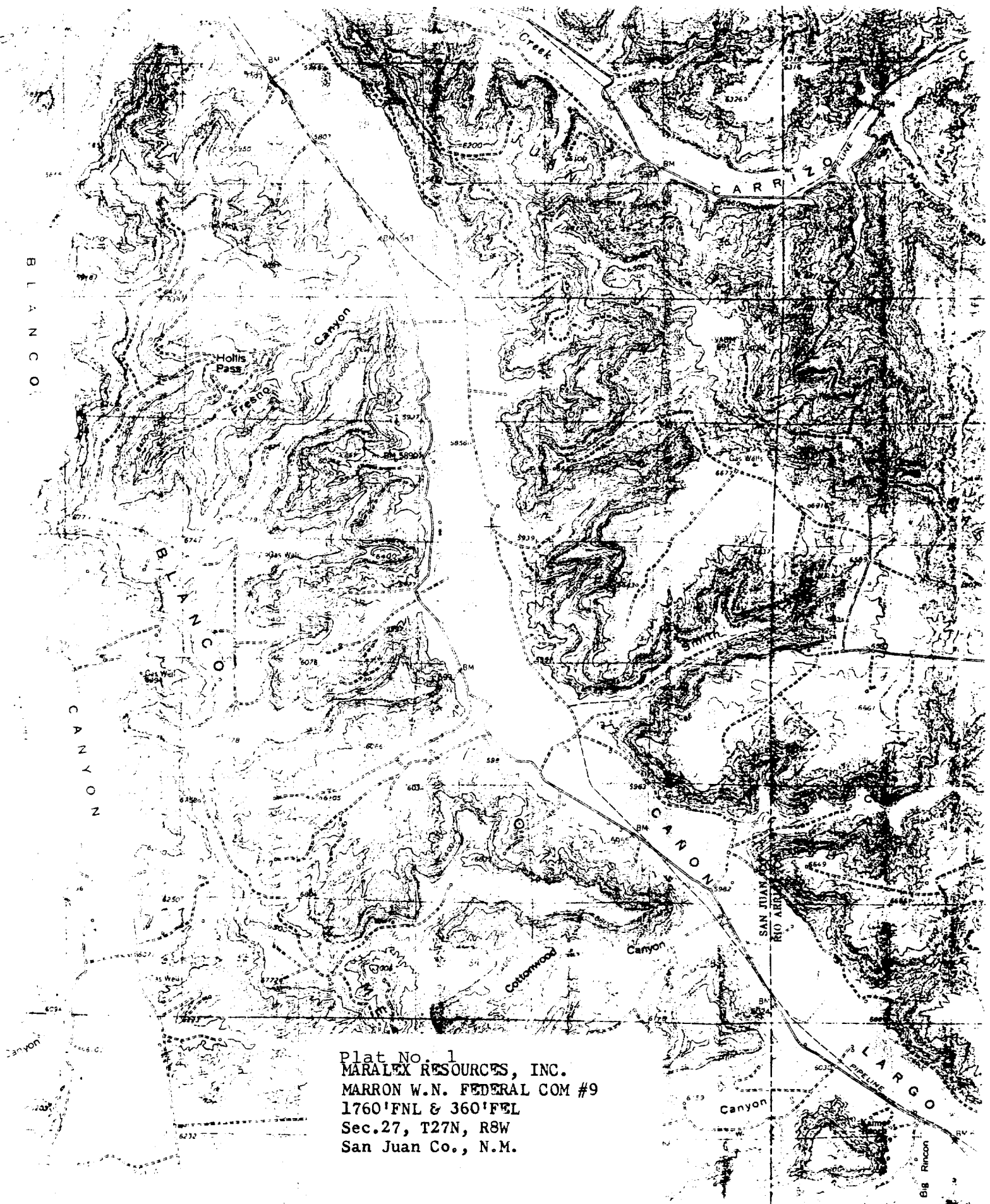

Plat No. 1  
MARALEX RESOURCES, INC.  
MARRON W.N. FEDERAL COM #9  
1760'FNL & 360'FEL  
Sec.27, T27N, R8W  
San Juan Co., N.M.

SCALE 1:500