

UNITED STATES
DEPARTMENT OF THE INTERIOR
BUREAU OF LAND MANAGEMENT

30-045-28800

APPLICATION FOR PERMIT TO DRILL, DEEPEN, OR PLUG BACK

1a. TYPE OF WORK

DRILL ☒

DEEPEN ☐

PLUG BACK ☐

b. TYPE OF WELL

OIL
WELL ☐

GAS
WELL ☒

OTHER ☐

SINGLE
ZONE ☒

MULTIPLE
ZONE ☐

2. NAME OF OPERATOR

Bonneville Fuels Corporation

3. ADDRESS OF OPERATOR

1660 Lincoln St., Suite 1800 Denver, CO 80264

4. LOCATION OF WELL (Report location clearly and in accordance with any State requirements.)*

At surface

1190' FSL, 790' FWL

At proposed prod. zone

same

14. DISTANCE IN MILES AND DIRECTION FROM NEAREST TOWN OR POST OFFICE*

10 miles southwest of Bloomfield, New Mexico

16. DISTANCE FROM PROPOSED*

LOCATION TO NEAREST
PROPERTY OR LEASE LINE, FT.
(Also to nearest drlg. unit line, if any)

4490'

18. NO. OF ACRES IN LEASE

2560

18. DISTANCE FROM PROPOSED LOCATION*

TO NEAREST WELL, DRILLING, COMPLETED,
OR APPLIED FOR, ON THIS LEASE, FT.

3990'

19. PROPOSED DEPTH

2050'

17. NO. OF ACRES ASSIGNED

TO THIS WELL 320 acres
S/2 Sec. 13, T27N, R11W

20. ROTARY OR CABLE TOOLS

Rotary

21. ELEVATIONS (Show whether DF, RT, GR, etc.)

6050 GR

This action is subject to technical and
procedural review pursuant to 43 CFR 3166.3
and appeal pursuant to 43 CFR 3166.4

22. APPROX. DATE WORK WILL START*

November 1, 1992

23.

PROPOSED CASING AND CEMENTING PROGRAM

SIZE OF HOLE	SIZE OF CASING	WEIGHT PER FOOT	SETTING DEPTH	QUANTITY OF CEMENT GENERAL REQUIREMENTS
12 1/4	8 5/8	24#	+300'	250 SX (Circ to Surf)
7 7/8	5 1/2	15.5#	+2050'	500 SX (Circ to Surf)

Exhibits Attached

Ten point Compliance program
Surface Use & Operation Plan

- Exh. 1. Blowout preventer
- Exh. 2. Location & Elevation
- Exh. 3. Vicinity map
- Exh. 4. One mile radius map
- Exh. 5. Topography & pad layout
- Exh. 6. Cross sections & volumes
- Exh. 7. Rig layout
- Exh. 8. Production facility layout

RECEIVED
OCT 08 1992

OIL CON. DIV.

APPROVED
AS AMENDED

OCT 06 1992
J. M. Keller
AREA MANAGER

RECEIVED
OIL CON. DIV.
SEP 16 11:11:00
BLM

IN ABOVE SPACE DESCRIBE PROPOSED PROGRAM: If proposal is to deepen or plug back, give data on present productive zone and proposed new productive zone. If proposal is to drill or deepen directionally, give pertinent data on subsurface locations and measured and true vertical depths. Give blowout preventer program, if any.

24.

SIGNED

Lawrence D. Lillo

TITLE

Land Manager

DATE

September 4, 1992

(This space for Federal or State office use)

PERMIT NO.

APPROVAL DATE

APPROVED BY

TITLE

CONDITIONS OF APPROVAL, IF ANY:

ch. 5C

NMOOD

*See Instructions On Reverse Side

Title 18 U.S.C. Section 1001, makes it a crime for any person knowingly and willfully to make to any department or agency of the United States any false, fictitious or fraudulent statements or representations as to any matter within its jurisdiction.

APPROVED
AS AMENDED

SEP 22 1992

AREA MANAGER

UNITED STATES
DEPARTMENT OF THE INTERIOR
BUREAU OF LAND MANAGEMENT

APPLICATION FOR PERMIT TO DRILL, DEEPEN, OR PLUG BACK

1a. TYPE OF WORK

DRILL ☒

DEEPEN ☐

PLUG BACK ☐

b. TYPE OF WELL

OIL
WELL ☐

GAS
WELL ☒

OTHER

SINGLE
ZONE ☒

MULTIPLE
ZONE ☐

2. NAME OF OPERATOR

Bonneville Fuels Corporation

3. ADDRESS OF OPERATOR

1600 Broadway, Suite 1110, Denver, CO 80202

4. LOCATION OF WELL (Report location clearly and in accordance with any State requirements.)*

At surface

1190 FSL, 790 FWL

At proposed prod. zone

same

14. DISTANCE IN MILES AND DIRECTION FROM NEAREST TOWN OR POST OFFICE*

10 miles southwest of Bloomfield, New Mexico

16. DISTANCE FROM PROPOSED*

LOCATION TO NEAREST
PROPERTY OR LEASE LINE, FT.
(Also to nearest drg. unit line, if any)

4490

18. DISTANCE FROM PROPOSED LOCATION*

TO NEAREST WELL, DRILLING, COMPLETED,
OR APPLIED FOR, ON THIS LEASE, FT.

3990

10. NO. OF ACRES IN LEASE

2560

10. PROPOSED DEPTH

2050

17. NO. OF ACRES ASSIGNED
TO THIS WELL

320

20. ROTARY OR CABLE TOOLS

Rotary

21. ELEVATIONS (Show

6050 GR

whether DE, RT, GR, etc.)
This action is subject to technical and
procedural review pursuant to 43 CFR 3165.3
and appeal pursuant to 43 CFR 3165.4.

22. APPROX. DATE WORK WILL START*

October 1, 1990

23.

PROPOSED CASING AND CEMENTING PROGRAM

DRILLING OPERATIONS AUTHORIZED ARE
SUBJECT TO COMPLIANCE WITH ATTACHED
"GENERAL REQUIREMENTS"

SIZE OF HOLE	SIZE OF CASING	WEIGHT PER FOOT	SETTING DEPTH	QUANTITY OF CEMENT
12 1/4	8 5/8	24#	± 300'	250 sx (Circ to surf)
7 7/8	4 1/2	11-60#	± 2050	500 sx (Circ to surf)
	5	15.5		

Exhibits Attached:

Exhibit 8 Production Facility Layout

Ten Point Compliance Program

Surface Use & Operation Plan

Exhibit 1 Blowout Preventer

" 2 Location & Elevation

" 3 Vicinity Map

" 4 One Mile Radius Map

" 5 Topography & Pad Layout

" 6 Cross Sections & Volumes

" 7 Rig Layout

IN ABOVE SPACE DESCRIBE PROPOSED PROGRAM: If proposal is to deepen or plug back, give data on present productive zone and proposed new productive zone. If proposal is to drill or deepen directionally, give pertinent data on subsurface locations and measured and true vertical depths. Give blowout preventer program, if any.

24.

SIGNED

[Signature]

TITLE Operations Supervisor

DATE August 20, 1990

(This space for Federal or State office use)

90-944

PERMIT NO.

APPROVAL DATE

APPROVED BY

TITLE

DATE

CONDITIONS OF APPROVAL, IF ANY:

FARMINGTON COPY

AREA MANAGER

*See Instructions On Reverse Side

Title 18 U.S.C. Section 1001, makes it a crime for any person knowingly and willfully to make to any department or agency of the

Submit to Appropriate
District Office
State Lease - 4 copies
Fee Lease - 3 copies

State of New Mexico
Energy, Minerals and Natural Resources Department

Form C-102
Revised 1-1-89

OIL CONSERVATION DIVISION

P.O. Box 2088
Santa Fe, New Mexico 87504-2088

DISTRICT I
P.O. Box 1980, Hobbs, NM 88240

DISTRICT II
P.O. Drawer DD, Artesia, NM 88210

DISTRICT III
1000 Rio Brazos Rd., Aztec, NM 87410

WELL LOCATION AND ACREAGE DEDICATION PLAT

All Distances must be from the outer boundaries of the section

Operator BONNEVILLE FUELS CORPORATION			Lease FULLERTON FEDERAL		Well No. 13-14
Unit Letter M	Section 13	Township 27N	Range 11W	County NMPM San Juan	
Actual Footage Location of Well: 1190 feet from the South line and 790 feet from the West line					
Ground level Elev. 6050	Producing Formation Fert Coal		Pool San Juan Coal	Dedicated Acreage: 320 Acres	

- Outline the acreage dedicated to the subject well by colored pencil or hatchure marks on the plat below.
- If more than one lease is dedicated to the well, outline each and identify the ownership thereof (both as to working interest and royalty).
- If more than one lease of different ownership is dedicated to the well, have the interest of all owners been consolidated by communitization, unitization, force-pooling, etc.?
☐ Yes ☐ No If answer is "yes" type of consolidation _____
If answer is "no" list the owners and tract descriptions which have actually been consolidated. (Use reverse side of this form if necessary).
No allowable will be assigned to the well until all interests have been consolidated (by communitization, unitization, forced-pooling, or otherwise) or until a non-standard unit, eliminating such interest, has been approved by the Division.

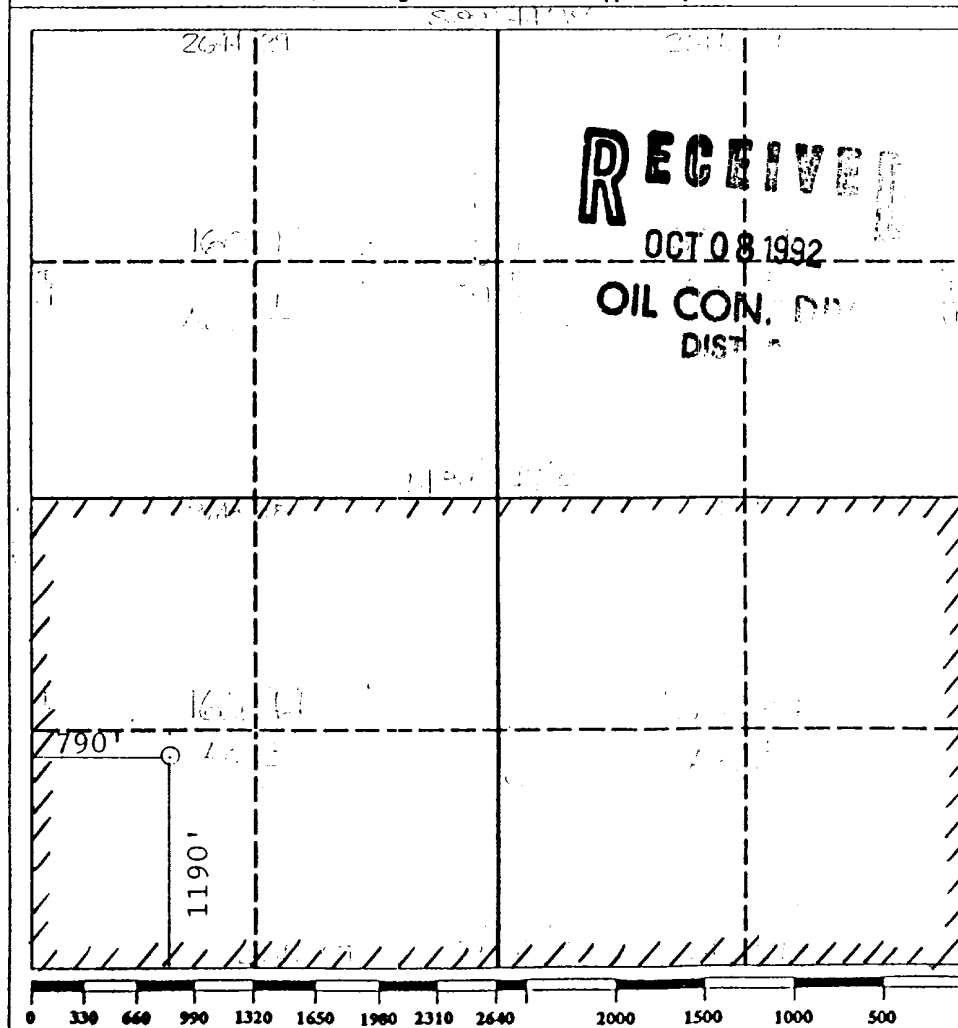

OPERATOR CERTIFICATION

I hereby certify that the information contained herein is true and complete to the best of my knowledge and belief.

Signature

Gerald D. Gentry

Printed Name

Gerald D. Gentry

Position

Operations Supervisor

Company

Bonneville Fuels Corporation

Date

August 20, 1990

SURVEYOR CERTIFICATION

I hereby certify that the well location shown on this plat was plotted from field notes of actual surveys made by me or under my supervision, and that the same is true and correct to the best of my knowledge and belief.

August 7, 1990

Date Surveyed

Cecil B. Tullis
Cecil B. Tullis

Signature of Professional Surveyor

Professional Surveyor

Certificate No.

9672

UNITED STATES
DEPARTMENT OF THE INTERIOR
BUREAU OF LAND MANAGEMENT

SUBMIT IN TRIPL
(Other instructions
verse side)

Budget Bureau No. 1004-0135
Expires August 31, 1985

5. LEASE DESIGNATION AND SERIAL NO.

SF-078094

6. IF INDIAN, ALLOTTEE OR TRIBE NAME

7. UNIT AGREEMENT NAME

8. FARM OR LEASE NAME

Fullerton Federal

9. WELL NO.

13-14

10. FIELD AND POOL, OR WILDCAT

Basin Fruitland

11. SEC., T., R., M., OR BLK. AND
SURVEY OR AREA

13M T27N R11W

12. COUNTY OR PARISH

San Juan

13. STATE

NM

1. OIL ☐ GAS ☐
WELL WELL OTHER

2. NAME OF OPERATOR

Bonneville Fuels Corporation

3. ADDRESS OF OPERATOR

1600 Broadway, Suite 1110, Denver, CO 80202

4. LOCATION OF WELL (Report location clearly and in accordance with any State requirements.*
See also space 17 below.)
At surface

1190' FSL, 790' FWL

14. PERMIT NO.

15. ELEVATIONS (Show whether DF, RT, GR, etc.)

6050' GR

16. Check Appropriate Box To Indicate Nature of Notice, Report, or Other Data

NOTICE OF INTENTION TO:

TEST WATER SHUT-OFF

FRACTURE TREAT

SHOOT OR ACIDIZE

REPAIR WELL

(Other)

PULL OR ALTER CASING

MULTIPLE COMPLETE

ABANDON*

CHANGE PLANS

SUBSEQUENT REPORT OF:

WATER SHUT-OFF

FRACTURE TREATMENT

SHOOTING OR ACIDIZING

(Other)

REPAIRING WELL

ALTERING CASING

ABANDONMENT*

(NOTE: Report results of multiple completion on Well
Completion or Recompletion Report and Log form.)

17. DESCRIBE PROPOSED OR COMPLETED OPERATIONS (Clearly state all pertinent details, and give pertinent dates, including estimated date of starting any proposed work. If well is directionally drilled, give subsurface locations and measured and true vertical depths for all markers and zones pertinent to this work.)*

Change BOPE system from 3M system to a 2M system and use target tees (high pressure where necessary).

18. I hereby certify that the foregoing is true and correct

SIGNED

Doris Maly

TITLE

Engineering Tech

DATE

11/6/90

(This space for Federal or State office use)

APPROVED BY

CONDITIONS OF APPROVAL, IF ANY:

TITLE

FARMINGTON COPY

APPROVED

NOV 09 1990

for **AREA MANAGER**

*See Instructions on Reverse Side

UNITED STATES
DEPARTMENT OF THE INTERIOR
BUREAU OF LAND MANAGEMENT

SUBMIT IN TRIPL
(Other instructions
verse side)

Budget Bureau No. 1004-0135
Expires August 31, 1985

SUNDRY NOTICES AND REPORTS ON WELLS

(Do not use this form for proposals to drill or to deepen or plug back to a different reservoir.
Use "APPLICATION FOR PERMIT—" for such proposals.)

1. OIL WELL <input type="checkbox"/> GAS WELL <input checked="" type="checkbox"/> OTHER <input type="checkbox"/>		50 OCT 12 PM 1:35	
2. NAME OF OPERATOR Bonneville Fuels Corporation		FARMINGTON, NEW MEXICO	
3. ADDRESS OF OPERATOR 1600 Broadway, Suite 1110, Denver, CO 80202		7. UNIT AGREEMENT NAME	
4. LOCATION OF WELL (Report location clearly and in accordance with any State requirements.* See also space 17 below.) At surface 1190' FSL, 790' FWL		8. FARM OR LEASE NAME Fullerton Federal	
14. PERMIT NO.		9. WELL NO. 13-14	
15. ELEVATIONS (Show whether DF, RT, GR, etc.) 6050' GR		10. FIELD AND POOL, OR WILDCAT Basin Fruitland	
		11. SEC., T., R., M., OR BLK. AND SURVEY OR AREA 13M T27N R11W	
		12. COUNTY OR PARISH San Juan	13. STATE NM

16. Check Appropriate Box To Indicate Nature of Notice, Report, or Other Data

NOTICE OF INTENTION TO:		SUBSEQUENT REPORT OF:	
TEST WATER SHUT-OFF <input type="checkbox"/>	PULL OR ALTER CASING <input type="checkbox"/>	WATER SHUT-OFF <input type="checkbox"/>	REPAIRING WELL <input type="checkbox"/>
FRACTURE TREAT <input type="checkbox"/>	MULTIPLE COMPLETE <input type="checkbox"/>	FRACTURE TREATMENT <input type="checkbox"/>	ALTERING CASING <input type="checkbox"/>
SHOOT OR ACIDIZE <input type="checkbox"/>	ABANDON* <input checked="" type="checkbox"/>	SHOOTING OR ACIDIZING <input type="checkbox"/>	ABANDONMENT* <input type="checkbox"/>
REPAIR WELL <input type="checkbox"/>	CHANGE PLANS <input checked="" type="checkbox"/>	(Other) <input type="checkbox"/>	(Other) <input type="checkbox"/>
(Other) <input type="checkbox"/>		(NOTE: Report results of multiple completion on Well Completion or Recompletion Report and Log form.)	

17. DESCRIBE PROPOSED OR COMPLETED OPERATIONS (Clearly state all pertinent details, and give pertinent dates, including estimated date of starting any proposed work. If well is directionally drilled, give subsurface locations and measured and true vertical depths for all markers and zones pertinent to this work.)*

Change of Proposed Casing and Cementing Program.

Casing will be:

Size of Hole: 7 7/8". Casing 5 1/2" 15.50# J-55 8rd.

Cementing will be:

Lead - \pm 155 sx 65/35/6 with 2% CaCl_2 , 1/4#/sx celloflake + 0.8% fluid loss additive.

Cement properties: 12.7 ppg, yield 1.72 ft³/sx.

Tail - \pm 100 sx Class 'B' with 1% CaCl_2 + 0.2% fluid loss additive.

Cement properties: 15.6 ppg, yield 1.17 ft³/sx.

18. I hereby certify that the foregoing is true and correct

SIGNED

Doris Maly

TITLE

Engineering Technician

DATE

10-9-90

(This space for Federal or State office use)

APPROVED BY

TITLE

CONDITIONS OF APPROVAL, IF ANY:

APPROVED

NOV 02, 1990

DATE

AREA MANAGER
FARMINGTON

*See Instructions on Reverse Side
FARMINGTON COPY

BONNEVILLE FUELS CORPORATION
 FULLERTON FEDERAL #13-14
 SW $\frac{1}{4}$, SW $\frac{1}{4}$ Sec. 13 T27N R11W N.M.P.M.
 San Juan Co., New Mexico

KUTZ CANYON

6423

EXHIBIT 3

45989