

Submit to Appropriate
District Office
State Lease - 4 copies
Fee Lease - 3 copies

State of New Mexico
Energy, Minerals and Natural Resources Department

Form C-102
Revised 1-1-89

OIL CONSERVATION DIVISION

P.O. Box 2088
Santa Fe, New Mexico 87504-2088

DISTRICT I
P.O. Box 1980, Hobbs, NM 88240

DISTRICT II
P.O. Drawer DD, Artesia, NM 88210

DISTRICT III
1000 Rio Brazos Rd., Aztec, NM 87410

WELL LOCATION AND ACREAGE DEDICATION PLAT

All Distances must be from the outer boundaries of the section

Operator LOUIS DREYFUS NATURAL GAS CORP.			Lease HANCOCK 12		Well No. 42-12
Unit Letter H	Section 12	Township 27 N	Range 12 W	County San Juan	
Actual Footage Location of Well: 2173 feet from the North line and 1310 feet from the East line					
Ground Level Elev. 6079	Producing Formation FRUITLAND COAL		Pool BASIN FRUITLAND COAL	Dedicated Acreage: 320 Acres	
<p>1. Outline the acreage dedicated to the subject well by colored pencil or hatchure marks on the plat below.</p> <p>2. If more than one lease is dedicated to the well, outline each and identify the ownership thereof (both as to working interest and royalty).</p> <p>3. If more than one lease of different ownership is dedicated to the well, have the interest of all owners been consolidated by communitization, unitization, force-pooling, etc.? <input type="checkbox"/> Yes <input type="checkbox"/> No If answer is "yes" type of consolidation _____</p> <p>If answer is "no" list the owners and tract descriptions which have actually been consolidated. (Use reverse side of this form if necessary.) _____</p> <p>No allowable will be assigned to the well until all interests have been consolidated (by communitization, unitization, forced-pooling, or otherwise) or until a non-standard unit, eliminating such interest, has been approved by the Division.</p>					

0 350 480 600 720 840 960 1080 1200 1320 1440 1560 1680 1800 1920 2040 2160 2280 2400 2520 2640 2760 2880 3000 3120 3240 3360 3480 3600 3720 3840 3960 4080 4200 4320 4440 4560 4680 4800 4920 5040 5160 5280 5400 5520 5640 5760 5880 6000 6120 6240 6360 6480 6600 6720 6840 6960 7080 7200 7320 7440 7560 7680 7800 7920 8040 8160 8280 8400 8520 8640 8760 8880 9000 9120 9240 9360 9480 9600 9720 9840 9960 10080 10200 10320 10440 10560 10680 10800 10920 11040 11160 11280 11400 11520 11640 11760 11880 12000 12120 12240 12360 12480 12600 12720 12840 12960 13080 13200 13320 13440 13560 13680 13800 13920 14040 14160 14280 14400 14520 14640 14760 14880 15000 15120 15240 15360 15480 15600 15720 15840 15960 16080 16200 16320 16440 16560 16680 16800 16920 17040 17160 17280 17400 17520 17640 17760 17880 18000 18120 18240 18360 18480 18600 18720 18840 18960 19080 19200 19320 19440 19560 19680 19800 19920 20040 20160 20280 20400 20520 20640 20760 20880 21000 21120 21240 21360 21480 21600 21720 21840 21960 22080 22200 22320 22440 22560 22680 22800 22920 23040 23160 23280 23400 23520 23640 23760 23880 24000 24120 24240 24360 24480 24600 24720 24840 24960 25080 25200 25320 25440 25560 25680 25800 25920 26040 26160 26280 26400 26520 26640 26760 26880 27000 27120 27240 27360 27480 27600 27720 27840 27960 28080 28200 28320 28440 28560 28680 28800 28920 29040 29160 29280 29400 29520 29640 29760 29880 30000 30120 30240 30360 30480 30600 30720 30840 30960 31080 31200 31320 31440 31560 31680 31800 31920 32040 32160 32280 32400 32520 32640 32760 32880 33000 33120 33240 33360 33480 33600 33720 33840 33960 34080 34200 34320 34440 34560 34680 34800 34920 35040 35160 35280 35400 35520 35640 35760 35880 36000 36120 36240 36360 36480 36600 36720 36840 36960 37080 37200 37320 37440 37560 37680 37800 37920 38040 38160 38280 38400 38520 38640 38760 38880 39000 39120 39240 39360 39480 39600 39720 39840 39960 40080 40200 40320 40440 40560 40680 40800 40920 41040 41160 41280 41400 41520 41640 41760 41880 42000 42120 42240 42360 42480 42600 42720 42840 42960 43080 43200 43320 43440 43560 43680 43800 43920 44040 44160 44280 44400 44520 44640 44760 44880 45000 45120 45240 45360 45480 45600 45720 45840 45960 46080 46200 46320 46440 46560 46680 46800 46920 47040 47160 47280 47400 47520 47640 47760 47880 48000 48120 48240 48360 48480 48600 48720 48840 48960 49080 49200 49320 49440 49560 49680 49800 49920 50040 50160 50280 50400 50520 50640 50760 50880 51000 51120 51240 51360 51480 51600 51720 51840 51960 52080 52200 52320 52440 52560 52680 52800 52920 53040 53160 53280 53400 53520 53640 53760 53880 54000 54120 54240 54360 54480 54600 54720 54840 54960 55080 55200 55320 55440 55560 55680 55800 55920 56040 56160 56280 56400 56520 56640 56760 56880 57000 57120 57240 57360 57480 57600 57720 57840 57960 58080 58200 58320 58440 58560 58680 58800 58920 59040 59160 59280 59400 59520 59640 59760 59880 60000 60120 60240 60360 60480 60600 60720 60840 60960 61080 61200 61320 61440 61560 61680 61800 61920 62040 62160 62280 62400 62520 62640 62760 62880 63000 63120 63240 63360 63480 63600 63720 63840 63960 64080 64200 64320 64440 64560 64680 64800 64920 65040 65160 65280 65400 65520 65640 65760 65880 66000 66120 66240 66360 66480 66600 66720 66840 66960 67080 67200 67320 67440 67560 67680 67800 67920 68040 68160 68280 68400 68520 68640 68760 68880 69000 69120 69240 69360 69480 69600 69720 69840 69960 70080 70200 70320 70440 70560 70680 70800 70920 71040 71160 71280 71400 71520 71640 71760 71880 72000 72120 72240 72360 72480 72600 72720 72840 72960 73080 73200 73320 73440 73560 73680 73800 73920 74040 74160 74280 74400 74520 74640 74760 74880 75000 75120 75240 75360 75480 75600 75720 75840 75960 76080 76200 76320 76440 76560 76680 76800 76920 77040 77160 77280 77400 77520 77640 77760 77880 78000 78120 78240 78360 78480 78600 78720 78840 78960 79080 79200 79320 79440 79560 79680 79800 79920 80040 80160 80280 80400 80520 80640 80760 80880 81000 81120 81240 81360 81480 81600 81720 81840 81960 82080 82200 82320 82440 82560 82680 82800 82920 83040 83160 83280 83400 83520 83640 83760 83880 84000 84120 84240 84360 84480 84600 84720 84840 84960 85080 85200 85320 85440 85560 85680 85800 85920 86040 86160 86280 86400 86520 86640 86760 86880 87000 87120 87240 87360 87480 87600 87720 87840 87960 88080 88200 88320 88440 88560 88680 88800 88920 89040 89160 89280 89400 89520 89640 89760 89880 90000 90120 90240 90360 90480 90600 90720 90840 90960 91080 91200 91320 91440 91560 91680 91800 91920 92040 92160 92280 92400 92520 92640 92760 92880 93000 93120 93240 93360 93480 93600 93720 93840 93960 94080 94200 94320 94440 94560 94680 94800 94920 95040 95160 95280 95400 95520 95640 95760 95880 96000 96120 96240 96360 96480 96600 96720 96840 96960 97080 97200 97320 97440 97560 97680 97800 97920 98040 98160 98280 98400 98520 98640 98760 98880 99000 99120 99240 99360 99480 99600 99720 99840 99960 100000

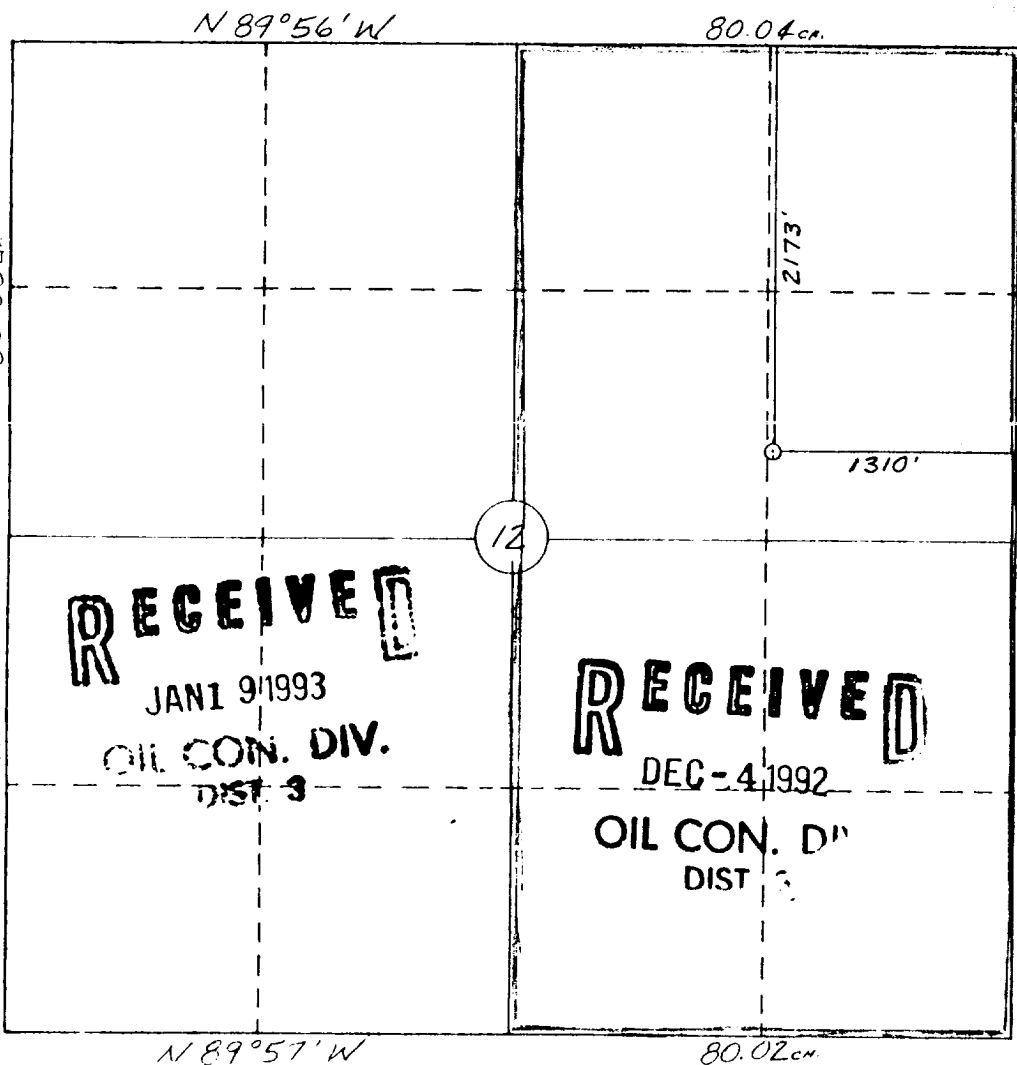

OPERATOR CERTIFICATION

I hereby certify that the information contained herein is true and complete to the best of my knowledge and belief.

Signature
R.L. Flowers Jr.
Printed Name
R.L. Flowers Jr.
Position
Dist Operations Manager
Company
Louis Dreyfus Natural Gas Corp.
Date
12/21/92

SURVEYOR CERTIFICATION

I hereby certify that the well location shown on this plat was plotted from field notes of actual surveys made by me or under my supervision, and that the same is true and correct to the best of my knowledge and belief Re-issued 12-4-92

Date Surveyed
William E. Mahnke II
Signature & Seal of Professional Surveyor
#8466
Certification No. 8466
PROFESSIONAL SURVEYOR