

UNITED STATES
DEPARTMENT OF THE INTERIOR

BUREAU OF LAND MANAGEMENT

APPLICATION FOR PERMIT TO DRILL OR DEEPEN

1a. TYPE OF WORK

DRILL ☒

DEEPEN ☐

b. TYPE OF WELL

OIL WELL ☐

GAS WELL ☒

OTHER ☐

SINGLE ZONE ☐

MULTIPLE ZONE ☒

2. NAME OF OPERATOR

Attention:

Amoco Production Company

Julie L. Acevedo

3. ADDRESS AND TELEPHONE NO.

P.O. Box 800, Denver, Colorado 80201

4. LOCATION OF WELL (Report location clearly and in accordance with any State requirements.)

At surface

1790FNL

1570FWL

At proposed prod. zone

14. DISTANCE IN MILES AND DIRECTION FROM NEAREST TOWN OR POST OFFICE*

3.4 Miles From Aztec, N.M.

15. DISTANCE FROM PROPOSED* LOCATION TO NEAREST PROPERTY OR LEASE LINE, FT. (Also to nearest drig. unit line, if any)

16. NO. OF ACRES IN LEASE

1266.8

17. NO. OF ACRES ASSIGNED TO THIS WELL

N/2 308.

18. DISTANCE FROM PROPOSED LOCATION* TO NEAREST WELL, DRILLING, COMPLETED, OR APPLIED FOR, ON THIS LEASE, FT.

19. PROPOSED DEPTH

6890'

20. ROTARY OR CABLE TOOLS

Rotary

21. ELEVATIONS (Show whether DF, RT, GR., etc.)

5859' GL

22. APPROX. DATE WORK WILL START*

01-13-94

23.

PROPOSED CASING AND CEMENTING PROGRAM

SIZE OF HOLE	GRADE, SIZE OF CASING	WEIGHT PER FOOT	SETTING DEPTH	QUANTITY OF CEMENT
17 1/2"	13-3/8"	61#	400'	625 cf CI B W/2% CaCl2 (Cement to surface)
12-1/4"	9-5/8"	36#	2445'	1688 cf CI B (Cement to surface)
8-3/4"	7"	23#	6370'	1001 cf CL B (Cement to surface)

6 1/4"

4 1/2"

11.6#

6170'-6890' Liner 126cf CI G

Notice of Staking submitted on 11/12/93 as Ref. 10149. Arch survey as Ref. 10149

Lease Description:

T28N-R8W:

Sec. 26:S/2

Sec. 27: N/2

Sec. 34: N/2

Sec. 35: Lots 1, 2, 3, 4, N/2S/2

CONFIDENTIAL

RECEIVED
JAN 03 1994
OIL CON. DIV.
DIST. 3

IN ABOVE SPACE DESCRIBE PROPOSED PROGRAM: If proposal is to deepen, give data on present productive zone and proposed new productive zone. If proposal is to drill or deepen directionally, give pertinent data on subsurface locations and measured and true vertical depths. Give blowout preventer program, if any.

24.

SIGNED

Julie L. Acevedo

TITLE Sr. Staff Assistant

DATE

12-13-1993

(This space for Federal or State office use)

PERMIT NO.

APPROVAL DATE

Application approval does not warrant or certify that the applicant holds legal or equitable title to those rights in the subject lease which would entitle the applicant to conduct operations thereon.

CONDITIONS OF APPROVAL, IF ANY:

APPROVED BY

ok

TITLE

AMOCO

*See Instructions On Reverse Side

Title 18 U.S.C. Section 1001, makes it a crime for any person knowingly and willfully to make to any department or agency of the United States any false, fictitious or fraudulent statements or representations as to any matter within its jurisdiction.

Form approved.
Budget Bureau No.1004-0136
Expires: December 31, 1991

5. LEASE DESIGNATION AND SERIAL NO.

SF-078566

6. IF INDIAN, ALLOTTEE OR TRIBE NAME

7. UNIT AGREEMENT NAME

8. FARM OR LEASE NAME, WELL NO.

Storey LS #4A

9. API WELL NO.

10. FIELD AND POOL, OR WILDCAT

Blanco Mesaverde/Basin Dakota

11. SEC., T., R., M., OR BLK. AND SURVEY OR AREA

Section 34

Township 28N

Range 8W

12. COUNTY OR PARISH

San Juan

13. STATE

New Mexico

15. DISTANCE FROM PROPOSED* LOCATION TO NEAREST PROPERTY OR LEASE LINE, FT. (Also to nearest drig. unit line, if any)

16. NO. OF ACRES IN LEASE

1266.8

17. NO. OF ACRES ASSIGNED TO THIS WELL

N/2 308.

18. DISTANCE FROM PROPOSED LOCATION* TO NEAREST WELL, DRILLING, COMPLETED, OR APPLIED FOR, ON THIS LEASE, FT.

19. PROPOSED DEPTH

6890'

20. ROTARY OR CABLE TOOLS

Rotary

21. ELEVATIONS (Show whether DF, RT, GR., etc.)

5859' GL

22. APPROX. DATE WORK WILL START*

01-13-94

23.

PROPOSED CASING AND CEMENTING PROGRAM

SIZE OF HOLE	GRADE, SIZE OF CASING	WEIGHT PER FOOT	SETTING DEPTH	QUANTITY OF CEMENT
17 1/2"	13-3/8"	61#	400'	625 cf CI B W/2% CaCl2 (Cement to surface)
12-1/4"	9-5/8"	36#	2445'	1688 cf CI B (Cement to surface)
8-3/4"	7"	23#	6370'	1001 cf CL B (Cement to surface)

6 1/4"

4 1/2"

11.6#

6170'-6890' Liner 126cf CI G

Notice of Staking submitted on 11/12/93 as Ref. 10149. Arch survey as Ref. 10149

Lease Description:

T28N-R8W:

Sec. 26:S/2

Sec. 27: N/2

Sec. 34: N/2

Sec. 35: Lots 1, 2, 3, 4, N/2S/2

CONFIDENTIAL

RECEIVED
JAN 03 1994
OIL CON. DIV.
DIST. 3

IN ABOVE SPACE DESCRIBE PROPOSED PROGRAM: If proposal is to deepen, give data on present productive zone and proposed new productive zone. If proposal is to drill or deepen directionally, give pertinent data on subsurface locations and measured and true vertical depths. Give blowout preventer program, if any.

24.

SIGNED

Julie L. Acevedo

TITLE Sr. Staff Assistant

DATE

12-13-1993

(This space for Federal or State office use)

PERMIT NO.

APPROVAL DATE

Application approval does not warrant or certify that the applicant holds legal or equitable title to those rights in the subject lease which would entitle the applicant to conduct operations thereon.

CONDITIONS OF APPROVAL, IF ANY:

APPROVED BY

ok

TITLE

AMOCO

*See Instructions On Reverse Side

Title 18 U.S.C. Section 1001, makes it a crime for any person knowingly and willfully to make to any department or agency of the United States any false, fictitious or fraudulent statements or representations as to any matter within its jurisdiction.

APPROVED
AS AMENDED

DEC 22 1993

DISTRICT MANAGER

Submit to Appropriate
District Office
State Lease - 4 copies
Fee Lease - 3 copies

Energy, Minerals and Natural Resources Department

Revised 1-1-89

OIL CONSERVATION DIVISION

P.O. Box 2088
Santa Fe, New Mexico 87504-2088

DISTRICT I
P.O. Box 1980, Hobbs, NM 88240

DISTRICT II
P.O. Drawer DD, Artesia, NM 88210

DISTRICT III
1000 Rio Brazos Rd., Aztec, NM 87410

WELL LOCATION AND ACREAGE DEDICATION PLAT

All Distances must be from the outer boundaries of the section

Operator AMOCO PRODUCTION COMPANY			Lease Storey Reference LS	Well No. 4A # 10149
Unit Letter F	Section 34	Township 28 NORTH	Range 8 WEST NMPM	County SAN JUAN
Actual Footage Location of Well: 1790 feet from the NORTH line and 1570 feet from the WEST line				
Ground level Elev. 5857	Producing Formation Basin Dakota	Pool Basin Dakota	Dedicated Acreage: N/2 320 / 320 Acres	

- Outline the acreage dedicated to the subject well by colored pencil or hatchure marks on the plat below.
- If more than one lease is dedicated to the well, outline each and identify the ownership thereof (both as to working interest and royalty).
- If more than one lease of different ownership is dedicated to the well, have the interest of all owners been consolidated by communization, unitization, force-pooling, etc.?
☐ Yes ☐ No If answer is "yes" type of consolidation _____
If answer is "no" list the owners and tract descriptions which have actually been consolidated. (Use reverse side of this form if necessary.)
No allowable will be assigned to the well until all interests have been consolidated (by communization, unitization, forced-pooling, or otherwise) or until a non-standard unit, eliminating such interest, has been approved by the Division.

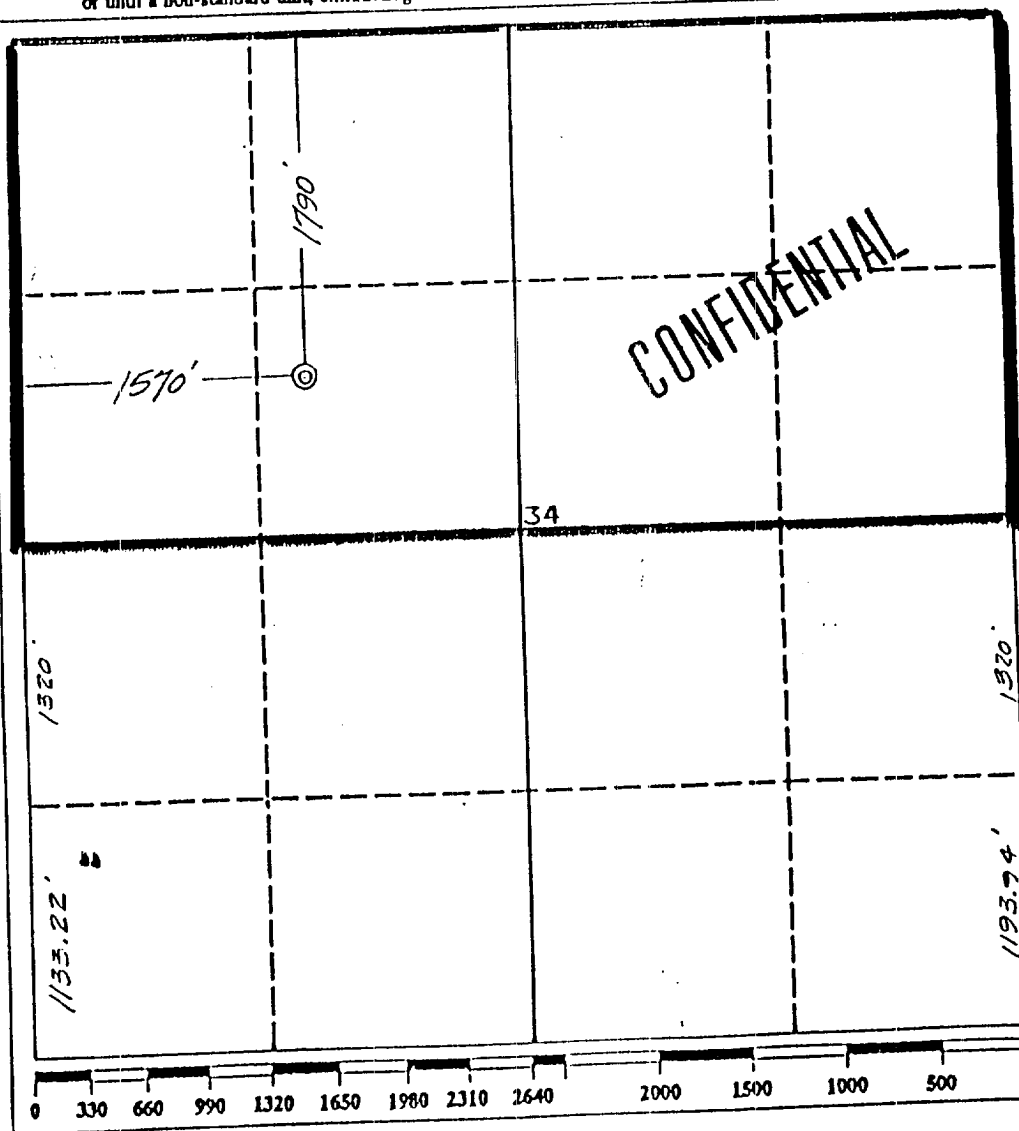

OPERATOR CERTIFICATION

I hereby certify that the information contained herein is true and complete to the best of my knowledge and belief.

Signature
DeAnne Tallant
Printed Name

DeAnne Tallant
Position
Staff Assistant

Company
Amoco Production Co.

Date
11-12-93

SURVEYOR CERTIFICATION

I hereby certify that the well location shown on this plat was plotted from field notes of actual surveys made by me or under my supervision, and that the same is true and correct to the best of my knowledge and belief.

Date Surveyed
September 29, 1993

Signature & Seal of
Professional Surveyor
Gary D. Vann
7016
Gary Vann
7016
REGISTERED PROFESSIONAL LAND SURVEYOR

Submit to Appropriate
District Office
State Lease - 4 copies
Fee Lease - 3 copies

State of New Mexico
Energy, Minerals and Natural Resources Department

Form C-102
Revised 1-1-89

OIL CONSERVATION DIVISION

P.O. Box 2088
Santa Fe, New Mexico 87504-2088

DISTRICT I
P.O. Box 1980, Hobbs, NM 88240

DISTRICT II
P.O. Drawer DD, Artesia, NM 88210

DISTRICT III
1000 Rio Brazos Rd., Aztec, NM 87410

WELL LOCATION AND ACREAGE DEDICATION PLAT
All Distances must be from the outer boundaries of the section

Operator AMOCO PRODUCTION COMPANY			Lease STORY LS Reference		Well No. # 10149
Unit Letter F	Section 34	Township 28 NORTH	Range 8 WEST	County SAN JUAN	
Actual Footage Location of Well: 1790 feet from the NORTH line and 1570 feet from the WEST line					
Ground level Elev. 5859	Producing Formation Mesaverde	Pool Mesaverde		Dedicated Acreage: N/2 320 Acres	
<p>1. Outline the acreage dedicated to the subject well by colored pencil or hatchure marks on the plat below.</p> <p>2. If more than one lease is dedicated to the well, outline each and identify the ownership thereof (both as to working interest and royalty).</p> <p>3. If more than one lease of different ownership is dedicated to the well, have the interest of all owners been consolidated by communization, unitization, force-pooling, etc.? <input type="checkbox"/> Yes <input type="checkbox"/> No If answer is "yes" type of consolidation _____ If answer is "no" list the owners and tract descriptions which have actually been consolidated. (Use reverse side of this form if necessary.) _____ No allowable will be assigned to the well until all interests have been consolidated (by communization, unitization, forced-pooling, or otherwise) or until a non-standard unit, eliminating such interest, has been approved by the Division.</p>					
				OPERATOR CERTIFICATION I hereby certify that the information contained herein is true and complete to the best of my knowledge and belief.	
				Signature <i>DeAnne Tallant</i> Printed Name DeAnne Tallant Position Staff Assistant Company Amoco Production Co. Date 11-12-93	
				SURVEYOR CERTIFICATION I hereby certify that the well location shown on this plat was plotted from field notes of actual surveys made by me or under my supervision, and that the same is true and correct to the best of my knowledge and belief.	
				Date Surveyed September 29, 1993 Signature & Seal of Professional Surveyor Gary Certification 7016	

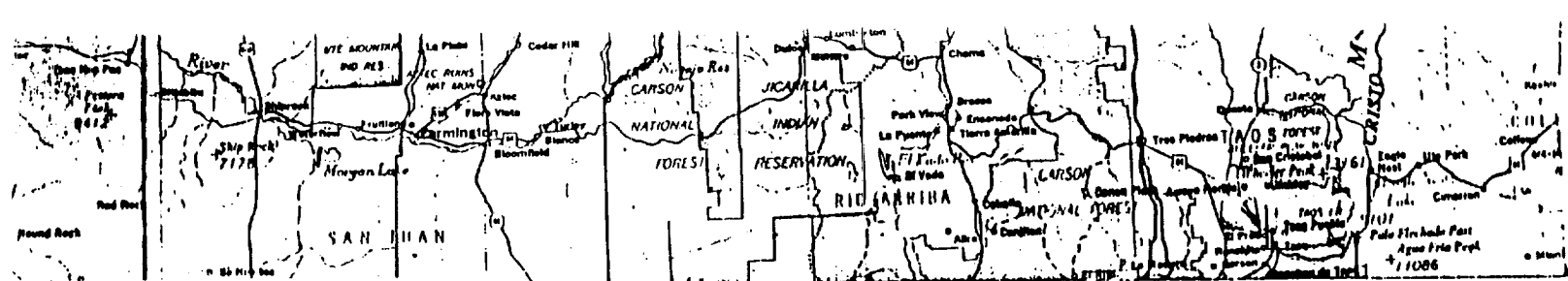

REF. # 10149
 1790' F/NL 1570' F/WL
 SEC. 34, T28N, RBW, NMPM
 RAIL POINT: 177 MI from Montrose, Co.
 MUD POINT: 34 MI from Aztec, N.M.
 CEMENT POINT: 38 MI from Farmington, N.M.

