

UNITED STATES
DEPARTMENT OF THE INTERIOR
BUREAU OF LAND MANAGEMENT

BLM-7 10:33
C70

APPLICATION FOR PERMIT TO DRILL, DEEPEN, OR PLUG BACK

1a. Type of Work DRILL	5. Lease Number SF-077950	
1b. Type of Well GAS	6. If Indian, All. or Tribe	
2. Operator MERIDIAN OIL 14538	7. Unit Agreement Name Huerfano Unit	
3. Address & Phone No. of Operator PO Box 4289, Farmington, NM 87499 (505) 326-9700	8. Farm or Lease Name 7139 Huerfano Unit 9. Well Number 521	
4. Location of Well 1455' FSL, 1550' FWL Latitude 36° 31' 43", Longitude 107° 52' 04"	10. Field, Pool, Wildcat 71629 Basin Ft Coal 11. Sec., Twn, Rge, Mer. K Sec 35, T-27-N, R-10-W NMPM	
14. Distance in Miles from Nearest Town 6 miles to Huerfano Trading Post	12. County San Juan	13. State NM
15. Distance from Proposed Location to Nearest Property or Lease Line 1330'	API # 30-045-29199	
16. Acres in Lease	17. Acres Assigned to Well 320 AT 5/2	
18. Distance from Proposed Location to Nearest Well, Drlg, Compl, or Applied for on this Lease 2400'	20. Rotary or Cable Tools Rotary	
19. Proposed Depth 2550'	22. Approx. Date Work will Start 4th quarter 1994	
21. Elevations (DF, FT, GR, Etc.) 6618' GR	23. Proposed Casing and Cementing Program See Operations Plan attached	
24. Authorized by: <u>[Signature]</u> Regional Drilling Engineer	Date <u>9/7/94</u>	

RECEIVED
SEP 15 1994

OIL CON. DIV.
DIST. 3

The information on this form is to be used for the preparation of a permit application to the BLM and is not to be used for any other purpose.

ALL INFORMATION ON THIS FORM IS UNCLASSIFIED AND IS IN THE PUBLIC DOMAIN.

PERMIT NO. _____ APPROVAL DATE _____
APPROVED BY _____ TITLE _____ DATE _____

Archaeological Report submitted by Arboles Contract Arch. Technical Report #592 dated 07-21-94
Threatened and Endangered Species Report submitted by Ecosphere Environmental Services, Inc. dated 08-11-94
NOTE: This format is issued in lieu of U.S. BLM Form 3160-3

APPROVED
AS AMENDED

SEP 13 1994
DISTRICT MANAGER

[Handwritten initials]

NMOOD

District I
 PO Box 1988, Hobbs, NM 88241-1988
 District II
 PO Drawer DD, Artesia, NM 88211-0719
 District III
 1008 Rio Brazos Rd., Aztec, NM 87410
 District IV
 PO Box 2088, Santa Fe, NM 87504-2088

State of New Mexico
 Energy, Minerals & Natural Resources Department

Form C-102
 Revised February 21, 1994

OIL CONSERVATION DIVISION
 PO Box 2088
 Santa Fe, NM 87504-2088

Instructions on back
 Submit to Appropriate District Office
 State Lease - 4 Copies
 Fee Lease - 3 Copies

AMENDED REPORT

WELL LOCATION AND ACREAGE DEDICATION PLAT

API Number 30-045-29199		Pool Code 71629	Pool Name Basin Fruitland Coal
Property Code 7139	Property Name Huerfano Unit		Well Number 521
OGRID No. 14538	Operator Name MERIDIAN OIL INC.		Elevation 6618'

10 Surface Location

UL or lot no.	Section	Township	Range	Lot Ids	Feet from the	North/South line	Feet from the	East/West line	County
K	35	27 N	10 W		1455	South	1550	West	S.J.

11 Bottom Hole Location If Different From Surface

UL or lot no.	Section	Township	Range	Lot Ids	Feet from the	North/South line	Feet from the	East/West line	County

12 Dedicated Acres S/320	13 Joint or Infill	14 Consolidation Code	15 Order No.
-----------------------------	--------------------	-----------------------	--------------

NO ALLOWABLE WILL BE ASSIGNED TO THIS COMPLETION UNTIL ALL INTERESTS HAVE BEEN CONSOLIDATED OR A NON-STANDARD UNIT HAS BEEN APPROVED BY THE DIVISION

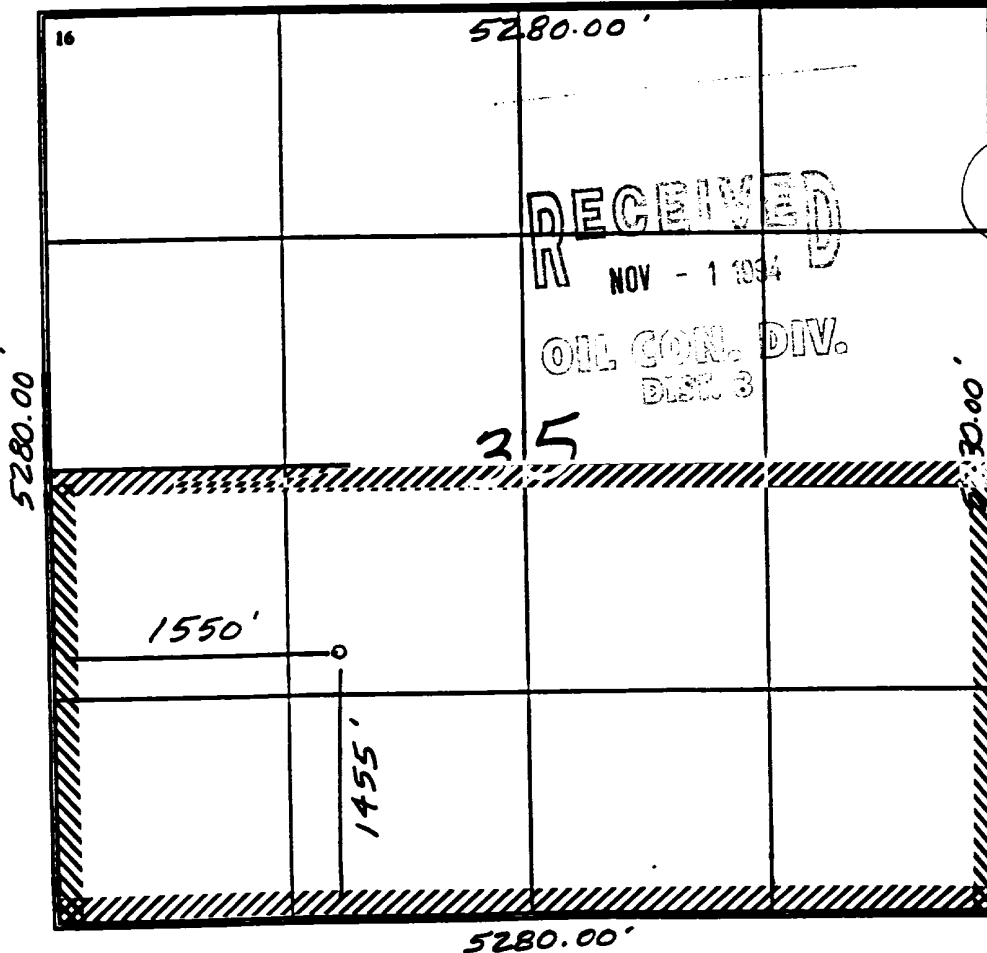

17 OPERATOR CERTIFICATION
 I hereby certify that the information contained herein is true and complete to the best of my knowledge and belief.

Peggy Bradfield
 Signature
 Peggy Bradfield
 Printed Name
 Regulatory Affairs
 Title
 9-26-94
 Date

18 SURVEYOR CERTIFICATION

I hereby certify that the well location shown on this plat was plotted from field notes of actual surveys made by me or under my supervision, and that the same is true and correct to the best of my knowledge and belief.

7-8-94
 Date of Survey
 Signature and Seal of Surveyor

 Certificate Number
 6857

OPERATIONS PLAN

Well Name: Huerfano Unit #521
Location: 1455'FSL, 1550'FWL, Section 35, T-27-N, R-10-W
 San Juan County, New Mexico
 Latitude 36° 31' 43", Longitude 107° 52' 04"
Formation: Basin Fruitland Coal
Elevation: 6618'GL

Formation:	Top	Bottom	Contents
Surface	Nacimiento	1306'	
Ojo Alamo	1306'	1445'	aquifer
Kirtland	1445'	2007'	
Fruitland	2007'	2270'	
Pictured Cliffs	2270'		
Total Depth	2550'		

Logging Program: Mud logs: 1900' to TD
 Dens/Neut/Por;Density/Corr;Micro/GR;Numar MR: 1800-TD
 Ind/SP/GR: to TD

Mud Program:

<u>Interval</u>	<u>Type</u>	<u>Weight</u>	<u>Vis.</u>	<u>Fluid Loss</u>
0- 200'	Spud	8.4-8.9	40-50	no control
200-2550'	Non-dispersed	8.4-9.5	30-60	no control

Casing Program:

<u>Hole Size</u>	<u>Depth Interval</u>	<u>Csg.Size</u>	<u>Wt.</u>	<u>Grade</u>
12 1/4"	0 - 200'	8 5/8"	24.0#	K-40
7 7/8"	0 - 2550'	4 1/2"	10.5#	K-55

Tubing Program:

0 - 2550'	2 3/8"	4.7#	J-55
-----------	--------	------	------

Float Equipment: 8 5/8" surface casing - saw tooth guide shoe.
 Centralizers will be run in accordance with Onshore Order #2.

4 1/2" production casing - float shoe on bottom. Three centralizers run every other joint above shoe. Two centralizers run every 3rd joint to the base of the Ojo Alamo @ 1445'. Two turbolizing type centralizers - one below and one into the base of the Ojo Alamo @ 1445'. Standard centralizers thereafter every fourth joint up to the base of the surface pipe.

Wellhead Equipment: 8 5/8" x 4 1/2" x 2 3/8" x 11" 2000 psi xmas tree assembly.

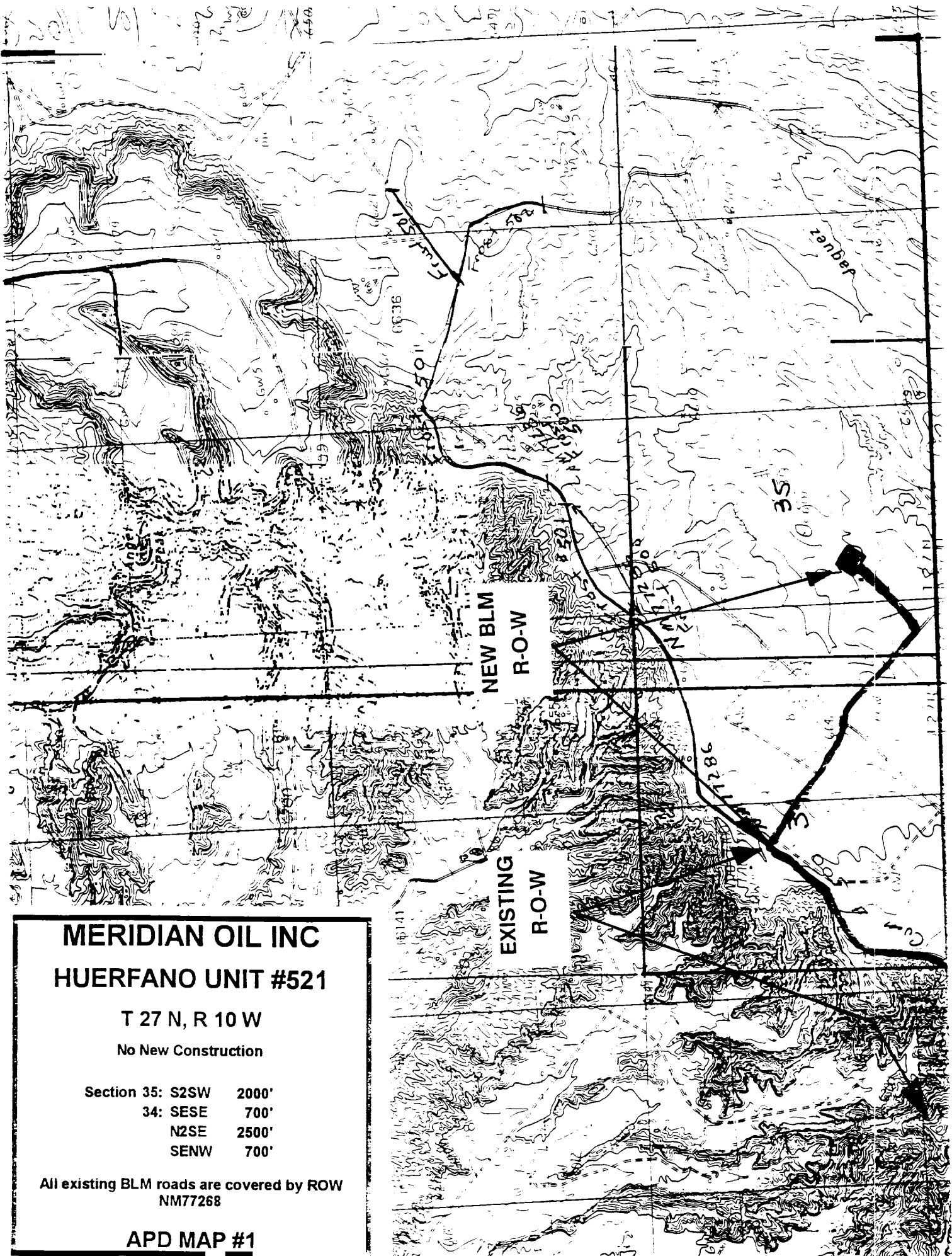

MERIDIAN OIL INC
HUERFANO UNIT #521

T 27 N, R 10 W

No New Construction

Section 35: S2SW	2000'
34: SESE	700'
N2SE	2500'
SENW	700'

All existing BLM roads are covered by ROW
 NM77268

APD MAP #1

**UNITED STATES
DEPARTMENT OF THE INTERIOR
BUREAU OF LAND MANAGEMENT**

Sundry Notices and Reports on Wells

1. Type of Well
GAS

RECEIVED
DEC 19 1994

2. Name of Operator
MERIDIAN OIL

**OIL CON. DIV.
DIST. 3**

3. Address & Phone No. of Operator
PO Box 4289, Farmington, NM 87499 (505) 326-9700

4. Location of Well, Footage, Sec., T, R, M
1455'FSL, 1580'FWL, Sec.35, T-27-N, R-10-W, NMPM

- 5. Lease Number
SF-077950
- 6. If Indian, All. or Tribe Name
- 7. Unit Agreement Name
Huerfano Unit
- 8. Well Name & Number
Huerfano Unit #521
- 9. API Well No.
- 10. Field and Pool
Basin Fruitland Coal
- 11. County and State
San Juan Co, NM

12. CHECK APPROPRIATE BOX TO INDICATE NATURE OF NOTICE, REPORT, OTHER DATA

Type of Submission	Type of Action	
<input type="checkbox"/> Notice of Intent	<input type="checkbox"/> Abandonment	<input type="checkbox"/> Change of Plans
<input checked="" type="checkbox"/> Subsequent Report	<input type="checkbox"/> Recompletion	<input type="checkbox"/> New Construction
<input type="checkbox"/> Final Abandonment	<input type="checkbox"/> Plugging Back	<input type="checkbox"/> Non-Routine Fracturing
	<input type="checkbox"/> Casing Repair	<input type="checkbox"/> Water Shut off
	<input type="checkbox"/> Altering Casing	<input type="checkbox"/> Conversion to Injection
	<input checked="" type="checkbox"/> Other - Spud	

13. Describe Proposed or Completed Operations

12-6-94 MIRU. Spud well @ 10:30 p.m. 12-5-94. Drill to 239'. Ran 5 jts 8 5/8" 24# K-55 8RD STC csg, set @ 234'. Cmt w/235 sx Class "G" cmt w/3% calcium chloride, 0.25 pps Cellophane (270 cu.ft.). 0.5 bbl cmt to surface. Cmt fell approximately 10'. Pump 20 sx cmt to bring cmt to surface.

12-7-94 WOC. PT BOP & csg to 600 psi/30 min, OK. Drilling ahead.

12-9-94 Drill to TD @ 2600'. Log hole. Ran 58 jts 4 1/2" 10.5# K-55 8RD STC csg, landed @ 2599'. Cmt w/515 sx Class "G" 65/35 poz, 6% gel, 2% calcium chloride, 0.25 pps Cellophane, 5 pps Gilsonite (912 cu.ft.). Tailed w/100 sx Class "G" cmt w/2% calcium chloride (115 cu.ft.). Circ 40 bbl cmt to surface. WOC. PT csg to 3800 psi, OK. ND BOP. NU WH. Rig released.

14. I hereby certify that the foregoing is true and correct.

Signed *[Signature]* Title Regulatory Affairs Date 12/12/94

(This space for Federal or State Office use)
APPROVED BY _____ Title _____ Date _____
CONDITION OF APPROVAL, if any:

(Handwritten mark)

NM000

ACCEPTED FOR RECORD

DEC 17 1994

FARMINGTON DISTRICT OFFICE
BY *[Signature]*