

UNITED STATES
DEPARTMENT OF THE INTERIOR
BUREAU OF LAND MANAGEMENT

RECEIVED
BLM

FORM APPROVED
Budget Bureau No. 1004-0135
Expires: March 31, 1993

SUNDRY NOTICES AND REPORTS ON WELLS

Do not use this form for proposals to drill or to deepen or reentry to a different reservoir.
Use "APPLICATION FOR PERMIT - " for such proposals

95 AUG 15 AM 10:00
070 FARMINGTON, NM

5. Lease Designation and Serial No.

NM-012202

6. If Indian, Allottee or Tribe Name

7. If Unit or CA, Agreement Designation

8. Well Name and No.

Bolack E 1

9. API Well No.

3004524103

10. Field and Pool, or Exploratory Area

Basin Dakota

11. County or Parish, State

San Juan New Mexico

1. Type of Well

☐ Oil Well ☒ Gas Well ☐ Other

2. Name of Operator

Amoco Production Company

Attention:

Pat Archuleta, Room 1205C

3. Address and Telephone No.

P.O. Box 800, Denver, Colorado 80201

(303) 830-5217

4. Location of Well (Footage, Sec., T., R., M., or Survey Description)

1640'FSL 1080'FML Sec. 33 T 28N R 8W

Unit 1

12. CHECK APPROPRIATE BOX(s) TO INDICATE NATURE OF NOTICE, REPORT, OR OTHER DATA

TYPE OF SUBMISSION

TYPE OF ACTION

- ☒ Notice of Intent
☐ Subsequent Report
☐ Final Abandonment Notice

- ☐ Abandonment
☒ Recompletion
☐ Plugging Back
☐ Casing Repair
☐ Altering Casing
☐ Other

- ☐ Change of Plans
☐ New Construction
☐ Non-Routine Fracturing
☐ Water Shut-Off
☐ Conversion to Injection
☐ Dispose Water

(Note: Report results of multiple completion on Well Completion or Recompletion Report and Log form.)

13. Describe Proposed or Completed Operations (Clearly state all pertinent details, and give pertinent dates, including estimated date of starting any proposed work. If well is directionally drilled, give subsurface locations and measured and true vertical depths for all markers and zones pertinent to this work.)*

Amoco Production Company requests permission to recomplete this well to the Mesaverde horizon, and downhole commingle the Dakota and the Mesaverde per the attached procedures

If you have any technical questions contact Mark Rothenberg at (303) 830-5612 or Pat Archuleta for any administrative questions.

RECEIVED
AUG 21 1996
OIL CON. DIV.
DIST. 3

14. I hereby certify that the foregoing is true and correct

Signed

Pat Archuleta

Title

Clerk

Date

8/14/96

(This space for Federal or State office use)

Approved by

Title

Date

Conditions of approval, if any:

APPROVED

Title 18 U.S.C. Section 1001, makes it a crime for any person knowingly and willfully to make to any department or agency of the United States any false, fictitious or fraudulent statements or representations as to any matter within its jurisdiction.

AUG 15 1996

/s/ Duane Spencer

DISTRICT MANAGER

* See Instructions on Reverse Side
NMOCD

Suggested Procedure:

1. Check location for anchors. Install if necessary. Test anchors.
2. MIRUSU. Record DK SITP and CPs. Blow down well. Kill with water, only if absolutely necessary.
3. Lower 2 3/8" tbg and tag for fill. POOH with 2 3/8" tbg. NDWH. NUBOP. RIII with tbg and RBP, set RBP at 6600', spot 10' of sand on RBP. Circulate hole clean. Pressure test casing to 1000 psig. Isolate any leaks found, but do not repair until CBL is run.
4. If no leaks were found or if leaks were isolated above 4800', then release RBP and reset at 4800'. Otherwise, leave RBP at 6600'.
5. Run CBL/CCL/GR from RBP to TOL at approx. 3333'. Determine TOC. Relay CBL info to Mark Rothenberg in Denver to verify if remedial cement squeezes will be needed prior to any frac treatment.
6. Correlate to Welx Gamma-Induction log dated 1/24/81 for depth control. Perf select fire-22 shots-at:
4290', 4297', 4336', 4340', 4355', 4378', 4449', 4518', 4580', 4584', 4588'
4596', 4607', 4646', 4658', 4662', 4676', 4680', 4708', 4713', 4728', 4746'
7. RIII with tbg and pkr, set pkr at 4250' and break down/ball off perfs with acid and 1.1 SG RCN balls. Knock off balls with packer. TOH with PKR.
8. Frac perfs according to frac procedure A.
9. Flow well back to tank as soon as possible on a 1/4" choke for 8 hours, then increase choke to 1/2" or larger depending on activity of well and sand or water production. Establish and record gas, water, oil rates and producing and shut-in TP and CPs. Obtain water and gas samples.
10. RIII with scraper and c/o sand to RPB at 4800'. Retrieve RBP and TOOII.
11. TIIH with 2 3/8" production string and land at lower depth of 6804' (1/2 mule shoe on btm and a SN 1 JT off btm). RDMOSU
12. Place well on production.

Note: Since this procedure may involve recompletion and DRA expenditures, please be sure to label all invoices accordingly so that costs can be accounted for properly.

If problems are encountered, please contact:

MARK ROTHENBERG

(W) (303) 830-5612

(H) (303) 841-8503

(P) (303) 553-6448

Amoco Production Company

ENGINEERING CHART

Sheet No. _____ of _____

File _____

Appn _____

Date 8/15/96

By MDR

SUBJECT BOLACK E1 3004524103

1640' FSLX 1080' FWL F-33, 28N-8W Fed L6 NM-10202

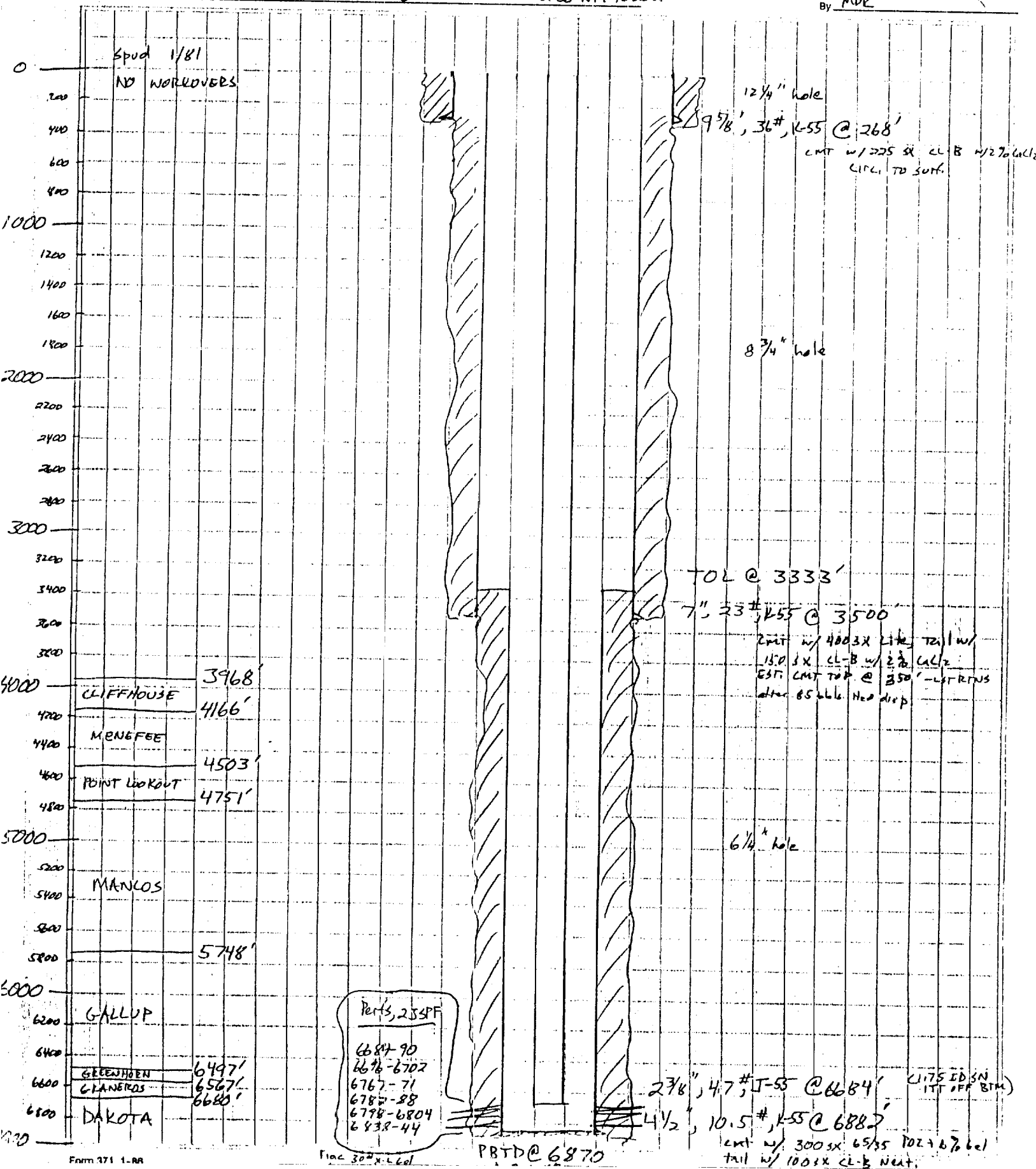

District I
PO Box 1980, Hobbs, NM 88241-1980
District II
811 South First, Artesia, NM 88210
District III
1000 Rio Bravo Rd., Aztec, NM 87410
District IV
2040 South Pacheco, Santa Fe, NM 87505

State of New Mexico
Energy, Minerals & Natural Resources Department

OIL CONSERVATION DIVISION
2040 South Pacheco
Santa Fe, NM 87505

RECEIVED
96 AUG 15 AM 10:00

Form C-102
Revised October 18, 1994
Instructions on back
Submit to Appropriate District Office
State Lease - 4 Copies
Fee Lease - 3 Copies

☐ AMENDED REPORT

WELL LOCATION AND ACREAGE DEDICATION PLAT

1 API Number 3004524103		2 Pool Code 72319		3 Pool Name Blanco Mesaverde	
4 Property Code 000329		5 Property Name Bolack E			6 Well Number 1
7 OGRID No. 000778		8 Operator Name Amoco Production Company			9 Elevation 6042

10 Surface Location

UL or lot no. I	Section 33	Township 28N	Range 8W	Lot Idn	Feet from the 1640	North/South line South	Feet from the 1080	East/West line West	County San Juan
--------------------	---------------	-----------------	-------------	---------	-----------------------	---------------------------	-----------------------	------------------------	--------------------

11 Bottom Hole Location If Different From Surface

UL or lot no.	Section	Township	Range	Lot Idn	Feet from the	North/South line	Feet from the	East/West line	County
12 Dedicated Acres 295.36		13 Joint or Infill		14 Consolidation Code		15 Order No.			

NO ALLOWABLE WILL BE ASSIGNED TO THIS COMPLETION UNTIL ALL INTERESTS HAVE BEEN CONSOLIDATED
OR A NON-STANDARD UNIT HAS BEEN APPROVED BY THE DIVISION

16				17 OPERATOR CERTIFICATION I hereby certify that the information contained herein is true and complete to the best of my knowledge and belief Signature Pat Archuleta Printed Name Pat Archuleta Clerk Title August 14, 1996 Date			
18 SURVEYOR CERTIFICATION I hereby certify that the well location shown on this plat was plotted from field notes of actual surveys made by me or under my supervision, and that the same is true and correct to the best of my belief. October 3, 1979 Date of Survey Signature and Seal of Professional Surveyor: 3950 Certificate Number							

All distances must be from the outer boundaries of the Section.

RECEIVED
BLM

Operator TENNECO OIL COMPANY			Lease BOLACK "E"		Well No. 1	
Unit Letter L	Section 33	Township 28N	Range 3W	County San Juan		
Actual Footage Location of Well: 1640 feet from the South line and 1080 feet from the West line						
Ground Level Elev. 6042	Producing Formation Dakota		Pool Basin Dakota		Dedicated Acreage: 320.00 Acres	

1. Outline the acreage dedicated to the subject well by colored pencil or hachure marks on the plat below.
2. If more than one lease is dedicated to the well, outline each and identify the ownership thereof (both as to working interest and royalty).
3. If more than one lease of different ownership is dedicated to the well, have the interests of all owners been consolidated by communitization, unitization, force-pooling, etc?

☐ Yes ☐ No If answer is "yes," type of consolidation _____

If answer is "no," list the owners and tract descriptions which have actually been consolidated. (Use reverse side of this form if necessary.) _____

No allowable will be assigned to the well until all interests have been consolidated (by communitization, unitization, forced-pooling, or otherwise) or until a non-standard unit, eliminating such interests, has been approved by the Commission.

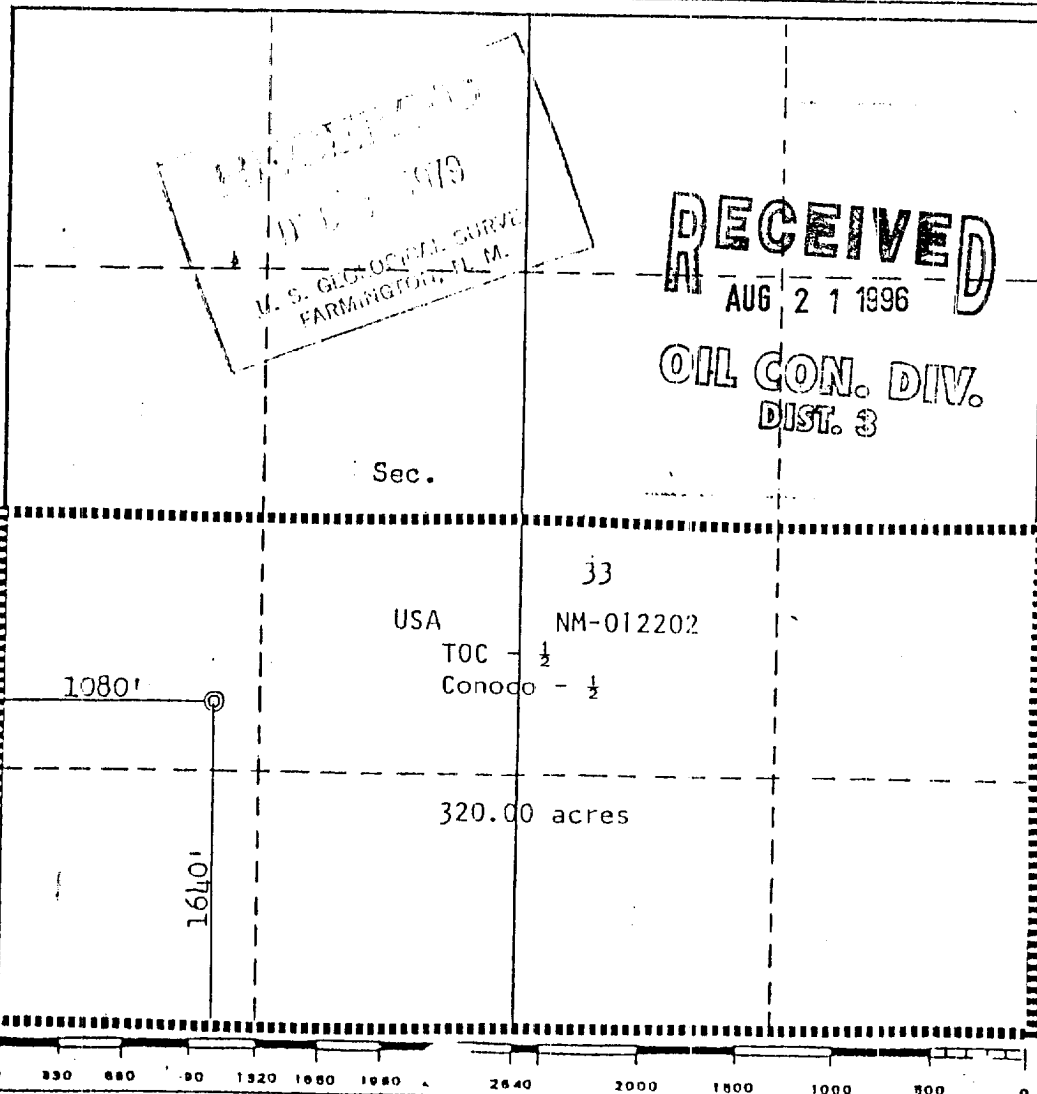

CERTIFICATION

I hereby certify that the information contained herein is true and complete to the best of my knowledge and belief.

M. Lee Freeman
Name

M. Lee Freeman

Position
Staff Production Analyst

Company

Tenneco Oil Company

Date

December 17, 1979

I hereby certify that the well location shown on this plat was plotted from field notes of actual surveys made by me or under my supervision, and that the same is true and correct to the best of my knowledge and belief.

Date Surveyed

October 14, 1979

Registered Professional Engineer
and/or Land Surveyor

Fred B. Kery Jr.
3950

Certificate No.

3950