

Form 9-331b
(April 1952)

(SUBMIT IN TRIPLICATE)

Indian Agency NAVAJO TRIBAL

UNITED STATES
DEPARTMENT OF THE INTERIOR
GEOLOGICAL SURVEY

WINDY HOOK, ARIZONA

Allottee JENNAPAH

Lease No. 14-20-603-782

30-045-07021

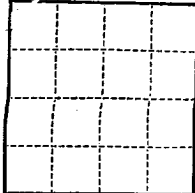

SUNDRY NOTICES AND REPORTS ON WELLS

NOTICE OF INTENTION TO DRILL.....	<input checked="" type="checkbox"/>	SUBSEQUENT REPORT OF WATER SHUT-OFF.....	
NOTICE OF INTENTION TO CHANGE PLANS.....		SUBSEQUENT REPORT OF SHOOTING OR ACIDIZING.....	
NOTICE OF INTENTION TO TEST WATER SHUT-OFF.....		SUBSEQUENT REPORT OF ALTERING CASING.....	
NOTICE OF INTENTION TO REDRILL OR REPAIR WELL.....		SUBSEQUENT REPORT OF REDRILLING OR REPAIR.....	
NOTICE OF INTENTION TO SHOOT OR ACIDIZE.....		SUBSEQUENT REPORT OF ABANDONMENT.....	
NOTICE OF INTENTION TO PULL OR ALTER CASING.....		SUPPLEMENTARY WELL HISTORY.....	
NOTICE OF INTENTION TO ABANDON WELL.....			

(INDICATE ABOVE BY CHECK MARK NATURE OF REPORT, NOTICE, OR OTHER DATA)

Jennajah

Farmington, New Mexico May 6, 1957

Well No. 1 is located 1745 ft. from N line and 1100 ft. from E line of sec. 36

NE/4 of Section 36
(1/4 Sec. and Sec. No.)

T-28-N
(Twp.)

R-9-W
(Range)

NMPH
(Meridian)

South Blanco-Pictured Cliffs
(Field)

San Juan
(County or Subdivision)

New Mexico
(State or Territory)

The elevation of the derrick floor above sea level is _____ ft. (To be reported later.)

DETAILS OF WORK

(State names of and expected depths to objective sands; show sizes, weights, and lengths of proposed casings; indicate mudding jobs, cementing points, and all other important proposed work)

We propose to drill the above well to a total depth of approximately 2300' with production anticipated from the Pictured Cliffs formation. Rotary tools will be used to total depth.

The proposed casing program is as follows:

SIZE	AMOUNT	CEMENT
8-1/8	140'	Circulate to surface
5-1/2	2300'	100 sacks

Copies of location plat are attached. Upon completion of this well casing logs taken will be forwarded.

Verbal approval 5-4-57 McGrath to Bauer.

I understand that this plan of work must receive approval in writing by the Geological Survey before operations may be commenced.

Company Pan American Petroleum Corporation

Address Box 487

Farmington, New Mexico

By [Signature]

Title Field Superintendent



WELL LOCATION AND/OR GAS PRORATION PLAT

DATE May 6, 1957

OPERATOR PAN AMERICAN PETROLEUM CORP. JENNAPAH

WELL NO. 1 SECTION 36 TOWNSHIP 28 NORTH RANGE 9 WEST, N.M.P.M.

LOCATED 1745 FEET FROM the NORTH END 1180 FEET FROM the EAST LINE

SAN JUAN

COUNTY, NEW MEXICO

DATE OF LOCATION to be reported later

NAME OF RESERVATION PICTURE CLIFF South Blanco-Pictured Cliffs DEDICATED ACREAGE 160

Note: All distances must be from outer boundaries of section.

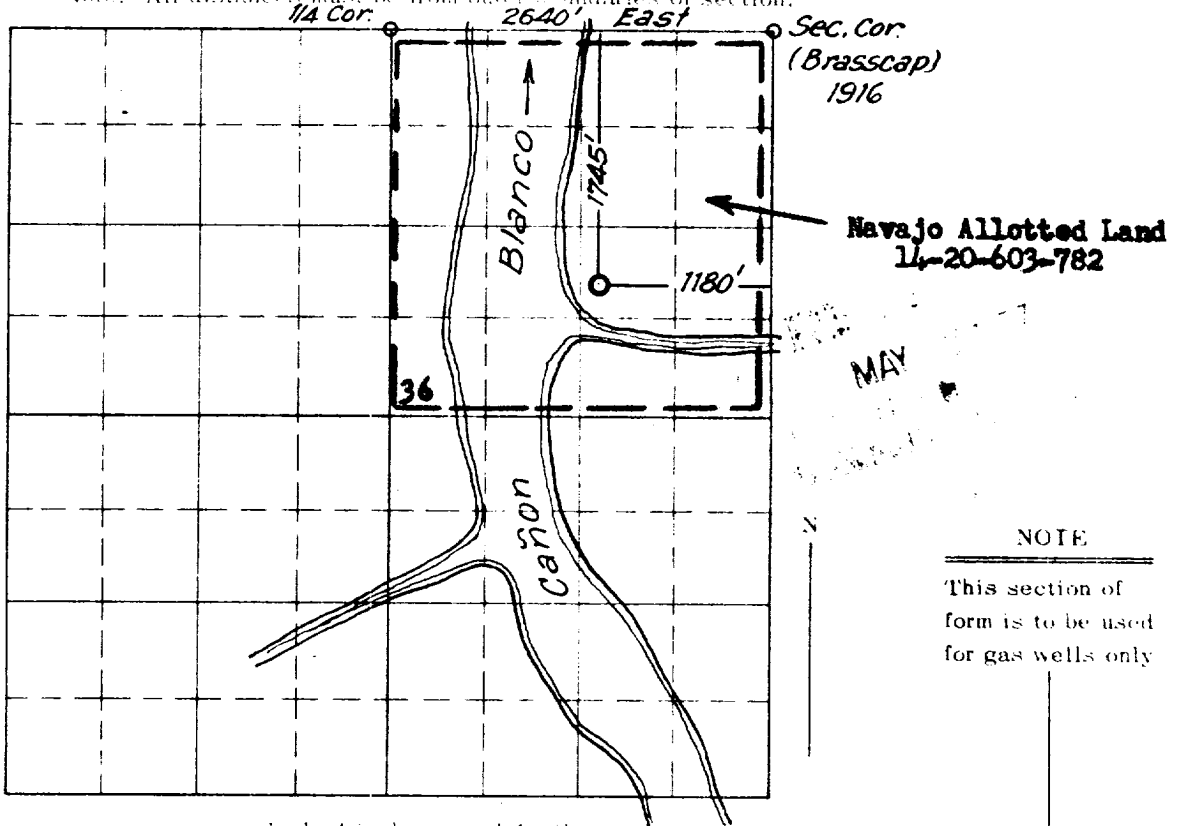

MAY

NOTE
This section of form is to be used for gas wells only

This is to certify that the above plat was prepared from field notes of actual surveys made by me or under my supervision and that the same are true and correct to the best of my knowledge and belief.

Date Surveyed 4 MAY 1957

James P. Leese
Registered Professional Engineer and/or Land Surveyor
JAMES P. LEESE
N. MEX. REG. NO. 1183

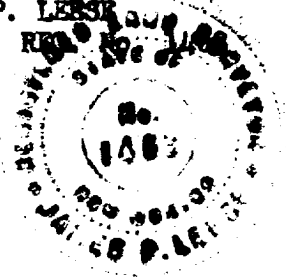

(Seal)

Farmington, New Mexico

1. Is this well a Dual Com.?
Yes _____ No X

2. If the answer to Question 1 is yes, are there any other dually completed wells within the dedicated acreage.
Yes _____

Name R. M. Bauer, Jr.

Position Field Engineer

Pan American Petroleum Corporation
Representing _____

Box 487, Farmington, New Mexico
Address _____