

(SUBMIT IN TRIPLICATE)

UNITED STATES
DEPARTMENT OF THE INTERIOR
GEOLOGICAL SURVEY

Land Office **Santa Fe**
Lease No. **SF-079634**
Unit **F**

SUNDRY NOTICES AND REPORTS ON WELLS

RECEIVED
APR 30 1956
U.S. GEOLOGICAL SURVEY
FARMINGTON, NEW MEXICO

| | | |
|--|-------------------------------------|--|
| NOTICE OF INTENTION TO DRILL | <input checked="" type="checkbox"/> | SUBSEQUENT REPORT OF WATER SHUT-OFF |
| NOTICE OF INTENTION TO CHANGE PLANS | | SUBSEQUENT REPORT OF SHOOTING OR ACIDIZING |
| NOTICE OF INTENTION TO TEST WATER SHUT-OFF | | SUBSEQUENT REPORT OF ALTERING CASING |
| NOTICE OF INTENTION TO RE-DRILL OR REPAIR WELL | | SUBSEQUENT REPORT OF RE-DRILLING OR REPAIR |
| NOTICE OF INTENTION TO SHOOT OR ACIDIZE | | SUBSEQUENT REPORT OF ABANDONMENT |
| NOTICE OF INTENTION TO PULL OR ALTER CASING | | SUPPLEMENTARY WELL HISTORY |
| NOTICE OF INTENTION TO ABANDON WELL | | |

(INDICATE ABOVE BY CHECK MARK NATURE OF REPORT, NOTICE, OR OTHER DATA)

April 28, 1956

6 McClanahan
Well No. is located 1850 ft. from [N] line and 1500 ft. from [W] line of sec. 23
SE 1/4 NW 1/4, Sec. 23 T-28-N, R-10-W N.M.P.M.
(1/4 Sec. and Sec. No.) (Twp.) (Range) (Meridian)
Fulcher-Kutz Extension San Juan New Mexico
(Field) (County or Subdivision) (State or Territory)

The elevation of the derrick floor above sea level is 5936 ft.

DETAILS OF WORK

(State names of and expected depths to objective sands; show sizes, weights, and lengths of proposed casings; indicate mudding jobs, cementing points, and all other important proposed work)

Propose to: Set 200' of 8 5/8" casing at 200' with 125 sacks cement. Drill to an approximate total depth of 2110'. Set 5 1/2" casing at T.D. (2110') with 100 sacks cement. Perforate Pictured Cliffs formation. Sand-water frac with 40,000 gallons water, 40,000 lbs. sand. Run 1" tubing to 2090'. The proration unit assigned is the NW 1/4 and consists of 160 acres.

I understand that this plan of work must receive approval in writing by the Geological Survey before operations may be commenced.

Company AZTEC OIL & GAS COMPANYAddress P O Box 786Farmington, New Mexico

By Joe C. Salmon
Joe C. Salmon
Title Drilling Superintendent

NEW MEXICO
OIL CONSERVATION COMMISSION

Form C-128

Well Location and/or Gas Proration Plat

Date March 21, 1956

Operator Astec Oil and Gas Company Lease McClanahan

Well No. 6 Section 23 Township 28 North Range 10 West NMPM

Located 1850 Feet From North Line, 1500 Feet From West Line,

San Juan County, New Mexico. G. L. Elevation 5934

Name of Producing Formation Pictured Cliffs Pool Fulcher-Kuts Extension Dedicated Acreage 160

(Note: All distances must be from outer boundaries of Section)

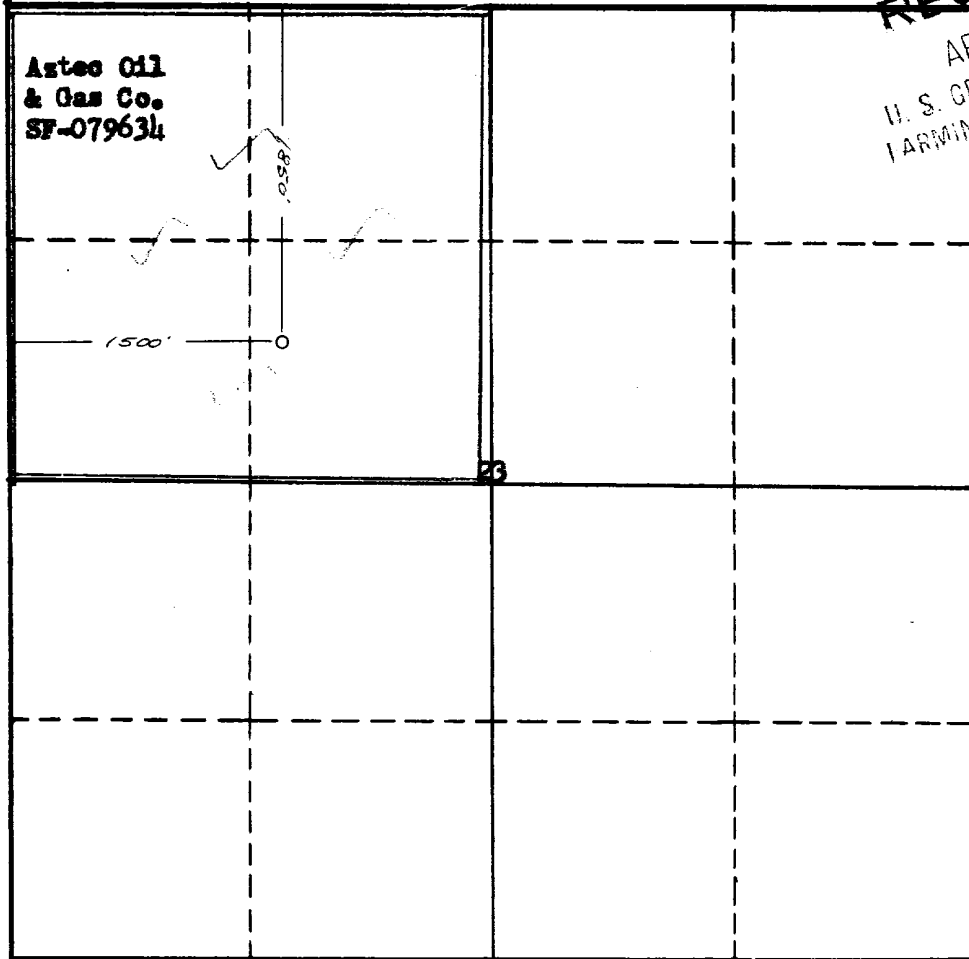

RECEIVED
APR 30 1956
U. S. GEOLOGICAL SURVEY
FARMINGTON, NEW MEXICO

NOTE

This section of
form is to be
used for gas
wells only.



SCALE: 1"=1000'

1. Is this Well a Dual Comp.? Yes No **x**.
2. If the answer to Question 1 is yes, are there any other dually completed wells within the dedicated acreage? Yes No .

Name J. C. Salmon
Position Drilling Superintendent
Representing Astec Oil & Gas Company
Address Box 786, Farmington, N.M.

This is to certify that the above plat was prepared from field notes of actual surveys made by me or under my supervision and that the same are true and correct to the best of my knowledge and belief.

Date Surveyed March 11, 1956
Ernest V. Cochran
Registered Professional Engineer and/or
Land Surveyor **FOUR STATES OIL FIELD SURVEYS**
FARMINGTON, NEW MEXICO

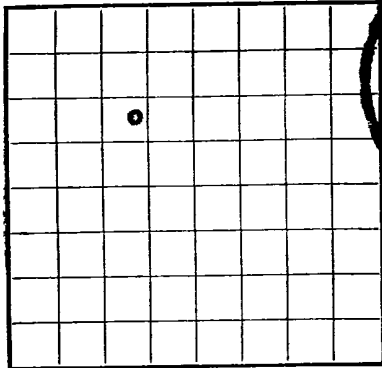

LOCATE WELL CORRECTLY

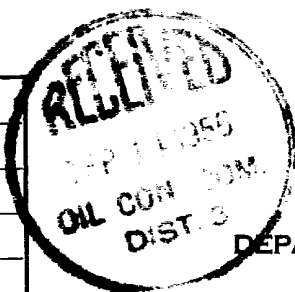
U. S. LAND OFFICE Santa Fe
SERIAL NUMBER SF-079634
LEASE OR PERMIT TO PROSPECTUNITED STATES
DEPARTMENT OF THE INTERIOR
GEOLOGICAL SURVEY

LOG OF OIL OR GAS WELL

Company Astec Oil & Gas Company Address Box 786, Farmington, New Mexico
Lessor or Tract McClanahan Field Fulcher-Kuts Ext. State New Mexico
Well No. 6 Sec. 23 T. 28 R. 10 Meridian N.M.P.M. County San Juan
Location 1850 ft. SW of N. Line and 1500 ft. E. of W. Line of Sec. 23 Elevation 5936
(Derrick floor relative to sea level)

The information given herewith is a complete and correct record of the well and all work done thereon so far as can be determined from all available records.

Signed J. C. SalmonDate July 13, 1956 Title Drilling Superintendent

The summary on this page is for the condition of the well at above date.

Commenced drilling May 9, 19 56 Finished drilling June 1, 19 56

OIL OR GAS SANDS OR ZONES

(Denote gas by G)

No. 1, from 2025 to 2073 G No. 4, from to
No. 2, from to No. 5, from to
No. 3, from to No. 6, from to

IMPORTANT WATER SANDS

No. 1, from to No. 3, from to
No. 2, from to No. 4, from to

CASING RECORD

| Size casing | Weight per foot | Threads per inch | Make | Amount | Kind of shoe | Cut and pulled from | Perforated | | Purpose |
|----------------------------|-----------------|------------------|------|--------------|--------------|---------------------|-------------|-------------|---------|
| | | | | | | | From— | To— | |
| <u>8 5/8</u> | <u>21 1/2</u> | <u>8rd</u> | | <u>185'</u> | | | | | |
| <u>5 1/2</u> | <u>17 1/2</u> | <u>8rd</u> | | <u>2125'</u> | | | <u>2025</u> | <u>2073</u> | |
| <u>1 1/2</u> | <u>10 1/2</u> | <u>8rd</u> | | <u>2020'</u> | | | | | |
| HISTORY OF OIL OR GAS WELL | | | | | | | | | |

MUDDING AND CEMENTING RECORD

| Size casing | Where set | Number sacks of cement | Method used | Mud gravity | Amount of mud used |
|--------------|--------------|------------------------|-------------|-------------|--------------------|
| <u>8 5/8</u> | <u>195'</u> | <u>110</u> | | | |
| <u>5 1/2</u> | <u>2125'</u> | <u>100</u> | | | |
| <u>1 1/2</u> | <u>2020'</u> | | | | |

PLUGS AND ADAPTERS

Heaving plug—Material Length Depth set
Adapters—Material Size

SHOOTING RECORD

| Size | Shell used | Explosive used | Quantity | Date | Depth shot | Depth cleaned out |
|---|------------|----------------|----------|------|------------|-------------------|
| Sand-water free from <u>2025-2073</u> with <u>14,100</u> gallons water and <u>10,000</u> lbs. sand. | | | | | | |
| Breakdown Pressure <u>1650</u> lbs., Treating Pressure <u>1000</u> lbs., Final <u>1000</u> lbs., | | | | | | |
| Injection Rate <u>17.2</u> bpm. | | | | | | |

TOOLS USED

Rotary tools were used from 0 feet to 2125 feet, and from feet to feet
Cable tools were used from feet to feet, and from feet to feet

DATES

..... June 8, 19 56 Put to producing, 19.....

The production for the first 24 hours was barrels of fluid of which% was oil;% emulsion;% water; and% sediment. Gravity, °Bé.

If gas well, cu. ft. per 24 hours 3597 / Calculated Absolute PotentialRock pressure, lbs. per sq. in. 641 lbs. - Volume through 3/4" Choke 3125 MCF

EMPLOYEES

....., Driller , Driller
....., Driller , Driller

FORMATION RECORD

| FROM— | TO— | TOTAL FEET | FORMATION |
|-------------|------------------|------------|-------------------------------|
| <u>0</u> | <u>35</u> | <u>35</u> | <u>Sand</u> |
| <u>35</u> | <u>51</u> | <u>16</u> | <u>Gray Sand stone</u> |
| <u>51</u> | <u>65</u> | <u>14</u> | <u>Gray Sand stone</u> |
| <u>65</u> | <u>90</u> | <u>25</u> | <u>Blue Shale</u> |
| <u>90</u> | <u>103</u> | <u>13</u> | <u>Gray Sand stone</u> |
| <u>103</u> | <u>133</u> | <u>30</u> | <u>Gray Sand stone</u> |
| <u>133</u> | <u>153</u> | <u>20</u> | <u>Blue Shale</u> |
| <u>153</u> | <u>187</u> | <u>34</u> | <u>Gray Sandy Shale</u> |
| <u>187</u> | <u>199</u> | <u>12</u> | <u>Sand & Shale</u> |
| <u>199</u> | <u>216</u> | <u>17</u> | <u>Sand & Shale</u> |
| <u>216</u> | <u>2000</u> | <u>784</u> | <u>Sand & Shale</u> |
| <u>2000</u> | <u>2220</u> | <u>220</u> | <u>Sand & Shale</u> |
| <u>2220</u> | <u>2531</u> | <u>311</u> | <u>Sand & Shale</u> |
| <u>2531</u> | <u>2691</u> | <u>160</u> | <u>Sand & Shale</u> |
| <u>2691</u> | <u>2069</u> | <u>622</u> | <u>Sand, Shale & Coal</u> |
| <u>2069</u> | <u>2125 T.P.</u> | <u>56</u> | <u>Sand & Shale</u> |

Schlumberger Tops: Pictured Cliffs 2020

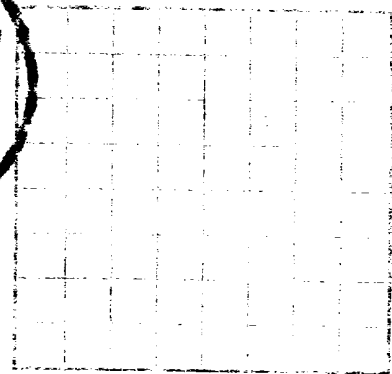

LOC OF OIL OR GAS WELL.

100-443887-1

The summary on this page is for the condition of the well at above date.

10-1-2014

| Year | Share of total population | Share of total population | Share of total population | Share of total population |
|------|---------------------------|---------------------------|---------------------------|---------------------------|
| 1990 | 100% | 100% | 100% | 100% |
| 2000 | 100% | 100% | 100% | 100% |
| 2010 | 100% | 100% | 100% | 100% |
| 2020 | 100% | 100% | 100% | 100% |

2003. 1. 24

| | | | | | | | | | | | | | | | | | | | | | | | | | | | | | | | | | | | | | | | | | | | | | | | | | | | | | | | | | | | | | | | | | | | | | | | | | | | | | | | | | | | | | | | | | | | | | | | | | | | | | | | | | | | | | | | | | | | | | | | | | | | | | | | | | | | | | | | | | | | | | | | | | | | | | | | | | | | | | | | | | | | | | | | | | | | | | | | | | | | | | | | | | | | | | | | | | | | | | | | | | | | | | | | | | | | | | | | | | | | | | | | | | | | | | | | | | | | | | | | | | | | | | | | | | | | | | | | | | | | | | | | | | | | | | | | | | | | | | | | | | | | | | | | | | | | | | | | | | | | | | | | | | | | | | | | | | | | | | | | | | | | | | | | | | | | | | | | | | | | | | | | | | | | | | | | | | | | | | | | | | | | | | | | | | | | | | | | | | | | | | | | | | | | | | | | | | | | | | | | | | | | | | | | | | | | | | | | | | | | | | | | | | | | | | | | | | | | | | | | | | | | | | | | | | | | | | | | | | | | | | | | | | |
|---|---|---|---|---|---|---|---|---|----|----|----|----|----|----|----|----|----|----|----|----|----|----|----|----|----|----|----|----|----|----|----|----|----|----|----|----|----|----|----|----|----|----|----|----|----|----|----|----|----|----|----|----|----|----|----|----|----|----|----|----|----|----|----|----|----|----|----|----|----|----|----|----|----|----|----|----|----|----|----|----|----|----|----|----|----|----|----|----|----|----|----|----|----|----|----|----|----|----|-----|-----|-----|-----|-----|-----|-----|-----|-----|-----|-----|-----|-----|-----|-----|-----|-----|-----|-----|-----|-----|-----|-----|-----|-----|-----|-----|-----|-----|-----|-----|-----|-----|-----|-----|-----|-----|-----|-----|-----|-----|-----|-----|-----|-----|-----|-----|-----|-----|-----|-----|-----|-----|-----|-----|-----|-----|-----|-----|-----|-----|-----|-----|-----|-----|-----|-----|-----|-----|-----|-----|-----|-----|-----|-----|-----|-----|-----|-----|-----|-----|-----|-----|-----|-----|-----|-----|-----|-----|-----|-----|-----|-----|-----|-----|-----|-----|-----|-----|-----|-----|-----|-----|-----|-----|-----|-----|-----|-----|-----|-----|-----|-----|-----|-----|-----|-----|-----|-----|-----|-----|-----|-----|-----|-----|-----|-----|-----|-----|-----|-----|-----|-----|-----|-----|-----|-----|-----|-----|-----|-----|-----|-----|-----|-----|-----|-----|-----|-----|-----|-----|-----|-----|-----|-----|-----|-----|-----|-----|-----|-----|-----|-----|-----|-----|-----|-----|-----|-----|-----|-----|-----|-----|-----|-----|-----|-----|-----|-----|-----|-----|-----|-----|-----|-----|-----|-----|-----|-----|-----|-----|-----|-----|-----|-----|-----|-----|-----|-----|-----|-----|-----|-----|-----|-----|-----|-----|-----|-----|-----|-----|-----|-----|-----|-----|-----|-----|-----|-----|-----|-----|-----|-----|-----|-----|-----|-----|-----|-----|-----|-----|-----|-----|-----|-----|-----|-----|-----|-----|-----|-----|-----|-----|-----|-----|-----|-----|-----|-----|-----|-----|-----|-----|-----|-----|-----|-----|-----|-----|-----|-----|-----|-----|-----|-----|-----|-----|-----|-----|-----|-----|-----|-----|-----|-----|-----|-----|-----|-----|-----|-----|-----|-----|-----|-----|-----|-----|-----|-----|-----|-----|-----|-----|-----|-----|-----|-----|-----|-----|-----|-----|-----|-----|-----|-----|-----|-----|-----|-----|-----|-----|-----|-----|-----|-----|-----|-----|-----|-----|-----|-----|-----|-----|-----|-----|-----|-----|-----|-----|-----|-----|-----|-----|-----|-----|-----|-----|-----|-----|-----|-----|-----|-----|-----|-----|-----|-----|-----|-----|-----|-----|-----|-----|-----|-----|-----|-----|-----|-----|-----|-----|-----|-----|-----|-----|-----|-----|
| 1 | 2 | 3 | 4 | 5 | 6 | 7 | 8 | 9 | 10 | 11 | 12 | 13 | 14 | 15 | 16 | 17 | 18 | 19 | 20 | 21 | 22 | 23 | 24 | 25 | 26 | 27 | 28 | 29 | 30 | 31 | 32 | 33 | 34 | 35 | 36 | 37 | 38 | 39 | 40 | 41 | 42 | 43 | 44 | 45 | 46 | 47 | 48 | 49 | 50 | 51 | 52 | 53 | 54 | 55 | 56 | 57 | 58 | 59 | 60 | 61 | 62 | 63 | 64 | 65 | 66 | 67 | 68 | 69 | 70 | 71 | 72 | 73 | 74 | 75 | 76 | 77 | 78 | 79 | 80 | 81 | 82 | 83 | 84 | 85 | 86 | 87 | 88 | 89 | 90 | 91 | 92 | 93 | 94 | 95 | 96 | 97 | 98 | 99 | 100 | 101 | 102 | 103 | 104 | 105 | 106 | 107 | 108 | 109 | 110 | 111 | 112 | 113 | 114 | 115 | 116 | 117 | 118 | 119 | 120 | 121 | 122 | 123 | 124 | 125 | 126 | 127 | 128 | 129 | 130 | 131 | 132 | 133 | 134 | 135 | 136 | 137 | 138 | 139 | 140 | 141 | 142 | 143 | 144 | 145 | 146 | 147 | 148 | 149 | 150 | 151 | 152 | 153 | 154 | 155 | 156 | 157 | 158 | 159 | 160 | 161 | 162 | 163 | 164 | 165 | 166 | 167 | 168 | 169 | 170 | 171 | 172 | 173 | 174 | 175 | 176 | 177 | 178 | 179 | 180 | 181 | 182 | 183 | 184 | 185 | 186 | 187 | 188 | 189 | 190 | 191 | 192 | 193 | 194 | 195 | 196 | 197 | 198 | 199 | 200 | 201 | 202 | 203 | 204 | 205 | 206 | 207 | 208 | 209 | 210 | 211 | 212 | 213 | 214 | 215 | 216 | 217 | 218 | 219 | 220 | 221 | 222 | 223 | 224 | 225 | 226 | 227 | 228 | 229 | 230 | 231 | 232 | 233 | 234 | 235 | 236 | 237 | 238 | 239 | 240 | 241 | 242 | 243 | 244 | 245 | 246 | 247 | 248 | 249 | 250 | 251 | 252 | 253 | 254 | 255 | 256 | 257 | 258 | 259 | 260 | 261 | 262 | 263 | 264 | 265 | 266 | 267 | 268 | 269 | 270 | 271 | 272 | 273 | 274 | 275 | 276 | 277 | 278 | 279 | 280 | 281 | 282 | 283 | 284 | 285 | 286 | 287 | 288 | 289 | 290 | 291 | 292 | 293 | 294 | 295 | 296 | 297 | 298 | 299 | 300 | 301 | 302 | 303 | 304 | 305 | 306 | 307 | 308 | 309 | 310 | 311 | 312 | 313 | 314 | 315 | 316 | 317 | 318 | 319 | 320 | 321 | 322 | 323 | 324 | 325 | 326 | 327 | 328 | 329 | 330 | 331 | 332 | 333 | 334 | 335 | 336 | 337 | 338 | 339 | 340 | 341 | 342 | 343 | 344 | 345 | 346 | 347 | 348 | 349 | 350 | 351 | 352 | 353 | 354 | 355 | 356 | 357 | 358 | 359 | 360 | 361 | 362 | 363 | 364 | 365 | 366 | 367 | 368 | 369 | 370 | 371 | 372 | 373 | 374 | 375 | 376 | 377 | 378 | 379 | 380 | 381 | 382 | 383 | 384 | 385 | 386 | 387 | 388 | 389 | 390 | 391 | 392 | 393 | 394 | 395 | 396 | 397 | 398 | 399 | 400 | 401 | 402 | 403 | 404 | 405 | 406 | 407 | 408 | 409 | 410 | 411 | 412 | 413 | 414 | 415 | 416 | 417 | 418 | 419 | 420 | 421 | 422 | 423 | 424 | 425 | 426 | 427 | 428 | 429 | 430 | 431 | 432 | 433 | 434 | 435 | 436 | 437 | 438 | 439 | 440 | 441 | 442 | 443 | 444 | 445 | 446 | 447 | 448 | 449 | 450 | 451 | 452 | 453 | 454 | 455 | 456 | 457 | 458 | 459 | 460 | 461 | 462 | 463 | 464 | 465 | 466 |
|---|---|---|---|---|---|---|---|---|----|----|----|----|----|----|----|----|----|----|----|----|----|----|----|----|----|----|----|----|----|----|----|----|----|----|----|----|----|----|----|----|----|----|----|----|----|----|----|----|----|----|----|----|----|----|----|----|----|----|----|----|----|----|----|----|----|----|----|----|----|----|----|----|----|----|----|----|----|----|----|----|----|----|----|----|----|----|----|----|----|----|----|----|----|----|----|----|----|----|-----|-----|-----|-----|-----|-----|-----|-----|-----|-----|-----|-----|-----|-----|-----|-----|-----|-----|-----|-----|-----|-----|-----|-----|-----|-----|-----|-----|-----|-----|-----|-----|-----|-----|-----|-----|-----|-----|-----|-----|-----|-----|-----|-----|-----|-----|-----|-----|-----|-----|-----|-----|-----|-----|-----|-----|-----|-----|-----|-----|-----|-----|-----|-----|-----|-----|-----|-----|-----|-----|-----|-----|-----|-----|-----|-----|-----|-----|-----|-----|-----|-----|-----|-----|-----|-----|-----|-----|-----|-----|-----|-----|-----|-----|-----|-----|-----|-----|-----|-----|-----|-----|-----|-----|-----|-----|-----|-----|-----|-----|-----|-----|-----|-----|-----|-----|-----|-----|-----|-----|-----|-----|-----|-----|-----|-----|-----|-----|-----|-----|-----|-----|-----|-----|-----|-----|-----|-----|-----|-----|-----|-----|-----|-----|-----|-----|-----|-----|-----|-----|-----|-----|-----|-----|-----|-----|-----|-----|-----|-----|-----|-----|-----|-----|-----|-----|-----|-----|-----|-----|-----|-----|-----|-----|-----|-----|-----|-----|-----|-----|-----|-----|-----|-----|-----|-----|-----|-----|-----|-----|-----|-----|-----|-----|-----|-----|-----|-----|-----|-----|-----|-----|-----|-----|-----|-----|-----|-----|-----|-----|-----|-----|-----|-----|-----|-----|-----|-----|-----|-----|-----|-----|-----|-----|-----|-----|-----|-----|-----|-----|-----|-----|-----|-----|-----|-----|-----|-----|-----|-----|-----|-----|-----|-----|-----|-----|-----|-----|-----|-----|-----|-----|-----|-----|-----|-----|-----|-----|-----|-----|-----|-----|-----|-----|-----|-----|-----|-----|-----|-----|-----|-----|-----|-----|-----|-----|-----|-----|-----|-----|-----|-----|-----|-----|-----|-----|-----|-----|-----|-----|-----|-----|-----|-----|-----|-----|-----|-----|-----|-----|-----|-----|-----|-----|-----|-----|-----|-----|-----|-----|-----|-----|-----|-----|-----|-----|-----|-----|-----|-----|-----|-----|-----|-----|-----|-----|-----|-----|-----|-----|-----|-----|-----|-----|-----|-----|-----|-----|-----|-----|-----|-----|-----|-----|-----|-----|-----|-----|-----|-----|-----|-----|-----|-----|-----|-----|-----|-----|-----|-----|-----|-----|-----|-----|-----|-----|-----|

It is of the greatest importance to have a complete history of the well. Please state in detail the dates of redrilling, together with the reasons for the work and its results. If there were any changes made in the casing, state fully, and if any casing was "sidetracked" or left in the well, give its size and location. If the well has been dynamited, give date, size, position, and number of shots. If piers or bridges were put in to test for water, state kind of material used, position, and results of pumping or bailing.

U. S. GOVERNMENT PRINTING OFFICE 16-43084-2

[illegible]

NEW MEXICO OIL CONSERVATION COMMISSION
SANTA FE, NEW MEXICO

(File the original and 4 copies with the appropriate district office)

CERTIFICATE OF COMPLIANCE AND AUTHORIZATION
TO TRANSPORT OIL AND NATURAL GAS

Company or Operator Astec Oil & Gas Company Lease McClanahan
Well No. 6 Unit Letter S 23 T 28 R 10 Pool Fulcher-Davis Extension
County San Juan Kind of Lease (State, Fed. or Patented) Federal
If well produces oil or condensate, give location of tanks: Unit S T R
Authorized Transporter of Oil or Condensate _____

Address _____
(Give address to which approved copy of this form is to be sent)

Authorized Transporter of Gas Southern Union Gas Company
Address 1104 Burt Building, Dallas, Texas
(Give address to which approved copy of this form is to be sent)

If Gas is not being sold, give reasons and also explain its present disposition:

Reasons for Filing: (Please check proper box) New Well (X)
Change in Transporter of (Check One): Oil () Dry Gas () C'head () Condensate ()
Change in Ownership () Other ()
Remarks: _____ (Give explanation below)

The undersigned certifies that the Rules and Regulations of the Oil Conservation Commission have been complied with.

Executed this the 13th day of July 19 56

Approved JUL 19 1956 19

OIL CONSERVATION COMMISSION

By Emery C. Arnold
Title Oil and Gas Inspector Dist. #3.

By Joe O. Salmon
Title Drilling Superintendent

Company AZTEC OIL & GAS COMPANY

Address Box 786, Farmington, New Mexico



Form 9-381a
(12-30-1960)

| | | | |
|-----------------|--|--|--|
| APPROVED | | JUN 26 1956 | |
| | | JERRY W. LONG ACT'G DISTRICT ENGINEER | |

(SUBMIT IN TRIPLICATE)

UNITED STATES
DEPARTMENT OF THE INTERIOR
GEOLOGICAL SURVEY

Land Office Santa Fe
Lease No. SF-079634
Unit _____

SUNDRY NOTICES AND REPORTS ON WELLS

| | | |
|--|--|----------|
| NOTICE OF INTENTION TO DRILL | SUBSEQUENT REPORT OF WATER SHUT-OFF | |
| NOTICE OF INTENTION TO CHANGE PLANS | SUBSEQUENT REPORT OF SHOOTING OR ACIDIZING | X |
| NOTICE OF INTENTION TO TEST WATER SHUT-OFF | SUBSEQUENT REPORT OF ALTERING CASING | |
| NOTICE OF INTENTION TO RE-DRILL OR REPAIR WELL | SUBSEQUENT REPORT OF RE-DRILLING OR REPAIR | |
| NOTICE OF INTENTION TO SHOOT OR ACIDIZE | SUBSEQUENT REPORT OF ABANDONMENT | |
| NOTICE OF INTENTION TO PULL OR ALTER CASING | SUPPLEMENTARY WELL HISTORY | |
| NOTICE OF INTENTION TO ABANDON WELL | | |

(INDICATE ABOVE BY CHECK MARK NATURE OF REPORT, NOTICE, OR OTHER DATA)

June 21, 1956

McClanshan 6
Well No. / is located 1850 ft. from N line and 1500 ft. from W line of sec. 23
SE/NW, Section 23 T-28-N, R-10-W N.M.P.M.
(1/4 Sec. and Sec. No.) (Twp.) (Range) (Meridian)
Fulcher-Eats Extension San Juan New Mexico
(Field) (County or Subdivision) (State or Territory)

The elevation of the derrick floor above sea level is 5926 ft.

DETAILS OF WORK

(State names of and expected depths to objective sands; show sizes, weights, and lengths of proposed casings; indicate mudding jobs, cementing points, and all other important proposed work)

T.D. 2125. Perforated from 2025-78 with 216 shots. Sand-water frac with 44,100 gallons water, 40,000 lbs. sand, BDP 1650 lbs., Injection Rate 47.2 bpm. Landed 2010' of 1" tubing at 2020'. Well gauged 3600 MCF after unloading 7 hours. Tested well June 15, 1956 - Absolute Potential 3597, volume through 3/4" choke 3125, SICP and SITP 641 after 7 day shut-in.

I understand that this plan of work must receive approval in writing by the Geological Survey before operations may be commenced.

Company AZTEC OIL & GAS COMPANY
Address P O BOX 786
Farmington, New Mexico
By Joe C. Salmon
Joe C. Salmon
Title Drilling Superintendent

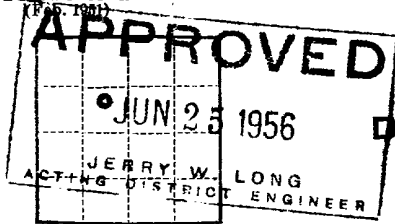

(SUBMIT IN TRIPLICATE)

UNITED STATES
DEPARTMENT OF THE INTERIOR
GEOLOGICAL SURVEY

Land Office Santa FeLease No. SF-079634

Unit _____

SUNDRY NOTICES AND REPORTS ON WELLS

| | | |
|---|---|-------------------------------------|
| NOTICE OF INTENTION TO DRILL..... | SUBSEQUENT REPORT OF WATER SHUT-OFF..... | <input checked="" type="checkbox"/> |
| NOTICE OF INTENTION TO CHANGE PLANS..... | SUBSEQUENT REPORT OF SHOOTING OR ACIDIZING..... | |
| NOTICE OF INTENTION TO TEST WATER SHUT-OFF..... | SUBSEQUENT REPORT OF ALTERING CASING..... | |
| NOTICE OF INTENTION TO RE-DRILL OR REPAIR WELL..... | SUBSEQUENT REPORT OF RE-DRILLING OR REPAIR..... | |
| NOTICE OF INTENTION TO SHOOT OR ACIDIZE..... | SUBSEQUENT REPORT OF ABANDONMENT..... | |
| NOTICE OF INTENTION TO PULL OR ALTER CASING..... | SUPPLEMENTARY WELL HISTORY..... | |
| NOTICE OF INTENTION TO ABANDON WELL..... | | |

(INDICATE ABOVE BY CHECK MARK NATURE OF REPORT, NOTICE, OR OTHER DATA)

June 5, 1956

McClanahan 6
Well No. 7 is located 1850 ft. from [N] line and 1500 ft. from [W] line of sec. 23
SE/NW, Section 23 T-28-N, R-10-W N.M.P.M.
($\frac{1}{4}$ Sec. and Sec. No.) (Twp.) (Range) (Meridian)
Fulcher-Kutz Extension San Juan New Mexico
(Field) (County or Subdivision) (State or Territory)

The elevation of the derrick floor above sea level is 5936 ft.

DETAILS OF WORK

(State names of and expected depths to objective sands; show sizes, weights, and lengths of proposed casings; indicate mudding jobs, cementing points, and all other important proposed work)

Well was spudded May 9, 1956. Set 8 5/8" casing at 187' with 110 sacks cement. Tested for 30 minutes with 500# pressure, no leaks. Drilled cement plug May 29, 1956. Tested for 30 minutes with 500# pressure, no drop in pressure.

I understand that this plan of work must receive approval in writing by the Geological Survey before operations may be commenced.

Company AZTEC OIL & GAS COMPANYAddress P O BOX 786Farmington, New MexicoBy Joe C. SalmonJoe C. Salmon
Title Drilling Superintendent

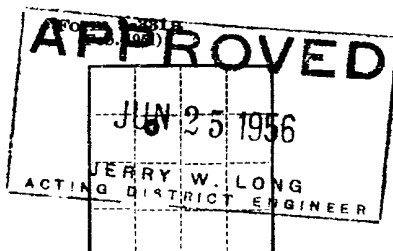

(SUBMIT IN TRIPLICATE)

UNITED STATES
DEPARTMENT OF THE INTERIOR
GEOLOGICAL SURVEY

Land Office Santa Fe
Lease No. SF-079634
Unit _____

SUNDRY NOTICES AND REPORTS ON WELLS

| | | |
|---|---|----------|
| NOTICE OF INTENTION TO DRILL..... | SUBSEQUENT REPORT OF WATER SHUT-OFF..... | X |
| NOTICE OF INTENTION TO CHANGE PLANS..... | SUBSEQUENT REPORT OF SHOOTING OR ACIDIZING..... | |
| NOTICE OF INTENTION TO TEST WATER SHUT-OFF..... | SUBSEQUENT REPORT OF ALTERING CASING..... | |
| NOTICE OF INTENTION TO RE-DRILL OR REPAIR WELL..... | SUBSEQUENT REPORT OF RE-DRILLING OR REPAIR..... | |
| NOTICE OF INTENTION TO SHOOT OR ACIDIZE..... | SUBSEQUENT REPORT OF ABANDONMENT..... | |
| NOTICE OF INTENTION TO PULL OR ALTER CASING..... | SUPPLEMENTARY WELL HISTORY..... | |
| NOTICE OF INTENTION TO ABANDON WELL..... | | |

(INDICATE ABOVE BY CHECK MARK NATURE OF REPORT, NOTICE, OR OTHER DATA)

June 6, 1956

McClanahan 6

Well No. is located 1850 ft. from (N) line and 1500 ft. from (W) line of sec. 23

SE/NW, Section 23
($\frac{1}{4}$ Sec. and Sec. No.)

T-28-N, R-10-W
(Twp.) (Range)

N.M.P.M.
(Meridian)

Fulcher-Kutz Extension
(Field)

San Juan
(County or Subdivision)

New Mexico
(State or Territory)

The elevation of the derrick floor above sea level is 5936 ft.

DETAILS OF WORK

(State names of and expected depths to objective sands; show sizes, weights, and lengths of proposed casings; indicate mudding jobs, cementing points, and all other important proposed work)

TD 2125. Top Pictured Cliffs formation 2020. Set 2115' of 5 1/2" casing at 2125' with 100 sacks cement. Drilled cement plug June 6, 1956. Swabbed hole dry. Tested for 2 hours with 500 lbs. pressure. Pipe O.K.

I understand that this plan of work must receive approval in writing by the Geological Survey before operations may be commenced.

Company AZTEC OIL & GAS COMPANY

Address P O Box 786

Farmington, New Mexico

By Joe C. Salmon
Joe C. Salmon
Title Drilling Superintendent

MULTI-POINT BACK PRESSURE TEST FOR GAS WELLS

Pool Fulcher-Kuts Extension Formation Pictured Cliffs County San Juan
Initial X Annual _____ Special _____ Date of Test June 15, 1956
Company Astec Oil & Gas Company Lease McClanahan Well No. 6
Unit F Sec. 23 Twp. 28 Rge. 10 Purchaser Southern Union Gas Company
Casing 5 1/2" Wt. 11# I.D. - - Set at 2125 Perf. 2025 To 2078
Tubing 1" Wt. 1.7# I.D. - - Set at 2020 Perf. 1999 To 2009
Gas Pay: From 2025 To 2078 L _____ xG _____ -GL _____ Bar.Press. _____
Producing Thru: Casing X Tubing _____ Type Well Single
Date of Completion: June 8, 1956 Packer None Single-Bradenhead-G. G. or G.O. Dual
Reservoir Temp. _____

OBSERVED DATA

Tested Through (~~Prover~~) (Choke) (~~Meter~~) Shut-in 7 days Type Taps _____

| No. | Flow Data | | | Tubing Data | | Casing Data | | Duration of Flow Hr. |
|-----|----------------------------|------------------------------|----------------|-------------------------|--------------|----------------|--------------|----------------------------|
| | (Prover) (Line) Size | (Choke) (Orifice) Size | Press. psig | Diff. h _w | Temp. °F. | Press. psig | Temp. °F. | |
| SI | | | | | | | | |
| 1. | | <u>0.750</u> | | | | <u>641</u> | <u>641</u> | <u>3 hrs.</u> |
| 2. | | | | | | <u>292</u> | <u>243</u> | |
| 3. | | | | | | | | |
| 4. | | | | | | | | |
| 5. | | | | | | | | |

FLOW CALCULATIONS

| No. | Coefficient (24-Hour) | $\sqrt{h_w p_f}$ | Pressure psia | Flow Temp. Factor F _{LT} | Gravity Factor F _g | Compress. Factor F _{pv} | Rate of Flow Q-MCFPD @ 15.025 psia |
|-----|--------------------------|------------------|------------------|---|-------------------------------------|--|--|
| 1. | <u>12.365</u> | | <u>255</u> | <u>1.0</u> | <u>0.961</u> | <u>1.031</u> | <u>3125</u> |
| 2. | | | | | | | |
| 3. | | | | | | | |
| 4. | | | | | | | |
| 5. | | | | | | | |

PRESSURE CALCULATIONS

Gas Liquid Hydrocarbon Ratio _____ cf/bbl.
Gravity of Liquid Hydrocarbons _____ deg.
F_c _____ (1-e^{-S}) Specific Gravity Separator Gas _____
Specific Gravity Flowing Fluid _____
P_c _____ P_c _____

| No. | P _w P _t (psia) | P _t ² | F _c Q | (F _c Q) ² | (F _c Q) ² (1-e ^{-S}) | F _w ² | P _c ² -P _w ² | Cal. P _w | P _w P _c |
|-----|---|-----------------------------|------------------|---------------------------------|---|-----------------------------|--|------------------------|----------------------------------|
| 1. | <u>255</u> | | | | | <u>65.025</u> | <u>361.384</u> | | |
| 2. | | | | | | | | | |
| 3. | | | | | | | | | |
| 4. | | | | | | | | | |
| 5. | | | | | | | | | |

Absolute Potential: 3597 MCFPD; n 0.85
COMPANY AZTEC OIL & GAS COMPANY
ADDRESS P O Box 786, Farmington, New Mexico
AGENT and TITLE ORIGINAL SIGNED BY BILL R. HASTINGS, Bill R. Hastings
WITNESSED _____
COMPANY _____

REMARKS

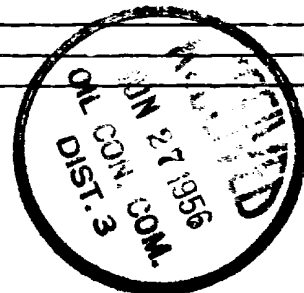

NEW MEXICO OIL CONSERVATION COMMISSION
Santa Fe, New Mexico

(Form C-104)
(Revised 7/1/52)

REQUEST FOR (OIL) - (GAS) ALLOWABLE

New Well
~~Existing Well~~

This form shall be submitted by the operator before an initial allowable will be assigned to any completed Oil or Gas well. Form C-104 is to be submitted in QUADRUPLICATE to the same District Office to which Form C-101 was sent. The allowable will be assigned effective 7:00 A.M. on date of completion or recompletion, provided this form is filed during calendar month of completion or recompletion. The completion date shall be that date in the case of an oil well when oil is delivered into the stock tanks. Gas must be reported on 15.025 psia at 60° Fahrenheit.

Farmington, New Mexico July 13, 1956

(Place)

(Date)

WE ARE HEREBY REQUESTING AN ALLOWABLE FOR A WELL KNOWN AS:

Astec Oil & Gas Company McIlvenahan, Well No. 6, in SE 1/4 NW 1/4,
(Company or Operator) (Lease)

Sec. 23, T. 28-N, R. 10-W, NMPM, Fulcher-Ruta Extension Pool
(Unit)

San Juan County. Date Spudded May 9, 1956, Date Completed June 15, 1956

Please indicate location:

| | | | |
|--|--|--|--|
| | | | |
| | | | |
| | | | |
| | | | |

Elevation 5936 D.F. Total Depth 2125' P.B. - -

Top oil/gas pay 2020 Name of Prod. Form Pictured Cliffs

Casing Perforations: 2025-2078 or

Depth to Casing shoe of Prod. String 2125

Natural Prod. Test BOPD

based on bbls. Oil in Hrs. Mins.

Test after acid or shot BOPD

Based on bbls. Oil in Hrs. Mins.

Gas Well Potential 3597 MCF

Size choke in inches 3/4"

Date first oil run to tanks or gas to Transmission system: Not connected

Transporter taking Oil or Gas: Southern Union Gas Company

Casing and Cementing Record

Size Feet Sax

| | | |
|--------|------|-----|
| 8 5/8" | 195 | 110 |
| 5 1/2" | 2125 | 100 |
| 1" | 2020 | |

Remarks: Shut-in Casing and Tubing Pressure 641, Volume through 3/4" choke 3125 MCF

I hereby certify that the information given above is true and complete to the best of my knowledge.

Approved: JUL 19 1956, 19

OIL CONSERVATION COMMISSION

By: Emergency C. Arnold

Title Oil and Gas Inspector Dist. #3.

ASTEC OIL & GAS COMPANY
(Company or Operator)

By: Joe C. Salmon
(Signature)

Title: Drilling Superintendent

Send Communications regarding well to:

Name: Joe C. Salmon

Address: Box 786, Farmington, New Mexico

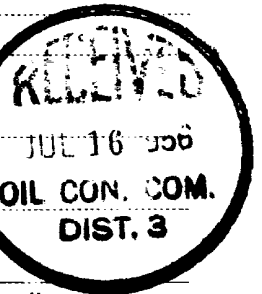

| | |
|------------------------|-------|
| NO. OF COPIES RECEIVED | 5 |
| DISTRIBUTION | |
| SANTA FE | / |
| FILE | / |
| U.S.G.S. | |
| LAND OFFICE | |
| TRANSPORTER | OIL / |
| | GAS / |
| OPERATOR | / |
| PRORATION OFFICE | |

NEW MEXICO OIL CONSERVATION COMMISSION
REQUEST FOR ALLOWABLE
AND
AUTHORIZATION TO TRANSPORT OIL AND NATURAL GAS

Form C-104
Supersedes Old C-104 and C-110
Effective 1-1-65

I. Operator
Aztec Oil & Gas Company
Address
Drawer 570, Farmington, New Mexico
Reason(s) for filing (Check proper box)
New Well ☐ Change in Transporter of:
Recompletion ☐ Oil ☐ Dry Gas ☒
Change in Ownership ☐ Casinghead Gas ☐ Condensate ☐
Other (Please explain)

If change of ownership give name
and address of previous owner

II. DESCRIPTION OF WELL AND LEASE

| | | | | |
|--|---------------|---|--|------------------------|
| Lease Name McClanahan | Well No. 6 | Pool Name, including Formation Pictured Cliffs | Kind of Lease State, Federal or Fee | Lease No. SR-070634 |
| Location Unit Letter F ; 1850 Feet From The North Line and 1200 Feet From The West Line of Section 23 Township 28N Range 10W , NMPM, San Juan County | | | | |

III. DESIGNATION OF TRANSPORTER OF OIL AND NATURAL GAS

| | | | | | | |
|--|---|------|------|------|----------------------------|------|
| Name of Authorized Transporter of Oil <input type="checkbox"/> or Condensate <input checked="" type="checkbox"/> Plateau | Address (Give address to which approved copy of this form is to be sent) Box 108, Farmington, New Mexico | | | | | |
| Name of Authorized Transporter of Casinghead Gas <input type="checkbox"/> or Dry Gas <input checked="" type="checkbox"/> Southern Union Gathering | Address (Give address to which approved copy of this form is to be sent) Box 398, Bloomfield, New Mexico | | | | | |
| If well produces oil or liquids, give location of tanks. | Unit | Sec. | Twp. | Rge. | Is gas actually connected? | When |

If this production is commingled with that from any other lease or pool, give commingling order number:

IV. COMPLETION DATA

| | | | | | | | | |
|--------------------------------------|-----------------------------|----------|-----------------|----------|-------------------|-----------|-------------|--------------|
| Designate Type of Completion - (X) | Oil Well | Gas Well | New Well | Workover | Deepen | Plug Back | Same Res'v. | Diff. Res'v. |
| Date Spudded | Date Compl. Ready to Prod. | | Total Depth | | P.B.T.D. | | | |
| Elevations (DF, RKB, RT, GR, etc.) | Name of Producing Formation | | Top Oil/Gas Pay | | Tubing Depth | | | |
| Perforations | | | | | Depth Casing Shoe | | | |
| TUBING, CASING, AND CEMENTING RECORD | | | | | | | | |
| HOLE SIZE | CASING & TUBING SIZE | | DEPTH SET | | SACKS CEMENT | | | |
| | | | | | | | | |
| | | | | | | | | |
| | | | | | | | | |

V. TEST DATA AND REQUEST FOR ALLOWABLE OIL WELL

(Test must be after recovery of total volume of load oil and must be equal to or exceed top allowable for this depth or be for full 24 hours)

| | | | |
|----------------------------------|---------------------------|---|------------|
| Date First New Oil Run To Tanks | Date of Test | Producing Method (Flow, pump, gas lift, etc.) | |
| Length of Test | Tubing Pressure | Casing Pressure | |
| Actual Prod. During Test | Oil-Bbls. | Water-Bbls. | Gas-MCF |
| GAS WELL | | | |
| Actual Prod. Test-MCF/D | Length of Test | Bbls. Condensate/MMCF | |
| Testing Method (pilot, back pr.) | Tubing Pressure (Shut-in) | Casing Pressure (Shut-in) | Choke Size |

VI. CERTIFICATE OF COMPLIANCE

I hereby certify that the rules and regulations of the Oil Conservation Commission have been complied with and that the information given above is true and complete to the best of my knowledge and belief.

Jim C. Arnold
(Signature)
District Superintendent
(Title)
July 29, 1970
(Date)

OIL CONSERVATION COMMISSION
AUG 3 1970

APPROVED _____, 19

BY Original Signed by Emery C. Arnold

TITLE SUPERVISOR DIST. #3

This form is to be filed in compliance with RULE 1104.

If this is a request for allowable for a newly drilled or deepened well, this form must be accompanied by a tabulation of the deviation tests taken on the well in accordance with RULE 111.

All sections of this form must be filled out completely for allowable on new and recompleted wells.

Fill out only Sections I, II, III, and VI for changes of owner well name or number, or transporter, or other such change of condition. Separate Forms C-104 must be filed for each pool in multiple.

| | | |
|------------------------|-----|---|
| NO. OF COPIES RECEIVED | | |
| DISTRIBUTION | | 7 |
| SANTA FE | | 1 |
| FILE | | 1 |
| U.S.G.S. | | |
| LAND OFFICE | | |
| TRANSPORTER | OIL | |
| | GAS | 1 |
| OPERATOR | | 4 |
| PROPRATION OFFICE | | |

NEW MEXICO OIL CONSERVATION COMMISSION
REQUEST FOR ALLOWABLE
AND
AUTHORIZATION TO TRANSPORT OIL AND NATURAL GAS

Form C-104
Supersedes Old C-104 and C-110
Effective 1-1-65

| | |
|---|---|
| Operator Southland Royalty Company | |
| Address P. O. Drawer 570, Farmington, New Mexico 87401 | |
| Reason(s) for filing (Check proper box) | |
| New Well <input type="checkbox"/> | Change in Transporter of: Oil <input type="checkbox"/> Dry Gas <input type="checkbox"/> |
| Recompletion <input type="checkbox"/> | Casinghead Gas <input type="checkbox"/> Condensate <input type="checkbox"/> |
| Change in Ownership <input type="checkbox"/> | Other (Please explain) Name change |

If change give name and address of previous owner Aztec Oil & Gas Company, P. O. Drawer 570, Farmington, New Mexico 87401

I. DESCRIPTION OF WELL AND LEASE

| | | | | |
|--|----------------|---|--|-----------------------|
| Lease Name McClanahan | Well No. #6 | Pool Name, Including Formation Fulcher Kutz Pictured Cliff | Kind of Lease State, Federal or Fee Federal | Lease No. SF-07963 |
| Location Unit Letter <u>F</u> ; <u>1850</u> Feet From The <u>North</u> Line and <u>1500</u> Feet From The <u>West</u> Line of Section <u>23</u> Township <u>28 North</u> Range <u>10 West</u> , NMPM, <u>San Juan</u> County | | | | |

II. DESIGNATION OF TRANSPORTER OF OIL AND NATURAL GAS

| | | |
|--|--|------|
| Name of Authorized Transporter of Oil <input type="checkbox"/> or Condensate <input type="checkbox"/> | Address (Give address to which approved copy of this form is to be sent) | |
| Name of Authorized Transporter of Casinghead Gas <input type="checkbox"/> or Dry Gas <input checked="" type="checkbox"/> | Address (Give address to which approved copy of this form is to be sent) | |
| <u>Southern Union Gathering</u> | <u>Fidelity Union Tower, Dallas, Texas 75201</u> | |
| If well produces oil or liquids, give location of tanks. | Unit | Sec. |
| | Twp. | Rge. |
| | Is gas actually connected? When | |

If this production is commingled with that from any other lease or pool, give commingling order number: _____

V. COMPLETION DATA

| | | | | | | | | |
|--------------------------------------|-----------------------------|----------|-----------------|----------|-------------------|-----------|--------------|---------------|
| Designate Type of Completion - (X) | Oil Well | Gas Well | New Well | Workover | Deepen | Plug Back | Same Rest'v. | Diff. Rest'v. |
| Date Spudded | Date Compl. Ready to Prod. | | Total Depth | | P.B.T.D. | | | |
| Elevations (DF, RKB, RT, GR, etc.) | Name of Producing Formation | | Top Oil/Gas Pay | | Tubing Depth | | | |
| Perforations | | | | | Depth Casing Shoe | | | |
| TUBING, CASING, AND CEMENTING RECORD | | | | | | | | |
| HOLE SIZE | CASING & TUBING SIZE | | DEPTH SET | | SACKS CEMENT | | | |
| | | | | | | | | |
| | | | | | | | | |
| | | | | | | | | |

V. TEST DATA AND REQUEST FOR ALLOWABLE OIL WELL (Test must be after recovery of total volume of load oil and must be equal to or exceed top allowable for this depth or be for full 24 hours)

| | | | |
|---------------------------------|-----------------|---|------------|
| Date First New Oil Run To Tanks | Date of Test | Producing Method (Flow, pump, gas lift, etc.) | |
| Length of Test | Tubing Pressure | Casing Pressure | Choke Size |
| Actual Prod. During Test | Oil-Bbls. | Water-Bbls. | Gas-MCF |

GAS WELL

| | | | |
|----------------------------------|---------------------------|---------------------------|-----------------------|
| Actual Prod. Test-MCF/D | Length of Test | Bbls. Condensate/MMCF | Gravity of Condensate |
| Testing Method (pilot, back pr.) | Tubing Pressure (Shut-in) | Casing Pressure (Shut-in) | Choke Size |

VI. CERTIFICATE OF COMPLIANCE

I hereby certify that the rules and regulations of the Oil Conservation Commission have been complied with and that the information given above is true and complete to the best of my knowledge and belief.

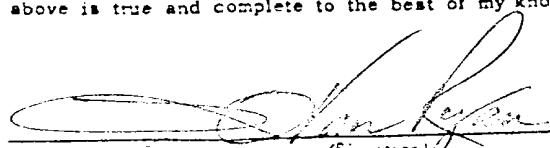
District Production Mgr.
1-1-78 (Title)
(Date)

OIL CONSERVATION COMMISSION

APPROVED JAN 12 1978, 19
BY Original Signed by G. R. KENDALL
TITLE _____

This form is to be filed in compliance with RULE 1104.
If this is a request for allowable for a newly drilled or deepened well, this form must be accompanied by a tabulation of the deviation tests taken on the well in accordance with RULE 111.
All sections of this form must be filled out completely for allowable on new and recompleted wells.
Fill out only Sections I, II, III, and VI for changes of owner, well name or number, or transporter, or other such change of condition.
Separate Forms C-104 must be filed for each pool in multiply completed wells.