

(SUBMIT IN TRIPLICATE)

UNITED STATES
DEPARTMENT OF THE INTERIOR
GEOLOGICAL SURVEY

Land Office Santa Fe
Lease No. 17-080781
Unit Cain

SUNDRY NOTICES AND REPORTS ON WELLS

NOTICE OF INTENTION TO DRILL	<input checked="" type="checkbox"/>	SUBSEQUENT REPORT OF WATER SHUT-OFF	
NOTICE OF INTENTION TO CHANGE PLANS		SUBSEQUENT REPORT OF SHOOTING OR ACIDIZING	
NOTICE OF INTENTION TO TEST WATER SHUT-OFF		SUBSEQUENT REPORT OF ALTERING CASING	
NOTICE OF INTENTION TO RE-DRILL OR REPAIR WELL		SUBSEQUENT REPORT OF RE-DRILLING OR REPAIR	
NOTICE OF INTENTION TO SHOOT OR ACIDIZE		SUBSEQUENT REPORT OF ABANDONMENT	
NOTICE OF INTENTION TO PULL OR ALTER CASING		SUPPLEMENTARY WELL HISTORY	
NOTICE OF INTENTION TO ABANDON WELL			

(INDICATE ABOVE BY CHECK MARK NATURE OF REPORT, NOTICE, OR OTHER DATA)

April 13, 1960

Well No. 17-1 is located 920 ft. from S line and 1060 ft. from W line of sec.

Angel Peak Dakota Extension (Field) T-4N (Twp.) R-10W (Range) N.M.P.M. (Meridian)
Santa Fe (County or Subdivision) New Mexico (State or Territory)

The elevation of the derrick floor above sea level is 5877 ft. (Ground Elevation)

DETAILS OF WORK

(State names of and expected depths to objective sands; show sizes, weights, and lengths of proposed casings; indicate mudding jobs, cementing points, and all other important proposed work)

Propose to: Set 50' of 5 5/8" surface casing and cement to surface. Drill with rotary tools to approximate total depth of 6500' or through Dakota formation.

Run 4 1/2" production casing to total depth with a two-stage cement collar set approximately 100' below Pictured Cliffs formation, cement first stage with 285 ex. and second stage with 125 ex.

Perforate Dakota formation. Sand-water flow with 100,000 gals. water and 100,000 ex. sand. Run 2 1/8" tubing.

Set 1/2 of Section 19, consisting of 50 acres dedicated to well.

I understand that this plan of work must receive approval in writing by the Geological Survey before operations may be commenced.

Company Aster Oil & Gas Company

Address Box 786

Farmington, New Mexico

ORIGINAL SIGNED BY JOE C. SALMON

By Joe C. Salmon

Title District Superintendent

NEW MEXICO OIL CONSERVATION COMMISSION

Well Location and Acreage Dedication Plat

Section A.

Date April 12, 1960

Operator Astec Oil & Gas Company Lease Cain
Well No. 10-D Unit Letter M Section 15 Township 28N Range 10W NMPN
Located 920 Feet From South Line, 1060 Feet From West Line
County San Juan G. L. Elevation 5877 Dedicated Acreage 320 Acres
Name of Producing Formation Dakota Pool Angel Peak Dakota Extension

1. Is the Operator the only owner* in the dedicated acreage outlined on the plat below?
Yes XX No _____
2. If the answer to question one is "no," have the interests of all the owners been consolidated by communitization agreement or otherwise? Yes _____ No _____. If answer is "yes,"
Type of Consolidation _____
3. If the answer to question two is "no," list all the owners and their respective interests below:

Owner

Land Description

Section. B

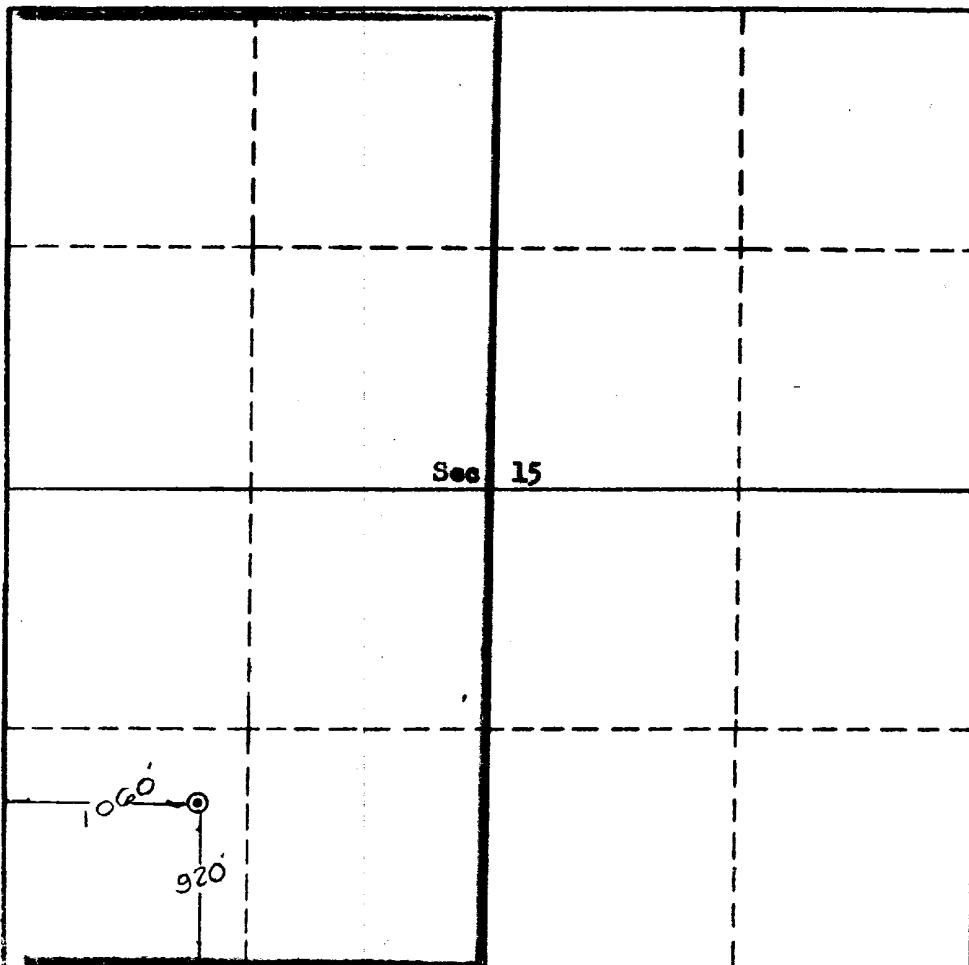

This is to certify that the information in Section A above is true and complete to the best of my knowledge and belief.

Astec Oil & Gas Company
(Operator)

ORIGINAL SIGNED BY JOE C. SALMON
(Representative)

Box 786, Farmington, New Mex.
Address

This is to certify that the well location shown on the plat in Section B was plotted from field notes of actual surveys made by me or under my supervision and that the same is true to the best of my knowledge and belief.

Date Surveyed April 10, 1960

Ernest V. Echohawk
Registered Land Surveyor.

Certificate No. 1545

