

(SUBMIT IN TRIPLICATE)

UNITED STATES
DEPARTMENT OF THE INTERIOR
GEOLOGICAL SURVEY

Land Office Santa Fe
Lease No. 24-01772A
Unit 1014

SUNDRY NOTICES AND REPORTS ON WELLS

NOTICE OF INTENTION TO DRILL.....	<input checked="" type="checkbox"/>	SUBSEQUENT REPORT OF WATER SHUT-OFF.....	
NOTICE OF INTENTION TO CHANGE PLANS.....		SUBSEQUENT REPORT OF SHOOTING OR ACIDIZING.....	
NOTICE OF INTENTION TO TEST WATER SHUT-OFF.....		SUBSEQUENT REPORT OF ALTERING CASING.....	
NOTICE OF INTENTION TO RE-DRILL OR REPAIR WELL.....		SUBSEQUENT REPORT OF RE-DRILLING OR REPAIR.....	
NOTICE OF INTENTION TO SHOOT OR ACIDIZE.....		SUBSEQUENT REPORT OF ABANDONMENT.....	
NOTICE OF INTENTION TO PULL OR ALTER CASING.....		SUPPLEMENTARY WELL HISTORY.....	
NOTICE OF INTENTION TO ABANDON WELL.....			

(INDICATE ABOVE BY CHECK MARK NATURE OF REPORT, NOTICE, OR OTHER DATA)

August 26, 1960

Well No. 18-D is located 1030 ft. from N line and 1630 ft. from E line of sec. 18

S. 1/4, Section 18 26N 9E 1014
(1/4 Sec. and Sec. No.) (Twp.) (Range) (Meridian)

Angel Peak Extension New Mexico Santa Fe County
(Field) (County or Subdivision) (State)

The elevation of the derrick floor above sea level is 5764 ft. (Ground Elevation)

DETAILS OF WORK

(State names of and expected depths to objective sands; show sizes, weights, and lengths of proposed casings; indicate mudlogging, cementing points, and all other important proposed work)

Propose To: Set 100 feet of 3 5/8" surface casing and cement to surface.

Drill with rotary to approximate total depth of 6532 feet or through Dakota formation. Run 4 1/2" production casing to total depth and cement with 800 cu. Set 2-stage cement collar 100 feet below Pictured Cliffs formation and cement with 150 cu.

Perforate Dakota formation with four shots per foot.

Send-water frac with 80,000 cu. sand and 80,000 gals. water. Run 2 1/8" tubing.

South one-half of Section 18, 101.20 acre, dedicated to well.

I understand that this plan of work must receive approval in writing by the Geological Survey before operations may be commenced.

Company Astec Oil and Gas Company

Address P. O. Drawer 570

Farmington, New Mexico

ORIGINAL SIGNED BY JOE C. SALMON

By Joe C. Salmon

Title District Superintendent

NEW MEXICO OIL CONSERVATION COMMISSION

Well Location and Acreage Dedication Plat

Section A.

Date August 25, 1960

Operator Astec Oil and Gas Company Lease Reid
Well No. 18-D Unit Letter K Section 18 Township 28N Range 9W NMPM
Located 1850 Feet From South Line, 1650 Feet From West Line
County San Juan G. L. Elevation 5744 Dedicated Acreage 301.29 Acres
Name of Producing Formation dakota Pool Angel Peak Extension

1. Is the Operator the only owner* in the dedicated acreage outlined on the plat below?
Yes XX No _____.
2. If the answer to question one is "no," have the interests of all the owners been consolidated by communitization agreement or otherwise? Yes _____ No _____. If answer is "yes,"
Type of Consolidation _____
3. If the answer to question two is "no," list all the owners and their respective interests below:

Owner

Land Description

Section. B

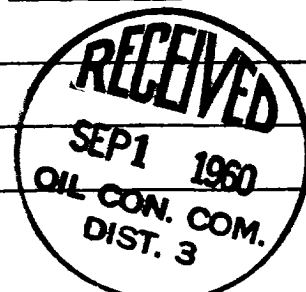
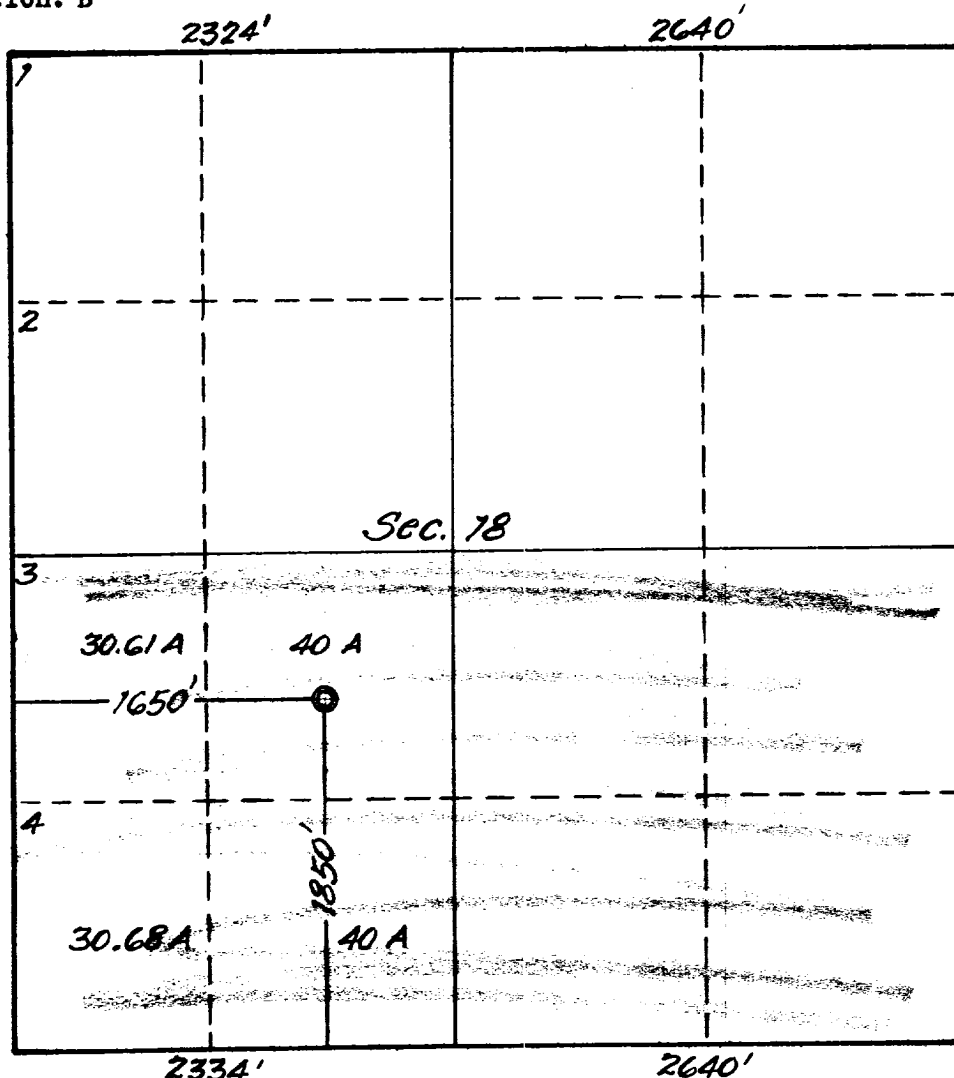

This is to certify that the information in Section A above is true and complete to the best of my knowledge and belief.

Astec Oil and Gas Co.
(Operator)

ORIGINAL SIGNED BY JOE C. SALMON
(Representative)

Drawer 570, Farmington, N.M.
Address

This is to certify that the well location shown on the plat in Section B was from field notes and actual surveys made by me or under my supervision and that the same is true to the best of my knowledge and belief.

Date Surveyed Aug. 24, 1960

E. V. Echshaw
Ernest V. Echshaw
Registered Land Surveyor.

Certificate No. 1545

