

UNITED STATES
DEPARTMENT OF THE INTERIOR
GEOLOGICAL SURVEY

APPLICATION FOR PERMIT TO DRILL, DEEPEN, OR PLUG BACK

1a. TYPE OF WORK

DRILL ☒DEEPEN ☐PLUG BACK ☐

b. TYPE OF WELL

OIL
WELL ☐GAS
WELL ☒OTHER ☐SINGLE
ZONE ☒MULTIPLE
ZONE ☐

2. NAME OF OPERATOR

Tenneco Oil Company

3. ADDRESS OF OPERATOR

P. O. Box 1714, Durango, Colorado

4. LOCATION OF WELL (Report location clearly and in accordance with any State requirements.*)

At surface

Unit Letter M 990' FSL 990' FWL
At proposed prod. zone

14. DISTANCE IN MILES AND DIRECTION FROM NEAREST TOWN OR POST OFFICE*

10 miles

15. DISTANCE FROM PROPOSED*
LOCATION TO NEAREST
PROPERTY OR LEASE LINE, FT.
(Also to nearest drlg. unit line, if any)

16. NO. OF ACRES IN LEASE

320

17. NO. OF ACRES ASSIGNED
TO THIS WELL

320

18. DISTANCE FROM PROPOSED LOCATION*
TO NEAREST WELL, DRILLING, COMPLETED,
OR APPLIED FOR, ON THIS LEASE, FT.

19. PROPOSED DEPTH

6555

20. ROTARY OR CABLE TOOLS

Rotary

21. ELEVATIONS (Show whether DF, RT, GR, etc.)

5876 GR

22. APPROX. DATE WORK WILL START*

7-22-65

23.

PROPOSED CASING AND CEMENTING PROGRAM

SIZE OF HOLE	SIZE OF CASING	WEIGHT PER FOOT	SETTING DEPTH	QUANTITY OF CEMENT
12-1/4"	8-5/8	24#	250	Circulate to surface.
7-7/8"	4-1/2	10.5#	6555	2 stages 100 sacks First stage, 2nd stage w/sufficient amount to circulate to surface.

We propose to rig up rotary rig and drill to 250' set 8-5/8" surface casing. WOC. Drill out from under surface to approximately 6555'. Set 5-1/2" 10.5# casing through stage collar, cement w/2 stages. Log perforate and complete as a single Dakota producer through 2-3/8" tubing.

IN ABOVE SPACE DESCRIBE PROPOSED PROGRAM: If proposal is to deepen or plug back, give data on present production, proposed new productive zone. If proposal is to drill or deepen directionally, give pertinent data on subsurface locations and measured depths. Give blowout preventer program, if any.

24.

Original Signed 2:

SIGNED

J. H. WATKINS
J. H. Watkins

TITLE District Office Supv.

DATE 7-22-65

(This space for Federal or State office use)

PERMIT NO.

APPROVAL DATE

APPROVED BY

TITLE

CONDITIONS OF APPROVAL, IF ANY:

NEW MEXICO OIL CONSERVATION COMMISSION

Well Location and Acreage Dedication Plat

Section A.

Date 7-22-65

Operator TENNECO OIL COMPANY Lease Order A
 Well No. 990-44 Unit Letter M Section 25 Township 28 North Range 10 West NMPM
 Located 990 Feet From South Line 990 Feet From West Line
 County San Juan G. L. Elevation 5876 ungraded Dedicated Acreage 320 Acres
 Name of Producing Formation Dakota Pool Dakota

1. Is the Operator the only owner in the dedicated acreage outlined on the plat below?
 Yes _____ No _____
2. If the answer to question one is "no", have the interests of all the owners been consolidated by communitization agreement or otherwise? Yes _____ No _____. If answer is "yes", Type of Consolidation.

3. If the answer to question two is "no", list all the owners and their respective interests below:

OwnerLand Description

Section B.

This is to certify that the information in Section A above is true and complete to the best of my knowledge and belief.

Tenneco Oil Company

Original Signed By (Operator)

HAROLD C. NICHOLS

(Representative)

Box 1714

(Address)

Durango, Colorado

Note: All distances must be from outer boundaries of section.

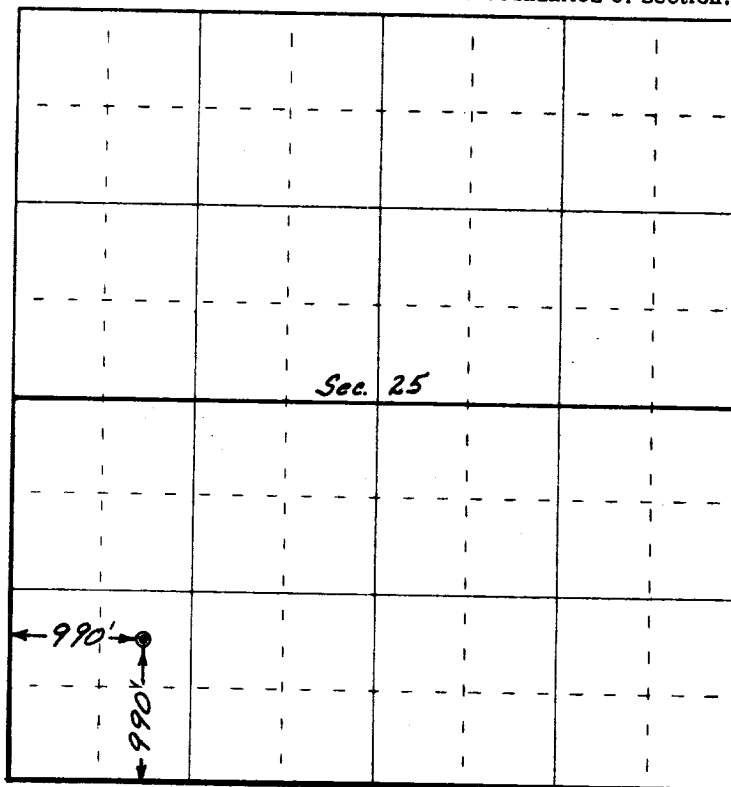

0 330 660 990 1320 1650 1980 2310 2640 2000 1500 1000 500 0

Scale 4 inches equal 1 mile

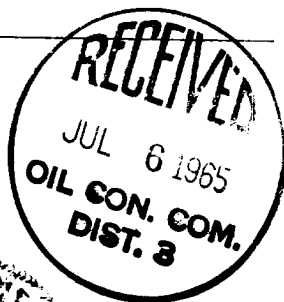

This is to certify that the above plat was prepared from field notes of actual surveys made by me or under my supervision and that the same are true and correct to the best of my knowledge and belief.

(Seal)

ERNST ENGINEERING CO
 Durango, Colorado

Date Surveyed 23 April 1965

Robert H. Ernst
 Registered Professional Engineer and/or Land Surveyor
 Robert H. Ernst, N. Mex. No. 2142