

UNITED STATES
DEPARTMENT OF THE INTERIOR
GEOLOGICAL SURVEY

APPLICATION FOR PERMIT TO DRILL, DEEPEN, OR PLUG BACK

1a. TYPE OF WORK

DRILL ☒

DEEPEN ☐

PLUG BACK ☐

b. TYPE OF WELL

OIL WELL ☐

GAS WELL ☒

OTHER

SINGLE ZONE ☐

MULTIPLE ZONE ☐

2. NAME OF OPERATOR

Marathon Oil Company

3. ADDRESS OF OPERATOR

P. O. Box 2659, Casper, Wyoming 82602

4. LOCATION OF WELL (Report location clearly and in accordance with any State requirements.)*

At surface

1,150' FSL and 1,800' FWL, NW/4 SE/4 SW/4 ~~Section~~

At proposed prod. zone

14. DISTANCE IN MILES AND DIRECTION FROM NEAREST TOWN OR POST OFFICE*

3 miles south and 1/4 mile east of Bloomfield, NM

15. DISTANCE FROM PROPOSED*

LOCATION TO NEAREST PROPERTY OR LEASE LINE, FT. (Also to nearest drig. unit line, if any)

1,150'

16. NO. OF ACRES IN LEASE

320

17. NO. OF ACRES ASSIGNED TO THIS WELL

160

18. DISTANCE FROM PROPOSED LOCATION*

TO NEAREST WELL, DRILLING, COMPLETED, OR APPLIED FOR, ON THIS LEASE, FT.

See Item 3

19. PROPOSED DEPTH

1,750'

20. ROTARY OR CABLE TOOLS

Rotary

21. ELEVATIONS (Show whether DF, RT, GR, etc.)

5620 GL

22. APPROX. DATE WORK WILL START*

23.

PROPOSED CASING AND CEMENTING PROGRAM

SIZE OF HOLE	SIZE OF CASING	WEIGHT PER FOOT	SETTING DEPTH	QUANTITY OF CEMENT
12-1/4"	8-5/8"	24#	225'	250 Sacks
7-7/8"	4-1/2"	10.5#	1,750'	220 Sacks

Please see the following attachments:

1. Surveyor's Plat
2. Ten Point Drilling Program
3. BOP Schematic
4. Thirteen Point NTL-6
5. Maps

IN ABOVE SPACE DESCRIBE PROPOSED PROGRAM: If proposal is to deepen or plug back, give data on present productive zone and proposed new productive zone. If proposal is to drill or deepen directionally, give pertinent data on subsurface locations and measured and true vertical depths. Give blowout preventer program, if any.

24.

SIGNED

B. E. Hester

TITLE District Operations Manager

DATE

May 9, 1978

(This space for Federal or State office use)

PERMIT NO.

APPROVAL DATE

APPROVED BY

TITLE

DATE

CONDITIONS OF APPROVAL, IF ANY:

ok Frank

*See Instructions On Reverse Side

5. LEASE DESIGNATION AND SERIAL NO.

NM-02498

02048

6. IF INDIAN, ALLOTTEE OR TRIBE NAME

7. UNIT AGREEMENT NAME

8. FARM OR LEASE NAME

Ohio Government

9. WELL NO.

10. FIELD AND POOL, OR WILDCAT

Fulcher Kutz-Pictured Cliffs

11. SEC., T., R., M., OR BLE. AND SURVEY OR AREA

Sec. 15, T28N, R11W

12. COUNTY OR PARISH

San Juan

13. STATE

New Mexico



**NEW MEXICO OIL CONSERVATION COMMISSION
WELL LOCATION AND ACREAGE DEDICATION PLAT**

Form C-102
Supersedes C-128
Effective 1-1-65

All distances must be from the outer boundaries of the Section.

Operator Marathon Oil Company			Lease Ohio Government		Well No. 254
Unit Letter N	Section 15	Township 28 North	Range 11 West	County San Juan	
Actual Footage Location of Well: 1150 feet from the South line and 1800 feet from the West line					
Ground Level Elev. 5620	Producing Formation Pictured Cliffs	Pool Fulcher Kutz Pictured Cliffs		Dedicated Acreage: 160 220 Acres	

1. Outline the acreage dedicated to the subject well by colored pencil or hachure marks on the plat below.
2. If more than one lease is dedicated to the well, outline each and identify the ownership thereof (both as to working interest and royalty).
3. If more than one lease of different ownership is dedicated to the well, have the interests of all owners been consolidated by communitization, unitization, force-pooling, etc?

☐ Yes ☐ No If answer is "yes," type of consolidation NA

If answer is "no," list the owners and tract descriptions which have actually been consolidated. (Use reverse side of this form if necessary.) _____

No allowable will be assigned to the well until all interests have been consolidated (by communitization, unitization, forced-pooling, or otherwise) or until a non-standard unit, eliminating such interests, has been approved by the Commission.

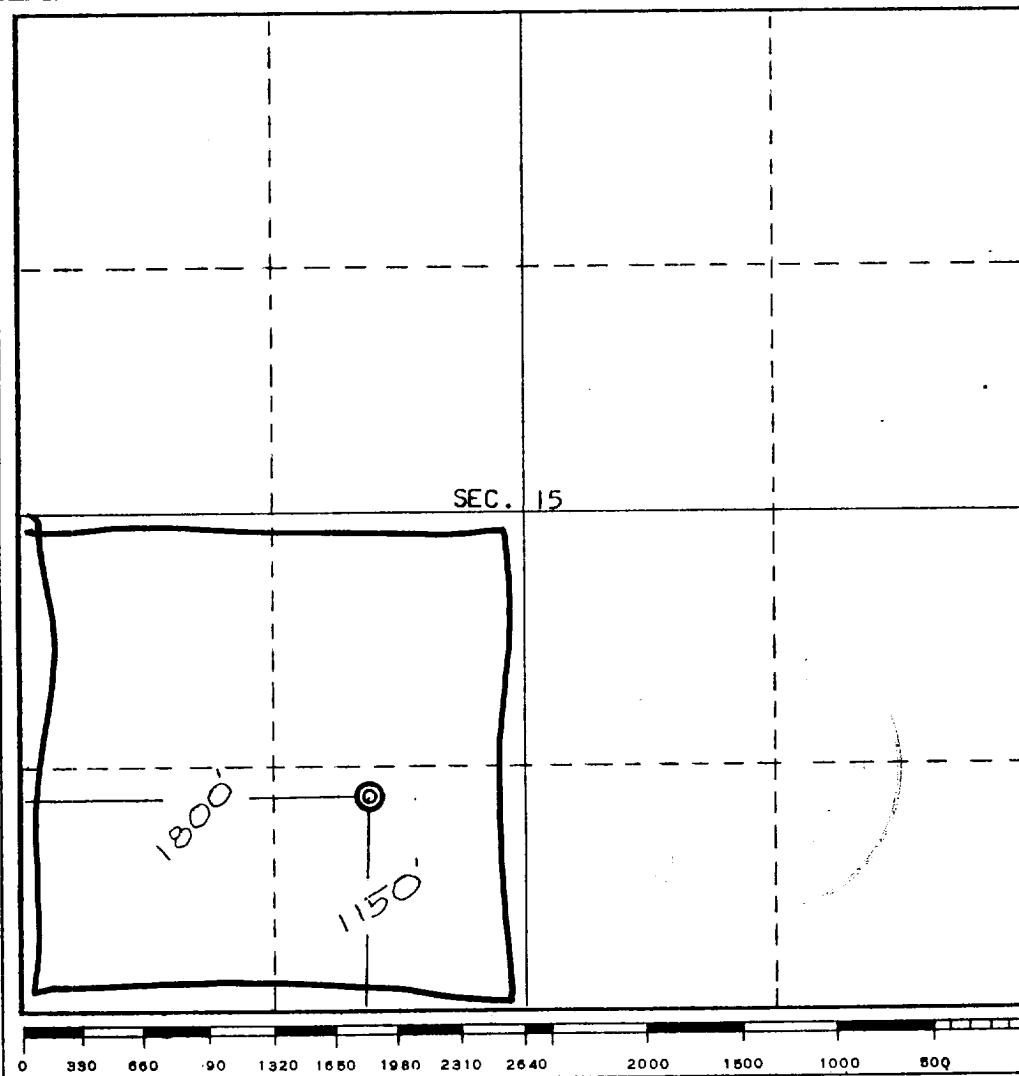

CERTIFICATION

I hereby certify that the information contained herein is true and complete to the best of my knowledge and belief.

J. F. Wirth
Name

J. F. Wirth

Position

Drilling Superintendent

Company

Marathon Oil Company

Date

May 5, 1978

I hereby certify that the well location shown on this plat was plotted from field notes of actual surveys made by me or under my supervision, and that the same are true and correct to the best of my knowledge and belief.

V. ECHOHAWK
REGISTERED LAND SURVEYOR
REG. NO. 3602
NEW MEXICO

Date Surveyed

April 27, 1978

Registered Professional Engineer
and/or Land Surveyor

E. V. Echohawk

Certificate No. **3602**

E. V. Echohawk LS