

THE APPLICATION OF TENNECO OIL COMPANY
FOR A DUAL COMPLETION

ORDER NO. MC-2821

ADMINISTRATIVE ORDER
OF THE OIL CONSERVATION DIVISION

Under the provisions of Rule 112-A, Tenneco Oil Company made application to the New Mexico Oil Conservation Division on March 10, 1981, for permission to dually complete its Omler A Well No. 3-E located in Unit O of Section 26, Township 28 North, Range 10 West, NMPM, San Juan County, New Mexico, in such a manner as to permit production of gas from the Chacra Formation and the Basin Dakota Pool.

Now, on this 18th day of May, 1981, the Division Director finds:

1. That application has been filed under the provisions of Rule 112-A of the Division's Rules and Regulations;
2. That satisfactory information has been provided that all operators of offset acreage have been duly notified;
3. That no objections have been received within the waiting period as prescribed by said rule;
4. That the proposed dual completion will not cause waste nor impair correlative rights.
5. That the mechanics of the proposed dual completion are feasible and consonant with good conservation practices.

IT IS THEREFORE ORDERED:

That the applicant herein, Tenneco Oil Company, be and the same is hereby authorized to dually complete its Omler A Well No. 3-E located in Unit O of Section 26, Township 28 North, Range 10 West, NMPM, Chaves County, New Mexico, in such a manner as to permit production of gas from the Chacra Formation and the Basin Dakota Pool through parallel strings of tubing.

PROVIDED HOWEVER, That applicant shall complete, operate, and produce said well in accordance with the provisions of Rule 112-A.

PROVIDED FURTHER, That applicant shall take packer-leakage tests upon completion and annually thereafter.

IT IS FURTHER ORDERED: That jurisdiction of this cause is hereby retained for the entry of such further orders as the Division may deem necessary.

DONE at Santa Fe, New Mexico, on the day and year hereinabove designated.

STATE OF NEW MEXICO
OIL CONSERVATION DIVISION

JOE D. RAMEY
Division Director

SEAL



STATE OF NEW MEXICO
ENERGY AND MINERALS DEPARTMENT

OIL CONSERVATION DIVISION
AZTEC DISTRICT OFFICE

1000 RIO BRAZOS ROAD
AZTEC, NEW MEXICO 87410
(505) 334-6178

OIL CONSERVATION DIVISION
BOX 2088
SANTA FE, NEW MEXICO 87501

DATE 3-10-81

RE: Proposed MC X
Proposed DHC _____
Proposed NSL _____
Proposed SWD _____
Proposed WFX _____
Proposed PMX _____

Gentlemen:

I have examined the application dated 3-10-81
for the Sinner Operator Omler A #3E Lease and Well No. 0-26-28N-10W Unit, S-T-R

and my recommendations are as follows:

Approve

Yours truly,

Frank J. Ching

NEW MEXICO OIL CONSERVATION COMMISSION
SANTA FE, NEW MEXICO
APPLICATION FOR MULTIPLE COMPLETION

Form C-107
5-1-61

Operator Tenneco Oil Company		County San Juan	Date 3/3/81
Address Box 3249, Englewood, CO 80155		Lease Omler A	Well No. 3E
Location of Well 0	Unit 26	Township 28N	Range 10W

1. Has the New Mexico Oil Conservation Commission heretofore authorized the multiple completion of a well in these same pools or in the same zones within one mile of the subject well? YES X NO
2. If answer is yes, identify one such instance: Order No. 2757 ; Operator Lease, and Well No.: Omler A 1E

3. The following facts are submitted:	Upper Zone	Intermediate Zone	Lower Zone
a. Name of Pool and Formation	Chacra		Dakota
b. Top and Bottom of Pay Section (Perforations)	2948-2974'		6258-6386'
c. Type of production (Oil or Gas)	Gas		Gas
d. Method of Production (Flowing or Artificial Lift)	Flowing		Flowing

4. The following are attached. (Please check YES or NO)

- | | | |
|---|-----------------------------|---|
| Yes <input checked="" type="checkbox"/> | No <input type="checkbox"/> | a. Diagrammatic Sketch of the Multiple Completion, showing all casing strings, including diameters and setting depths, centralizers and or turbolizers and location thereof, quantities used and top of cement, perforated intervals, tubing strings, including diameters and setting depth, location and type of packers and side door chokes, and such other information as may be pertinent. |
| <input checked="" type="checkbox"/> | <input type="checkbox"/> | b. Plat showing the location of all wells on applicant's lease, all offset wells on offset leases, and the names and addresses of operators of all leases offsetting applicant's lease. |
| <input checked="" type="checkbox"/> | <input type="checkbox"/> | c. Waivers consenting to such multiple completion from each offset operator, or in lieu thereof, evidence that said offset operators have been furnished copies of the application.* |
| <input checked="" type="checkbox"/> | <input type="checkbox"/> | d. Electrical log of the well or other acceptable log with tops and bottoms of producing zones and intervals of perforation indicated thereon. (If such log is not available at the time application is filed it shall be submitted as provided by Rule 112-A.) |

5. List all offset operators to the lease on which this well is located together with their correct mailing address.

Southland Royalty, P.O. Drawer 570, Farmington, New Mexico 87401

Southern Union (Supron), P.O. Box 808, Farmington, New Mexico 87401

6. Were all operators listed in Item 5 above notified and furnished a copy of this application? YES X NO . If answer is yes, give date of such notification March 5, 1981.

CERTIFICATE: I, the undersigned, state that I am the Asst. Div. Adm. Mgr. of the Tenneco Oil Company (company), and that I am authorized by said company to make this report; and that this report was prepared under my supervision and direction and that the facts stated therein are true, correct and complete to the best of my knowledge.

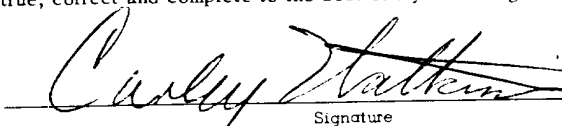
Signature

*Should waivers from all offset operators not accompany an application for administrative approval, the New Mexico Oil Conservation Commission will hold the application for a period of twenty (20) days from date of receipt by the Commission's Santa Fe office. If, after said twenty-day period, no protest nor request for hearing is received by the Santa Fe office, the application will then be processed.

NOTE: If the proposed multiple completion will result in an unorthodox well location and/or a non-standard proration unit in one or more of the producing zones, then separate application for approval of the same should be filed simultaneously with this application.

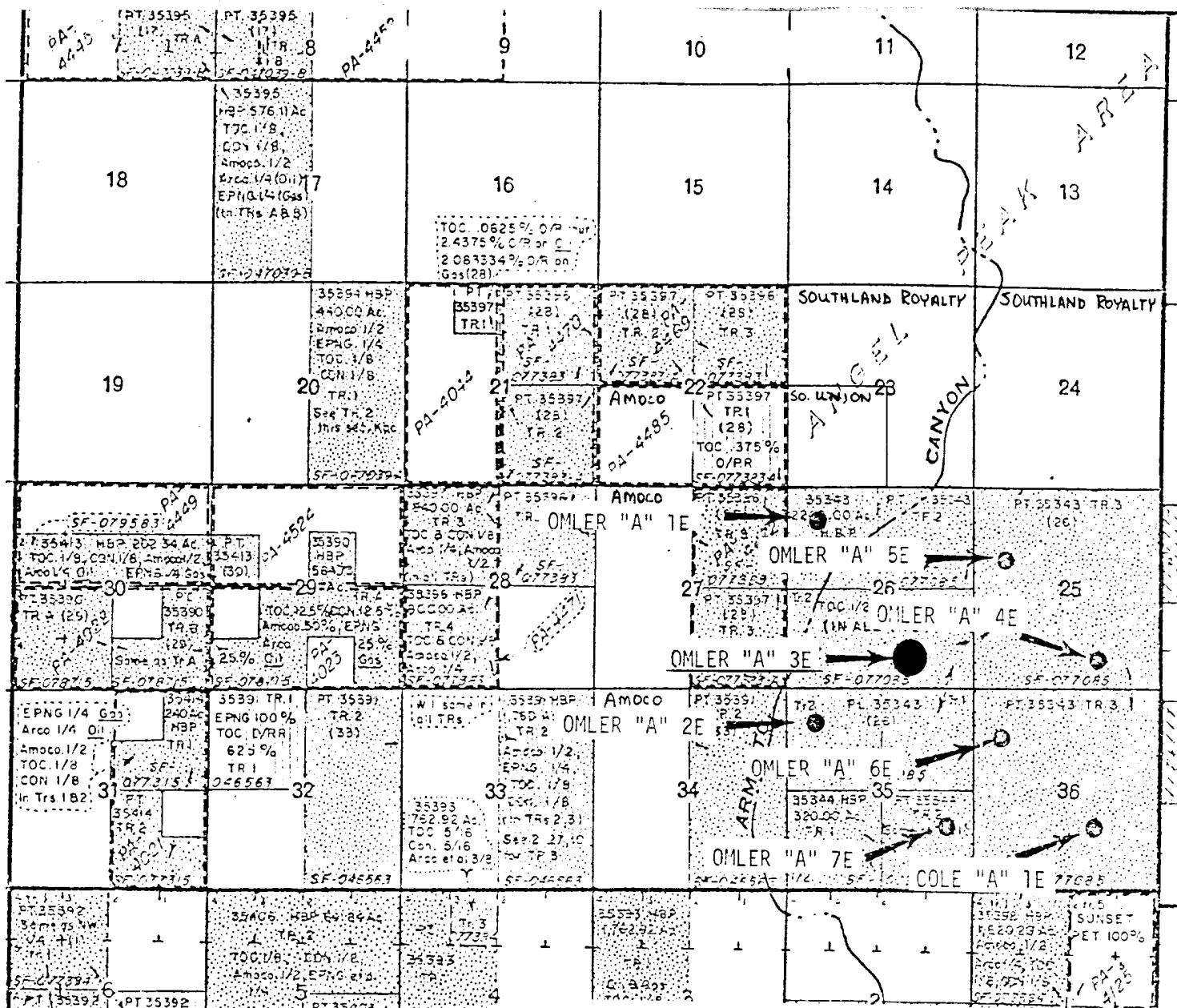

PROPOSED LOCATIONS

- Omler "A" 1E-890' FNL, 890' FWL - Sec. 26
- Omler "A" 2E-890' FNL, 890' FWL - Sec. 35
- Omler "A" 3E-890' FSL, 1750' FEL-Sec. 26
- Omler "A" 4E-890' FSL, 1750' FEL-Sec. 25
- Omler "A" 5E-1750'FNL, 890'FWL - Sec. 25
- Omler "A" 6E-1020'FNL, 890'FWL - Sec. 36
- Omler "A" 7E-1650'FSL, 1750' FEL-Sec. 36
- Cole "A" 1E-1750'FSL, 890'FEL - Sec. 35

TENNECO OIL COMPANY

SUBSIDIARY OF TENNECO INC.

DAKOTA INFILL DEVELOPMENT

SAN JUAN COUNTY, NEW MEXICO

T28N - R10W

4000 2000 0 SCALE IN FEET 4000 8000

DENVER, COLORADO

PA-4439-C 19

T28N, R10W

20

20

LEASE Omler A

WELL NO. 3E

9 5/8 "OD, 36 LB, CSG.W/ 200 SX

TOC @ SURFACE.

292'

7 "OD, 23 LB, CSG.W/ 504 SX

TOC @ SURFACE.

DETAILED PROCEDURE

23. Frac Chacra dn csg w/70% foamed 2% KCl as follows:
20,000 gal pad
10,000 gal w/1/2 ppg 20/40 sd
10,000 gal w/1 ppg 20/40 sd
10,000 gal w/1-1/2 ppg 20/40 sd
25,000 gal w/2 ppg 20/40 sd
Flush to top perf w/foam
Totals 76,460 gals 70% quality foam
80,000# 20/40 sd
24. Flow to clean up thru 1/2" choke.
25. Kill well w/2% KCl wtr.
26. RIH w/2-3/8" tbg, F nipple, muleshoe & pump thru retrievable plug in F nipple. Position seal assy & blast jts as required for Chacra.
27. Clean sd off Model D & land long string.
28. Run 1-1/4" tbg w/SN for Chacra.
29. NDBOP & NUWH. Retrieve tbg plug
30. Blow Chacra around w/N₂. Swb in Dakota.
31. Flow to clean up.

1 1/4" tbg
@ 2941'

2941-52'
2970-74'

3185'
MODEL D PKR

4622'

4772'

2 3/8" tbg @ 6260'

6258-64'
6316-36'
6382-86'
6423'

6435'