

UNITED STATES
DEPARTMENT OF THE INTERIOR
GEOLOGICAL SURVEY

APPLICATION FOR PERMIT TO DRILL, DEEPEN, OR PLUG BACK

1a. TYPE OF WORK DRILL ☒ DEEPEN ☐ PLUG BACK ☐

b. TYPE OF WELL
OIL WELL ☐ GAS WELL ☒ OTHER ☐
SINGLE ZONE ☒ MULTIPLE ZONE ☐

2. NAME OF OPERATOR
MESA PETROLEUM CO.

3. ADDRESS OF OPERATOR
1660 Lincoln, 2800 Lincoln Center, Denver, Colorado 80264

4. LOCATION OF WELL (Report location clearly and in accordance with any State requirements.)*
At surface 1530' N & 930' W
At proposed prod. zone same

14. DISTANCE IN MILES AND DIRECTION FROM NEAREST TOWN OR POST OFFICE*

15. DISTANCE FROM PROPOSED* LOCATION TO NEAREST PROPERTY OR LEASE LINE, FT. (Also to nearest drlg. unit line, if any)
18. DISTANCE FROM PROPOSED LOCATION* TO NEAREST WELL, DRILLING, COMPLETED, OR APPLIED FOR, ON THIS LEASE, FT.
16. NO. OF ACRES IN LEASE 2522.06
19. PROPOSED DEPTH 6650

21. ELEVATIONS (Show whether DF, RT, GR, etc.)

23. PROPOSED CASING AND CEMENTING PROGRAM

| SIZE OF HOLE | SIZE OF CASING | WEIGHT PER FOOT | SETTING DEPTH | QUANTITY OF CEMENT |
|--------------|----------------|-----------------|---------------|--------------------|
| 12 1/4 | 8 5/8 | 24 | 300 | 200 sk |
| 7 7/8 | 5 1/2 | 15.5 | 6650 | 555 sk |

(SEE ATTACHMENTS)

Gas under this lease is dedicated to a contract.

This action is subject to administrative
appeal pursuant to 30 CFR 290.

SEARCHED
SERIALIZED
INDEXED
FILED
OCT 30 1980
OIL CON. COM.
DIST. 3



IN ABOVE SPACE DESCRIBE PROPOSED PROGRAM: If proposal is to deepen or plug back, give data on present productive zone and proposed new productive zone. If proposal is to drill or deepen directionally, give pertinent data on subsurface locations and measured and true vertical depths. Give blowout preventer program, if any.

24. SIGNED John Alexander TITLE AGENT DATE November 28, 1979
(This space for Federal or State office use)

PERMIT NO. _____ APPROVAL DATE _____

APPROVED BY Bruce W. Ramsey TITLE _____ DATE _____
CONDITIONS OF APPROVAL, IF ANY:

DRILLING OPERATIONS AND PRODUCTION ARE
SUBJECT TO CONDITIONS OF LEASE ATTACHED
"GENERAL CONDITIONS"

NMOCC

ok Frank

All distances must be from the corner boundaries of the Section.

| | | | | | |
|---|-------------------------------|-----------------|------------------------------------|--------------------|---------------------------------|
| Operator MESA PETROLEUM COMPANY | | | Lease McLEOD- McLEOD | | Well No. 2-E |
| Unit Letter E | Section 34 | Township 28N | Range 10W | County San Juan | |
| Actual Footage Location of Well: 1530 feet from the North line and 930 feet from the West line | | | | | |
| Ground Level Elev. 5970 | Producing Formation Dakota | | Pool Basin Dakota | | Dedicated Acreage: 320 Acres |

1. Outline the acreage dedicated to the subject well by colored pencil or hachure marks on the plat below.
2. If more than one lease is dedicated to the well, outline each and identify the ownership thereof (both as to working interest and royalty).
3. If more than one lease of different ownership is dedicated to the well, have the interests of all owners been consolidated by communitization, unitization, force-pooling, etc?

☐ Yes ☐ No If answer is "yes," type of consolidation _____

If answer is "no," list the owners and tract descriptions which have actually been consolidated. (Use reverse side of this form if necessary.) _____

No allowable will be assigned to the well until all interests have been consolidated (by communitization, unitization, forced-pooling, or otherwise) or until a non-standard unit, eliminating such interests, has been approved by the Commission.

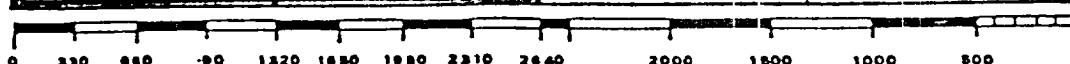
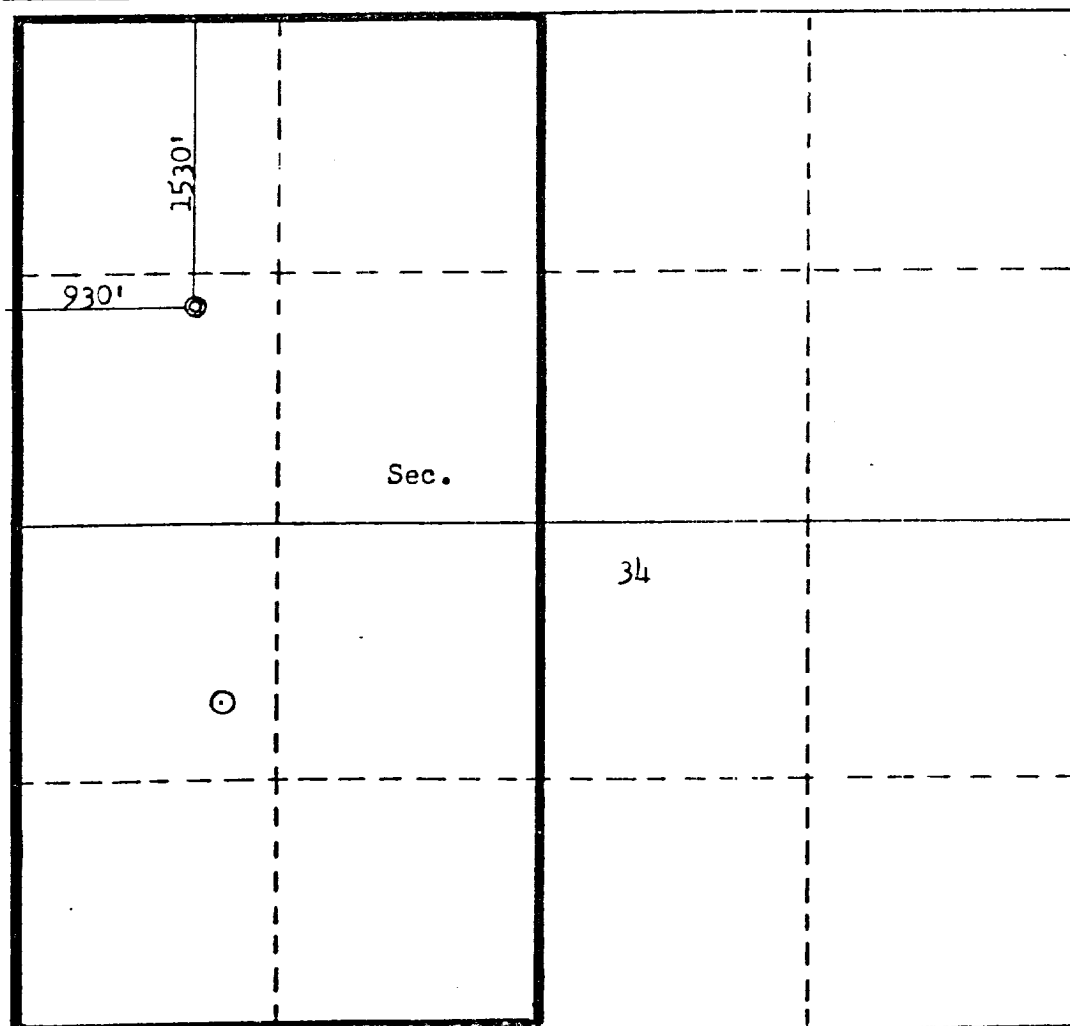

| | |
|---|--------------------|
| CERTIFICATION | |
| I hereby certify that the information contained herein is true and complete to the best of my knowledge and belief. | |
| <i>John Alexander</i> | |
| Name | JOHN ALEXANDER |
| Position | AGENT |
| Company | MESA PETROLEUM CO. |
| Date | November 28, 1979 |
| I hereby certify that the well location shown on this plat was plotted from field notes of actual surveys made by me or under my supervision, and that the same is true and correct to the best of my knowledge and belief. | |
| Date Surveyed | October 27, 1979 |
| Registered Professional Engineer and/or Land Surveyor 3950 | |
| <i>Fred B. ...</i> | |
| Certificate No. | 3950 |