



STATE OF NEW MEXICO  
**ENERGY AND MINERALS DEPARTMENT**  
OIL CONSERVATION DIVISION

December 28, 1984

TIDNEY ANAYA  
GOVERNOR

POST OFFICE BOX 2088  
STATE LAND OFFICE BUILDING  
SANTA FE, NEW MEXICO 87501  
(505) 827-5800

Dugan Production Corp.  
P. O. Box 208  
Farmington, New Mexico 87499

Attention: Sherman E. Dugan

Amended Administrative Order NSL-1840

Gentlemen:

Reference is made to your application on behalf of Pioneer Production Corp. for a non-standard location for their Redfern 5 Gas Com C Well No. 2 to be located 790 feet from the South line and 2500 feet from the West line of Section 9, Township 28 North, Range 11 West, NMPM, Otero Chacra Pool, San Juan County, New Mexico. County, New Mexico.

By authority granted me under the provisions of Rule 104 FI, the above-described unorthodox location is hereby approved.

Sincerely,

R. L. STAMETS, DIRECTOR

RLS/GPQ/dr

cc: ✓ Oil Conservation Division - Aztec  
Oil & Gas Engineering Committee - Hobbs  
Bureau of Land Management - Farmington

**RECEIVED**  
JAN 02 1985  
OIL CON. DIV.  
DIST. 2



STATE OF NEW MEXICO  
**ENERGY AND MINERALS DEPARTMENT**  
OIL CONSERVATION DIVISION

July 5, 1984

TONEY ANAYA  
GOVERNOR

POST OFFICE BOX 2088  
STATE LAND OFFICE BUILDING  
SANTA FE, NEW MEXICO 87501  
(505) 827-5800

8

Dugan Production Corp.  
P. O. Box 208  
Farmington, New Mexico 87499

Attention: Sherman E. Dugan

Administrative Order NSL-1840

Gentlemen:

Reference is made to your application on behalf of Pioneer Production Corp. for a non-standard location for their Redfern 5 Gas Com C Well No. 2 to be located 790 feet from the South line and 2500 feet from the West line of Section 9, Township 29 North, Range 11 West, NMPM, Otero Chacra Pool, San Juan County, New Mexico.

By authority granted me under the provisions of Rule 104 FI, the above-described unorthodox location is hereby approved.

Sincerely,

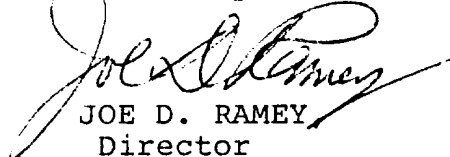
  
JOE D. RAMEY  
Director

JDR/RLS/dr

cc: Oil Conservation Division - Aztec  
Oil & Gas Engineering Committee - Hobbs  
Bureau of Land Management - Farmington

RECEIVED  
DEC 3 7 1984  
OIL CON. DIV.  
DIST. 3



STATE OF NEW MEXICO  
ENERGY AND MINERALS DEPARTMENT  
OIL CONSERVATION DIVISION  
AZTEC DISTRICT OFFICE

1000 RIO BRAZOS ROAD  
AZTEC, NEW MEXICO 87410  
(505) 334-6178

OIL CONSERVATION DIVISION  
BOX 2088  
SANTA FE, NEW MEXICO 87501

DATE 6-24-84

RE: Proposed MC \_\_\_\_\_  
Proposed DHC \_\_\_\_\_  
Proposed NSL X \_\_\_\_\_  
Proposed SWD \_\_\_\_\_  
Proposed WFX \_\_\_\_\_  
Proposed PMX \_\_\_\_\_

Gentlemen:

I have examined the application dated 6-5-31-84  
for the Dugan Production Corp. Redfern 5 Gas Com C#2 N-9-26N-11W  
Operator Lease and Well No. Unit, S-T-R

and my recommendations are as follows:

Approve:  
\_\_\_\_\_  
\_\_\_\_\_  
\_\_\_\_\_  
\_\_\_\_\_  
\_\_\_\_\_

Yours truly,

Tom Busch

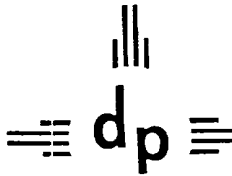

# dugan production corp.

May 29, 1984



Joe D. Ramey  
New Mexico Oil Conservation Division  
P O Box 2088  
Santa Fe, NM 87501

RE: Application for Administrative Approval of  
Unorthodox Location for Pioneer Production Corp.  
Redfern 5 Gas Com C #2, 790' FSL - 2500' FWL, Sec. 9, T28N, R11W, NMPM  
San Juan County, NM

Dear Mr. Ramey:

We hereby request approval of an unorthodox location for the subject well. Copies of the well location plat, topographic map, and a production map showing offsetting operators are attached for your reference.

The unorthodox location is necessary due to unconsolidated blow sand and sand dunes as well as a pipeline in the southwest part of Section 9.

A copy of this application is being submitted to all offsetting operators by certified mail with a request that they furnish your office with a waiver of objection.

We request your approval of this location under the provisions of NMOCD Rule 104-F.

Sincerely,

Sherman E. Dugan  
Agent

fp

cc: ✓ Frank Chavez, NMOCD, Aztec  
BLM, Farmington  
Southland Royalty Co.  
Union Texas Petroleum Corp.  
Pioneer Production Corp.

RECEIVED  
MAY 31 1984  
OIL CON. DIV.  
DIST. 3

WAIVER

\_\_\_\_\_ hereby waives objection to the above application  
for unorthodox location.

DATE \_\_\_\_\_

BY: \_\_\_\_\_

All distances must be from the center of the well to the Section

Name of <b>Pioneer Production Corporation</b>			Lease <b>Redfern 5 Gas Com C</b>		Well No. <b>2</b>
Grid Letter <b>N</b>	Section <b>9</b>	Township <b>28 North</b>	Range <b>11 West</b>	County <b>San Juan</b>	
Actual Well Location of Well:					
<b>790</b>	feet from the	<b>South</b>	line and	<b>2500</b>	feet from the <b>West</b> line
Ground Level Elev. <b>5540</b>	Producing Formation <b>Chacra</b>		Pool <b>Otero Chacra</b>	Dedicated Acreage: <b>special 130</b> Acres	

1. Outline the acreage dedicated to the subject well by colored pencil or hatchure marks on the plat below.
2. If more than one lease is dedicated to the well, outline each and identify the ownership thereof (both as to working interest and royalty).
3. If more than one lease of different ownership is dedicated to the well, have the interests of all owners been consolidated by communitization, unitization, force-pooling, etc?

☐ Yes ☐ No If answer is "yes," type of consolidation \_\_\_\_\_

If answer is "no," list the owners and tract descriptions which have actually been consolidated. (Use reverse side of this form if necessary.) \_\_\_\_\_

No allowable will be assigned to the well until all interests have been consolidated (by communitization, unitization, forced-pooling, or otherwise) or until a non-standard unit, eliminating such interests, has been approved by the Commission.

Application for Admin. Approval  
of Unorthodox Location for  
Pioneer Production Corp.  
Redfern 5 Gas Com C #2  
790' FSL 2500' FWL  
Sec. 9, T28N, R11W, NMPM  
San Juan County, NM

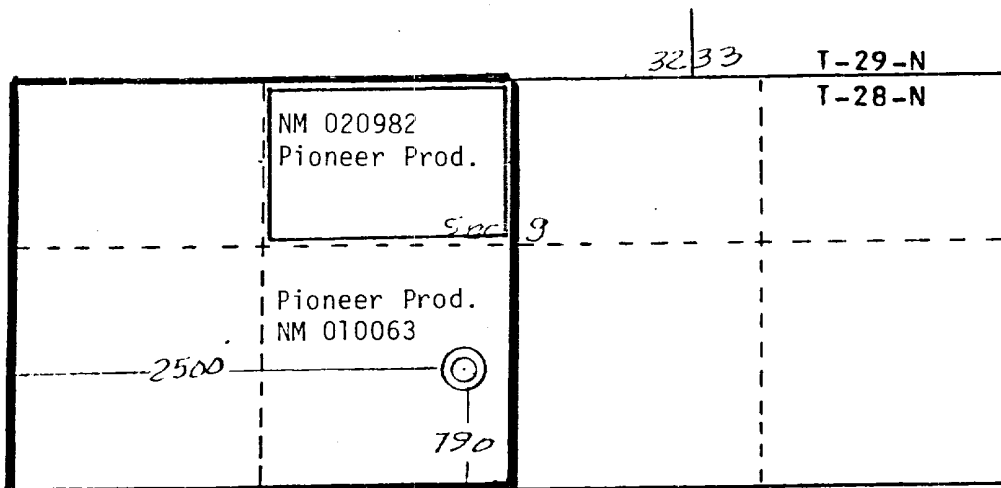

## CERTIFICATION

I hereby certify that the information contained herein is true and complete to the best of my knowledge and belief.

*Sherman E. Dugan*  
Name  
Sherman E. Dugan

Position  
Geologist

Company  
Dugan Production Corp.

Date  
5-22-84

I hereby certify that the location shown on this plat was obtained from field notes and is correct to the best of my knowledge and belief.

Date Surveyed

**April 19, 1984**

Registered Professional Engineer  
and/or Land Surveyor

*Edgar L. Risenhoover*  
Certificate No. **5979**

**Edgar L. Risenhoover, L.S.**



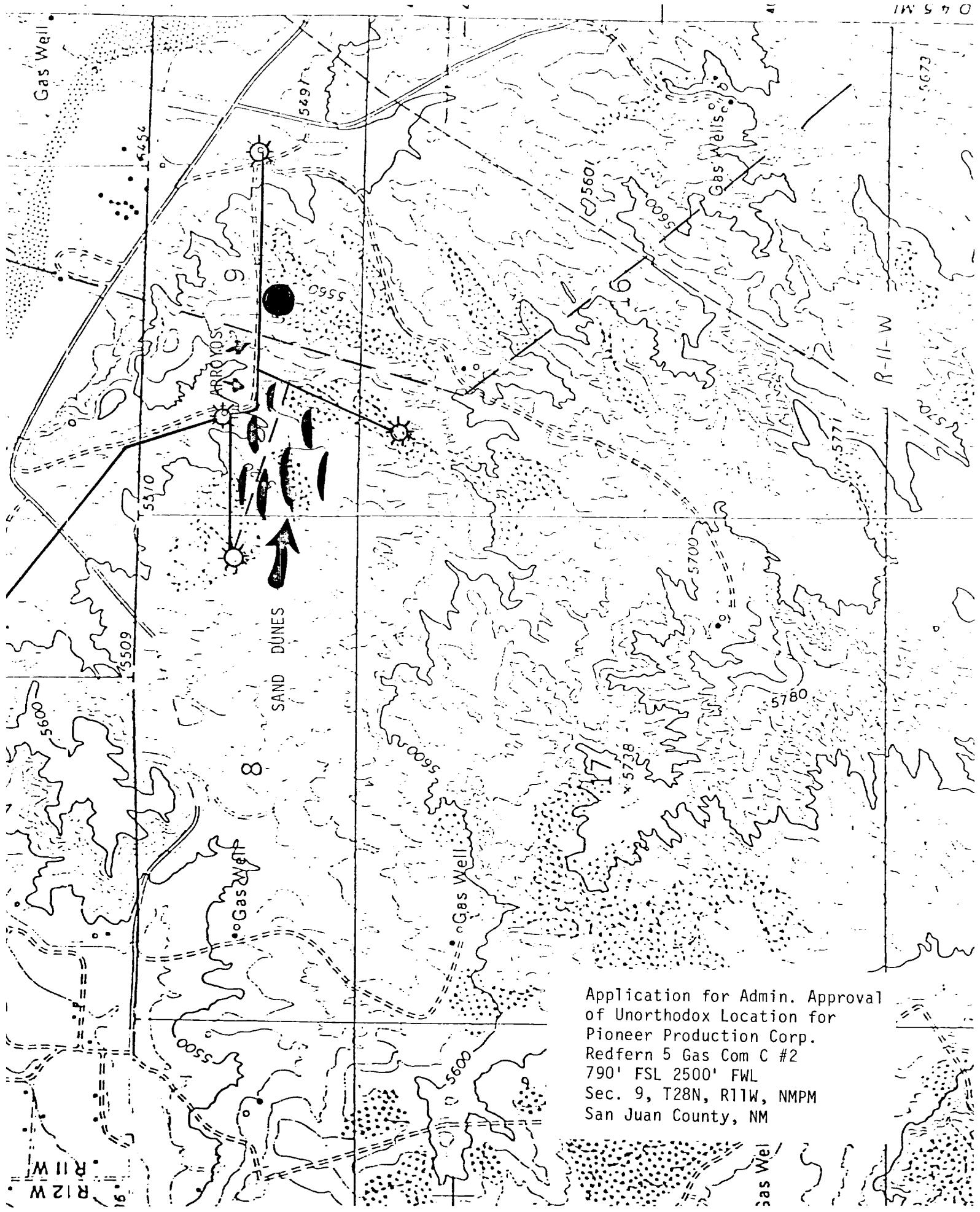

Application for Admin. Approval  
of Unorthodox Location for  
Pioneer Production Corp.  
Redfern 5 Gas Com C #2  
790' FSL 2500' FWL  
Sec. 9, T28N, R11W, NMPM  
San Juan County, NM



(Not drawn to scale)

Application for Admin. Approval  
of Unorthodox Location for  
Pioneer Production Corp.  
Redfern 5 Gas Com C #2  
790' FSL 2500' FWL  
Sec. 9. T28N. R11W. NMPM

