

24

50 YEARS



1935 - 1985

POST OFFICE BOX 2088
STATE LAND OFFICE BUILDING
SANTA FE, NEW MEXICO 87501
(505) 827-5800



TONEY ANAYA
GOVERNOR

STATE OF NEW MEXICO
ENERGY AND MINERALS DEPARTMENT
OIL CONSERVATION DIVISION

August 5, 1985

El Paso Exploration Company
P. O. Box 4289
Farmington, New Mexico 87499-4289

Attention: G. W. Brink

Administrative Order NSL-2103

Gentlemen:

Reference is made to your application for a non-standard location for your Lackey Well No. 1A to be located 2540 feet from the North line and 1190 feet from the West line of Section 26, Township 28 North, Range 9 West, NMPM, Blanco Mesaverde Pool, San Juan County, New Mexico. The W/2 of said Section 26 shall be dedicated to the well.

By authority granted me under the provisions of Rule 104 F(I), the above-described unorthodox location is hereby approved.

Sincerely

R. L. STAMETS, DIRECTOR

RLS/DC/dr

cc: Oil Conservation Division - Aztec
Bureau of Land Management - Farmington

RECEIVED

AUG 14 1985

OIL CON. DIV.
DIST. 3



ENERGY AND MINERALS DEPARTMENT

OIL CONSERVATION DIVISION
AZTEC DISTRICT OFFICE

1000 RIO BRAZOS ROAD
AZTEC, NEW MEXICO 87410
(505) 334-6178

OIL CONSERVATION DIVISION
BOX 2088
SANTA FE, NEW MEXICO 87501

DATE 7-25-85

RE: Proposed MC _____
Proposed DHC _____
Proposed NSL X _____
Proposed SWD _____
Proposed WFX _____
Proposed PMX _____

Gentlemen:

I have examined the application dated 7-16-85
for the El Paso Natural Gas Co. Lackey #1A E-26-28N-9W
Operator Lease and Well No. Unit, S-T-R

and my recommendations are as follows:

Approve =

Yours truly,

E. B. Bland



P. O. BOX 4289
FARMINGTON, NEW MEXICO 87499-4289
PHONE: 505-325-2841

July 12, 1985

Mr. Richard Stamets
New Mexico Oil Conservation Division
Post Office Box 2088
Santa Fe, New Mexico 87501

Dear Mr. Stamets:

This is a request for administrative approval for an unorthodox gas well location in the Blanco Mesa Verde Pool.

It is intended to locate the El Paso Natural Gas Company's Lackey #1A at 2540' from the North line and 1190' from the West line of Section 26, T-28-N, R-9-W, San Juan County, New Mexico.

Extremely rough terrain in the form of steep cliffs makes it impossible to build an orthodox location in the southwest corner of Section 26.

El Paso Natural Gas Company operates all proration units offsetting the proposed unorthodox location.

Plats showing the proposed well location and the terrain in Section 26, along with an ownership plat, are attached.

Sincerely yours,

A handwritten signature in dark ink, appearing to read "G. W. Brink", written over the typed name.

G. W. Brink
Project Drilling Engineer

encl.

RECEIVED

JUL 16 1985

OIL CON. DIV.
DIST. 3

EL PASO NATURAL GAS COMPANY

Well Name Lackey #1A, Blanco Mesaverde

Footage----- 2540' FNL, 1190' FWL

APPLICATION FOR NON-STANDARD LOCATION

County San Juan State New Mexico Section 26 Township 28N Range 9W

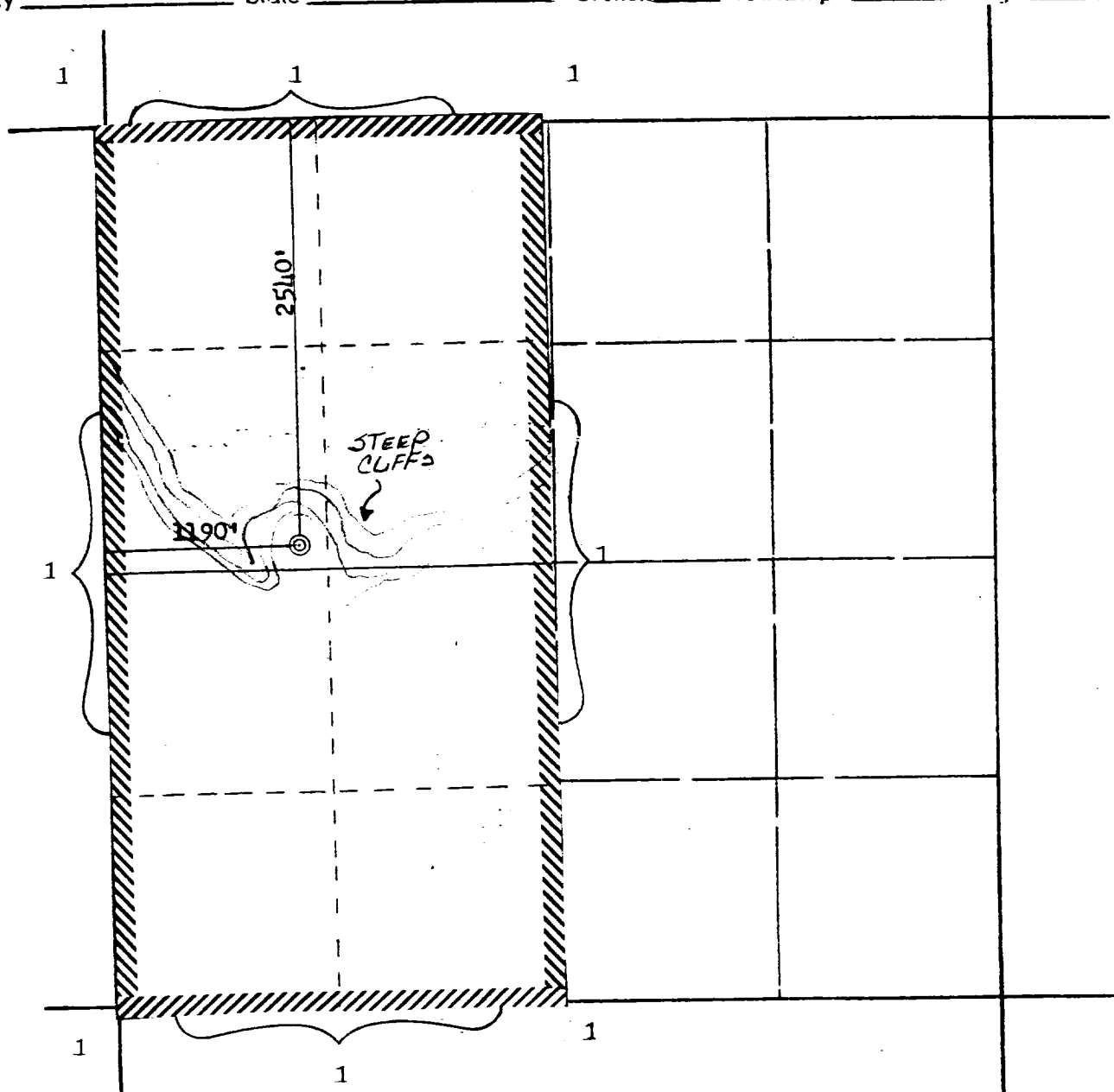

REMARKS:

(1) El Paso Natural Gas Company - Operator

RECEIVED

JUL 16 1985

OIL CON. DIV.
DIST. 3

(14)

NEW MEXICO OIL CONSERVATION COMMISSION
WELL LOCATION AND ACREAGE DEDICATION PLAT

Form C-102
Supersedes C-128
Effective 1-1-65

All distances must be from the outer boundaries of the Section.

Operator EL PASO NATURAL GAS COMPANY			Lease LACKEY (SF 077111)		Well No. 1A
Unit Letter E	Section 26	Township 28N	Range 9W	County San Juan	
Actual Footage Location of Well: 2540 feet from the North line and 1190 feet from the West line					
Ground Level Elev: 6184	Producing Formation Mesa Verde		Pool Blanco	Dedicated Acreage: 320 Acres	

1. Outline the acreage dedicated to the subject well by colored pencil or hachure marks on the plat below.
2. If more than one lease is dedicated to the well, outline each and identify the ownership thereof (both as to working interest and royalty).
3. If more than one lease of different ownership is dedicated to the well, have the interests of all owners been consolidated by communitization, unitization, force-pooling, etc?

☐ Yes ☐ No If answer is "yes," type of consolidation _____

If answer is "no," list the owners and tract descriptions which have actually been consolidated. (Use reverse side of this form if necessary.) _____

No allowable will be assigned to the well until all interests have been consolidated (by communitization, unitization, forced-pooling, or otherwise) or until a non-standard unit, eliminating such interests, has been approved by the Commission.

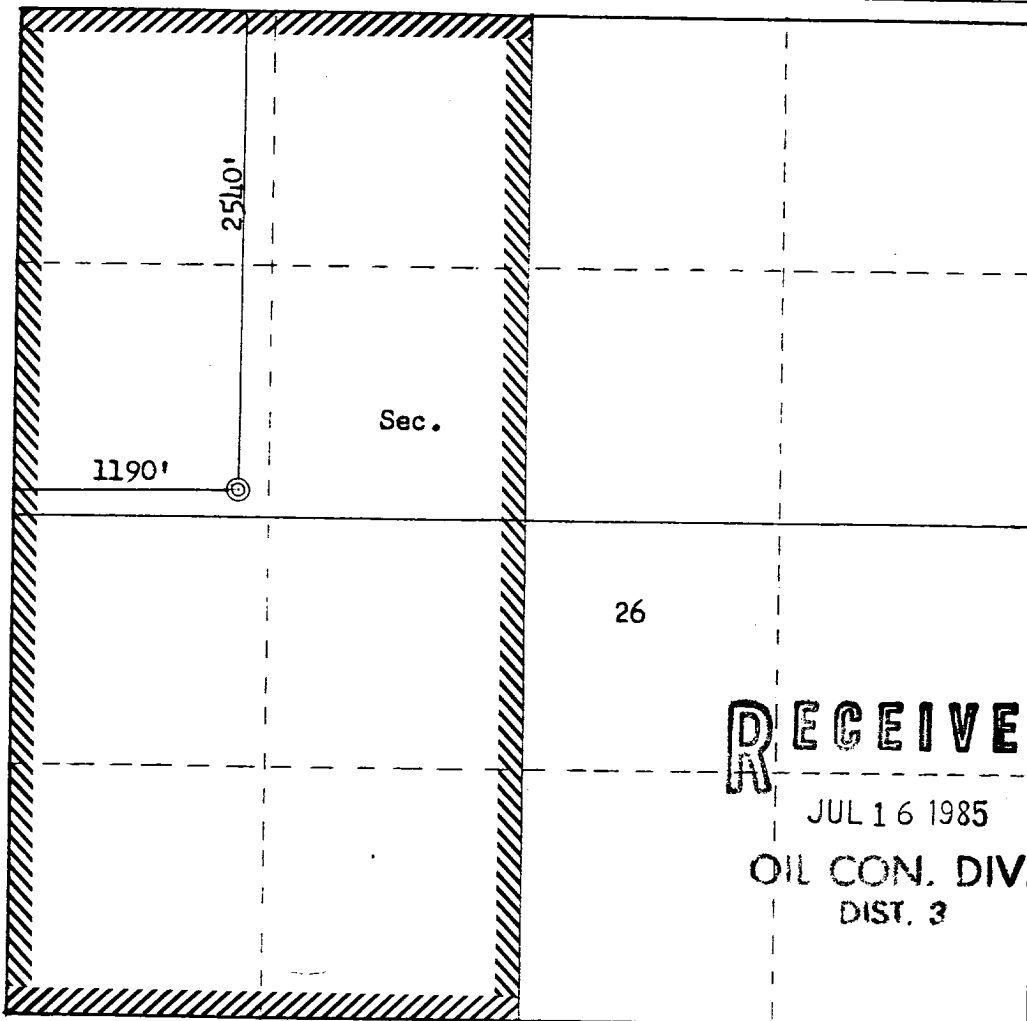

Scale: 1"=1000'

CERTIFICATION

I hereby certify that the information contained herein is true and complete to the best of my knowledge and belief.

Name
Drilling Clerk
Position
El Paso Natural Gas
Company

Date

I hereby certify that the well location shown on this plat was plotted from field notes of actual surveys made by me or under my supervision, and that the same is true and correct to the best of my knowledge and belief.

Date Surveyed
July 1, 1985
Registered Professional Engineer
and Land Surveyor

Fred B. Kerr Jr.

Certificate No. **3950**

RECEIVED
JUL 16 1985
OIL CON. DIV.
DIST. 3