

(SUBMIT IN TRIPLICATE)

UNITED STATES
DEPARTMENT OF THE INTERIOR
GEOLOGICAL SURVEYBudget Bureau No. 42-R358.4.
Approval expires 12-31-60.

Santa Fe

Land Office

SF-080044

Lease No.

Gallegos Canyon Unit

Unit

SUNDRY NOTICES AND REPORTS ON WELLS

NOTICE OF INTENTION TO DRILL	<input checked="" type="checkbox"/>	SUBSEQUENT REPORT OF WATER SHUT-OFF	<input type="checkbox"/>
NOTICE OF INTENTION TO CHANGE PLANS	<input type="checkbox"/>	SUBSEQUENT REPORT OF SHOOTING OR ACIDIZING	<input type="checkbox"/>
NOTICE OF INTENTION TO TEST WATER SHUT-OFF	<input type="checkbox"/>	SUBSEQUENT REPORT OF ALTERING CASING	<input type="checkbox"/>
NOTICE OF INTENTION TO RE-DRILL OR REPAIR WELL	<input type="checkbox"/>	SUBSEQUENT REPORT OF RE-DRILLING OR REPAIR	<input type="checkbox"/>
NOTICE OF INTENTION TO SHOOT OR ACIDIZE	<input type="checkbox"/>	SUBSEQUENT REPORT OF ABANDONMENT	<input type="checkbox"/>
NOTICE OF INTENTION TO PULL OR ALTER CASING	<input type="checkbox"/>	SUPPLEMENTARY WELL HISTORY	<input type="checkbox"/>
NOTICE OF INTENTION TO ABANDON WELL	<input type="checkbox"/>		

(INDICATE ABOVE BY CHECK MARK NATURE OF REPORT, NOTICE, OR OTHER DATA)

Gallegos Canyon Unit

Farmington, New Mexico April 11, 1961

Well No. 95 is located 1850 ft. from N line and 1550 ft. from E line of sec. 31
NE 1/4 SW 1/4 of Section 31 T-28-N R-11-W N.M.F.M.
(1/4 Sec. and Sec. No.) (Twp.) (Range) (Meridian)
Basin Dakota San Juan New Mexico
(Field) (County or Subdivision) (State or Territory)

The elevation of the derrick floor above sea level is _____ ft. (to be reported later)

DETAILS OF WORK

(State names of and expected depths to objective sands; show sizes, weights, and lengths of proposed casings; indicate mudding jobs, cementing points, and all other important proposed work)

We propose to drill the above well to approximately 6600' to test and develop productive Dakota Zone. Stimulation will be as indicated upon penetration of Dakota pay. Rotary tools will be used to total depth. Casing program as follows:

SIZE	DEPTH	CEMENT	REMARKS
8-5/8"	350'	250	Test circulate
4-1/2"	6600'	575	2 stage - first stage 275 sacks 6% gel with 1-1/2 pounds tuf plug per sack, 100 sacks neat. Second stage 150 sacks 6% gel cement.

Stage collar set 100' below base of Pictured Cliffs. Copies of location plat attached. A copy of any survey taken will be submitted upon completion of well.

I understand that this plan of work must receive approval in writing by the Geological Survey before operations may be commenced.

Company Pan American Petroleum CorporationAddress Box 480Farmington, New MexicoAttn: L. O. Speer, Jr.

ORIGINAL SIGNED BY

R. M. Bauer, Jr.

By

Title Senior Petroleum Engineer

Well Location and Acreage Dedication Plat

Section A.

Date March 23, 1961

Operator PAN AMERICAN PETROLEUM CORPORATION Lease GALLEGOS CANYON UNIT
 Well No. 95 Unit Letter K Section 31 Township 28 NORTH Range 11 WEST, NMPM
 Located 1850 Feet From the SOUTH Line, 1550 Feet From the WEST Line
 County SAN JUAN G. L. Elevation To report later Dedicated Acreage 317.39 Acres
 Name of Producing Formation Dakota Pool Basin Dakota

1. Is the Operator the only owner in the dedicated acreage outlined on the plat below?
 Yes ☐ No ☒ X
2. If the answer to question one is "no", have the interests of all the owners been consolidated by communitization agreement or otherwise? Yes ☒ X No ☐ If answer is "yes", Type of Consolidation: Gallegos Canyon Unit acreage.
3. If the answer to question two is "no", list all the owners and their respective interests below:

Owner

Land Description

Section B.

This is to certify that the information in Section A above is true and complete to the best of my knowledge and belief.

Pan American Petroleum Corporation

(Operator)

R. M. Bauer, Jr. *RMB*

(Representative)

Box 480, Farmington, New Mexico

(Address)

Ref: GLO plat dated 19 July 1915

Note: All distances must be from outer boundaries of section.

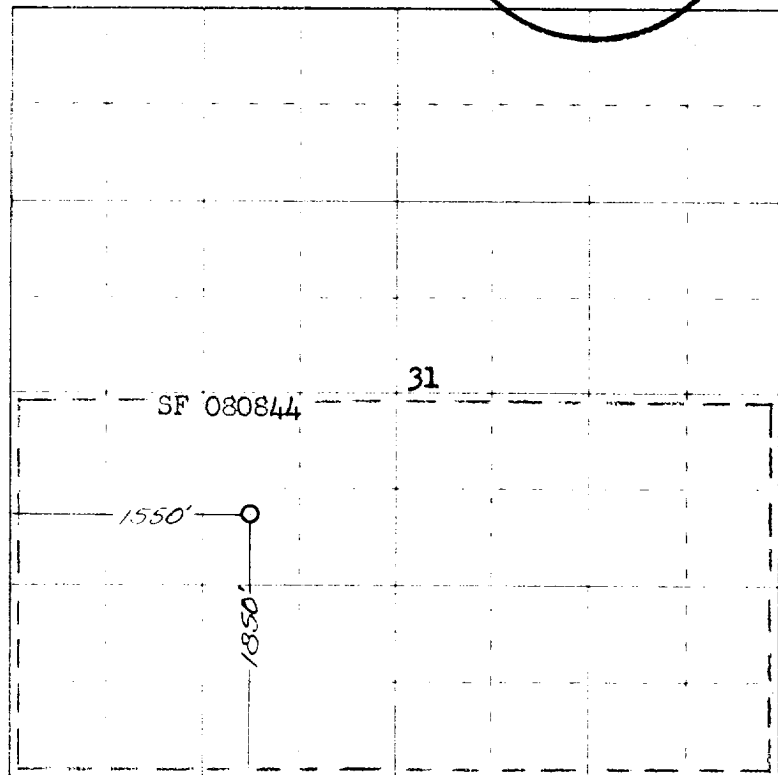

0 330 660 990 1320 1650 1980 2310 2640 2000 1500 1000 500 0

Scale 4 inches equal 1 mile

This is to certify that the above plat was prepared from field notes of actual surveys made by me or under my supervision and that the same are true and correct to the best of my knowledge and belief.

Date Surveyed 21 March 1961

James P. Lease
 Registered Professional Engineer and/or Land Surveyor
 James P. Lease N. Mex. Reg. No. 1463
 San Juan Engineering Company

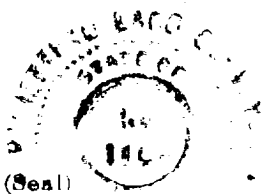

Farmington, New Mexico