

(SUBMIT IN TRIPLICATE)

UNITED STATES  
DEPARTMENT OF THE INTERIOR  
GEOLOGICAL SURVEY

Land Office Santa Fe  
Lease No. 078903  
Unit Gallegos Canyon Unit

SUNDRY NOTICES AND REPORTS ON WELLS

NOTICE OF INTENTION TO DRILL	<input checked="" type="checkbox"/>	SUBSEQUENT REPORT OF WATER SHUT-OFF	<input type="checkbox"/>
NOTICE OF INTENTION TO CHANGE PLANS	<input type="checkbox"/>	SUBSEQUENT REPORT OF SHOOTING OR ACIDIZING	<input type="checkbox"/>
NOTICE OF INTENTION TO TEST WATER SHUT-OFF	<input type="checkbox"/>	SUBSEQUENT REPORT OF ALTERING CASING	<input type="checkbox"/>
NOTICE OF INTENTION TO RE-DRILL OR REPAIR WELL	<input type="checkbox"/>	SUBSEQUENT REPORT OF REDRILLING OR REPAIR	<input type="checkbox"/>
NOTICE OF INTENTION TO SHOOT OR ACIDIZE	<input type="checkbox"/>	SUBSEQUENT REPORT OF ABANDONMENT	<input type="checkbox"/>
NOTICE OF INTENTION TO PULL OR ALTER CASING	<input type="checkbox"/>	SUPPLEMENTARY WELL HISTORY	<input type="checkbox"/>
NOTICE OF INTENTION TO ABANDON WELL	<input type="checkbox"/>		

FEB 19 1954  
U. S. GEOLOGICAL SURVEY  
FARMINGTON, N. M.

(INDICATE ABOVE BY CHECK MARK NATURE OF REPORT, NOTICE, OR OTHER DATA)

February 19, 1954

Well No. 54 is located 990 ft. from N line and 1650 ft. from E line of sec. 36  
SW/4 SE/4 Sec. 36 28N 12W N.M.P.M.  
(1/4 Sec. and Sec. No.) (Twp.) (Range) (Meridian)  
West Kuts San Juan New Mexico  
(Field) (County or Subdivision) (State or Territory)

The elevation of the derrick floor above sea level is 6054 ft.

DETAILS OF WORK

(State names of and expected depths to objective sands; show sizes, weights, and lengths of proposed casings; indicate mudding jobs, cementing points, and all other important proposed work)

Pictured Cliffs Sand test. Estimated depth 1800'.

Surface Casing: 80' of 8-5/8" OD 24# cemented with 75 sacks.

Production Casings: Approximately 1750' of 5-1/2" OD 14# J-55 cemented with 100 sacks.

If commercial production is indicated, the producing section will be shot with nitroglycerin.

I understand that this plan of work must receive approval in writing by the Geological Survey before operations may be commenced.

Company BENSON-MONTIN

Address 315 1/2 West Main

Farmington, New Mexico

By

*Al R. Lee*

Title Field Superintendent



Company Benson-Montin

Lease 078903 Well No. 1

Sec. 36 T. 28 N., R. 12 W., N.M.P.M.

Location 990' from the South line and 1650' from  
the East line.

San Juan County

New Mexico

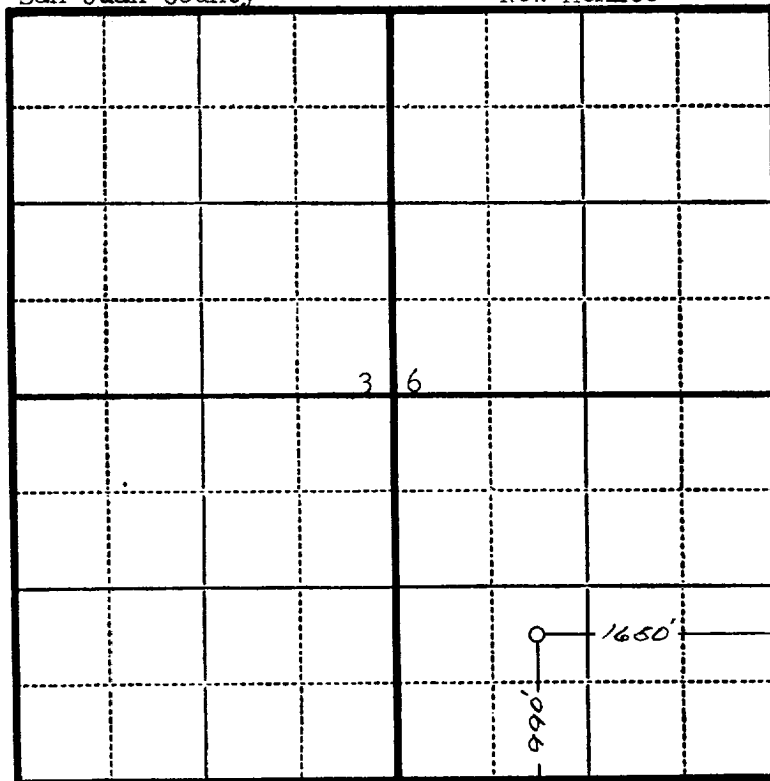

Scale—4 inches equals 1 mile.

This is to certify that the above plat was prepared from field notes of actual surveys made by me or under my supervision and that the same are true and correct to the best of my knowledge and belief.

*Charles J. Finklea*

Seal:

Registered Professional  
Engineer and Land Surveyor.

Charles J. Finklea  
N. Mex. Reg. No. 1302

Surveyed April 10, 1952

RECEIVED  
FEB 19 1954  
U. S. GEOLOGICAL SURVEY  
FARMINGTON, N. M.

