

(SUBMIT IN TRIPLICATE)

UNITED STATES
DEPARTMENT OF THE INTERIOR
GEOLOGICAL SURVEY

Indian Agency _____

Revojo _____

Allottee _____

Lease No. _____

SUNDRY NOTICES AND REPORTS ON WELLS

NOTICE OF INTENTION TO DRILL _____	<input checked="" type="checkbox"/>	SUBSEQUENT REPORT OF WATER SHUT-OFF _____	
NOTICE OF INTENTION TO CHANGE PLANS _____		SUBSEQUENT REPORT OF SHOOTING OR ACIDIZING _____	
NOTICE OF INTENTION TO TEST WATER SHUT-OFF _____		SUBSEQUENT REPORT OF ALTERING CASING _____	
NOTICE OF INTENTION TO REDRILL OR REPAIR WELL _____		SUBSEQUENT REPORT OF REDRILLING OR REPAIR _____	
NOTICE OF INTENTION TO SHOOT OR ACIDIZE _____		SUBSEQUENT REPORT OF ABANDONMENT _____	
NOTICE OF INTENTION TO PULL OR ALTER CASING _____		SUPPLEMENTARY WELL HISTORY _____	
NOTICE OF INTENTION TO ABANDON WELL _____			

(INDICATE ABOVE BY CHECK MARK NATURE OF REPORT, NOTICE, OR OTHER DATA)

April 21, 1955

Well No. No. 7.1.1 is located 357 ft. from N line and 2407 ft. from E line of sec. 36

11.1 (1/4 Sec. and Sec. No.) 1.1 (Twp.) 17 (Range) 11.1 (Meridian)
Illinois (Field) San Juan (County or Subdivision) New Mexico (State or Territory)

The elevation of the derrick floor above sea level is 5358 ft.

DETAILS OF WORK

(State names of and expected depths to objective sands; show sizes, weights, and lengths of proposed casings; indicate mudding jobs, cementing points, and all other important proposed work)

7 x 4 1/2 inch hole through the Dakota. (1500')

ILLEGIBLE



I understand that this plan of work must receive approval in writing by the Geological Survey before operations may be commenced.

Company Continental Oil Corp.

Address Box 1000
Fort Worth, Tex.

By W. L. Durr

Title Geologist Supervisor

COMPANY Continental Oil Company

Well Name & No. North Table Mesa #3

Lease No. _____

Location 857' from the North line and 2407' from the North line.

Being in NW 1/4 SE 1/4

Sec. 34, T. 28 N., R. 17 W., N.M.P.M., San Juan County, New Mexico

Ground Elevation 5353, ~~un~~graded

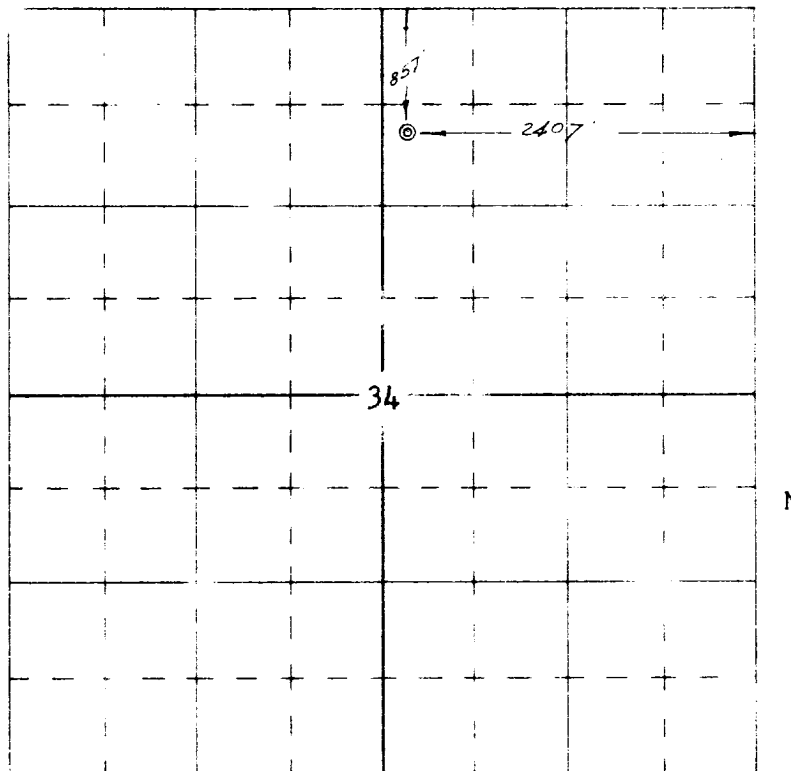

Scale -- 4 inches equals 1 mile

Surveyed April 26, 1955

This is to certify that the above plat was prepared from field notes of actual surveys made by me or under my supervision and that the same are true and correct to the best of my knowledge and belief.

Ernest V. Echohawk

Ernest V. Echohawk
Registered Land Surveyor
N. M. Reg. #1545

