

P. O. Box 965  
Farmington, New Mexico

July 25, 1956

R & G Drilling Company, Inc.  
P. O. Box 1848  
Farmington, New Mexico

RE: Santa Fe 078673

Gentlemen:

Receipt is acknowledged of your "Notice of Intention to Drill" dated July 25, 1956 covering your well No. 24 R & G in SE $\frac{1}{4}$  SW $\frac{1}{4}$  sec. 27, T. 28 N., R. 11 W., N. M. P. M., San Juan County, New Mexico, West Kutz ext. pool.

Your proposed work is hereby approved subject to compliance with the provisions of the "Oil and Gas Operating Regulations" revised May 25, 1942, a copy of which will be sent to you on request, and subject to the following conditions:

1. Drilling operations so authorized are subject to the attached sheet for general conditions of approval.
2. Furnish copies of all logs.

Very truly yours,

P. T. McGrath  
District Engineer

PTMcGrath:al



COPY TO O. C. C.

2000 10 10 10  
2000 10 10 10

2000 10 10 10

2000 10 10 10  
2000 10 10 10  
2000 10 10 10

2000 10 10 10

2000 10 10 10

2000 10 10 10  
2000 10 10 10  
2000 10 10 10  
2000 10 10 10  
2000 10 10 10

2000 10 10 10  
2000 10 10 10  
2000 10 10 10  
2000 10 10 10  
2000 10 10 10

2000 10 10 10  
2000 10 10 10  
2000 10 10 10

2000 10 10 10

2000 10 10 10

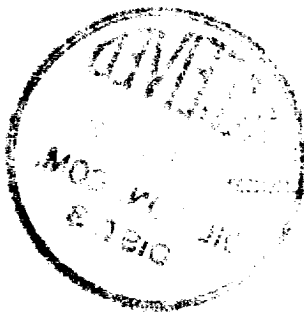

2000 10 10 10

2000 10 10 10

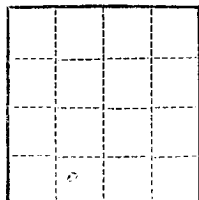

(SUBMIT IN TRIPLICATE)

UNITED STATES  
DEPARTMENT OF THE INTERIOR  
GEOLOGICAL SURVEY

Land Office Santa Fe  
Lease No. 078673  
Unit \_\_\_\_\_

SUNDRY NOTICES AND REPORTS ON WELLS

NOTICE OF INTENTION TO DRILL.....	<input checked="" type="checkbox"/>	SUBSEQUENT REPORT OF WATER SHUT-OFF.....
NOTICE OF INTENTION TO CHANGE PLANS.....		SUBSEQUENT REPORT OF SHOOTING OR ACIDIZING.....
NOTICE OF INTENTION TO TEST WATER SHUT-OFF.....		SUBSEQUENT REPORT OF ALTERING CASING.....
NOTICE OF INTENTION TO RE-DRILL OR REPAIR WELL.....		SUBSEQUENT REPORT OF RE-DRILLING OR REPAIR.....
NOTICE OF INTENTION TO SHOOT OR ACIDIZE.....		SUBSEQUENT REPORT OF ABANDONMENT.....
NOTICE OF INTENTION TO PULL OR ALTER CASING.....		SUPPLEMENTARY WELL HISTORY.....
NOTICE OF INTENTION TO ABANDON WELL.....		

(INDICATE ABOVE BY CHECK MARK NATURE OF REPORT, NOTICE, OR OTHER DATA)

July 25, 1956

Well No. 840 #24 is located 865 ft. from N line and 1710 ft. from E line of sec. 27  
SE 1/4 Sec. 27 28E 11W R.M.P.M.  
 (1/4 Sec. and Sec. No.) (Twp.) (Range) (Meridian)  
New Mexico San Juan New Mexico  
 (Field) (County or Subdivision) (State or Territory)

The elevation of the derrick floor above sea level is 5669 ft.

DETAILS OF WORK

(State names of and expected depths to objective sands; show sizes, weights, and lengths of proposed casings; indicate mudding jobs, cementing points, and all other important proposed work)

Plan to drill to Pictured Cliffs with Rotary tools - 1700 ft.  
 100 ft. - 8 5/8" casing with 50 sacks.  
 1700 ft - 5 1/2" casing with 100 sacks.

I understand that this plan of work must receive approval in writing by the Geological Survey before operations may be commenced.

Company R. & G. DRILLING COMPANY, INC.  
 Address P. O. Box 1848  
Farmington, New Mexico  
 By William C. Russell  
 Title President

NEW MEXICO  
OIL CONSERVATION COMMISSION

Form C-128

Well Location and/or Gas Proration Plat

Date July 25, 1956

Operator R & G Drilling Company

Lease Santa Fe 078673

Well No. 440 #24 Section 27 Township 28 North Range 11 West NMPM

Located 865 Feet From South Line, 1710 Feet From West Line,

San Juan

County, New Mexico. G. L. Elevation 5663.2

Name of Producing Formation \_\_\_\_\_ Pool \_\_\_\_\_ Dedicated Acreage 160

(Note: All distances must be from outer boundaries of Section)

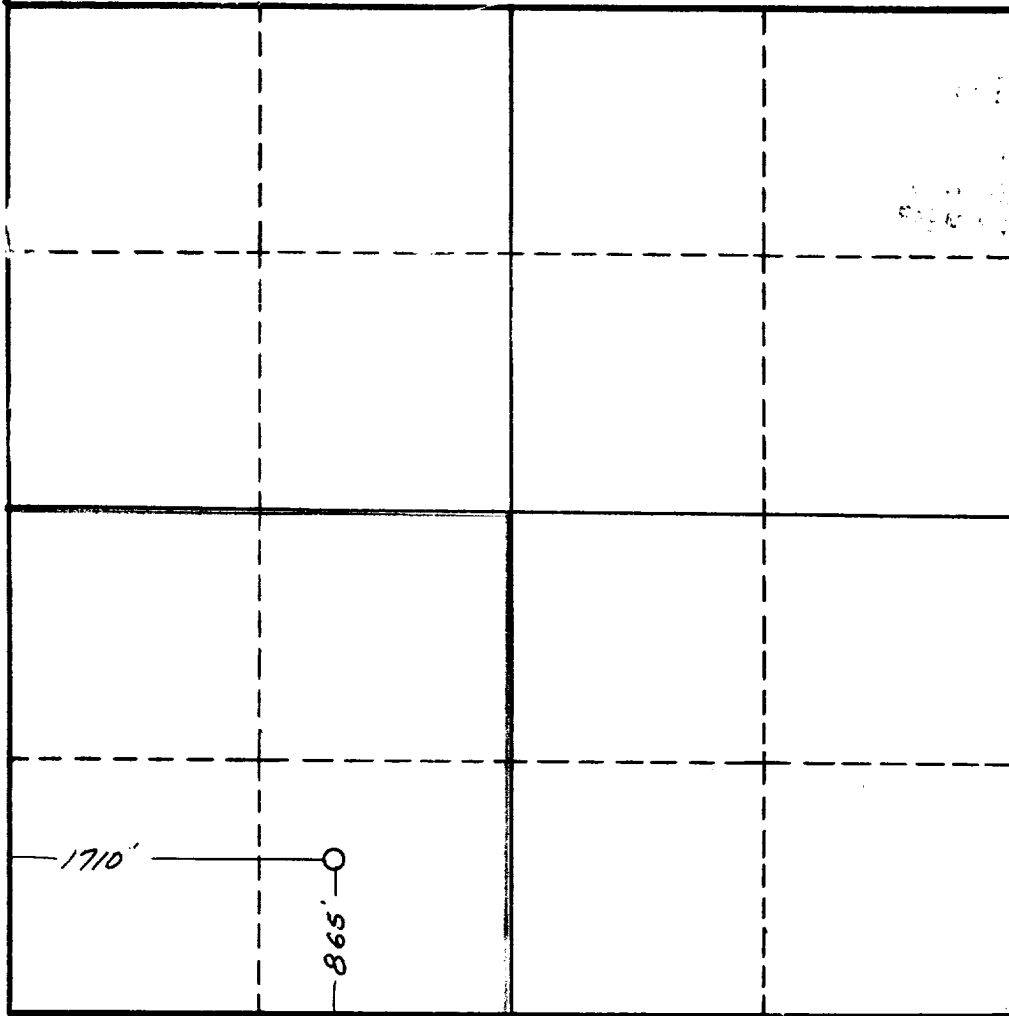

NOTE

This section of  
form is to be  
used for gas  
wells only.



SCALE: 1"=1000'

1. Is this Well a Dual Comp. ? Yes      No X
2. If the answer to Question 1 is yes, are there any other dually completed wells within the dedicated acreage ? Yes      No

Name William C. Russell  
Position President  
Representing R & G DRILLING COMPANY, INC.  
Address Box 1848, Farmington, N.M.

This is to certify that the above plat was prepared from field notes of actual surveys made by me or under my supervision and that the same are true and correct to the best of my knowledge and belief.

Date Surveyed July 19, 1956

James P. Leese  
Registered Professional Engineer and/or  
Land Surveyor James P. Leese  
Reg. No 1463 New Mexico.