

(SUBMIT IN TRIPLICATE)

UNITED STATES  
DEPARTMENT OF THE INTERIOR  
GEOLOGICAL SURVEY

Budget Bureau No. 42-R358.4.  
Form Approved.

Land Office **Santa Fe**

Lease No. **NM 0309371**

Unit \_\_\_\_\_

SUNDRY NOTICES AND REPORTS ON WELLS

NOTICE OF INTENTION TO DRILL	<input checked="" type="checkbox"/>	SUBSEQUENT REPORT OF WATER SHUT-OFF	
NOTICE OF INTENTION TO CHANGE PLANS		SUBSEQUENT REPORT OF SHOOTING OR ACIDIZING	
NOTICE OF INTENTION TO TEST WATER SHUT-OFF		SUBSEQUENT REPORT OF ALTERING CASING	
NOTICE OF INTENTION TO RE-DRILL OR REPAIR WELL		SUBSEQUENT REPORT OF RE-DRILLING OR REPAIR	
NOTICE OF INTENTION TO SHOOT OR ACIDIZE		SUBSEQUENT REPORT OF ABANDONMENT	
NOTICE OF INTENTION TO PULL OR ALTER CASING		SUPPLEMENTARY WELL HISTORY	
NOTICE OF INTENTION TO ABANDON WELL			

(INDICATE ABOVE BY CHECK MARK NATURE OF REPORT, NOTICE, OR OTHER DATA)

**May 20**, 19**61**

**USA Scott**

Well No. **1** is located **1850** ft. from **[N]** line and **1650** ft. from **[W]** line of sec. **28**

**N<sup>1</sup>/<sub>4</sub> Section 28**

(<sup>1</sup>/<sub>4</sub> Sec. and Sec. No.)

**28 N**

(Twp.)

**13 W**

(Range)

**N.M.P.M.**

(Meridian)

**Basin Dakota**

(Field)

**San Juan**

(County or Subdivision)

**New Mexico**

(State or Territory)

**ground level**

The elevation of the ~~center of well~~ above sea level is **6000** ft.

DETAILS OF WORK

(State names of and expected depths to objective sands; show sizes, weights, and lengths of proposed casings; indicate mudding jobs, cementing points, and all other important proposed work)

1. Drill 12-1/4" hole to 250'.
2. Run and cement 250' 8-5/8" OD, 2 1/2" casing. Circulate cement to surface.
3. Drill 7-7/8" hole to TD (approximately 6936').
4. Cut maximum of two 50' cores in Gallup zone.
5. If well indicates commercial production, run and cement 5-1/2" OD, 1 1/2" casing to TD. Cement with sufficient volume to cover 300' above top of Gallup.

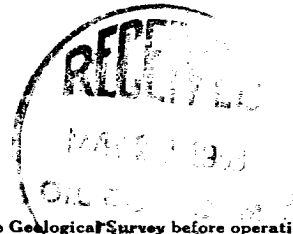

(OVER)

I understand that this plan of work must receive approval in writing by the Geological Survey before operations may be commenced.

Company **Tennessee Oil Company**

Address **P. O. Box 1714**

**Durango, Colorado**

By **J. J. Lacey**

Title **Sr. Petroleum Engineer**

6. If Gallup score indicates commercial production, dual completion will be attempted.
7. Perforate and stimulate productive zones
8. Clean up location.

NUMBER OF COPIES RECEIVED	
DISTRIBUTION	
SANTA FE	
FILE	
U.S.G.S.	
LAND OFFICE	
TRANSPORTER	OIL GAS
PRORATOR OFFICE	
OPERATOR	

**NEW MEXICO OIL CONSERVATION COMMISSION**  
**WELL LOCATION AND ACREAGE DEDICATION PLAT**  
 SEE INSTRUCTIONS FOR COMPLETING THIS FORM ON THE REVERSE SIDE

FORM C-128  
 Revised 5/1/57

**SECTION A**

Operator <b>TEHUACO OIL COMPANY</b>			Lease <b>USA Scott</b>		Well No. <b>1</b>
Unit Letter <b>F</b>	Section <b>28</b>	Township <b>28 North</b>	Range <b>13 West</b>	County <b>San Juan</b>	
Actual Footage Location of Well: <b>1850</b> feet from the <b>North</b> line and <b>1650</b> feet from the <b>West</b> line					
Ground Level Elev. <b>6000' ungraded</b>	Producing Formation <b>Dakota</b>	Pool <b>Basin Dakota</b>	Dedicated Acreage: <b>320</b> Acres		

1. Is the Operator the only owner in the dedicated acreage outlined on the plat below? YES ☒ NO \_\_\_\_ . ("Owner" means the person who has the right to drill into and to produce from any pool and to appropriate the production either for himself or for himself and another. (65-3-29 (e) NMSA 1935 Comp.)
2. If the answer to question one is "no," have the interests of all the owners been consolidated by communitization agreement or otherwise? YES \_\_\_\_ NO \_\_\_\_ . If answer is "yes," Type of Consolidation \_\_\_\_
3. If the answer to question two is "no," list all the owners and their respective interests below:

Owner	Land Description

**SECTION B**

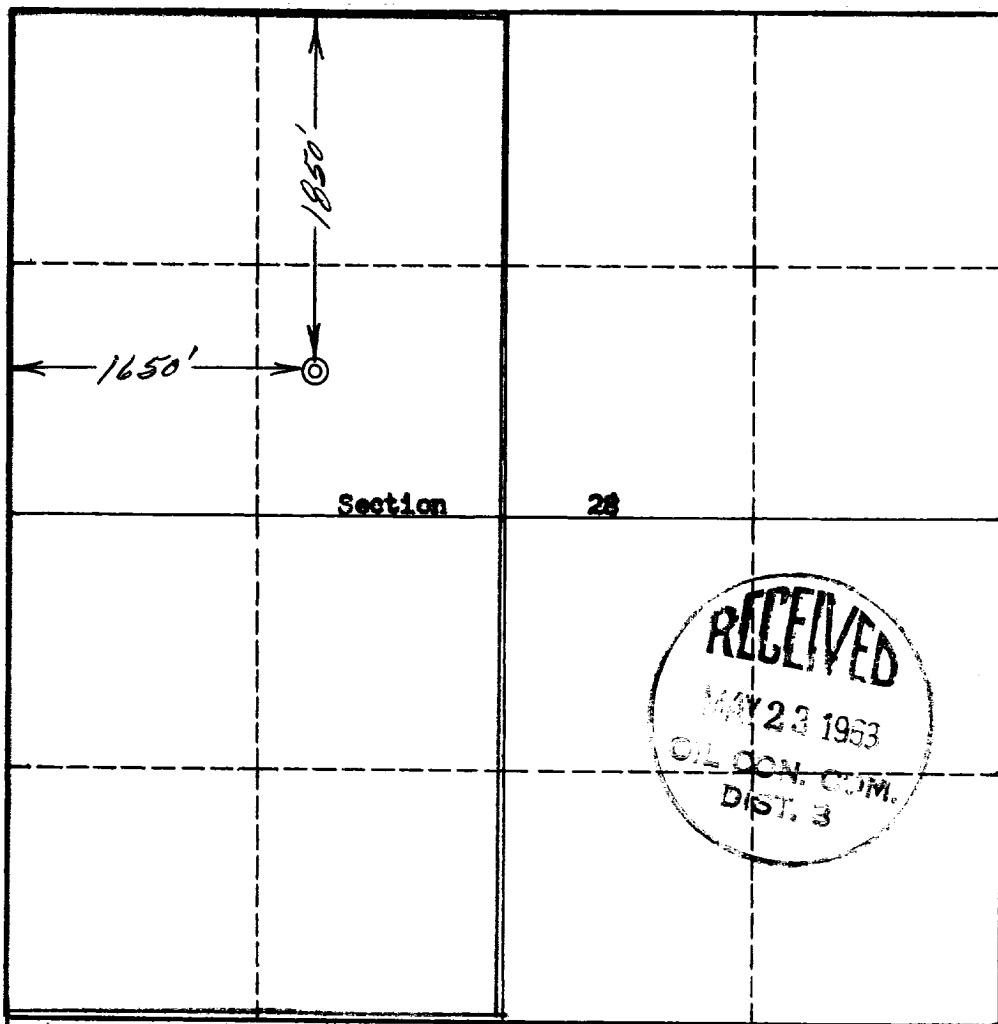

**CERTIFICATION**

I hereby certify that the information in SECTION A above is true and complete to the best of my knowledge and belief.

Name	<b>Robert E. Silverman</b>
Position	<b>District Prod. Supt.</b>
Company	<b>Teuaco Oil Company</b>
Date	<b>May 20, 1963</b>

I hereby certify that the well location shown on the plat in SECTION B was plotted from field notes of actual surveys made by me or under my supervision, and that the same is true and correct to the best of my knowledge and belief.

Date Surveyed	<b>18 May 1963</b>
Registered Professional Engineer and/or Land Surveyor	<b>Robert H. Burt</b>
Company	<b>San Juan Engineering Co.</b>
Certificate No.	<b>N. Mex. PE &amp; LS 2463</b>

0 330 660 990 1320 1650 1980 2310 2640 2000 1500 1000 500 0

## INSTRUCTIONS FOR COMPLETION OF FORM C-128

1. Operator shall furnish and certify to the information called for in Section A.
2. Operator shall outline the dedicated acreage for *both* oil and gas wells on the plat in Section B.
3. A registered professional engineer or land surveyor registered in the State of New Mexico or approved by the Commission shall show on the plat the location of the well and certify this information in the space provided.
4. All distances shown on the plat must be from the outer boundaries of the Section.
5. If additional space is needed for listing owners and their respective interests as required in question 3 of Section A, please use space below.