

(SUBMIT IN TRIPLICATE)

Indian Agency Nava jo
Tribal
Allottee Nava jo "H"
Lease No. 14-20-603-3013

Sec. 23
. #1

UNITED STATES
DEPARTMENT OF THE INTERIOR
GEOLOGICAL SURVEY

SUNDRY NOTICES AND REPORTS ON WELLS

NOTICE OF INTENTION TO DRILL	<input checked="" type="checkbox"/>	SUBSEQUENT REPORT OF WATER SHUT-OFF	
NOTICE OF INTENTION TO CHANGE PLANS		SUBSEQUENT REPORT OF SHOOTING OR ACIDIZING	
NOTICE OF INTENTION TO TEST WATER SHUT-OFF		SUBSEQUENT REPORT OF ALTERING CASING	
NOTICE OF INTENTION TO REDRILL OR REPAIR WELL		SUBSEQUENT REPORT OF REDRILLING OR REPAIR	
NOTICE OF INTENTION TO SHOOT OR ACIDIZE		SUBSEQUENT REPORT OF ABANDONMENT	
NOTICE OF INTENTION TO PULL OR ALTER CASING		SUPPLEMENTARY WELL HISTORY	
NOTICE OF INTENTION TO ABANDON WELL			

(INDICATE ABOVE BY CHECK MARK NATURE OF REPORT, NOTICE, OR OTHER DATA)

Nava jo "H" April 14, 19 62
Hobbs, New Mexico
Well No. 1 is located 1900 ft. from [S] line and 1900 ft. from [W] line of sec. 23
SE 1/4 SW 1/4 Sec. 23 20-N 15-W N.M.P.M.
(1/4 Sec. and Sec. No.) (Twp.) (Range) (Meridian)
Gallup (allottee) Under San Juan New Mexico
(Field) (County or Subdivision) (State or Territory)

The elevation of the derrick floor above sea level is _____ ft.

DETAILS OF WORK

(State names of and expected depths to objective sands; show sizes, weights, and lengths of proposed casings; indicate mudlogging jobs, cementing points, and all other important proposed work)

Propose to drill with rotary tools from surface to total depth of approx. 4600' to test the Gallup Formation. Casing program to be approx. as follows:

Size Hole	Size Casing	Casing Point	Feet Cement
11"	8-5/8"	290'	250
7-7/8"	4-1/2"	4600'	200

The pump & plug process will be used in cementing both strings of casing. The well will be perforated and treated with approximately 950 bbls. oil and approximately 40,000 lbs. 20/40 sand.

I understand that this plan of work must receive approval in writing by the Geological Survey before operations may be commenced.

Company Shelly Oil Co.

Address P. O. Box 36

Hobbs, New Mexico

By (ORIGINAL SIGNED) H. E. Aab

Title Dist. Supt.

NEW MEXICO OIL CONSERVATION COMMISSION

Well Location and Acreage Dedication Plat

SECTION A.

Date April 14, 1962

Operator Shelly Oil Company Lease Navajo "H"
Well No. 1 Unit Letter _____ Section 23 Township 28 North Range 15 West NMPM
Located 660 Feet From South Line, 1980 Feet From West Line
County San Juan G. L. Elevation 5562 Dedicated Acreage 40 Acres
Name of Producing Formation Gallup Pool Willard Under

1. Is the Operator the only owner* in the dedicated acreage outlined on the plat below? Yes XX No _____
2. If the answer to question One is "No," have the interests of all the owners been consolidated by communization agreement or otherwise? Yes _____ No _____. If answer is "Yes," Type of Consolidation _____
3. If the answer to question Two is "No," list all the owners and their respective interests below:

OWNER

LAND DESCRIPTION

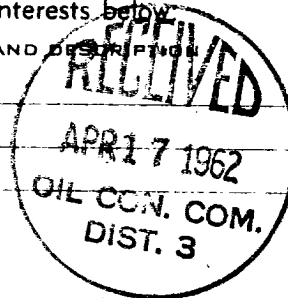

SECTION B.

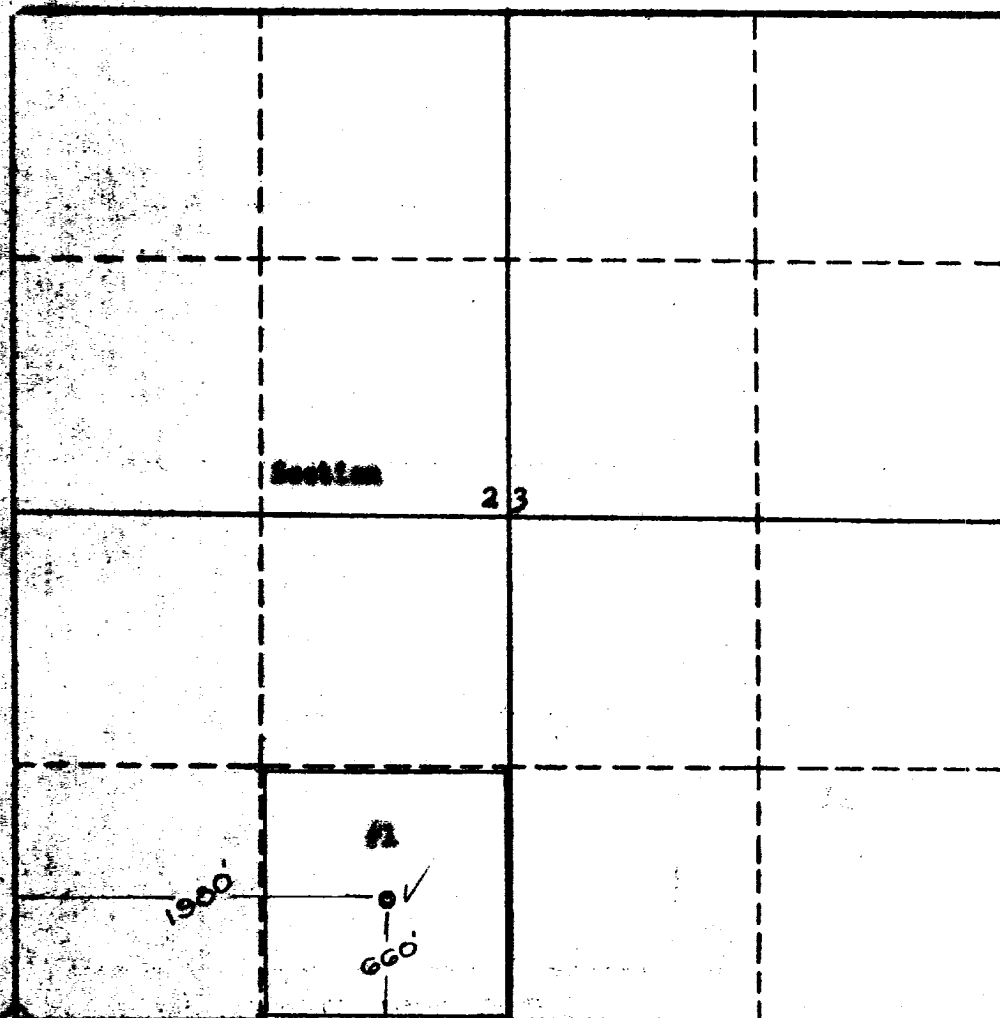

This is to certify that the information in Section A above is true and complete to the best of my knowledge and belief.

Shelly Oil Company

(OPERATOR)

(ORIGINAL SIGNED) H. E. Asplund, Supt.

(REPRESENTATIVE)

P.O. Box 98 - Hobbs, New Mex.

(ADDRESS)

This is to certify that the well location shown on the plat in Section B was plotted from field notes of actual surveys made by me or under my supervision and that the same is true and correct to the best of my knowledge and belief.

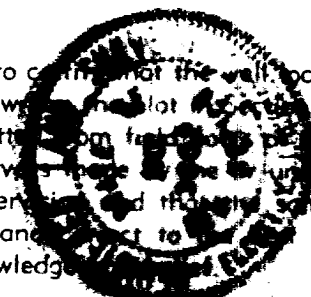

Date Surveyed April 12, 1962

Four States Engineering Co.
FARMINGTON, NEW MEXICO

Emmet V. Eckhardt
REGISTERED ENGINEER OR
LAND SURVEYOR

Certificate No. 3602

*Owner Verified (iron pipe, not marked)

0 500 1000 1500 2000 2500 3000 3500 3600