

(SUBMIT IN TRIPLICATE)

UNITED STATES  
DEPARTMENT OF THE INTERIOR  
GEOLOGICAL SURVEYLand Office Santa FeLease No. SF-078904Unit Gallegos Canyon Unit

## SUNDRY NOTICES AND REPORTS ON WELLS

NOTICE OF INTENTION TO DRILL	<input checked="" type="checkbox"/>	SUBSEQUENT REPORT OF WATER SHUT-OFF	JUL 21 1962
NOTICE OF INTENTION TO CHANGE PLANS		SUBSEQUENT REPORT OF SHOOTING OR ACIDIZING	
NOTICE OF INTENTION TO TEST WATER SHUT-OFF		SUBSEQUENT REPORT OF ALTERING CASING	U. S. GEOLOGICAL SURVEY
NOTICE OF INTENTION TO RE-DRILL OR REPAIR WELL		SUBSEQUENT REPORT OF RE-DRILLING OR REPAIRING	FARMINGTON, NEW MEXICO
NOTICE OF INTENTION TO SHOOT OR ACIDIZE		SUBSEQUENT REPORT OF ABANDONMENT	
NOTICE OF INTENTION TO PULL OR ALTER CASING		SUPPLEMENTARY WELL HISTORY	
NOTICE OF INTENTION TO ABANDON WELL			

(INDICATE ABOVE BY CHECK MARK NATURE OF REPORT, NOTICE, OR OTHER DATA)

Gallegos Canyon Unit

Farmington, New Mexico July 23, 1962

Well No. 126 is located 1980 ft. from N line and 1980 ft. from W line of sec. 23NE 1/4 SW 1/4 Section 23  
(1/4 Sec. and Sec. No.)T-26N  
(Twp.)R-12W  
(Range)N.M.P.M.  
(Meridian)Undesignated Gallup  
(Field)San Juan  
(County or Subdivision)New Mexico  
(State or Territory)

The elevation of the derrick floor above sea level is \_\_\_\_\_ ft. (To be reported later.)

## DETAILS OF WORK

(State names of and expected depths to objective sands; show sizes, weights, and lengths of proposed casings; indicate mudding jobs, cementing points, and all other important proposed work)

We propose to drill Gallegos Canyon Unit Well No. 126 with rotary tools to an approximate total depth of 5800' to test and develop productive Gallup Zones. Stimulation and completion will be as indicated upon penetration of Gallup Pay.

Proposed casing program as follows:

SIZE	DEPTH	CEMENT	REMARKS
8-5/8"	200'	150 sacks	Neat Incor - Circulate
4-1/2"	5800'	350 sacks	First stage - 125 sacks Incor 45 gel with 1-1/2 pounds Tuf plug per sack and 75 sacks Incor neat cement on bottom. Second stage - 150 sacks Incor 45 gel cement. 4-1/2" casing will be cemented by Second stage method with stage tool set about 100' below base of Pictured Cliffs. First stage will consist of sufficient cement to fill 300' above top of Gallup.

Copies of location plate attached. A copy of any survey taken will be submitted upon completion of well.

I understand that this plan of work must receive approval in writing by the Geological Survey before operations may be commenced.

Company Pan American Petroleum CorporationAddress P.O. Box 480Farmington, New MexicoAttn: L. G. Spear, Jr.

By

SIGNED BY  
P. H. HARRISWORTH

Title

Petroleum Engineer

## NEW MEXICO OIL CONSERVATION COMMISSION

## Well Location and Acreage Dedication Plat

Section A.

Date June 26, 1962

Operator PAN AMERICAN PETROLEUM CORPORATION Lease GALLEGOS CANYON UNIT  
 Well No. 126 Unit Letter K Section 23 Township 28 NORTH Range 12 WEST, NMPM  
 Located 1980 Feet From the SOUTH Line, 1980 Feet From the WEST Line  
 County SAN JUAN G. L. Elevation To report later Dedicated Acreage 40 Acres  
 Name of Producing Formation Gallup Pool Undesignated Gallup

1. Is the Operator the only owner in the dedicated acreage outlined on the plat below?

Yes \_\_\_\_\_ No X2. If the answer to question one is "no", have the interests of all the owners been consolidated by communitization agreement or otherwise? Yes X No \_\_\_\_\_. If answer is "yes", Type of Consolidation.Gallegos Canyon Unit acreage

3. If the answer to question two is "no", list all the owners and their respective interests below:

OwnerLand Description

Section B.

This is to certify that the information  
 in Section A above is true and complete  
 to the best of my knowledge and belief.

Pan American Petr. Corp.(Operator)F. H. Hollingsworth(Representative)Box 480, Farmington, New Mex.(Address)

Note: All distances must be from outer boundaries of section

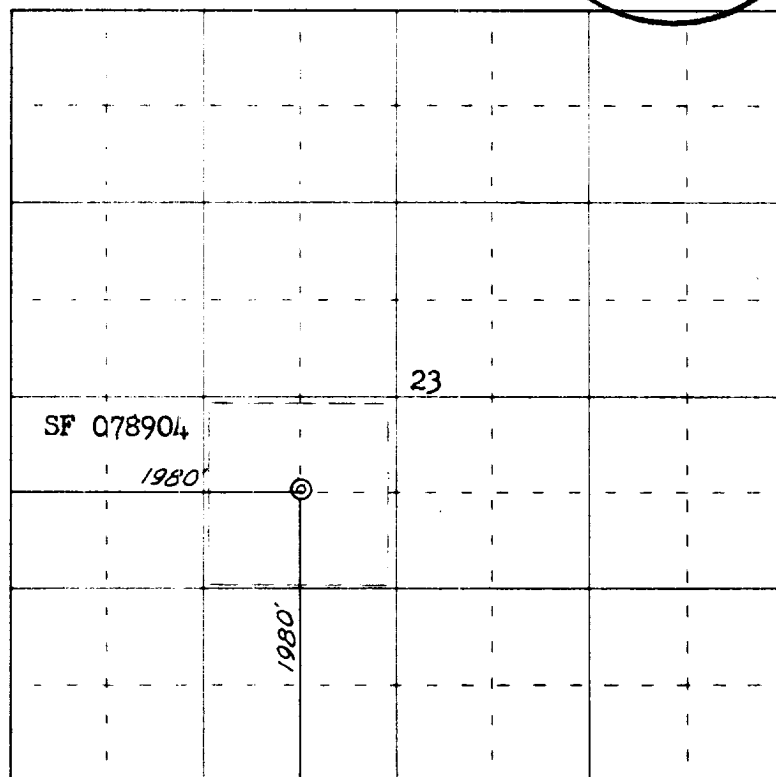

0 330 660 990 1320 1650 1980 2310 2640 2000 1500 1000 500 0

Scale 4 inches equal 1 mile

This is to certify that the above plat was prepared from field notes of actual surveys made by me or under my supervision and that the same are true and correct to the best of my knowledge and belief.

Date Surveyed 15 June 1962

James P. Leese  
 Registered Professional Engineer and/or Land Surveyor  
 James P. Leese N. Mex. Reg. No. 1463  
 San Juan Engineering Company

(Seal)

Farmington, New Mexico