

(SUBMIT IN TRIPLICATE)
UNITED STATES
DEPARTMENT OF THE INTERIOR
GEOLOGICAL SURVEYLand Office Santa Fe
Lease No. I-149-Indian 8476
Unit I-See. 844
Gallegos Canyon Unit

SUNDRY NOTICES AND REPORTS ON WELLS

NOTICE OF INTENTION TO DRILL.....	<input checked="" type="checkbox"/>	SUBSEQUENT REPORT OF WATER SHUT-OFF.....	
NOTICE OF INTENTION TO CHANGE PLANS.....		SUBSEQUENT REPORT OF SHOOTING OR ACIDIZING.....	
NOTICE OF INTENTION TO TEST WATER SHUT-OFF.....		SUBSEQUENT REPORT OF ALTERING CASING.....	
NOTICE OF INTENTION TO RE-DRILL OR REPAIR WELL.....		SUBSEQUENT REPORT OF REDRILLING OR REPAIR.....	
NOTICE OF INTENTION TO SHOOT OR ACIDIZE.....		SUBSEQUENT REPORT OF ABANDONMENT.....	
NOTICE OF INTENTION TO PULL OR ALTER CASING.....		SUPPLEMENTARY WELL HISTORY.....	
NOTICE OF INTENTION TO ABANDON WELL.....			

(INDICATE ABOVE BY CHECK MARK NATURE OF REPORT, NOTICE, OR OTHER DATA)

May 18, 19 53

Well No. 19 is located 1737 ft. from N line and 990 ft. from E line of sec. 20
SE 1/4 NE 1/4 Sec. 20 28N 12W N.M.P.M.
(1/4 Sec. and Sec. No.) (Twp.) (Range) (Meridian)
West Kutz San Juan New Mexico
(Field) (County or Subdivision) (State or Territory)

The elevation of the derrick floor above sea level is _____ ft. (Not available. Will furnish later).

DETAILS OF WORK

(State names of and expected depths to objective sands; show sizes, weights, and lengths of proposed casings; indicate mudding jobs, cementing points, and all other important proposed work)

Pictured Cliffs Sand test. Estimated depth 1500'.

Surface Casing: 80' of used 8-5/8" OD 26# cemented to surface.

Production Casing: 1400' of 5-1/2" OD 15.5# cemented with 100 sacks.

If commercial production is indicated, the producing section will
be shot with nitroglycerin.

I understand that this plan of work must receive approval in writing by the Geological Survey before operations may be commenced.

Company BENSON-MONTIN
 Address 315 1/2 West Main
Farmington, New Mexico

By Robert R. Green
 Title Field Superintendent



Company: MALLARD OIL CO.

Lease: Well No. 19

Sec. 20 T20N R14W N. M. L.

Location: 1400' from east line and 780' from north line

Sandoval County New Mexico

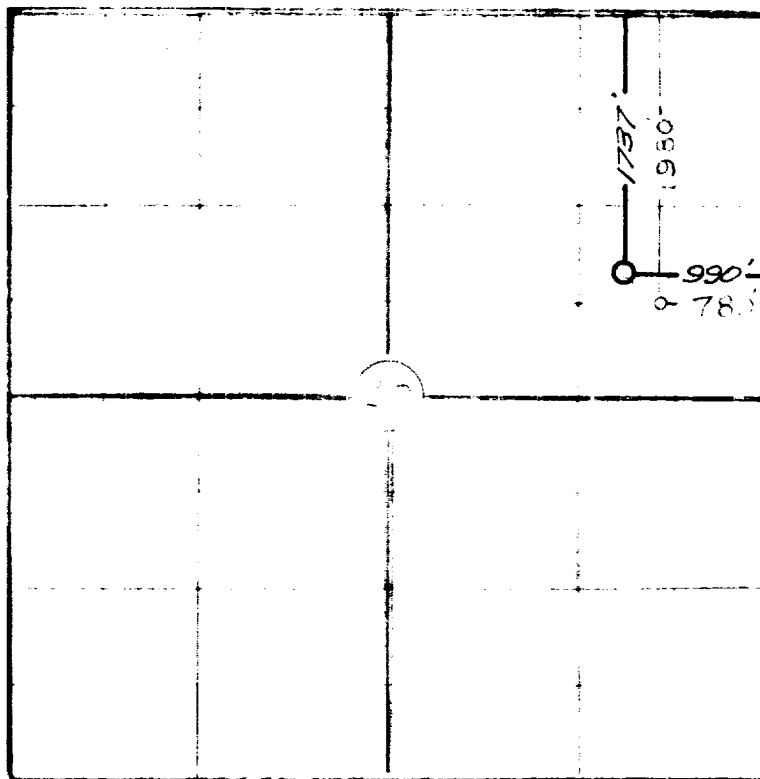

Location moved 9/30/52, to a point 1737' FNL, and 990' FEL, of same Section.

Signed:

Albert R. Greer
Albert R. Greer,
Registered Professional
Engineer,
New Mexico registration
Number 805.

This is to certify that the above location was as shown and that it is not subject to survey made by me or under my supervision and that the same is true and correct to the best of my knowledge and belief.

Robert L. Maddox Jr.
Robert L. Maddox Jr.
Registered Professional
Engineer and Land Surveyor
N. Mex. License No. 1426

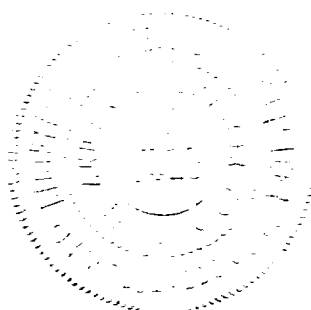

Surveyed July 1, 1952