

COPY TO O. C. C.

(SUBMIT IN TRIPLICATE)

UNITED STATES
DEPARTMENT OF THE INTERIOR
GEOLOGICAL SURVEY

Land Office Santa Fe
Lease No. I-149-Indian-2475
Unit I-See. 244
Gallegos Canyon Unit

SUNDRY NOTICES AND REPORTS ON WELLS

NOTICE OF INTENTION TO DRILL.....	<input checked="" type="checkbox"/>	SUBSEQUENT REPORT OF WATER SHUT-OFF.....	
NOTICE OF INTENTION TO CHANGE PLANS.....		SUBSEQUENT REPORT OF SHOOTING OR ACIDIZING.....	
NOTICE OF INTENTION TO TEST WATER SHUT-OFF.....		SUBSEQUENT REPORT OF ALTERING CASING.....	
NOTICE OF INTENTION TO RE-DRILL OR REPAIR WELL.....		SUBSEQUENT REPORT OF REDRILLING OR REPAIR.....	
NOTICE OF INTENTION TO SHOOT OR ACIDIZE.....		SUBSEQUENT REPORT OF ABANDONMENT.....	
NOTICE OF INTENTION TO PULL OR ALTER CASING.....		SUPPLEMENTARY WELL HISTORY.....	
NOTICE OF INTENTION TO ABANDON WELL.....			

(INDICATE ABOVE BY CHECK MARK NATURE OF REPORT, NOTICE, OR OTHER DATA)

May 18, 19 53

Well No. 39 is located 990 ft. from N line and 990 ft. from W line of sec. 16
SW/4 SW/4 Sec. 16 28N 12W N.M.P.M.
(1/4 Sec. and Sec. No.) (Twp.) (Range) (Meridian)
West Kutz San Juan New Mexico
(Field) (County or Subdivision) (State or Territory)

The elevation of the derrick floor above sea level is _____ ft. (Not available. Will furnish later).

DETAILS OF WORK

(State names of and expected depths to objective sands; show sizes, weights, and lengths of proposed casings; indicate mudding jobs, cementing points, and all other important proposed work)

Pictured Cliffs Sand test. Estimated depth 1500'.

Surface Casing: 80' of used 8-5/8" OD 26# cemented to surface.

Production Casing: 1400' of 5-1/2" OD 15.5# cemented with 100 sacks.

If commercial production is indicated, the producing section will be shot with nitroglycerin.

I understand that this plan of work must receive approval in writing by the Geological Survey before operations may be commenced.

Company BENSON-MONTIN
Address 315 1/2 West Main
Farmington, New Mexico

By CC West R Green
Title Field Superintendent

COMPANY - Benson - Montin
LEASE - Gallegos Canyon Unit - Well No 39
Sec 16 T28N R12W N.M.P.M.
LOCATION 990' from south line
990' from west line
San Juan County New Mex

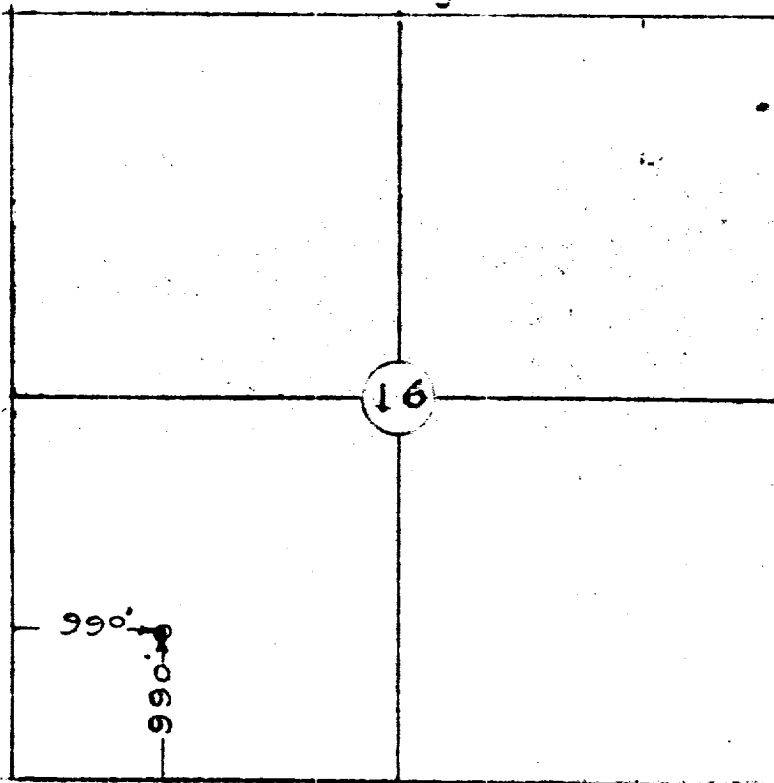

This to certify that the above plat
was prepared from field notes of
actual surveys made by me and
are true and correct to the best
of my knowledge & belief

Robert L. Maddox Jr.
Robert L. Maddox Jr.
Registered Professional Engineer
and Land Surveyor
N.M. Reg. No. 1426

Surveyed 3-22-53