

X		

(SUBMIT IN TRIPLICATE)

UNITED STATES
DEPARTMENT OF THE INTERIOR
GEOLOGICAL SURVEY

Land Office Santa Fe
Lease No. 077376
Unit Jones

SUNDRY NOTICES AND REPORTS ON WELLS

NOTICE OF INTENTION TO DRILL.....	<input checked="" type="checkbox"/>	SUBSEQUENT REPORT OF WATER SHUT-OFF.....
NOTICE OF INTENTION TO CHANGE PLANS.....		SUBSEQUENT REPORT OF SHOOTING OR ACIDIZING.....
NOTICE OF INTENTION TO TEST WATER SHUT-OFF.....		SUBSEQUENT REPORT OF ALTERING CASING.....
NOTICE OF INTENTION TO RE-DRILL OR REPAIR WELL.....		SUBSEQUENT REPORT OF RE-DRILLING OR REPAIR.....
NOTICE OF INTENTION TO SHOOT OR ACIDIZE.....		SUBSEQUENT REPORT OF ABANDONMENT.....
NOTICE OF INTENTION TO PULL OR ALTER CASING.....		SUPPLEMENTARY WELL HISTORY.....
NOTICE OF INTENTION TO ABANDON WELL.....		

(INDICATE ABOVE BY CHECK MARK NATURE OF REPORT, NOTICE, OR OTHER DATA)

November 17th, 19 61

Well No. 7 is located 1380 ft. from N line and 530 ft. from W line of sec. 15
SW/4 NW/4 Sec. 15 28N 13W N.M.P.M.
(1/4 Sec. and Sec. No.) (Twp.) (Range) (Meridian)
Cha Cha-Gallup San Juan New Mexico
(Field) (County or Subdivision) (State or Territory)

The elevation of the derrick floor above sea level is 6258 ft. est.

DETAILS OF WORK

(State names of and expected depths to objective sands; show sizes, weights, and lengths of proposed casings; indicate mudding jobs, cementing points, and all other important proposed work)

Gallup test. Estimated total depth 5900'.

Surface Casing: 150' of 8-5/8" OD 24# J-55 cemented to surface.
Production " : Approximately 5900' of 4-1/2" OD 11.5# J-55
cemented with 150 sacks.

If commercial production is indicated, the producing section will be sand-oil fractured.

I understand that this plan of work must receive approval in writing by the Geological Survey before operations may be commenced.

Company HENSON-MORTIN-GREER DRILLING CORP.

Address 158 Petroleum Center Bldg.
Farmington, New Mexico

By [Signature]
Title Engineer

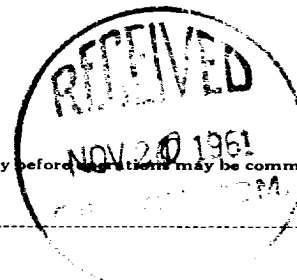

Well Location and Acreage Dedication Plat

Section A.

Date

November 17, 1961

Operator HENSON-MONTIN-GEER DRILLING CORPORATION LeaseWell No. _____ Unit Letter E Section 15 Township 20 NORTH Range 13 WEST, NMPMLocated 1980 Feet From the NORTH Line, 530 Feet From the WEST LineCounty SAN JUAN G. L. Elevation 6050.0 Dedicated Acreage _____ AcresName of Producing Formation _____ Pool 801. Is the Operator the only owner in 80 dedicated acreage outlined on the plat below? Yes 80-80-80

Yes _____ No _____

2. If the answer to question one is "no", have the interests of all the owners been consolidated by communization agreement or otherwise? Yes _____ No _____. If answer is "yes", Type of Consolidation.

3. If the answer to question two is "no", list all the owners and their respective interests below:

Owner

Land Description

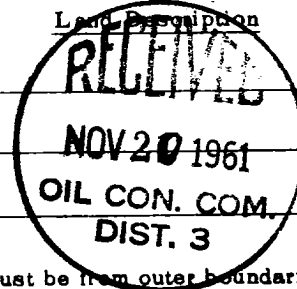

Section B.

Note: All distances must be from outer boundaries of section.

This is to certify that the information in Section A above is true and complete to the best of my knowledge and belief.

~~HENSON-MONTIN-GEER DRILLING~~

(Representative)

138 Petroleum Center Bldg.

Farmington, New Mexico

Ref: GLO plat dated 19 July 1915

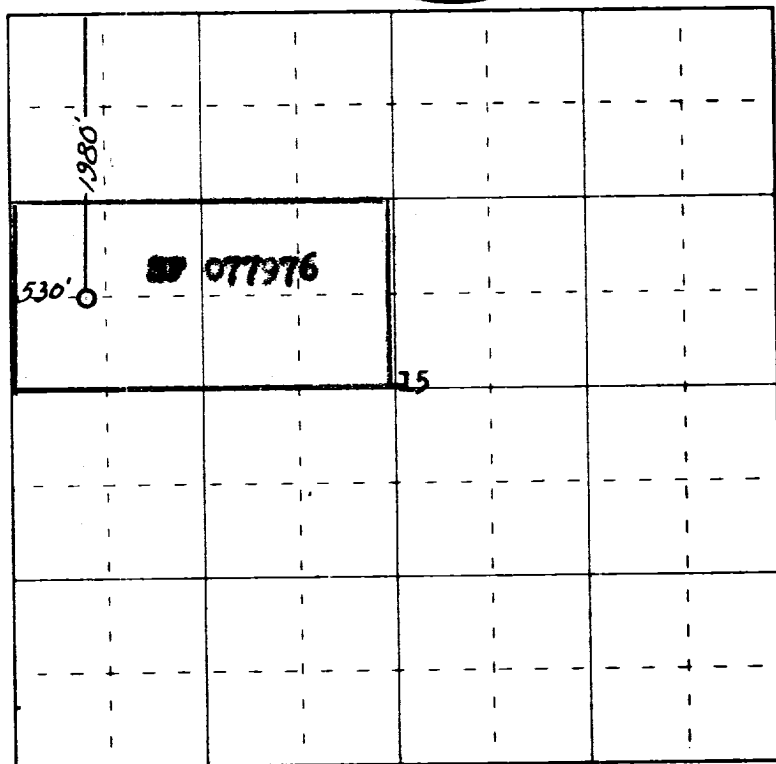

0 330 660 990 1320 1650 1980 2310 2640 2000 1500 1000 500 0

Scale 4 inches equal 1 mile

(Seal)

Farmington, New Mexico

This is to certify that the above plat was prepared from field notes of actual surveys made by me or under my supervision and that the same are true and correct to the best of my knowledge and belief.

Date Surveyed 7 August 1961

James P. Leese
Registered Professional Engineer and/or Land Surveyor
James P. Leese E. Max. Reg. No. 1463
San Juan Engineering Company

x			

(SUBMIT IN TRIPLICATE)

UNITED STATES
DEPARTMENT OF THE INTERIOR
GEOLOGICAL SURVEY

Land Office Santa Fe
Lease No. 077976
Unit Jones

SUNDRY NOTICES AND REPORTS ON WELLS

NOTICE OF INTENTION TO DRILL		SUBSEQUENT REPORT OF WATER SHUT-OFF	
NOTICE OF INTENTION TO CHANGE PLANS		SUBSEQUENT REPORT OF SHOOTING OR ACIDIZING	x
NOTICE OF INTENTION TO TEST WATER SHUT-OFF		SUBSEQUENT REPORT OF ALTERING CASING	
NOTICE OF INTENTION TO RE-DRILL OR REPAIR WELL		SUBSEQUENT REPORT OF RE-DRILLING OR REPAIR	
NOTICE OF INTENTION TO SHOOT OR ACIDIZE		SUBSEQUENT REPORT OF ABANDONMENT	
NOTICE OF INTENTION TO PULL OR ALTER CASING		SUPPLEMENTARY WELL HISTORY	
NOTICE OF INTENTION TO ABANDON WELL			

(INDICATE ABOVE BY CHECK MARK NATURE OF REPORT, NOTICE, OR OTHER DATA)

January 29, 1962

Well No. 7 is located 1900 ft. from N line and 530 ft. from E line of sec. 45

S4/4 NW/4 Sec. 15 20N 13E N.M.P.M.
(1/4 Sec. and Sec. No.) (Twp.) (Range) (Meridian)

Cha Cha Gallup San Juan New Mexico
(Field) (County or Subdivision) (State or Territory)

The elevation of the derrick floor above sea level is 6060 ft.

DETAILS OF WORK

(State names of and expected depths to objective sands; show sizes, weights, and lengths of proposed casings; indicate mudding jobs, cementing points, and all other important proposed work)

11-19-61 TD 170' RKB. Set 5 joints 155' of 8-5/8" OD 24# J-55 casing at 165' RKB with 150 sacks cement, 2% calcium chloride, circulated.

11-20-61 Pressured up on casing to 500#. No pressure decrease in 30 minutes.

I understand that this plan of work must receive approval in writing by the Geological Survey before operations may be commenced.

Company BENSON-MONTIN-GREER DRILLING CORP.

Address 158 Petroleum Center Building

Farlington, New Mexico

By S. J. Stanley
Title Engineer