

COPY TO O.C.C.

Budget Bureau 42-R358.2
Approval expires 12-31-52.

(SUBMIT IN TRIPLICATE)

UNITED STATES
DEPARTMENT OF THE INTERIOR
GEOLOGICAL SURVEY

Land Office Santa Fe
Lease No. 078106
Unit I-See. 844
Gallegos Canyon Unit

SUNDRY NOTICES AND REPORTS ON WELLS

NOTICE OF INTENTION TO DRILL.....	<input checked="" type="checkbox"/>	SUBSEQUENT REPORT OF WATER SHUT-OFF.....	
NOTICE OF INTENTION TO CHANGE PLANS.....		SUBSEQUENT REPORT OF SHOOTING OR ACIDIZING.....	
NOTICE OF INTENTION TO TEST WATER SHUT-OFF.....		SUBSEQUENT REPORT OF ALTERING CASING.....	
NOTICE OF INTENTION TO RE-DRILL OR REPAIR WELL.....		SUBSEQUENT REPORT OF REDRILLING OR REPAIR.....	
NOTICE OF INTENTION TO SHOOT OR ACIDIZE.....		SUBSEQUENT REPORT OF ABANDONMENT.....	
NOTICE OF INTENTION TO PULL OR ALTER CASING.....		SUPPLEMENTARY WELL HISTORY.....	
NOTICE OF INTENTION TO ABANDON WELL.....			

(INDICATE ABOVE BY CHECK MARK NATURE OF REPORT, NOTICE, OR OTHER DATA)

Acres allocated to this well: January 6, 1952
N/2 Section 18: 311.87 acres.

Well No. 22 is located 1790 ft. from N line and 1820 ft. from E line of sec. 18
~~XXXX~~ ~~XXXX~~

NE 1/4 of Sec. 18 28N 12W NMPM
(1/4 Sec. and Sec. No.) (Twp.) (Range) (Meridian)
West Kuts San Juan New Mexico
(Field) (County or Subdivision) (State or Territory)

The elevation of the derrick floor above sea level is 5647 ft. (RKB)

DETAILS OF WORK

(State names of and expected depths to objective sands; show sizes, weights, and lengths of proposed casings; indicate mudding jobs, cementing points, and all other important proposed work)

Pictured Cliffs test: Estimated depth 1400'.

Surface Casing: 90' of 32.7# 10 3/4" cemented to the surface.

Production casing: 1400' of 20# 7" cemented with 100 sacks.

Will set casing with rotary. Sand will be drilled with cable tools and if commercial production is indicated, producing section will be shot with nitroglycerin.

I understand that this plan of work must receive approval in writing by the Geological Survey before operations may be commenced.

Company BANSON AND MONTIN
Address 315 1/2 West Main St.
Farmington, N. M.

By Albert R. Greer
Title Albert R. Greer
Field Sup't.

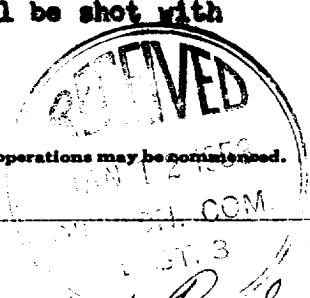

RECEIVED
JAN 12 1953
OFFICE OF THE SURVEY
COMMISSIONER

Company BENSON MARTIN

Lease

Well No. 22

Sec 18 T 28N R 12W N.M.P.M.

Location 1790' from north line and 1820'
from east line

San Juan County New Mexico

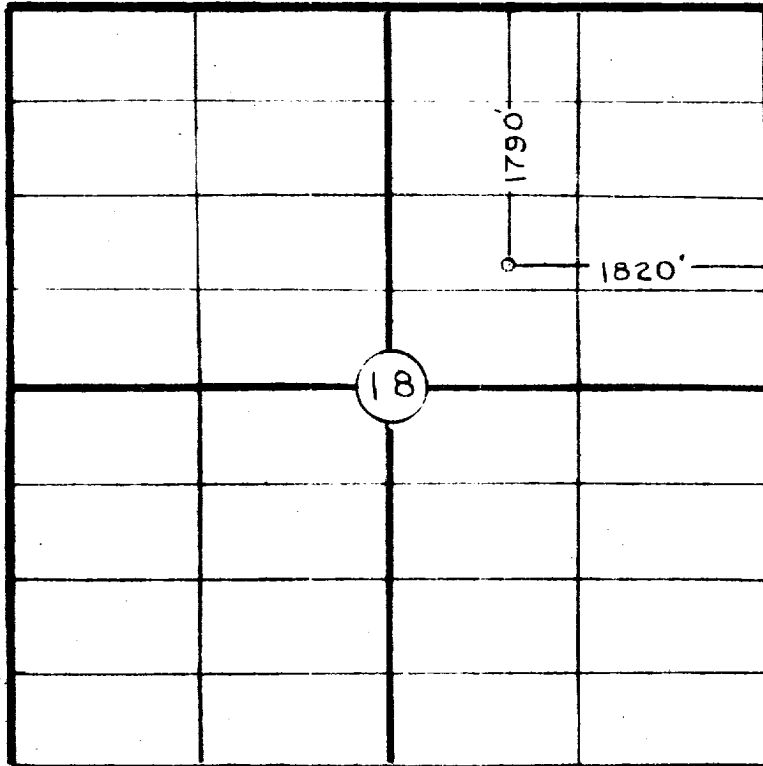

This is to certify that the above plat
was prepared from field notes of actual
surveys made by me or under my supervision
and that the same are true and correct to
the best of my knowledge and belief

Robert L. Maddox Jr.

Robert L. Maddox Jr
Registered Professional
Engineer and Land Surveyor
N.Mex. Reg. No. 1426

Surveyed July 17, 1952

