

(SUBMIT IN TRIPLICATE)

UNITED STATES  
DEPARTMENT OF THE INTERIOR  
GEOLOGICAL SURVEYLand Office Santa FeLease No. RM 010063

Unit \_\_\_\_\_

## SUNDRY NOTICES AND REPORTS ON WELLS

NOTICE OF INTENTION TO DRILL.....	<input checked="" type="checkbox"/>	SUBSEQUENT REPORT OF WATER SHUT-OFF.....	
NOTICE OF INTENTION TO CHANGE PLANS.....		SUBSEQUENT REPORT OF SHOOTING OR ACIDIZING.....	
NOTICE OF INTENTION TO TEST WATER SHUT-OFF.....		SUBSEQUENT REPORT OF ALTERING CASING.....	
NOTICE OF INTENTION TO RE-DRILL OR REPAIR WELL.....		SUBSEQUENT REPORT OF RE-DRILLING OR REPAIR.....	
NOTICE OF INTENTION TO SHOOT OR ACIDIZE.....		SUBSEQUENT REPORT OF ABANDONMENT.....	
NOTICE OF INTENTION TO PULL OR ALTER CASING.....		SUPPLEMENTARY WELL HISTORY.....	
NOTICE OF INTENTION TO ABANDON WELL.....			

(INDICATE ABOVE BY CHECK MARK NATURE OF REPORT, NOTICE, OR OTHER DATA)

March 12, 1962

Well No. Lucerne A-1 is located 990 ft. from N line and 990 ft. from W line of sec. 17N 1/4, SW 1/4, Sec 17 23N 11W R1P (Meridian)Dakota San Juan (County or Subdivision) New MexicoThe elevation of the ground floor above sea level is 5572 ft.

## DETAILS OF WORK

(State names of and expected depths to objective sands; show sizes, weights, and lengths of proposed casings; indicate mudlogging jobs, cementing points, and all other important proposed work)

Plan to drill a 12 1/4" hole to approx. 200' and run 8 5/8" Csg cemented with sufficient cement to circulate, approx. 125 sz. A 6 3/4" hole will then be drilled to a total depth of approximately 6300' and 4 1/2", 10.5% csg will be run and cemented with sufficient cement to cover the Gallup formation. The Dakota formation will then be selectively perforated and sand, water fractured.

*Determination of cementing procedure to be made  
from E log.*

I understand that this plan of work must receive approval in writing by the Geological Survey before operations may be commenced.

Company Redfern & Hard, Inc.Address 1007 N. DustinFarmington, New MexicoBy Original signed by T. A. DuganTitle Consulting Engineer

NEW MEXICO OIL CONSERVATION COMMISSION  
Well Location and Acreage Dedication Plat

Section A.

Date March 12, 1962

Operator Redfern & Herd Lease Lucerna  
Well No. A-1 Unit Letter D Section 17 Township 28 North Range 11 West NMPM  
Located 990 Feet From North Line, 990 Feet From West Line  
County San Juan G. L. Elevation 5572 Dedicated Acreage 320 Acres  
Name of Producing Formation Dakota Pool Basin - Dakota

1. Is the Operator the only owner\* in the dedicated acreage outlined on the plat below?  
Yes X No       .
2. If the answer to question one is "no," have the interests of all the owners been consolidated by communitization agreement or otherwise? Yes        No       . If answer is "yes," Type of Consolidation
3. If the answer to question two is "no," list all the owners and their respective interests below:

Owner

Land Description

RECEIVED

MAR 19 1962

OIL CON. COM.  
DIST. 3

Section B

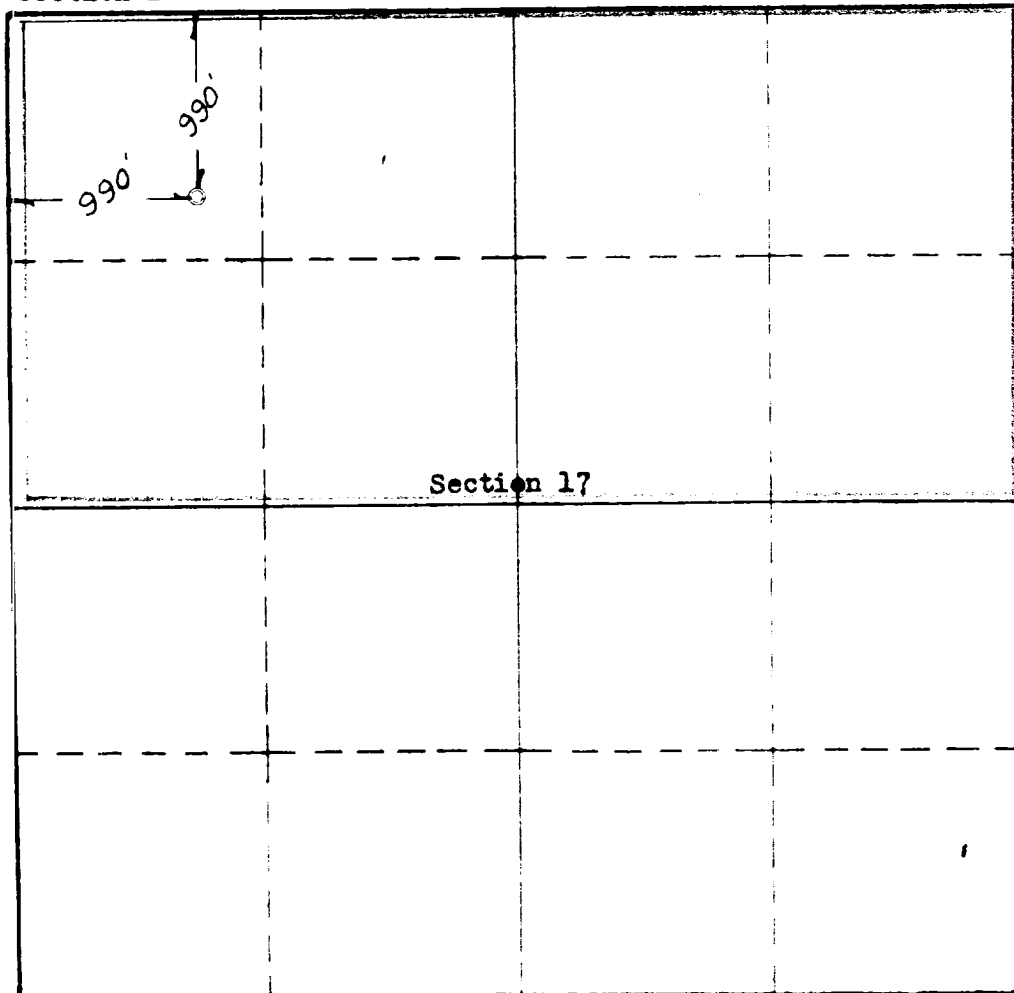

This is to certify that the information in Section A above is true and complete to the best of my knowledge and belief.

Redfern & Herd, Inc.  
(Operator)

1007 N. Dustin  
Farmington, New Mexico  
(Representative)

Original signed by T. A. Dugan

Address

This is to certify that the well location shown on the plat in Section B was plotted from field notes of actual surveys made by me or under my supervision and that the same is true and correct to the best of my knowledge and belief.

Date Surveyed Feb. 26, 1962

C. L. Poter  
Registered Professional  
Engineer and/or Land Surveyor.

Certificate No. 3084