

(SUBMIT IN TRIPLICATE)

UNITED STATES
DEPARTMENT OF THE INTERIOR
GEOLOGICAL SURVEY

Land Office **Santa Fe**
Lease No. **SF-078007-A**
Unit **Gallagos Canyon Unit**

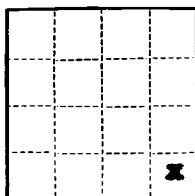

SUNDRY NOTICES AND REPORTS ON WELLS

NOTICE OF INTENTION TO DRILL.....	<input checked="" type="checkbox"/>	SUBSEQUENT REPORT OF WATER SHUT-OFF.....
NOTICE OF INTENTION TO CHANGE PLANS.....		SUBSEQUENT REPORT OF SHOOTING OR ACIDIZING.....
NOTICE OF INTENTION TO TEST WATER SHUT-OFF.....		SUBSEQUENT REPORT OF ALTERING CASING.....
NOTICE OF INTENTION TO RE-DRILL OR REPAIR WELL.....		SUBSEQUENT REPORT OF RE-DRILLING OR REPAIR.....
NOTICE OF INTENTION TO SHOOT OR ACIDIZE.....		SUBSEQUENT REPORT OF ABANDONMENT.....
NOTICE OF INTENTION TO PULL OR ALTER CASING.....		SUPPLEMENTARY WELL HISTORY.....
NOTICE OF INTENTION TO ABANDON WELL.....		

(INDICATE ABOVE BY CHECK MARK NATURE OF REPORT, NOTICE, OR OTHER DATA)

Gallagos Canyon Unit

Farmington, New Mexico August 9, 1961

Well No. **105** is located **810** ft. from **S** line and **600** ft. from **E** line of sec. **12**
SE/4 SE/4 of Section 12 T-28-N R-13-W N.M.P.M.
(1/4 Sec. and Sec. No.) (Twp.) (Range) (Meridian)
Totah Gallup San Juan New Mexico
(Field) (County or Subdivision) (State or Territory)

The elevation of the derrick floor above sea level is ft. (To be reported later)

DETAILS OF WORK

(State names of and expected depths to objective sands; show sizes, weights, and lengths of proposed casings; indicate mudding jobs, cementing points, and all other important proposed work)

We propose to drill the above well to approximately 5650' to test and develop production in Gallup zones. Stimulation will be as indicated upon penetration of Gallup Pay. Rotary tools will be used to total depth. Casing program as follows:

SIZE	DEPTH	CEMENT	REMARKS
8-5/8"	200'	110-160	Test - circulate
4-1/2"	5650'	500	Stage tool set 100' below base of Pictured Cliffs formation. First stage cemented with

125 sacks 6 percent gel with 1-1/2 pounds Taf Plug per sack followed by 75 sacks rest on bottom. Second stage cemented with 300 sacks 6 percent gel cement.

Copies of location plat attached. Copy of any survey taken will be submitted upon completion of well.

I understand that this plan of work must receive approval in writing by the Geological Survey before operations may be commenced.

Company **Pan American Petroleum Corporation**

Address **P. O. Box 480**

Farmington, New Mexico

Attn: **L. O. Speer, Jr.**

ORIGINAL SIGNED BY

L. O. Speer, Jr.

By

Title **Area Superintendent**

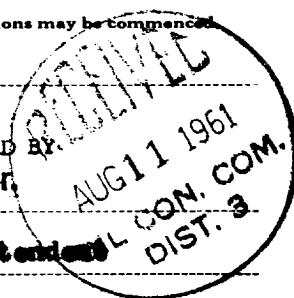

NEW MEXICO OIL CONSERVATION COMMISSION

Well Location and Acreage Dedication Plat

Section A.

Date August 8, 1961

Operator PAN AMERICAN PETROLEUM CORPORATION Lease GALLEGOS CANYON UNIT
 Well No. 105 Unit Letter P Section 12 Township 28 NORTH Range 13 WEST NMPM
 Located 810 Feet From THE SOUTH Line, 600 Feet From THE EAST Line
 County SAN JUAN G. L. Elevation To Report Later Dedicated Acreage 80 Acres
 Name of Producing Formation GALLUP Pool TOTAH GALLUP

1. Is the Operator the only owner in the dedicated acreage outlined on the plat below?

Yes _____ No X2. If the answer to question one is "no", have the interests of all the owners been consolidated by communitization agreement or otherwise? Yes X No _____. If answer is "yes", Type of Consolidation.

Gallegos Canyon Unit Acreage

3. If the answer to question two is "no", list all the owners and their respective interests below:

Owner

Land Description

Section B.

Note: All distances must be from outer boundaries of section.

This is to certify that the information
 in Section A above is true and complete
 to the best of my knowledge and belief.

Pan American Petroleum Corporation

(Operator)

R. M. Bauer, Jr. *RMBauer Jr.*

(Representative)

Box 480, Farmington, New Mexico

(Address)



Ref. GLO Plat dated: 19 July 1915

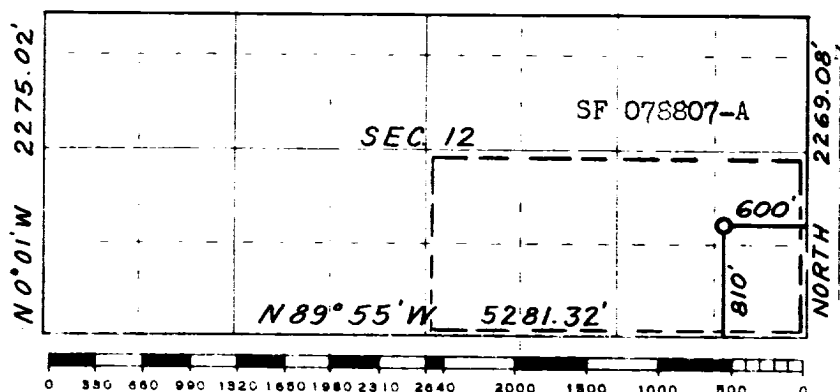

Scale 4 inches equal 1 mile

This is to certify that the above plat was prepared from field notes of actual surveys made by me or under my supervision and that the same are true and correct to the best of my knowledge and belief.

Date Surveyed August 4, 1961

James P. Lease
 Registered Professional Engineer and/or Land Surveyor
 James P. Lease N. Mex. Reg. No. 1463



Farmington, New Mexico