

State of New Mexico
Energy, Minerals and Natural Resources

Form C-103

Revised March 25, 1999

OIL CONSERVATION DIVISION

1220 South St. Francis Dr.

Santa Fe, NM 87505

WELL API NO.

30-045-11619

5. Indicate Type of Lease

STATE ☐ FEE ☐

6. State Oil & Gas Lease No.

7. Lease Name or Unit Agreement Name:

Gallegos Canyon Unit

(Federal Well SF - 078109 also filed on
BLM Form 3160-3)

8. Well No.

223

9. Pool name or Wildcat

Basin Dakota & Basin Fruitland Coal

SUNDRY NOTICES AND REPORTS ON WELLS

(DO NOT USE THIS FORM FOR PROPOSALS TO DRILL OR TO DEEPEN OR PLUG BACK TO A
DIFFERENT RESERVOIR. USE "APPLICATION FOR PERMIT" (FORM C-101) FOR SUCH
PROPOSALS.)

1. Type of Well:

Oil Well ☐ Gas Well ☒ Other

2. Name of Operator

Amoco Production Company

Attn: Mary Corley

3. Address of Operator

P.O. Box 3092 Houston, TX 77253

4. Well Location

Unit Letter N 795 feet from the South line and 1490 feet from the West lineSection 09 Township 28N Range 12W NMPM San Juan County

10. Elevation (Show whether DR, RKB, RT, GR, etc.)

5730'

11. Check Appropriate Box to Indicate Nature of Notice, Report or Other Data

NOTICE OF INTENTION TO:

PERFORM REMEDIAL WORK ☐ PLUG AND ABANDON ☐TEMPORARILY ABANDON ☐ CHANGE PLANS ☐PULL OR ALTER CASING ☐ MULTIPLE COMPLETION ☐OTHER: Complete Fruitland Coal & Downhole Commingle ☒

SUBSEQUENT REPORT OF:

REMEDIAL WORK ☐ ALTERING CASING ☐COMMENCE DRILLING OPNS. ☐ PLUG AND ABANDONMENT ☐CASING TEST AND CEMENT JOB ☐OTHER: ☐

12. Describe proposed or completed operations. (Clearly state all pertinent details, and give pertinent dates, including estimated date of starting any proposed work). SEE RULE 1103. For Multiple Completions: Attach wellbore diagram of proposed completion or recompletion.

Amoco Production Company request permission to complete the subject well into the Basin Fruitland Coal and commingle production downhole with the existing Basin Dakota Pool as per the attached procedure.

The Basin Dakota (71599) & the Basin Fruitland Coal (71629) Pools are Pre-Approved for Downhole Commingling per NMOCD Order R - 11363. Although the interest owners are not identical between these two Pools, NMOCD CASE NO. 12520, ORDER NO. R-11567 effective 04/26/2001, established approval for subsequent applications for the downhole commingling of production in wellbores within the Gallegos Canyon Unit without notice to the unit interest owners, therefore, additional notification is required prior to downhole commingling approval

Production is proposed to be allocated based on the subtraction method using the projected future decline for production from the Dakota. That production shall serve as a base for production subtracted from the total production for the commingled well. The balance of the production will be attributed to the Fruitland Coal. Attached is the future production decline estimates for the Dakota. Commingling Production Downhole in the subject well from the proposed pools with not reduce the value of the total remaining production.

I hereby certify that the information above is true and complete to the best of my knowledge and belief.

SIGNATURE Mary Corley TITLE Sr. Regulatory Analyst DATE 05/07/2001Type or print name Mary Corley Telephone No. 281-366-4491

(This space for State use)

APPROVED BY Original Signed by [Signature] TITLE DEPUTY OIL & GAS INSPECTOR DATE MAY 17 2001

Conditions of approval, if any:

NH C 403A2

DISTRICT I

P.O. Box 1980, Hobbs, NM 88240

DISTRICT II

311 South First., Artesia, NM 88210

DISTRICT III

1000 Rio Brazos Rd., Aztec, NM 87410

DISTRICT IV

2040 South Pacheco, Santa Fe, NM 87505

State of New Mexico

Energy, Minerals and Natural Resources Department

OIL CONSERVATION DIVISION2040 South Pacheco
Santa Fe, New Mexico 87505

Form C-102

Revised October 18, 1994

Submit to Appropriate District Office

State Lease - 4 Copies

Fee Lease - 3 Copies

WELL LOCATION AND ACREAGE DEDICATION PLAT

API Number 30-045-11619	Pool Code 71599 & 71629	Pool Name Basin Dakota & Basin Fruitland Coal
Property Code 000570	Property Name Gallegos Canyon Unit	Well Number 223
OGRID No. 000778	Operator Name AMOCO PRODUCTION COMPANY	Elevation 5730'

Surface Location

UL or lot no.	Section	Township	Range	Lot. Idn	Feet from the	North/South Line	Feet from the	East/West Line	County
UNIT N	09	28N	12W		795'	SOUTH	1490'	WEST	San Juan

Bottom Hole Location If Different From Surface

UL or lot no.	Section	Township	Range	Lot. Idn	Feet from the	North/South Line	Feet from the	East/West Line	County

Dedicated Acres 340.91 DK 272.56 FC	Joint or Infill	Consolidation Code	Order No.
---	-----------------	--------------------	-----------

**NO ALLOWABLE WILL BE ASSIGNED TO THIS COMPLETION UNTIL ALL INTERESTS HAVE BEEN CONSOLIDATED
OR A NON-STANDARD UNIT HAS BEEN APPROVED BY THE DIVISION**

	OPERATOR CERTIFICATION <i>I hereby certify that the information contained herein is true and complete to the best of my knowledge and belief</i> Signature <i>Mary Corley</i> Printed Name Mary Corley Position Sr. Regulatory Analyst Date 05/02/2001
	SURVEY CERTIFICATION <i>I hereby certify that the well location shown on this plat was plotted from field notes of actual surveys made by me or under my supervision, and that the same is true and correct to the best of my knowledge and belief.</i> 02/09/1966 Date of Survey Signature & Seal of Professional Surveyor James P Leese Certificate No. 1463

**NEW MEXICO OIL CONSERVATION COMMISSION
WELL LOCATION AND ACERAGE DEDICATION PLAT**

All distances must be from the outer boundaries of the Section

Operator PAN AMERICAN PETROLEUM CORPORATION			Lease GALLEGOS CANYON UNIT (DAKOTA)		Well No. 223
Unit Letter N	Section 9	Township 28 NORTH	Range 12 WEST	County SAN JUAN	
Actual Footage Location of Well: 795 feet from the SOUTH line and 1490 feet from the WEST line					
Ground Level Elev. REPORT LATER	Producing Formation DAKOTA		Pool BASIN DAKOTA	Dedicated Acreage: 340.91 Acres	

- Outline the acreage dedicated to the subject well by colored pencil or hachure marks on the plat below.
- If more than one lease is dedicated to the well, outline each and identify the ownership thereof (both as to working interest and royalty).
- If more than one lease of different ownership is dedicated to the well, have the interests of all owners been consolidated by communitization, unitization, force-pooling, etc?

(☒) Yes () No If answer is "yes," type of consolidation Unitization

If answer is "no," list the owners and tract descriptions which have actually consolidated. (Use reverse side of this form if necessary.)

No allowable will be assigned to the well until all interests have been consolidated (by communitization, unitization, forced-pooling, or otherwise) or until a non standard unit, eliminating such interests, has been approved by the Commission.

CERTIFICATION

I hereby certify that the information contained herein is true and complete to the best of my knowledge and belief.

G. W. Eaton, Jr.
Name

G. W. Eaton, Jr.
Position

Area Engineer
Company

PAN AMERICAN PETROLEUM CORP.
Date

February 9, 1966

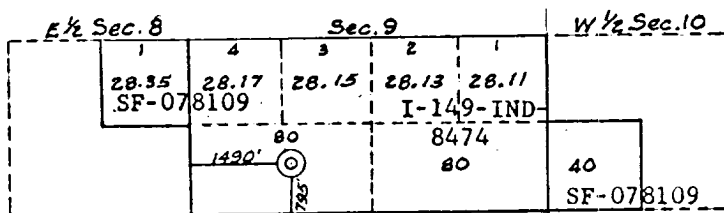

N

I hereby certify that the well location shown on this plat was plotted from field notes of actual surveys made by me or under my supervision, and that the same is true and correct to the best of my knowledge and belief.

February 9, 1966
Date Surveyed

James P. Reese
Registered Professional Engineer
and/or Land Surveyor

JAMES P. REESE
1463
Certificate No. 1463

SCALE - 2 INCHES EQUALS 1 MILE

SAN JUAN ENGINEERING COMPANY, FARMINGTON, N. M.

GCU Well Work Procedure

Well Name:	GCU #223
Date:	2/22/01
SAP Number	X5-xxxxx

Objective:
Recomplete in Fruitland Coal and downhole commingle with Dakota.

Pertinent Information:

Location:	Sec.9, T28N-R12W	Horizon:	Dakota/FC
County:	San Juan	API #:	30-045-11619
State:	New Mexico	Engr:	John Papageorge
Lease:	SF-078109	Phone:	W (281)366-5721
Meter No.	75367		H (713)464-5053
Well Flac:	98569501		

Note: Prior to scheduling rig, confirm that surface facility modifications have been initiated.

1. Check anchors. MIRU.
2. Check and record tubing, casing and bradenhead pressures.
3. Blow down wellhead, kill if necessary with 2% KCL water.
4. Nipple down wellhead, nipple up and pressure test BOP.
5. Tag for fill. Tally out of hole with tubing. Visually inspect. Replace tubing as required.
6. RIH with bit and scraper. Clean out to PBTD as necessary.
7. Set CIBP via tubing at approximately 5700'. Load hole with 2%KCL and pressure test to 500#.
8. Run CBL/GR/CCL across Fruitland Coal interval to verify zonal isolation. (Note DV tool at 1530') Fax results to John Papageorge @ 281-366-7099.
9. Set RBP approximately 150' below bottom of proposed perforations and pressure test.
10. Perforate the following interval with 4JSPF, 120 deg. phasing: **FRLD 1306-1311', 1335-1356'**.
11. RU frac equipment and install WH isolation tool. Fracture stimulate down casing according to schedule 'A'.
12. Flow back frac load until well dies.
13. RIH with bit and tubing. Clean out fill. Pull RBP and drill out CIBP to commingle with Dakota.
14. TIH with 2 3/8" tbg, rods, and pump. Land 1 joint below Dakota perms if possible.
15. RDMO. Hook up to pumping unit and well head compressor.
16. Pump to recover load and test.

GCU #223

Wellbore Diagram

795' FSL x 1490' FWL
Sec. 9, T28N, R12W
San Juan Co., NM

