

UNITED STATES
DEPARTMENT OF THE INTERIOR
BUREAU OF LAND MANAGEMENT

FORM APPROVED
OMB NO. 1004-0135
Expires: November 30, 2000

SUNDRY NOTICES AND REPORTS ON WELLS
Do not use this form for proposals to drill or to re-enter an abandoned well. Use form 3160-3 (APD) for such proposals.

SUBMIT IN TRIPLICATE - Other instructions on reverse side.

1. Type of Well <input type="checkbox"/> Oil Well <input checked="" type="checkbox"/> Gas Well <input type="checkbox"/> Other		7. If Unit or CA/Agreement, Name and/or No. NMNM78391C
2. Name of Operator AMOCO PRODUCTION COMPANY		8. Well Name and No. GALLEGOS CANYON 223
3a. Address P. O. BOX 3092 HOUSTON, TX 77253	3b. Phone No. (include area code) Ph: 281.366.4491	9. API Well No. 30-045-11619-00-S1
4. Location of Well (Footage, Sec., T., R., M., or Survey Description) Sec 9 T28N R12W Mer SESW 0795FSL 1490FWL 36.67162 N Lat, 108.12026 W Lon		10. Field and Pool, or Exploratory UNNAMED
		11. County or Parish, and State SAN JUAN COUNTY, NM

12. CHECK APPROPRIATE BOX(ES) TO INDICATE NATURE OF NOTICE, REPORT, OR OTHER DATA

TYPE OF SUBMISSION	TYPE OF ACTION			
<input checked="" type="checkbox"/> Notice of Intent	<input type="checkbox"/> Acidize	<input type="checkbox"/> Deepen	<input type="checkbox"/> Production (Start/Resume)	<input type="checkbox"/> Water Shut-Off
<input type="checkbox"/> Subsequent Report	<input type="checkbox"/> Alter Casing	<input type="checkbox"/> Fracture Treat	<input type="checkbox"/> Reclamation	<input type="checkbox"/> Well Integrity
<input type="checkbox"/> Final Abandonment Notice	<input type="checkbox"/> Casing Repair	<input type="checkbox"/> New Construction	<input type="checkbox"/> Recomplete	<input checked="" type="checkbox"/> SUBCOM
	<input type="checkbox"/> Change Plans	<input type="checkbox"/> Plug and Abandon	<input type="checkbox"/> Temporarily Abandon	
	<input type="checkbox"/> Convert to Injection	<input type="checkbox"/> Plug Back	<input type="checkbox"/> Water Disposal	

13. Describe Proposed or Completed Operation (clearly state all pertinent details, including estimated starting date of any proposed work and approximate duration thereof. If the proposal is to deepen directionally or recompleting horizontally, give subsurface locations and measured and true vertical depths of all pertinent markers and zones. Attach the Bond under which the work will be performed or provide the Bond No. on file with BLM/BIA. Required subsequent reports shall be filed within 30 days following completion of the involved operations. If the operation results in a multiple completion or recompleting in a new interval, a Form 3160-4 shall be filed once testing has been completed. Final Abandonment Notices shall be filed only after all requirements, including reclamation, have been completed, and the operator has determined that the site is ready for final inspection.)

Amoco Production Company request permission to complete the subject well into the Basin Fruitland Coal and commingle production downhole with the existing Basin Dakota Pool as per the attached procedure. The Basin Dakota (71599) & the Basin Fruitland Coal (71629) Pools are Pre-Approved for Downhole Commingling per NMOCD Order R - 11363. Although the interest owners are not identical between these two Pools, NMOCD CASE NO. 12520, ORDER NO. R-11567 effective 04/26/2001, established approval for subsequent applications for the downhole commingling of production in wellbores within the Gallegos Canyon Unit without notice to the unit interest owners, therefore, additional notification is required prior to downhole commingling approval. Production is proposed to be allocated based on the subtraction method using the projected future decline for production from the Dakota. That production shall serve as a base for production subtracted from the total production for the commingled well. The balance of the production will be attributed to the Fruitland Coal. Attached is the future production decline estimates for the Dakota. Commingling Production Downhole in the subject well from the proposed pools with not reduce the value of the total remaining production.

DHC 403 A2, 5-21-1

14. I hereby certify that the foregoing is true and correct. Electronic Submission #4214 verified by the BLM Well Information System For AMOCO PRODUCTION COMPANY, sent to the Farmington Committed to AFMSS for processing by Maurice Johnson on 05/17/2001 (01MXJ1884SE)	
Name (Printed/Typed) (None Specified)	Title
Signature	Date 05/14/2001

THIS SPACE FOR FEDERAL OR STATE OFFICE USE

Approved By <i>/s/ Jim Lovato</i>	Title	Date
Conditions of approval, if any, are attached. Approval of this notice does not warrant or certify that the applicant holds legal or equitable title to those rights in the subject lease which would entitle the applicant to conduct operations thereon.		Office

Title 18 U.S.C. Section 1001 and Title 43 U.S.C. Section 1212, make it a crime for any person knowingly and willfully to make to any department or agency of the United States any false, fictitious or fraudulent statements or representations as to any matter within its jurisdiction.

**** REVISED ** REVISED ** REVISED ** REVISED ** REVISED ** REVISED ** REVISED ** REVISED ****



**NEW MEXICO OIL CONSERVATION COMMISSION
WELL LOCATION AND ACERAGE DEDICATION PLAT**

All distances must be from the outer boundaries of the Section

Operator PAN AMERICAN PETROLEUM CORPORATION			Lease GALLEGOS CANYON UNIT "(DAKOTA)"		Well No. 223
Unit Letter N	Section 9	Township 28 NORTH	Range 12 WEST	County SAN JUAN	
Actual Footage Location of Well: 795 feet from the SOUTH line and 1490 feet from the WEST line					
Ground Level Elev. REPORT LATER	Producing Formation DAKOTA		Pool BASIN DAKOTA	Dedicated Acreage: 340.91 Acres	

Outline the acreage dedicated to the subject well by colored pencil or hatchure marks on the plat below.

- If more than one lease is dedicated to the well, outline each and identify the ownership thereof (both as to working interest and royalty),
- If more than one lease of different ownership is dedicated to the well, have the interests of all owners been consolidated by communitization, unitization, force-pooling, etc?

(☒) Yes (No If answer is "yes," type of consolidation: Unitization

If answer is "no," list the owners and tract descriptions which have actually consolidated. (Use reverse side of this form if necessary.) _____

No allowable will be assigned to the well until all interests have been consolidated (by communitization, unitization, forced-pooling, or otherwise) or until a non standard unit, eliminating such interests, has been approved by the Commission.

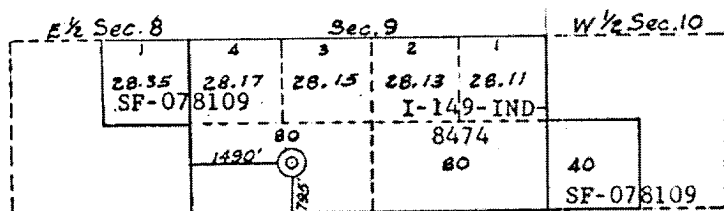

N

SCALE-2 INCHES EQUALS 1 MILE

SAN JUAN ENGINEERING COMPANY, FARMINGTON, N. M.

CERTIFICATION

I hereby certify that the information contained herein is true and complete to the best of my knowledge and belief.

G. W. Eaton, Jr.
Name
G. W. Eaton, Jr.
Position
Area Engineer
Company
PAN AMERICAN PETROLEUM CORP.
Date
February 9, 1966

I hereby certify that the well location shown on this plat was plotted from field notes of actual surveys made by me or under my supervision, and that the same is true and correct to the best of my knowledge and belief.

February 9, 1966
Date Surveyed
James P. Reese
Registered Professional Engineer
and/or Land Surveyor
JAMES P. REESE
1463
Certificate No. _____

DISTRICT I

P.O. Box 1980, Hobbs, NM 88240

DISTRICT II

311 South First., Artesia, NM 88210

DISTRICT III

1000 Rio Brazos Rd., Aztec, NM 87410

DISTRICT IV

2040 South Pacheco, Santa Fe, NM 87505

State of New Mexico
 Energy, Minerals and Natural Resources Department

OIL CONSERVATION DIVISION

2040 South Pacheco
 Santa Fe, New Mexico 87505

Form C-102**Revised October 18, 1994**

Submit to Appropriate District Office

State Lease - 4 Copies

Fee Lease - 3 Copies

WELL LOCATION AND ACREAGE DEDICATION PLAT

API Number 30-045-11619	Pool Code 71599 & 71629	Pool Name Basin Dakota & Basin Fruitland Coal
Property Code 000570	Property Name Gallegos Canyon Unit	Well Number 223
OGRID No. 000778	Operator Name AMOCO PRODUCTION COMPANY	Elevation 5730'

Surface Location

UL or lot no.	Section	Township	Range	Lot. Idn	Feet from the	North/South Line	Feet from the	East/West Line	County
UNIT N	09	28N	12W		795'	SOUTH	1490'	WEST	San Juan

Bottom Hole Location If Different From Surface

UL or lot no.	Section	Township	Range	Lot. Idn	Feet from the	North/South Line	Feet from the	East/West Line	County
Dedication Area 340.91 DK 272.56 FC	Joint or Infill	Consolidation Code		Order No.					

**NO ALLOWABLE WILL BE ASSIGNED TO THIS COMPLETION UNTIL ALL INTERESTS HAVE BEEN CONSOLIDATED
 OR A NON-STANDARD UNIT HAS BEEN APPROVED BY THE DIVISION**

	OPERATOR CERTIFICATION	
	I hereby certify that the information contained herein is true and complete to the best of my knowledge and belief	
	Signature	<i>Mary Corley</i>
	Printed Name	Mary Corley
	Position	Sr. Regulatory Analyst
	Date	05/02/2001
	SURVEY CERTIFICATION	
	I hereby certify that the well location shown on this plat was plotted from field notes of actual surveys made by me or under my supervision, and that the same is true and correct to the best of my knowledge and belief.	
	Date of Survey	
	Signature & Seal of Professional Surveyor	
James P Leese		
Certificate No.		
1463		

Gallegos Canyon Unit # 223

Well Work Procedure

Objective:

Recomplete in Fruitland Coal and downhole commingle with Dakota.

Note: Prior to scheduling rig, confirm that surface facility modifications have been initiated.

1. Check anchors. MIRU.
2. Check and record tubing, casing and bradenhead pressures.
3. Blow down wellhead, kill if necessary with 2% KCL water.
4. Nipple down wellhead, nipple up and pressure test BOP.
5. Tag for fill. Tally out of hole with tubing. Visually inspect. Replace tubing as required.
6. RIH with bit and scraper. Clean out to PBTD as necessary.
7. Set CIBP via tubing at approximately 5700'. Load hole with 2%KCL and pressure test to 500#.
8. Run CBL/GR/CCL across Fruitland Coal interval to verify zonal isolation. (Note DV tool at 1530') Fax results to John Papageorge @ 281-366-7099.
9. Set RBP approximately 150' below bottom of proposed perforations and pressure test.
10. Perforate the following interval with 4JSPF, 120 deg. phasing: **FRLD 1306-1311', 1335-1356'**.
11. RU frac equipment and install WH isolation tool. Fracture stimulate down casing according to schedule 'A'.
12. Flow back frac load until well dies.
13. RIH with bit and tubing. Clean out fill. Pull RBP and drill out CIBP to commingle with Dakota.
14. TIH with 2 3/8" tbg, rods, and pump. Land 1 joint below Dakota perms if possible.
15. RDMO. Hook up to pumping unit and well head compressor.
16. Pump to recover load and test.

GCU #223
Wellbore Diagram

795' FSL x 1490' FWL
Sec. 9, T28N, R12W
San Juan Co., NM

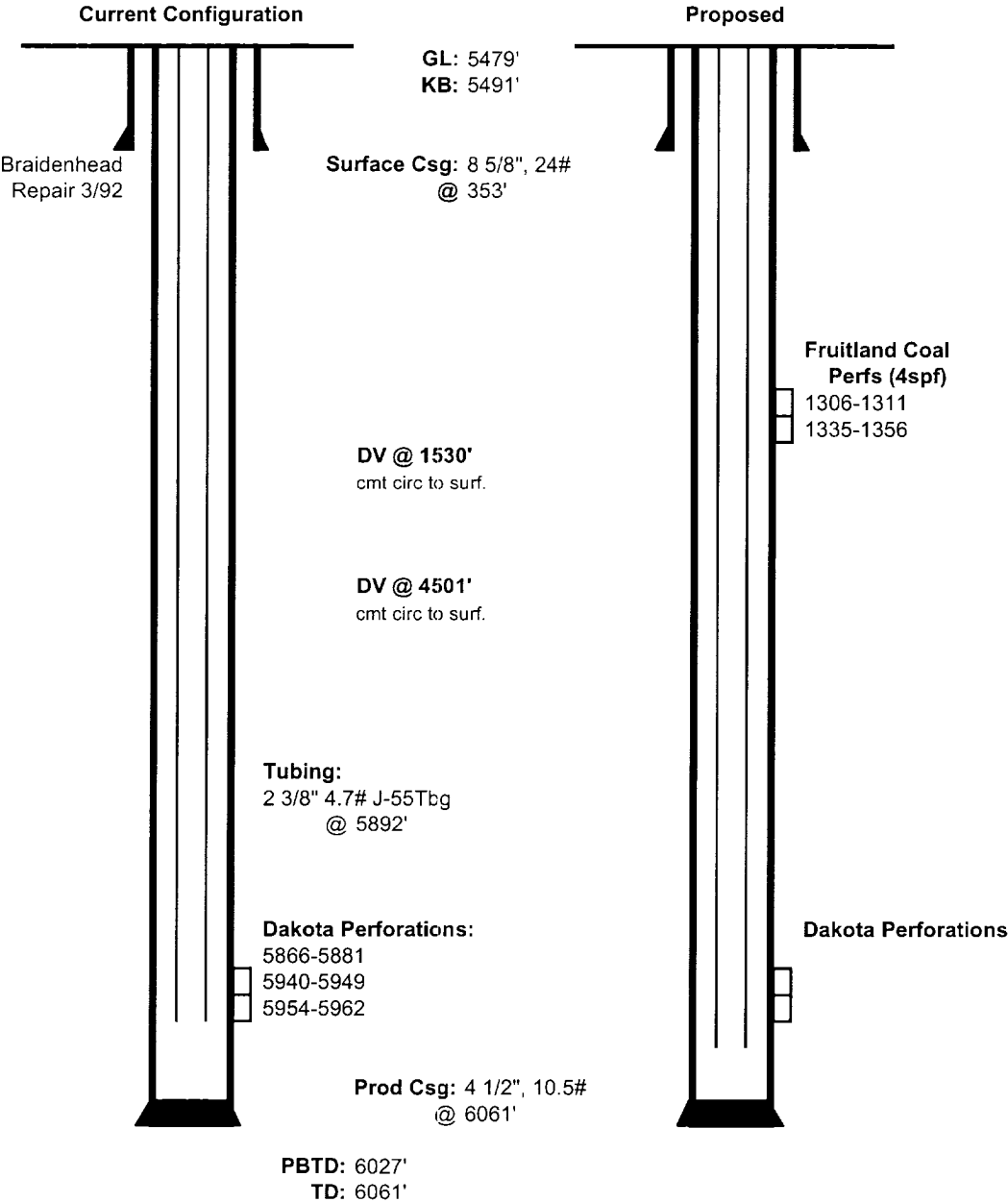

Gallegos Canyon Unit 223 **Future Production Decline Estimate** **(Monthly Factor .277%)**

$\ln(Q_i/Q_o) = -dt$
 $Q_i = 15 \text{ MCFD } (10/2000)$
 $Q_o = 12 \text{ MCFD } (03/2001)$
 $t = 6 \text{ months } (.41666 \text{ yrs})$
 $d = 0.32 \text{ annual decline}$
 $0.027 \text{ monthly decline } (0.32/12)$

Corrected Volumes

$12/15 = 0.80000$
 $.80 * .41666 = .333328$
 0.027777333

Month	Gas Volume
Jan-2000	16
Feb-2000	17
Mar-2000	36
Apr-2000	21
May-2000	19
Jun-2000	24
Jul-2000	13
Aug-2000	12
Sep-2000	16
Oct-2000	15
Nov-2000	23
Dec-2000	25
Jan-2001	21
Feb-2001	16
Mar-2001	12
Apr-2001	14
May-2001	14
Jun-2001	14
Jul-2001	14
Aug-2001	14
Sep-2001	14
Oct-2001	14
Nov-2001	14
Dec-2001	14
Jan-2002	14
Feb-2002	14
Mar-2002	14
Apr-2002	14
May-2002	14
Jun-2002	14
Jul-2002	13
Aug-2002	13
Sep-2002	13
Oct-2002	13
Nov-2002	13
Dec-2002	13

Month	Gas Volume
Jan-2003	13
Feb-2003	13
Mar-2003	13
Apr-2003	13
May-2003	13
Jun-2003	13
Jul-2003	13
Aug-2003	13
Sep-2003	13
Oct-2003	13
Nov-2003	13
Dec-2003	13
Jan-2004	13
Feb-2004	13
Mar-2004	13
Apr-2004	13
May-2004	13
Jun-2004	13
Jul-2004	13
Aug-2004	13
Sep-2004	13
Oct-2004	13
Nov-2004	13
Dec-2004	13
Jan-2005	12
Feb-2005	12
Mar-2005	12
Apr-2005	12
May-2005	12
Jun-2005	12
Jul-2005	12
Aug-2005	12
Sep-2005	12
Oct-2005	12
Nov-2005	12
Dec-2005	12

Month	Gas Volume
Jan-2006	12
Feb-2006	12
Mar-2006	12
Apr-2006	12
May-2006	12
Jun-2006	12
Jul-2006	12
Aug-2006	12
Sep-2006	12
Oct-2006	12
Nov-2006	12
Dec-2006	12
Jan-2007	12
Feb-2007	12
Mar-2007	11
Apr-2007	11
May-2007	11
Jun-2007	11
Jul-2007	11
Aug-2007	11
Sep-2007	11
Oct-2007	11
Nov-2007	11
Dec-2007	11
Jan-2008	11
Feb-2008	11
Mar-2008	11
Apr-2008	11
May-2008	11
Jun-2008	11
Jul-2008	11
Aug-2008	11
Sep-2008	11
Oct-2008	11
Nov-2008	11
Dec-2008	11

Gallegos Canyon Unit 223
Future Production Decline Estimate
(Monthly Factor .277%)

Month	Gas Volume
Jan-2009	11
Feb-2009	11
Mar-2009	11
Apr-2009	11
May-2009	11
Jun-2009	10
Jul-2009	10
Aug-2009	10
Sep-2009	10
Oct-2009	10
Nov-2009	10
Dec-2009	10
Jan-2010	10
Feb-2010	10
Mar-2010	10
Apr-2010	10
May-2010	10
Jun-2010	10
Jul-2010	10
Aug-2010	10
Sep-2010	10
Oct-2010	10
Nov-2010	10
Dec-2010	10
Jan-2011	10
Feb-2011	10
Mar-2011	10
Apr-2011	10
May-2011	10
Jun-2011	10
Jul-2011	10
Aug-2011	10
Sep-2011	10
Oct-2011	10
Nov-2011	9
Dec-2011	9

Month	Gas Volume
Jan-2012	9
Feb-2012	9
Mar-2012	9
Apr-2012	9
May-2012	9
Jun-2012	9
Jul-2012	9
Aug-2012	9
Sep-2012	9
Oct-2012	9
Nov-2012	9
Dec-2012	9
Jan-2013	9
Feb-2013	9
Mar-2013	9
Apr-2013	9
May-2013	9
Jun-2013	9
Jul-2013	9
Aug-2013	9
Sep-2013	9
Oct-2013	9
Nov-2013	9
Dec-2013	9
Jan-2014	9
Feb-2014	9
Mar-2014	9
Apr-2014	9
May-2014	9
Jun-2014	9
Jul-2014	9
Aug-2014	9
Sep-2014	9
Oct-2014	9
Nov-2014	8
Dec-2014	8

Month	Gas Volume
Jan-2015	8
Feb-2015	8
Mar-2015	8
Apr-2015	8
May-2015	8
Jun-2015	8
Jul-2015	8
Aug-2015	8
Sep-2015	8
Oct-2015	8
Nov-2015	8
Dec-2015	8
Jan-2016	8
Feb-2016	8
Mar-2016	8
Apr-2016	8
May-2016	8
Jun-2016	8
Jul-2016	8
Aug-2016	8
Sep-2016	8
Oct-2016	8
Nov-2016	8
Dec-2016	8
Jan-2017	8
Feb-2017	8
Mar-2017	8
Apr-2017	8
May-2017	8
Jun-2017	8
Jul-2017	8
Aug-2017	8
Sep-2017	8
Oct-2017	8
Nov-2017	8
Dec-2017	8

Month	Gas Volume
Jan-2018	8
Feb-2018	8
Mar-2018	7
Apr-2018	7
May-2018	7
Jun-2018	7
Jul-2018	7
Aug-2018	7
Sep-2018	7
Oct-2018	7
Nov-2018	7
Dec-2018	7
Jan-2019	7
Feb-2019	7
Mar-2019	7
Apr-2019	7
May-2019	7
Jun-2019	7
Jul-2019	7
Aug-2019	7
Sep-2019	7
Oct-2019	7
Nov-2019	7
Dec-2019	7
Jan-2020	7
Feb-2020	7
Mar-2020	7
Apr-2020	7
May-2020	7
Jun-2020	7
Jul-2020	7
Aug-2020	6
Sep-2020	6
Oct-2020	6
Nov-2020	6
Dec-2020	6

Gallegos Canyon Unit 223
Future Production Decline Estimate
(Monthly Factor .277%)

Month	Gas Volume
Jan-2021	6
Feb-2021	6
Mar-2021	6
Apr-2021	6
May-2021	6
Jun-2021	6
Jul-2021	6
Aug-2021	6
Sep-2021	6
Oct-2021	6
Nov-2021	6
Dec-2021	6
Jan-2022	6
Feb-2022	6
Mar-2022	6
Apr-2022	6
May-2022	6
Jun-2022	6
Jul-2022	6
Aug-2022	6
Sep-2022	6
Oct-2022	6
Nov-2022	6
Dec-2022	6
Jan-2023	6
Feb-2023	6
Mar-2023	6
Apr-2023	6
May-2023	5
Jun-2023	5
Jul-2023	5
Aug-2023	5
Sep-2023	5
Oct-2023	5
Nov-2023	5
Dec-2023	5

Month	Gas Volume
Jan-2024	5
Feb-2024	5
Mar-2024	5
Apr-2024	5
May-2024	5
Jun-2024	5
Jul-2024	5
Aug-2024	5
Sep-2024	5
Oct-2024	5
Nov-2024	5
Dec-2024	5
Jan-2025	5
Feb-2025	5
Mar-2025	5
Apr-2025	5
May-2025	5
Jun-2025	5
Jul-2025	5
Aug-2025	5
Sep-2025	5
Oct-2025	5
Nov-2025	5
Dec-2025	5
Jan-2026	5
Feb-2026	5
Mar-2026	5
Apr-2026	5
May-2026	5
Jun-2026	5
Jul-2026	5
Aug-2026	5
Sep-2026	4
Oct-2026	4
Nov-2026	4
Dec-2026	4

Month	Gas Volume
Jan-2027	4
Feb-2027	4
Mar-2027	4
Apr-2027	4
May-2027	4
Jun-2027	4
Jul-2027	4
Aug-2027	4
Sep-2027	4
Oct-2027	4
Nov-2027	4
Dec-2027	4
Jan-2028	4
Feb-2028	4
Mar-2028	4
Apr-2028	4
May-2028	4
Jun-2028	4
Jul-2028	4
Aug-2028	4
Sep-2028	4
Oct-2028	4
Nov-2028	4
Dec-2028	4
Jan-2029	4
Feb-2029	4
Mar-2029	4
Apr-2029	4
May-2029	4
Jun-2029	4
Jul-2029	4
Aug-2029	4
Sep-2029	4
Oct-2029	4
Nov-2029	4
Dec-2029	4

Month	Gas Volume
Jan-2030	4
Feb-2030	4
Mar-2030	4
Apr-2030	4
May-2030	4
Jun-2030	4
Jul-2030	4
Aug-2030	4
Sep-2030	4
Oct-2030	3
Nov-2030	3
Dec-2030	3
Jan-2031	3
Feb-2031	3
Mar-2031	3
Apr-2031	3
May-2031	3
Jun-2031	3
Jul-2031	3
Aug-2031	3
Sep-2031	3
Oct-2031	3
Nov-2031	3
Dec-2031	3
Jan-2032	3
Feb-2032	3
Mar-2032	3
Apr-2032	3
May-2032	3
Jun-2032	3
Jul-2032	3
Aug-2032	3
Sep-2032	3
Oct-2032	3
Nov-2032	3
Dec-2032	3