

OIL CONSERVATION COMMISSION
3 DISTRICT

OIL CONSERVATION COMMISSION
BOX 871
SANTA FE, NEW MEXICO

DATE 2-21-66

Re: Proposed NSP _____

Proposed NWU ✓

Proposed NSL _____

Proposed NFO _____

Proposed DC _____

Gentlemen:

I have examined the application dated 2-16-66
for the Pan American Pet. Corp. Allegre Canyon Unit #126-828-12
Operator Lease and Well No. S-T-R

and my recommendations are as follows:

Approved

Yours very truly,

Ernest C. Arnold

PAN AMERICAN PETROLEUM CORPORATION

SECURITY LIFE BUILDING

DENVER, COLORADO 80202

PRODUCING DEPARTMENT
H. T. HUNTER
DIVISION PRODUCTION
MANAGER

DISTRICT SUPERINTENDENTS
W. M. JONES
A. E. PIPER
T. M. CURTIS
JOINT INTEREST
SUPERINTENDENT
S. B. RICHARDS

February 16, 1966

File: TMC-76-WF

Re: Non-Standard Dakota Gas Unit
Gallegos Canyon Unit - Dakota
Well No. 226

Mr. A. L. Porter, Jr. (3)
New Mexico Oil Conservation Commission
P. O. Box 2038
Santa Fe, New Mexico

Dear Sir:

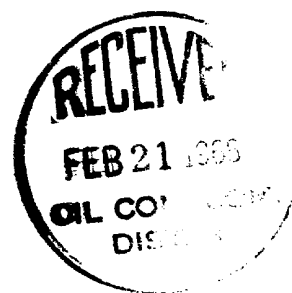

Pan American Petroleum Corporation respectfully requests administrative approval of the non-standard gas proration unit for the Gallegos Canyon Unit - Dakota Well No. 226 W/2 Section 8, T28N-R12W consisting of 304.28 acres.

In accordance with the provisions of Rule 5(B) of Item A, Well Location and Acreage Requirements, under the Special Rules and Regulations for the Basin Dakota Gas Pool of NMOCC Order No. R-1670-C, the requested non-standard proration unit is due to the unorthodox size of the tract due to variation in the legal subdivisions of the United States Public Lands Survey. The following provisions are complied with:

1. The non-standard unit consists of contiguous lots and quarter-quarter sections.
2. The non-standard unit lies wholly within a governmental section.
3. The entire non-standard unit may reasonably be presumed to be productive of gas.
4. The length or width of the non-standard unit does not exceed 5280 feet.

The requested 304.28 acre non-standard gas proration unit is necessitated by the occurrence of lots smaller than 40 acres along the western edge of Section 18, T28N-R12W. A map showing the proposed location of the well in relation to other Basin Dakota Pool Wells is attached, which indicates that the entire non-standard unit may reasonably be presumed to be productive of gas. A copy of

Page 2
File: TMC-76-WF

NMOCC Form C-128 (Well Location and Acreage Dedication Plot) shows the proposed location 790 feet from the west line and 1190 feet from the south line of Section 18 in the proposed W/2 Section 18 gas unit.

Since this well and its respective spacing unit lies well within the boundaries of the Gallegos Canyon Unit, all interests in nearby acreage have been unitized. Therefore, Pan American is acting on behalf of all operators and ratification and waivers of offset operators is not required.

Yours very truly,

A handwritten signature in cursive script, appearing to read 'T. M. Curtis', written in dark ink.

T. M. Curtis

Attachment

cc: Mr. E. C. Arnold
New Mexico Oil Conservation Commission
Aztec, New Mexico

**NEW MEXICO OIL CONSERVATION COMMISSION
WELL LOCATION AND ACERAGE DEDICATION PLAT**

All distances must be from the outer boundaries of the Section

Operator PAN AMERICAN PETROLEUM CORPORATION			Lease GALLEGOS CANYON UNIT*DAKOTA		Well No. 226
Unit Letter M	Section 18	Township 28 NORTH	Range 12 WEST	County SAN JUAN	
Actual Footage Location of Well: 1190 feet from the SOUTH line and 790 feet from the WEST line					
Ground Level Elev. Report Later	Producing Formation Dakota	Pool Basin Dakota	Dedicated Acreage: 304.28 Acres		

1. Outline the acreage dedicated to the subject well by colored pencil or hachure marks on the plat below.
2. If more than one lease is dedicated to the well, outline each and identify the ownership thereof (both as to working interest and royalty),
3. If more than one lease of different ownership is dedicated to the well, have the interests of all owners been consolidated by communitization, unitization, force-pooling, etc?

(☒) Yes () No If answer is "yes," type of consolidation Unitization

If answer is "no," list the owners and tract descriptions which have actually consolidated. (Use reverse side of this form if necessary.)

No allowable will be assigned to the well until all interests have been consolidated (by communitization, unitization, forced-pooling, or otherwise) or until a non standard unit, eliminating such interests, has been approved by the Commission.

CERTIFICATION

I hereby certify that the information contained herein is true and complete to the best of my knowledge and belief.

G. W. Eaton, Jr.
Name
G. W. Eaton, Jr.
Position
Area Engineer
Company
PAN AMERICAN PETROLEUM CORP.
Date
February 8, 1966

I hereby certify that the well location shown on this plat was plotted from field notes of actual surveys made by me or under my supervision, and that the same is true and correct to the best of my knowledge and belief.

January 28, 1966
Date Surveyed
James P. Leese
Registered Professional Engineer
and/or Land Surveyor
James P. Leese
San Juan Engineering Company
Certificate No. 1467

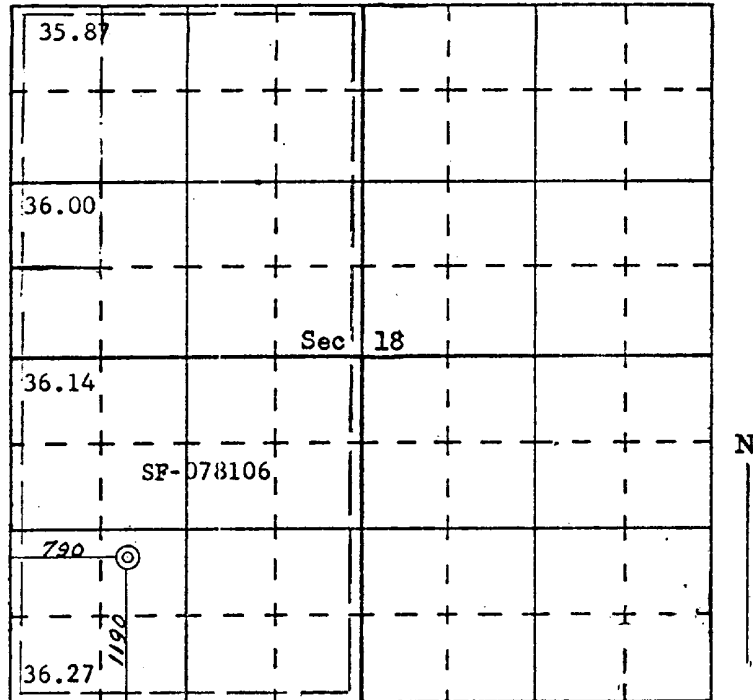

SCALE—4 INCHES EQUALS 1 MILE

SAN JUAN ENGINEERING COMPANY, FARMINGTON, N. M.

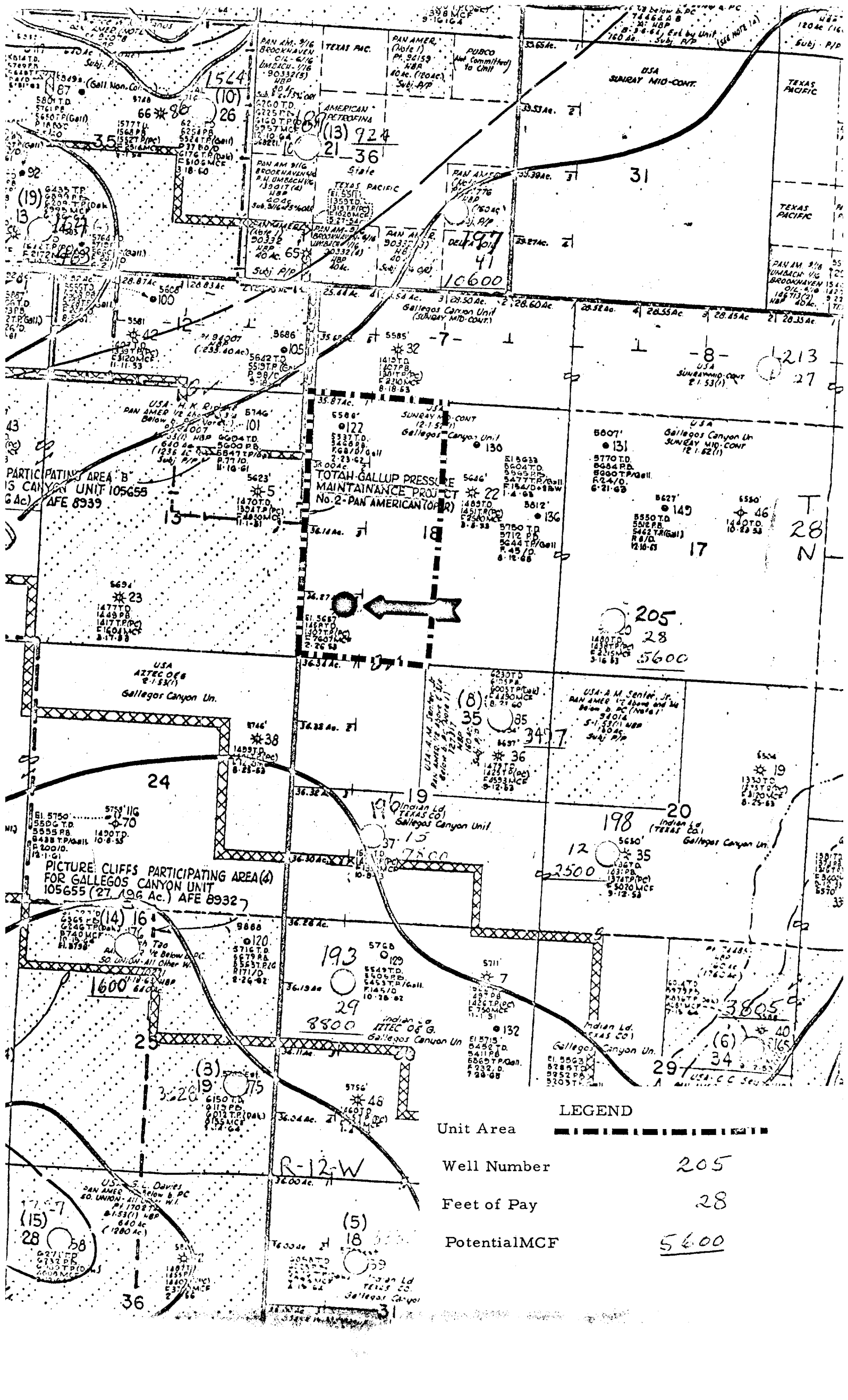

UNIT AREA
WELL NUMBER
FEET OF PAY
POTENTIAL MCF

205
28
5600