

(SUBMIT IN TRIPLICATE)

UNITED STATES
DEPARTMENT OF THE INTERIOR
GEOLOGICAL SURVEY

Land Office Santa Fe
Lease No. M-09979
Unit Robinson

SUNDRY NOTICES AND REPORTS ON WELLS

NOTICE OF INTENTION TO DRILL.....	<input checked="" type="checkbox"/>	SUBSEQUENT REPORT OF WATER SHUT-OFF.....
NOTICE OF INTENTION TO CHANGE PLANS.....		SUBSEQUENT REPORT OF SHOOTING OR ACIDIZING.....
NOTICE OF INTENTION TO TEST WATER SHUT-OFF.....		SUBSEQUENT REPORT OF ALTERING CASING.....
NOTICE OF INTENTION TO RE-DRILL OR REPAIR WELL.....		SUBSEQUENT REPORT OF RE-DRILLING OR REPAIR.....
NOTICE OF INTENTION TO SHOOT OR ACIDIZE.....		SUBSEQUENT REPORT OF ABANDONMENT.....
NOTICE OF INTENTION TO PULL OR ALTER CASING.....		SUPPLEMENTARY WELL HISTORY.....
NOTICE OF INTENTION TO ABANDON WELL.....		

(INDICATE ABOVE BY CHECK MARK NATURE OF REPORT, NOTICE, OR OTHER DATA)

October 21, 1960

Well No. 5-0 is located 800 ft. from S line and 730 ft. from E line of sec. 15

SE 1/4, Section 15
(1/4 Sec. and Sec. No.)

28N
(Twp.)

13W
(Range)

N.M.P.M.
(Meridian)

Undesignated
(Field)

San Juan
(County or Subdivision)

New Mexico
(State or Territory)

The elevation of the derrick floor above sea level is 6061 ft. (Ground Elevation)

DETAILS OF WORK

(State names of and expected depths to objective sands; show sizes, weights, and lengths of proposed casings; indicate how they will be cemented; and all other important proposed work)

Propose to: Set 300 feet of 8 1/8" surface casing and cement to surface.

Drill with rotary to approximate total depth of 3860 feet or through Gallup formation. Run 4 1/2" production casing to total depth and cement with 250 cu. Set two-stage cement collar approximately 200 feet below Pictured Cliffs formation and cement with 150 cu.

Perforate Gallup formation with four shots per foot.
Sand-Oil frac with approximately 30,000 gal oil and 30,000 gal sand.

Run 2 3/8" tubing.
SE 1/4, 40 acres, Section 15 dedicated to well.

I understand that this plan of work must receive approval in writing by the Geological Survey before operations may be commenced.

Company Arco Oil and Gas Company

Address P. O. Drawer 570

Farmington, New Mexico

ORIGINAL SIGNED BY JOE C. SALMON
By J. C. Salmon
Title District Superintendent

NEW MEXICO OIL CONSERVATION COMMISSION

Well Location and Acreage Dedication Plat

SECTION A.

Date October 21, 1960

Operator Artex Oil and Gas Company Lease Robinson
Well No. 5-8 Unit Letter P Section 15 Township 28N Range 13W NMPM
Located 800 Feet From South Line, 730 Feet From East Line
County San Juan G. L. Elevation 6083 Dedicated Acreage 40 Acres
Name of Producing Formation Gallup Pool Undesignated

1. Is the Operator the only owner* in the dedicated acreage outlined on the plat below? Yes XXX No _____
2. If the answer to question One is "No," have the interests of all the owners been consolidated by communitization agreement or otherwise? Yes _____ No _____ If answer is "Yes," Type of Consolidation _____
3. If the answer to question Two is "No," list all the owners and their respective interests below:

OWNER

LAND DESCRIPTION

SECTION B.

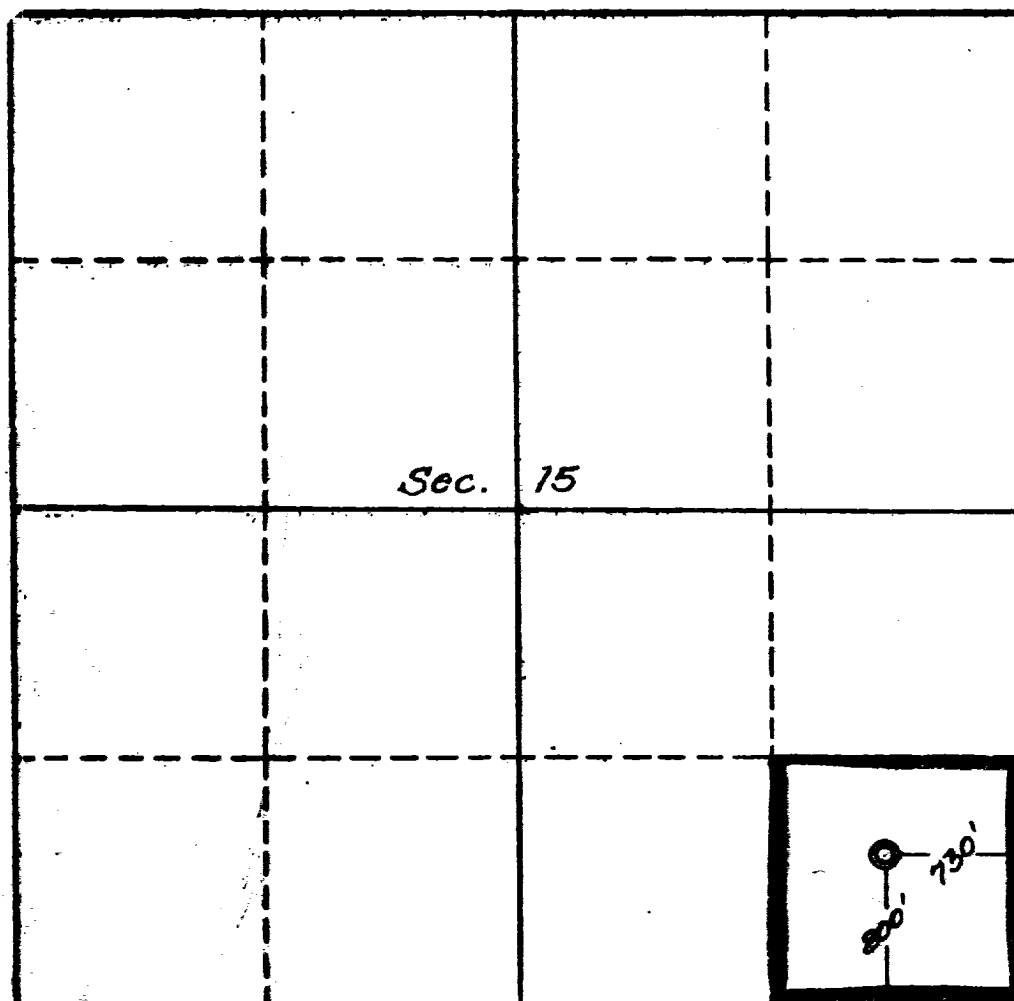

This is to certify that the information in Section A above is true and complete to the best of my knowledge and belief.

Artex Oil and Gas Company
(OPERATOR)

ORIGINAL SIGNED BY JOE C. SALMON
(REPRESENTATIVE)

Drawer 570, Farmington, N.M.

This is to certify that the information shown on the plat in Section B was placed on file by me or under my supervision and that the same is true and correct to the best of my knowledge and belief.

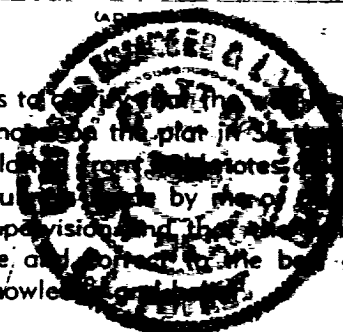

Date Surveyed Oct. 19, 1960

Four States Engineering Co.
FARMINGTON, NEW MEXICO

C. J. Totah
REGISTERED ENGINEER OR
LAND SURVEYOR

Certificate No. 3084

