

OIL CONSERVATION COMMISSION

P. O. BOX 2088

SANTA FE, NEW MEXICO 87501

December 29, 1977

Walsh Engineering & Prod. Corp.  
P. O. Box 254  
Farmington, New Mexico 87401

Administrative Order NSL-914

Gentlemen:

Reference is made to your application on behalf of R & G Drilling Company for approval of a non-standard location for their Krause Well No. 65 to be drilled 1190 feet from the North line and 2050 feet from the West line of Section 33, Township 28 North, Range 11 West, NMPM, Rutz-Fruitland Pool, San Juan County, New Mexico.

By authority granted me under the provisions of Rule 104 F of the Commission Rules and Regulations, the above-described unorthodox location is hereby approved.

Very truly yours,

JOE D. RAMEY  
Secretary-Director

JDR/ALS/jr

cc: U.S. Geological Survey - Farmington  
Oil & Gas Engineering Committee - Hobbs  
Oil Conservation Commission - Aztec

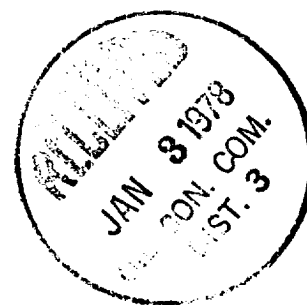

UNITED STATES PATENT OFFICE

951,000

APPROVED FOR PATENT

UNITED STATES PATENT OFFICE

UNITED STATES PATENT OFFICE

UNITED STATES PATENT OFFICE

UNITED STATES PATENT OFFICE

UNITED STATES PATENT OFFICE

UNITED STATES PATENT OFFICE

UNITED STATES PATENT OFFICE

UNITED STATES PATENT OFFICE

UNITED STATES PATENT OFFICE

UNITED STATES PATENT OFFICE



OIL CONSERVATION COMMISSION  
Cuyler DISTRICT

OIL CONSERVATION COMMISSION  
BOX 2088  
SANTA FE, NEW MEXICO

DATE 12-22-77

RE: Proposed MC \_\_\_\_\_  
Proposed DHC \_\_\_\_\_  
Proposed NSL ✓ \_\_\_\_\_  
Proposed SWD \_\_\_\_\_  
Proposed WFX \_\_\_\_\_  
Proposed PMX \_\_\_\_\_

Gentlemen:

I have examined the application dated 12-22-77  
for the RFC Drilling Co. Lease #65 C-33-28N-11W  
Operator Lease and Well No. Unit, S-T-R

and my recommendations are as follows:

Approve  
\_\_\_\_\_  
\_\_\_\_\_  
\_\_\_\_\_  
\_\_\_\_\_  
\_\_\_\_\_

Yours very truly,

AR Jendrick

# Walsh

ENGINEERING & PRODUCTION CORP.

PETROLEUM ENGINEERING  
RESERVOIR STUDIES  
EVALUATIONS  
GEOLOGICAL STUDIES  
LEASE MANAGEMENT  
CONTRACT PUMPING  
DRILLING SUPERVISION  
WORKOVER SUPERVISION

EWELL N. WALSH, P.E.  
President

December 22, 1977



Mr. Joe D. Ramey  
Secretary Director  
New Mexico Oil Conservation Commission  
P.O. Box 2088  
Santa Fe, NM 87501

Ref: R&G Drilling Company  
Krause No. 65  
1190'FNL, 2050'FWL  
Unit C Section 33-T28N-R11W  
San Juan County, New Mexico  
Lease No. SF-078863

Dear Mr. Ramey:

This is a request on behalf of the above-referred-to operator for approval of an unorthodox location.

The location is unorthodox due to the following reason:

An orthodox location would be in or to close for Bureau of Land Management approval to the canal transporting water to the Navajo Irrigation Project. (See attached copy of topography map indicating the position of the location of the canal.)

R&G Drilling Company is owner of all the leases adjacent to and joining the dedicated 160 acres to the well. Therefore, no plat is submitted.

Attached you will find the following:

1. Well location and Acreage Dedication Plat
2. Topography map indicating the position of the well.

# Ways

ENGINEERING & PRODUCTION CORP.

EMELI H. WILSON P.E.  
President

PETROLEUM & MINING  
EXPLORATION  
EVALUATION  
PRODUCTION  
PLANT MANAGEMENT  
DRILLING SUPERVISION  
WORKOVER SUPERVISION



10000 W. 10th Ave.

10000 W. 10th Ave.  
Suite 100  
Denver, CO 80231  
(303) 751-1111  
FAX (303) 751-1112

10000 W. 10th Ave.  
Suite 100  
Denver, CO 80231  
(303) 751-1111  
FAX (303) 751-1112

10000 W. 10th Ave.

10000 W. 10th Ave.  
Suite 100  
Denver, CO 80231  
(303) 751-1111  
FAX (303) 751-1112

10000 W. 10th Ave.  
Suite 100  
Denver, CO 80231  
(303) 751-1111  
FAX (303) 751-1112

10000 W. 10th Ave.  
Suite 100  
Denver, CO 80231  
(303) 751-1111  
FAX (303) 751-1112

10000 W. 10th Ave.  
Suite 100  
Denver, CO 80231  
(303) 751-1111  
FAX (303) 751-1112

10000 W. 10th Ave.  
Suite 100  
Denver, CO 80231  
(303) 751-1111  
FAX (303) 751-1112

10000 W. 10th Ave.  
Suite 100  
Denver, CO 80231  
(303) 751-1111  
FAX (303) 751-1112

Mr. Joe D. Ramey

Your consideration and cooperation in this matter is greatly appreciated.

Very truly yours,

A handwritten signature in black ink, appearing to read "Ewell N. Walsh". The signature is fluid and cursive, with the first name "Ewell" being more prominent.

Ewell N. Walsh, P.E.  
President

Attachment

ENW:jc

cc:Mr. Al Kendrick, NMOCC, Aztec, NM ✓  
USGS, Farmington, NM

11/11/11

11/11/11 11:11 AM 11/11/11 11:11 AM 11/11/11 11:11 AM 11/11/11 11:11 AM

11/11/11 11:11 AM

*11/11/11 11:11 AM*

11/11/11 11:11 AM  
11/11/11 11:11 AM

11/11/11 11:11 AM

11/11/11 11:11 AM 11/11/11 11:11 AM 11/11/11 11:11 AM 11/11/11 11:11 AM

**NEW MEXICO OIL CONSERVATION COMMISSION  
WELL LOCATION AND ACREAGE DEDICATION PLAT**

Form C-102  
Supersedes C-128  
Effective 1-4-65

All distances must be from the outer boundaries of the Section.

Operator <b>R &amp; G Drilling Company</b>			Lease <b>Krause</b>		Well No. <b>65</b>
Unit Letter <b>C</b>	Section <b>33</b>	Township <b>28N</b>	Range <b>11W</b>	County <b>San Juan</b>	
Actual Footage Location of Well: <b>1190</b> feet from the <b>North</b> line and <b>2050</b> feet from the <b>West</b> line					
Ground Level Elev. <b>5869</b>	Producing Formation <b>Fruitland</b>		Pool <b>Kutz Fruitland</b>		Dedicated Acreage:  Acres

1. Outline the acreage dedicated to the subject well by colored pencil or hachure marks on the plat below.
2. If more than one lease is dedicated to the well, outline each and identify the ownership thereof (both as to working interest and royalty).
3. If more than one lease of different ownership is dedicated to the well, have the interests of all owners been consolidated by communitization, unitization, force-pooling, etc?

☐ Yes    ☐ No    If answer is "yes," type of consolidation \_\_\_\_\_

If answer is "no," list the owners and tract descriptions which have actually been consolidated. (Use reverse side of this form if necessary.) \_\_\_\_\_

No allowable will be assigned to the well until all interests have been consolidated (by communitization, unitization, forced-pooling, or otherwise) or until a non-standard unit, eliminating such interests, has been approved by the Commission.

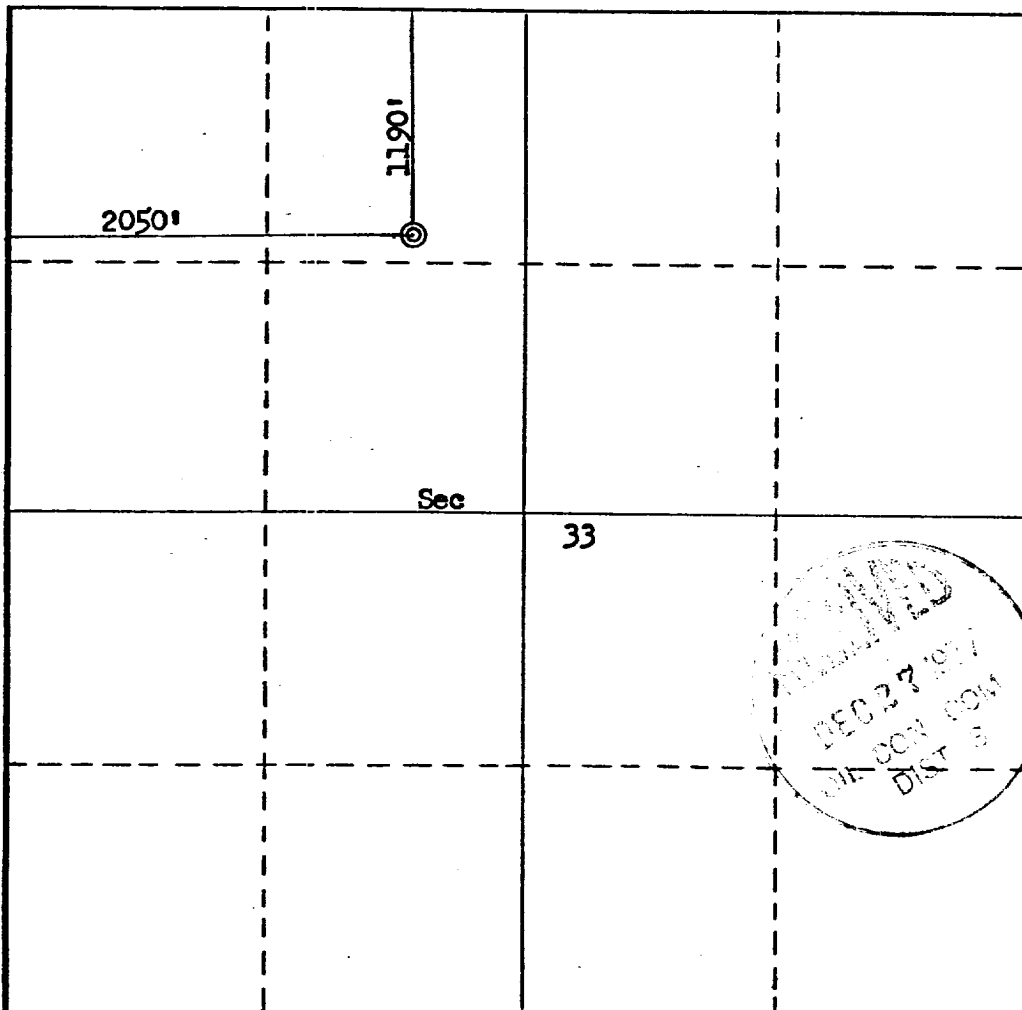

**CERTIFICATION**

I hereby certify that the information contained herein is true and complete to the best of my knowledge and belief.  
For: **R&G Drilling Co.**

Name
<b>Ewell N. Walsh, P.E.</b>
Position
<b>President</b>
Company
<b>Walsh Engr. &amp; Prod. Corp.</b>
Date
<b>12-20-77</b>

I hereby certify that the well location shown on this plat was plotted from field notes of actual surveys made by me or under my supervision, and that the same is true and correct to the best of my knowledge and belief.

Date Surveyed
<b>August 31, 1977</b>
Registered Professional Engineer and/or Land Surveyor
<i>Fred B. Kertz, Jr.</i>
Certificate No.
<b>3950</b>





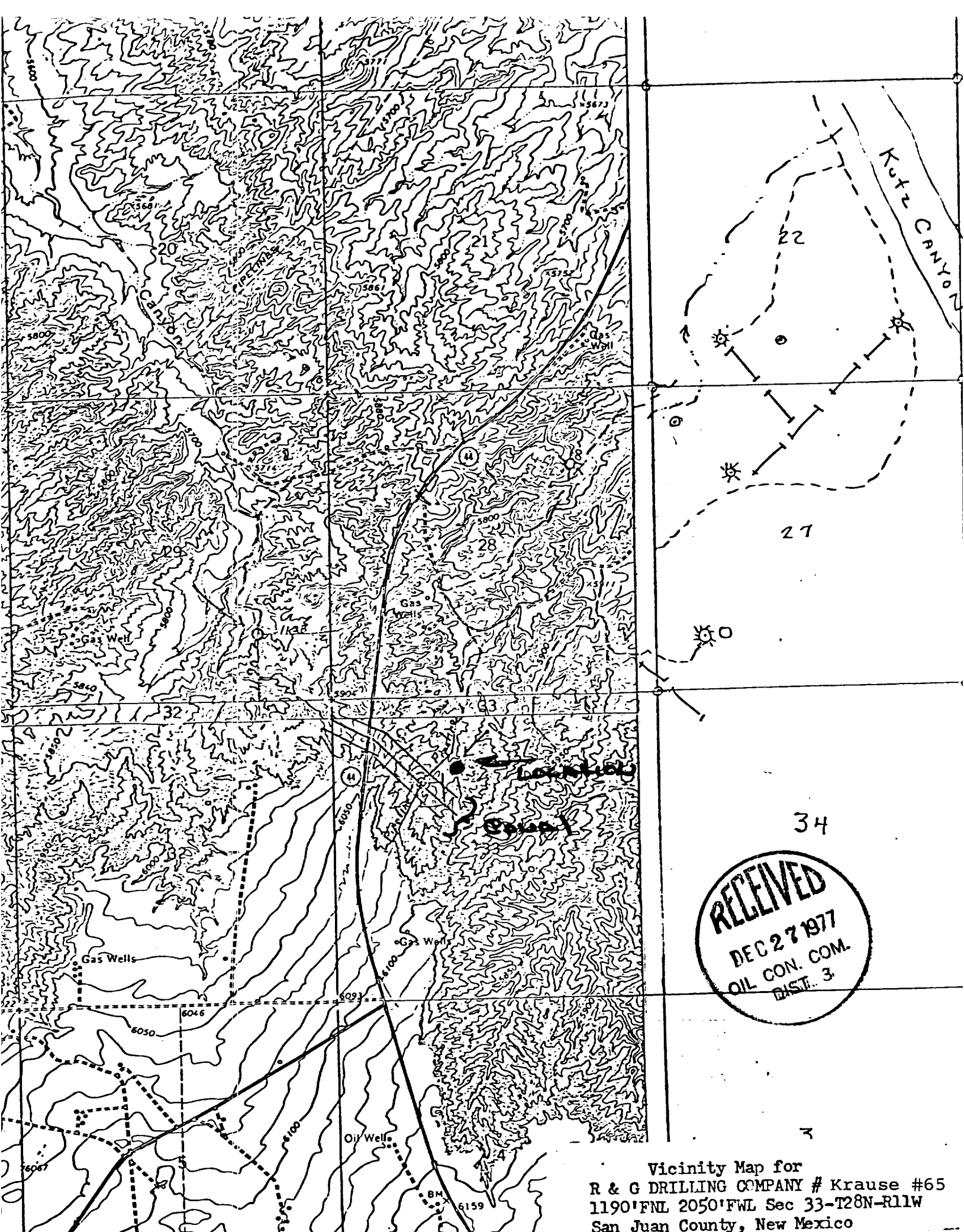

# Walsh

ENGINEERING & PRODUCTION CORP.

PETROLEUM ENGINEERING  
RESERVOIR STUDIES  
EVALUATIONS  
GEOLOGICAL STUDIES  
LEASE MANAGEMENT  
CONTRACT PUMPING  
DRILLING SUPERVISION  
WORKOVER SUPERVISION

EWELL N. WALSH, P.E.  
President

December 22, 1977

Mr. Joe D. Ramey  
Secretary Director  
New Mexico Oil Conservation Commission  
P.O. Box 2088  
Santa Fe, NM 87501

Ref: R&G Drilling Company  
Krause No. 65

Dear Joe:

I would appreciate a very early approval of the enclosed request for an unorthodox location.

The drilling contractor informed me that he had a rig being released and I plan to drill two other wells with the rig before drilling the above-referred-to well.

If possible, a verbal approval would be appreciated.

Very truly yours,



Ewell N. Walsh, P.E.  
President

ENW:JC  
cc:Al Kendrick, NMOCC, Aztec



# Walt

ENGINEERING & PRODUCTION CORP.

WALT DISNEY  
STUDIO

WALT DISNEY  
STUDIO  
ENGINEERING & PRODUCTION CORP.  
1000 W. WASHINGTON  
ST. L. MO. 63101

1000 W. WASHINGTON

1000 W. WASHINGTON  
ST. L. MO. 63101

1000 W. WASHINGTON  
ST. L. MO. 63101

1000 W. WASHINGTON

1000 W. WASHINGTON  
ST. L. MO. 63101

1000 W. WASHINGTON  
ST. L. MO. 63101

1000 W. WASHINGTON  
ST. L. MO. 63101

1000 W. WASHINGTON

1000 W. WASHINGTON  
ST. L. MO. 63101



1000 W. WASHINGTON  
ST. L. MO. 63101