

240000

All distances must be from the outer boundaries of the Section

Operator SUPRON ENERGY CORPORATION		Lease ANGEL PEAK "B"		Well No. 31
Unit Letter C	Section 25	Township 28 NORTH	Range 11 WEST	County SAN JUAN
Actual Postage Location of Well: 990 feet from the NORTH line and 1650 feet from the WEST line				
Ground Level Elev. 5807	Producing Formation GALLUP	Pool UNDESIGNATED	Dedicated Acreage: NE of NW/4 40.00 acres	

1. Outline the acreage dedicated to the subject well by colored pencil or hatchure marks on the plat below.
2. If more than one lease is dedicated to the well, outline each and identify the ownership thereof (both as to working interest and royalty).
3. If more than one lease of different ownership is dedicated to the well, have the interests of all owners been consolidated by communitization, unitization, force-pooling, etc?

☐ Yes ☐ No If answer is "yes," type of consolidation _____

If answer is "no," list the owners and tract descriptions which have actually been consolidated. (Use reverse side of this form if necessary.) _____

No allowable will be assigned to the well until all interests have been consolidated (by communitization, unitization, forced-pooling, or otherwise) or until a non-standard unit, eliminating such interests, has been approved by the Division.

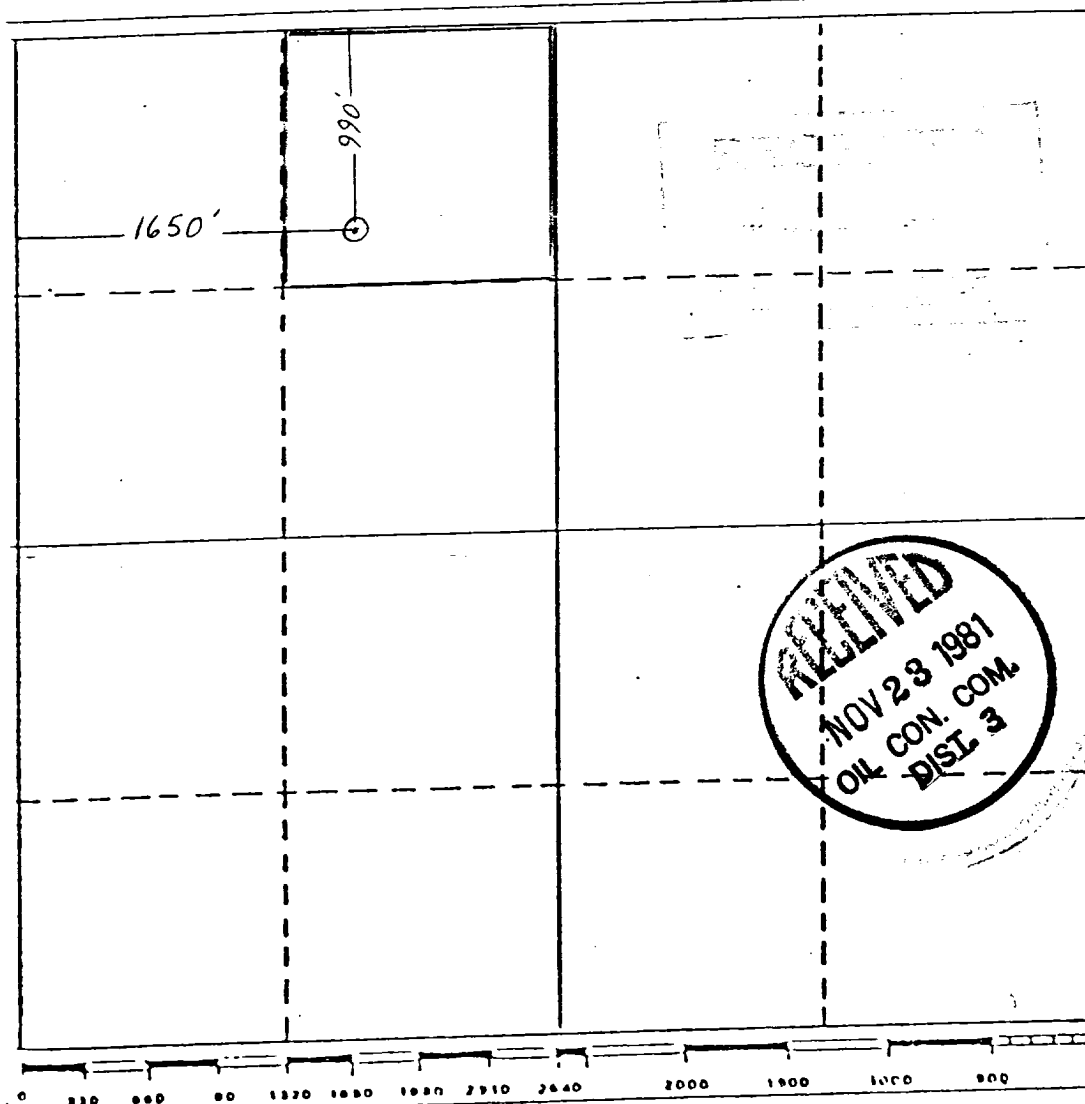

CERTIFICATION

I hereby certify that the information contained herein is true and complete to the best of my knowledge and belief.

Rudy D. Motto
Name

Rudy D. Motto

Position

Area Superintendent

Company

Supron Energy Corporation

Date

November 16, 1981

Michael Daly
I hereby certify that the well location shown on this 5802 was plotted from field notes of actual survey made by me or under my supervision, and that the same is true and correct to the best of my knowledge and belief.

Date Surveyed

February 21, 1980

Registered Professional Engineer and/or Land Surveyor

Michael Daly

Certificate No.

5992