

UNITED STATES
DEPARTMENT OF THE INTERIOR
BUREAU OF LAND MANAGEMENT

SUBMIT IN TRIPLICATE:
Other instructions on
reverse side

20-045-26156
Form approved.
Budget Bureau No. 1004-0136
Expires August 31, 1985

DEC 07 1984

APPLICATION FOR PERMIT TO DRILL, DEEPEN, OR PLUG BACK
OIL CON. DIV.

1a. TYPE OF WORK

DRILL ☒

DEEPEN ☐

PLUG BACK ☐

b. TYPE OF WELL

OIL
WELL ☐

GAS
WELL ☒

OTHER

SINGLE
ZONE ☒

MULTIPLE
ZONE ☐

2. NAME OF OPERATOR

Union Texas Petroleum Corporation

3. ADDRESS OF OPERATOR

P.O. Box 1290, Farmington, New Mexico 87499

4. LOCATION OF WELL (Report location clearly and in accordance with any State requirements.)

At surface

1120' FNL; 1630' FWL

At proposed prod. zone

Same as above

14. DISTANCE IN MILES AND DIRECTION FROM NEAREST TOWN OR POST OFFICE*

3.5 miles south of Farmington, New Mexico.

15. DISTANCE FROM PROPOSED*

LOCATION TO NEAREST
PROPERTY OR LEASE LINE, FT.
(Also to nearest drig. unit line, if any)

1120'

1120'

18. DISTANCE FROM PROPOSED LOCATION*

TO NEAREST WELL, DRILLING, COMPLETED,
OR APPLIED FOR, ON THIS LEASE, FT.

2000'

16. NO. OF ACRES IN LEASE

1557.20

19. PROPOSED DEPTH

6560

17. NO. OF ACRES ASSIGNED
TO THIS WELL

N/2 320.00

20. ROTARY OR CABLE TOOLS

Rotary

21. ELEVATIONS (Show whether DF, RT, GR, etc.)

6057 GR (Ungraded)

DRILLING OPERATIONS AUTHORIZED ARE
SUBJECT TO COMPLIANCE WITH ATTACHED

22. APPROX. DATE WORK WILL START*

July 25, 1984

"GENERAL REQUIREMENTS" CEMENTING PROGRAM

This action is subject to administrative
approval pursuant to 30 CFR 201.10.

SIZE OF HOLE	SIZE OF CASING	WEIGHT PER FOOT	SETTING DEPTH	QUANTITY OF CEMENT
12-1/4	New 8-5/8" K55	24.00#	(±) 300'	265 cu.ft. CL "B" 2% CaCl ₂ circ.
7-7/8	New 4-1/2" K55	10.5 #	(±) 6560'	See Below - 2 stage

We desire to drill this well to the above described program. After setting and cementing surface pipe W.O.C. Pressure test the casing. Drill to T.D. using mud as the circulating medium. Log the well. Run casing to T.D. with D.V. tools as approx. 2900' and cement as follows: 1st stage preceed cement with 20BBLs of mud flush followed by approx. 1050 cu.ft. of 50-50 POZ with 8% Gel, and 6170# of Gilsonite tailed in with approx. 132 cu.ft. of 50-50 POZ with 2% Gel, 0.6% FLA and 1000# of salt to circulate to the D.V. tool. 2nd stage - Preceed cement with 20BBLs of mud flush followed by approx. 800 cu.ft. of 65-35 POZ. with 6450# of Gilsonite tailed in with approx. 138 cu.ft. of CL "B" with 2% Gel and 2% CaCl₂ to circulate to the surface. W.O.C. Drill out the D.V. tool and pressure test the casing. Perforate and fracture the Dakota zone. Clean the well up. Run 2-3/8" J5 tubing to the Dakota zone. Nipple down the wellhead. Test the well and connect to a gathering system.

IN ABOVE SPACE DESCRIBE PROPOSED PROGRAM: If proposal is to deepen or plug back, give data on present productive zone and proposed new productive zone. If proposal is to drill or deepen directionally, give pertinent data on subsurface locations and measured and true vertical depths. Give blowout prevention program if any.

SIGNED

Rudy D. Motto

TITLE Area Operation Manager

APPROVED 1984

AS AMENDED

DEC 05 1984

(S) J. H. MILLER

PERMIT NO.

APPROVAL DATE

APPROVED BY

TITLE

CONDITIONS OF APPROVAL, IF ANY:

NMOCC

*See Instructions On Reverse Side

All distances must be from the outer boundaries of the Section.

Operator UNION TEXAS PETROLEUM CORPORATION			Lease C. J. HOLDER		Well No. 17
Unit Letter C	Section 16	Township 28 NORTH	Range 13 WEST	County SAN JUAN	
Actual Footnote Location of Well: 1120 feet from the NORTH line and 1630 feet from the WEST line					
Ground Level Elev. 6057	Producing Formation Dakota		Pool Basin		Dedicated Acreage: N/2 320.00 Acres

1. Outline the acreage dedicated to the subject well by colored pencil or hatchure marks on the plat below.
2. If more than one lease is dedicated to the well, outline each and identify the ownership thereof (both as to working interest and royalty).
3. If more than one lease of different ownership is dedicated to the well, have the interests of all owners been consolidated by communitization, unitization, force-pooling, etc?

☐ Yes ☒ No If answer is "yes," type of consolidation _____

If answer is "no," list the owners and tract descriptions which have actually been consolidated. (Use reverse side of this form if necessary.) Union Texas Exploration

No allowable will be assigned to the well until all interests have been consolidated (by communitization, unitization, forced-pooling, or otherwise) or until a non-standard unit, eliminating such interests, has been approved by the Division

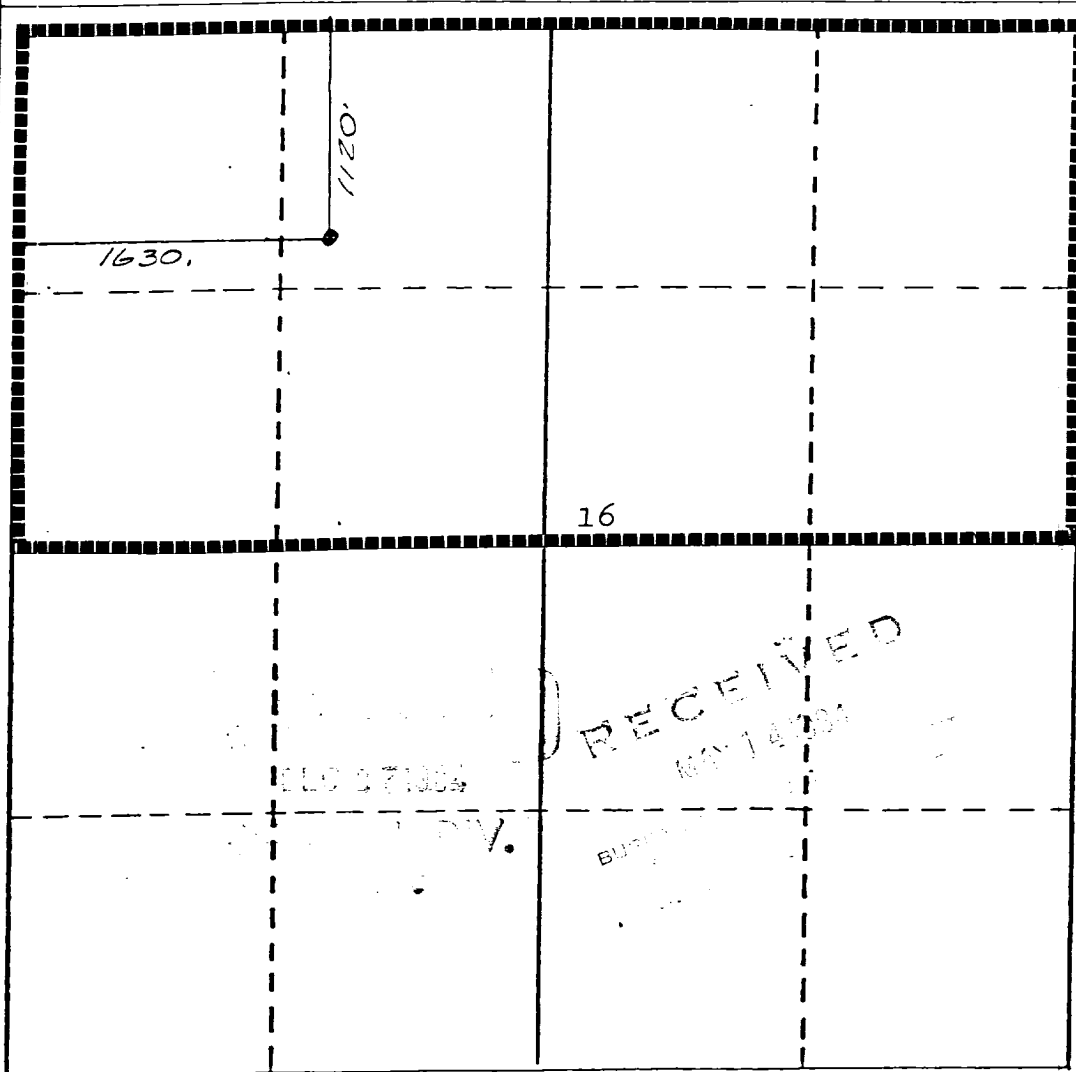

CERTIFICATION

I hereby certify that the information contained herein is true and complete to the best of my knowledge and belief.

Rudy D. Motto
Name

Rudy D. Motto

Position

Area Operations Manager

Company

Union Texas Petroleum Corp.

Date

May 11, 1984

I hereby certify that the well location shown on this plat plotted from field notes of surveys made by me or under my supervision, and that the same are true and correct to the best of my knowledge and belief.

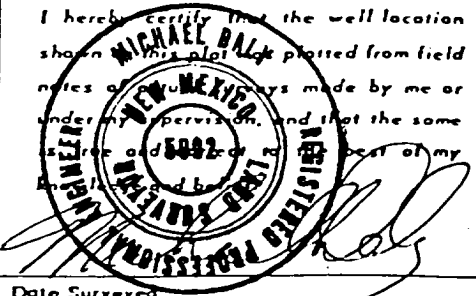

Date Surveyed

March 5, 1983

Registered Professional Engineer
and/or Land Surveyor

Michael Daly

Certificate No.

5992

300' OF NEW ROAD IS NEEDED.

