

UNITED STATES
DEPARTMENT OF THE INTERIOR
BUREAU OF LAND MANAGEMENT

APPLICATION FOR PERMIT TO DRILL, DEEPEN, OR PLUG BACK

1a. TYPE OF WORK DRILL <input checked="" type="checkbox"/> DEEPEN <input type="checkbox"/> PLUG BACK <input type="checkbox"/>			5. LEASE DESIGNATION AND SERIAL NO. SF - 078905	
b. TYPE OF WELL OIL WELL <input checked="" type="checkbox"/> GAS WELL <input type="checkbox"/> OTHER <input type="checkbox"/>			6. IF INDIAN, ALLOTTEE OR TRIBE NAME	
2. NAME OF OPERATOR Amoco Production Company			7. UNIT AGREEMENT NAME Gallegos Canyon Unit	
3. ADDRESS OF OPERATOR 501 Airport Drive Farmington, NM 87401			8. FARM OR LEASE NAME	
4. LOCATION OF WELL (Report location clearly and in accordance with any State requirements.) At surface 1700' FSL X 1770' FEL At proposed prod. zone Same			9. WELL NO. 8E	
14. DISTANCE IN MILES AND DIRECTION FROM NEAREST TOWN OR POST OFFICE 15 miles southeast of Farmington, NM			10. FIELD AND POOL, OR WILDCAT Basin Dakota/Simpson Gallup	
15. DISTANCE FROM PROPOSED* LOCATION TO NEAREST PROPERTY OR LEASE LINE, FT. (Also to nearest drlg. unit line, if any) 1700'			11. SEC., T., R., M., OR BLK. AND SURVEY OR AREA J NW/SE Sec. 22, T28N, R12W	
16. NO. OF ACRES IN LEASE 1207			12. COUNTY OR PARISH San Juan	
17. NO. OF ACRES ASSIGNED TO THIS WELL 320 / 40			13. STATE NM	
18. DISTANCE FROM PROPOSED LOCATION* TO NEAREST WELL, DRILLING, COMPLETED, OR APPLIED FOR, ON THIS LEASE, FT. 1/2 mi. S			17. NO. OF ACRES ASSIGNED TO THIS WELL 320 / 40	
19. PROPOSED DEPTH 6237'			20. ROTARY OR CABLE TOOLS Rotary	
21. ELEVATIONS (Show whether DF, RT, GR, etc.) 5667' GR			22. APPROX. DATE WORK WILL START* As soon as permitted	

PROPOSED CASING AND CEMENTING PROGRAM

SIZE OF HOLE	SIZE OF CASING	WEIGHT PER FOOT	SETTING DEPTH	QUANTITY OF CEMENT
12-1/4"	9-5/8"	32.3#, H-40	300'	200 cu. ft. Class B
8 3/4"	7"	20#, K-55	6237'	1,409 cu. ft. Class B

Amoco proposes to drill the above well to further develop the Basin Dk and Simpson Gallup reservoir. The well will be drilled to the surface casing point using native mud. The well will then be drilled to TD with a low solids nondispersed mud system. Completion design will be based on open hole logs. Copy of all logs will be filed upon completion. Amoco's standard blowout prevention will be employed; see attached drawing for blowout preventer design. Upon completion the well site will be cleaned and the reserve pit filled and leveled. The gas from this well is dedicated to El Paso Natural Gas under contract no. 56742.

RECEIVED

JAN 22 1985

OIL CON. DIV.

IN ABOVE SPACE DESCRIBE PROPOSED PROGRAM: If proposal is to deepen or plug back, give data on present productive zone and proposed new productive zone. If proposal is to drill or deepen directionally, give pertinent data on subsurface locations and measured and true depths. Give blowout preventer program, if any.

24. Original signed By
SIGNED B. D. Shaw TITLE Adm. Supervisor

(This space for Federal or State office use)

PERMIT NO. _____ APPROVAL DATE _____

APPROVED BY _____ TITLE _____

CONDITIONS OF APPROVAL, IF ANY:

ch 7

Nmccc

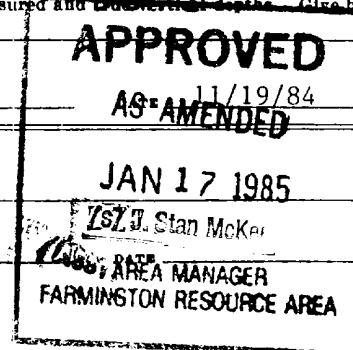

*See Instructions On Reverse Side

All distances must be from the outer boundaries of the Section.

Operator AMOCO PRODUCTION COMPANY		Lease GALLEGOS CANYON UNIT		Well No. 8E
Unit Letter J	Section 22	Township 28N	Range 12W	County San Juan
Actual Footage Location of Well: 1700 feet from the South line and 1770 feet from the East line				
Ground Level Elev. 5667	Producing Formation Dakota & Gallup	Pool Basin Dakota/Simpson Gallup	Dedicated Acreage: 320/40 Acres	

1. Outline the acreage dedicated to the subject well by colored pencil or hachure marks on the plat below.
2. If more than one lease is dedicated to the well, outline each and identify the ownership thereof (both as to working interest and royalty).
3. If more than one lease of different ownership is dedicated to the well, have the interests of all owners been consolidated by communitization, unitization, force-pooling, etc?

☒ Yes ☐ No If answer is "yes," type of consolidation Unitized

If answer is "no," list the owners and tract descriptions which have actually been consolidated. (Use reverse side of this form if necessary.)

No allowable will be assigned to the well until all interests have been consolidated (by communitization, unitization, forced-pooling, or otherwise) or until a non-standard unit, eliminating such interests, has been approved by the Commission.

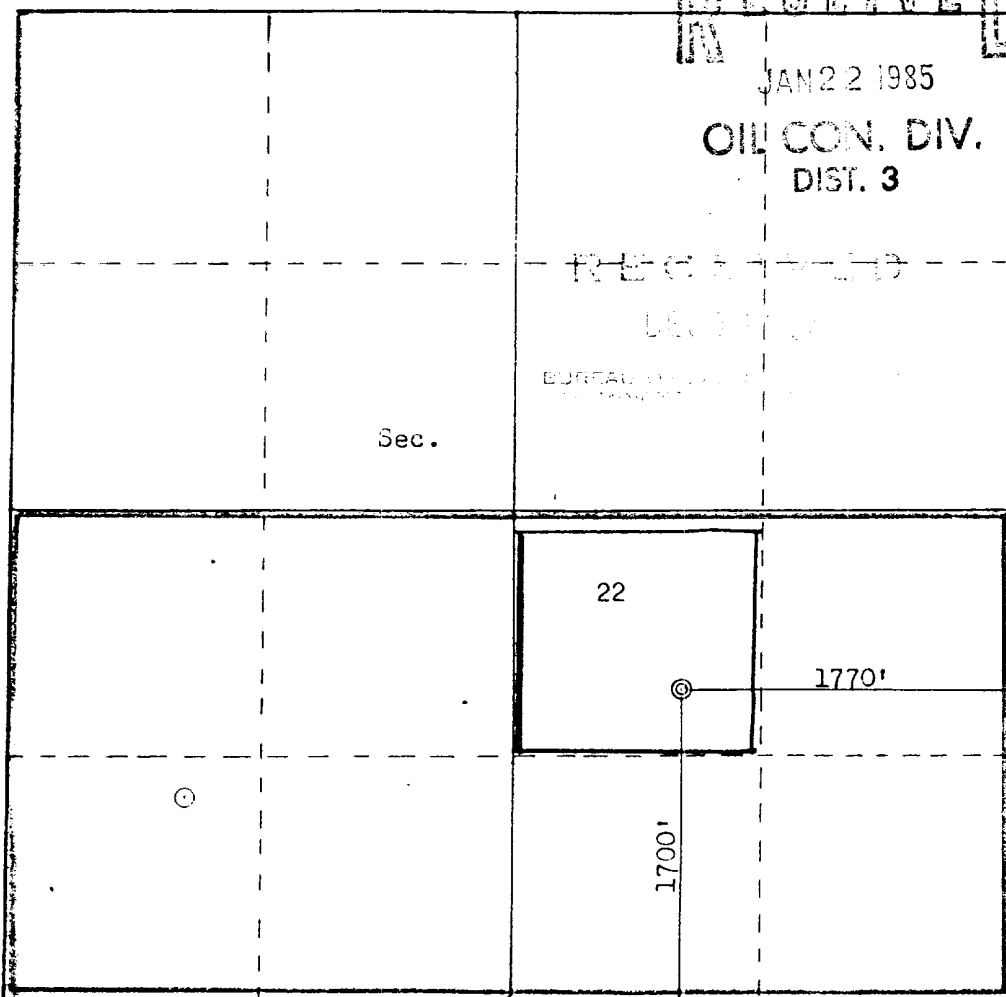

Scale: 1"=1000'

CERTIFICATION	
I hereby certify that the information contained herein is true and complete to the best of my knowledge and belief.	
Original signed By	
Name	B. D. Shaw
	B.D. Shaw
Position	Administrative Supervisor
Company	Amoco Production Company
Date	11/14/84
I hereby certify that the well location shown on this plat was plotted from field notes of actual surveys made by me or under my supervision, and that the same is true and correct to the best of my knowledge and belief.	
Date Surveyed	October 16, 1984
Registered Professional Engineer and Land Surveyor	<i>Fred B. Kerr Jr.</i> Fred B. Kerr Jr.
Certificate No.	3950

