



TONY ANAYA
GOVERNOR

STATE OF NEW MEXICO
ENERGY AND MINERALS DEPARTMENT
OIL CONSERVATION DIVISION

October 1, 1985

50 YEARS



1935 - 1985

POST OFFICE BOX 2088
STATE LAND OFFICE BUILDING
SANTA FE, NEW MEXICO 87501
(505) 827-5800

Amoco Production Company
Petroleum Center Building
501 Airport Drive
Farmington, New Mexico 87401

Attention: W. J. Holcomb

Administrative Order NSL-2156

Gentlemen:

Reference is made to your application for a non-standard location for your Gallegos Canyon Unit No. 137E well to be located 1110 feet from the South line and 940 feet from the West line of Section 36, Township 28 North, Range 13 West, NMPM, Basin Dakota Pool and Cha Cha Gallup Extension Fields, San Juan County, New Mexico. The S/2 of said Section 36 shall be dedicated to the Basin Dakota Pool and the S/2 SW/4 of said Section 36 shall be dedicated to the Cha Cha Gallup Extension.

By authority granted me under the provisions of Rule 104 F(I), the above-described unorthodox location is hereby approved.

Sincerely,

R. L. STAMETS, DIRECTOR

RLS/DC/dr

cc: Oil Conservation Division - Aztec
Bureau of Land Management - Farmington

OCT 03 1985

OIL CON. DIV.
DIST. 3



STATE OF NEW MEXICO
ENERGY AND MINERALS DEPARTMENT

OIL CONSERVATION DIVISION
AZTEC DISTRICT OFFICE

1000 RIO BRAZOS ROAD
AZTEC, NEW MEXICO 87410
(505) 334-6178

OIL CONSERVATION DIVISION
BOX 2088
SANTA FE, NEW MEXICO 87501

DATE 7-3-85

RE: Proposed MC _____
Proposed DHC _____
Proposed NSL X _____
Proposed SWD _____
Proposed WFX _____
Proposed PMX _____

Gentlemen:

I have examined the application dated 7-3-85

for the Amoco C.C.V. #137E M-36-28A-13
Operator Lease and Well No. Unit, S-T-R

and my recommendations are as follows:

Approved

Yours truly,

[Signature]



STATE OF NEW MEXICO
ENERGY AND MINERALS DEPARTMENT

OIL CONSERVATION DIVISION
AZTEC DISTRICT OFFICE

1000 RIO BRAZOS ROAD
AZTEC, NEW MEXICO 87410
(505) 334-6178

OIL CONSERVATION DIVISION
BOX 2088
SANTA FE, NEW MEXICO 87501

DATE 3-1-85

RE: Proposed MC _____
Proposed DHC _____
Proposed NSL X _____
Proposed SWD _____
Proposed WFX _____
Proposed PMX _____

Gentlemen:

I have examined the application dated 2-12-85
for the Amoco G. C. U. # 137E M-36-28N-13W
Operator Lease and Well No. Unit, S-T-R

and my recommendations are as follows:

Docket for hearing

Yours truly,

Sam Burt

2-1-85
Accepted

SECRET

EXHIBIT C

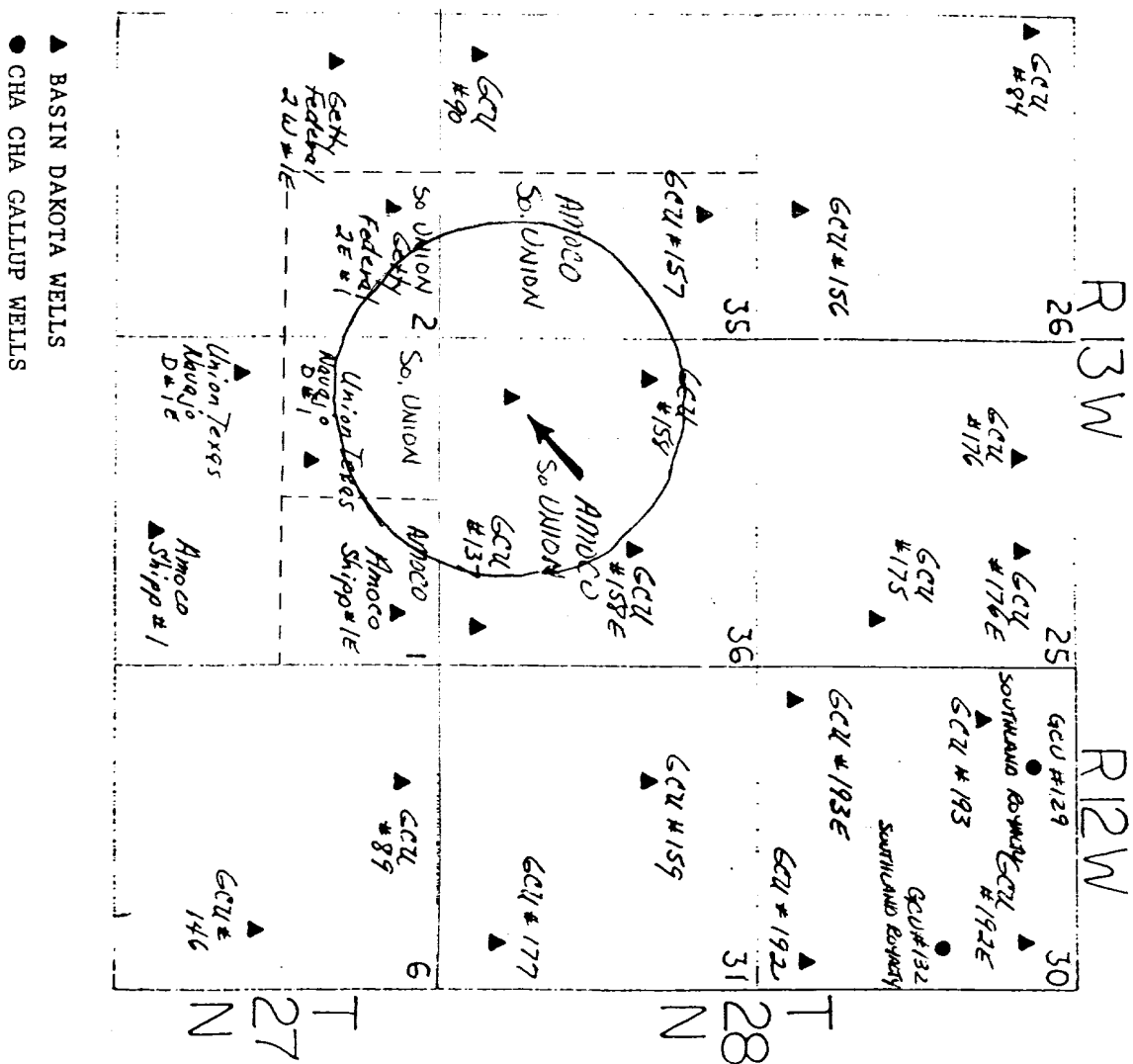

All distances must be from the outer boundaries of the Section.

Operator AMOCO PRODUCTION COMPANY			Lease GALLEGOS CANYON UNIT		Well No. 137E
Unit Letter M	Section 36	Township 28N	Range 13W	County San Juan	
Actual Footage Location of Well: 1110 feet from the South line and 940 feet from the West line					
Ground Level Elev. 5843	Producing Formation Dakota & Gallup		Pool Basin Dakota / Cha Cha Gallup Ext.		Dedicated Acreage: 320 / 80 Acres

1. Outline the acreage dedicated to the subject well by colored pencil or hachure marks on the plat below.
2. If more than one lease is dedicated to the well, outline each and identify the ownership thereof (both as to working interest and royalty).
3. If more than one lease of different ownership is dedicated to the well, have the interests of all owners been consolidated by communitization, unitization, force-pooling, etc?

☒ Yes ☐ No If answer is "yes," type of consolidation Unitized

If answer is "no," list the owners and tract descriptions which have actually been consolidated. (Use reverse side of this form if necessary.)

No allowable will be assigned to the well until all interests have been consolidated (by communitization, unitization, forced-pooling, or otherwise) or until a non-standard unit, eliminating such interests, has been approved by the Commission.

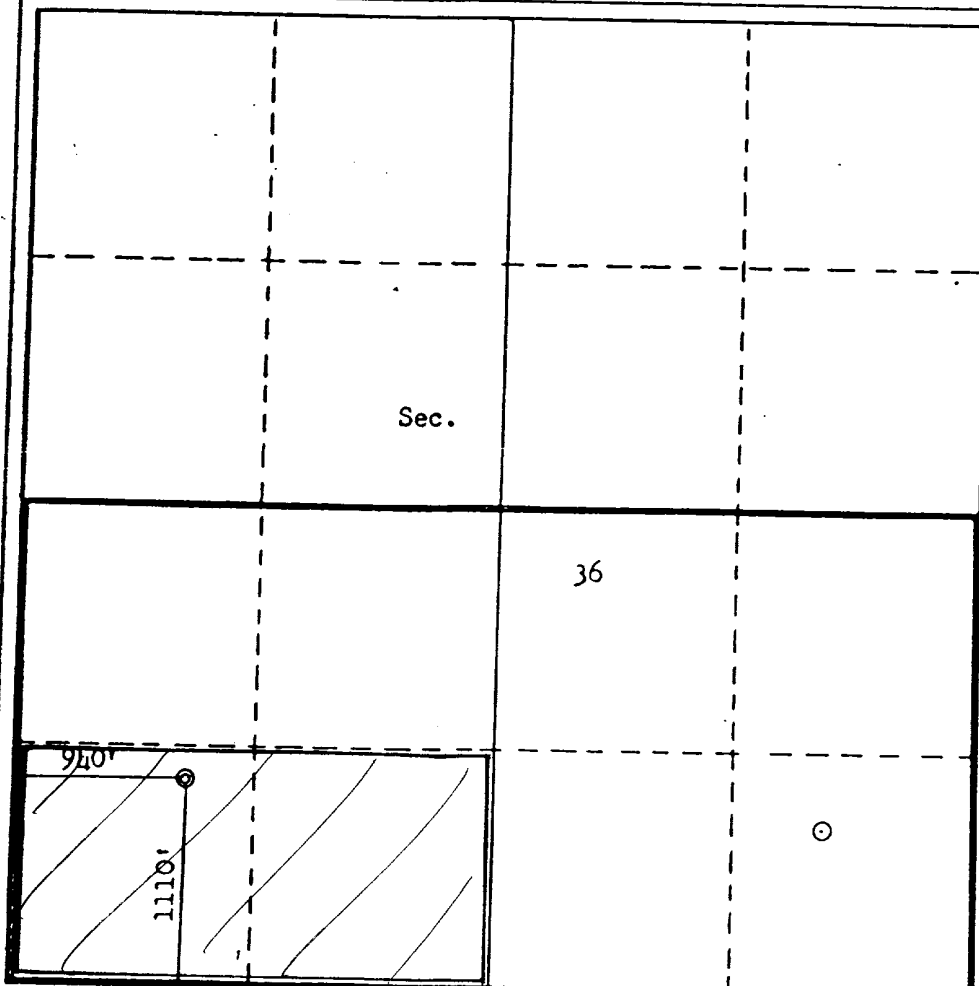

CERTIFICATION

I hereby certify that the information contained herein is true and complete to the best of my knowledge and belief.

Original Signed By

Name **B. D. Shaw**

Position **Administrative Supervisor**

Company **Amoco Production Company**

Date **May 31, 1984**

I hereby certify that the well location shown on this plat was plotted from field notes of actual surveys made by me or under my supervision, and that the same is true and correct to the best of my knowledge and belief.

Date Surveyed

December 14, 1981

Registered Professional Engineer and/or Land Surveyor

Fred B. Kerr, Jr.

Certificate No.

3950

